



INSTALLATION INSTRUCTIONS

Accessory
HEATED GRIPS ATTACHMENT KIT
 P/N 08T70-MGS-A30

Application
NC700X/XD

Publication No.
MII 13973
 Issue Date
April 2012

Honda Dealer: Please give a copy of these instructions to your customer.

PARTS LIST

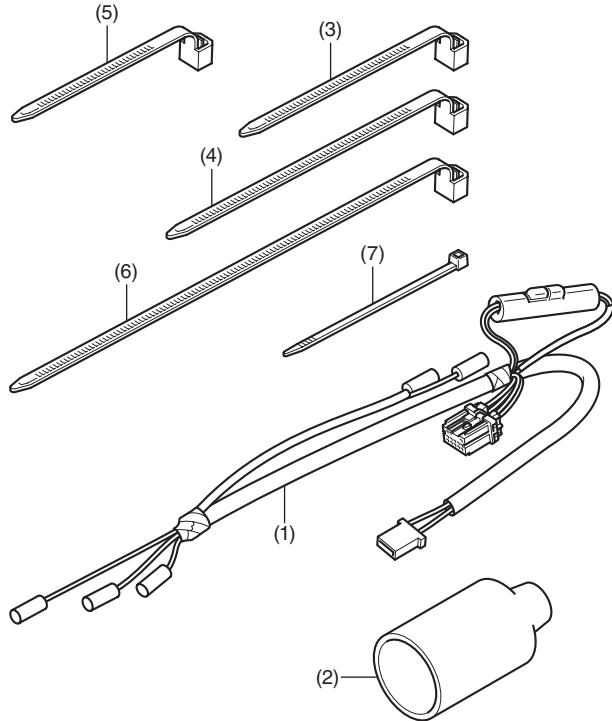

| No. | Description | Qty |
|-----|-----------------------------------|-----|
| (1) | Heated grip harness | 1 |
| (2) | Harness boot | 1 |
| (3) | Wire tie A (W x L: 7 x 125 mm) | 3 |
| (4) | Wire tie B (W x L: 7 x 165 mm) | 2 |
| (5) | Wire tie C (W x L: 7 x 95 mm) | 2 |
| (6) | Wire tie D (W x L: 7 x 235 mm) | 2 |
| (7) | Wire tie E (W x L: 2.5 x 100* mm) | 2 |

*: The length is included the wire tie head.

HEATED GRIPS Sold separately

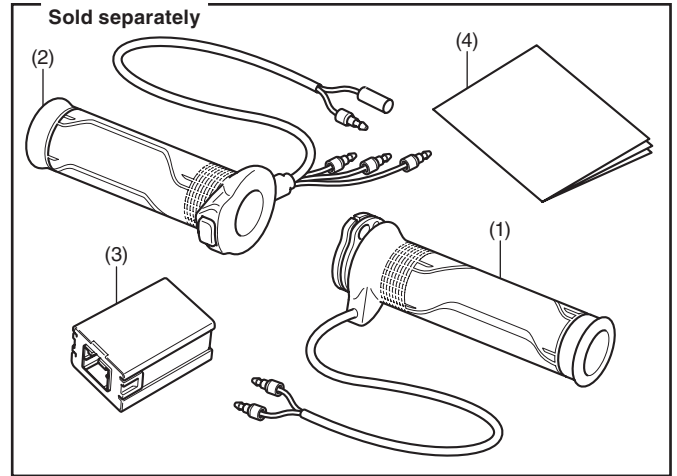

| No. | Description | Qty |
|-----|-------------------|-----|
| (1) | Right heated grip | 1 |
| (2) | Left heated grip | 1 |
| (3) | Controller | 1 |
| (4) | Operation Manual | 1 |

SUB HARNESS Sold separately

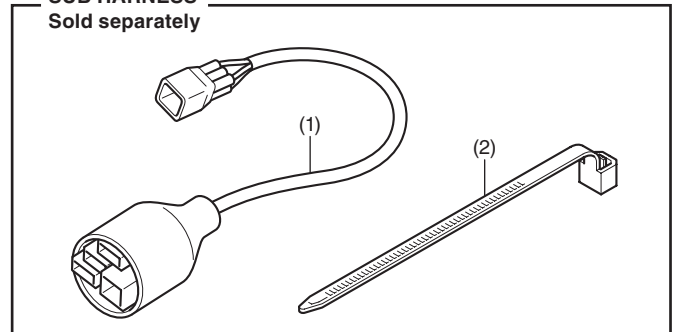

| No. | Description | Qty |
|-----|-------------|-----|
| (1) | Sub harness | 1 |
| (2) | Wire tie | 1 |

RELAY SET
Sold separately

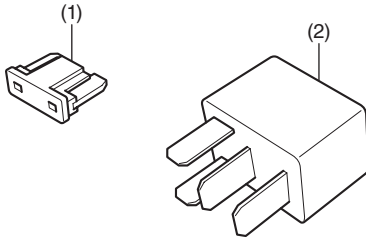

| No. | Description | Qty |
|-----|--------------|-----|
| (1) | Fuse (7.5 A) | 1 |
| (2) | Relay | 1 |

TOOLS AND SUPPLIES REQUIRED

Side cutters
Scissors
Ruler
Marker
Electrical tape
Pro Honda Handgrip Cement (08712-0001)
Grease
Thread lock
Isopropyl alcohol
Shop towel

TORQUE INFORMATION

Refer to the Service Manual for the torque values of the removed parts.

USE AND CARE INFORMATION

- Use a 5A fuse for replacement of the fuse in the accessory harness. Do not use any other fuse for replacement.
- Use a 7.5A fuse for replacement of the fuse in the relay set. Do not use any other fuse for replacement.
- Check the accessory mounts frequently.

INSTALLATION INFORMATION

CAUTION:

- To prevent burns, allow the engine, exhaust system, radiator, etc., to cool before installing the accessory.

NOTE:

- The following accessories are also required to install the heated grips.
 - Heated grips
 - Sub harness
 - Relay set
- Disconnect the throttle cables from the right grip as instructed in the motorcycle's Service Manual.
- For secure adhesion of the left heated grip to the handlebar, we urge you to use the recommended adhesive agent (Pro Honda Handgrip Cement or equivalent) and wait until it cures fully before use.
- Be sure to open and close the throttle to check for smooth operation after installation of the right heated grip.
- Take care not to damage the painted surfaces of the motorcycle.
- Reinstall the removed parts on the motorcycle and make sure that wires and harnesses are not pinched.
- Disconnect the negative (-) cable from the battery before installing this accessory.
- The memory of the clock will be erased when you disconnect the battery. Reset the clock after reconnecting the battery.
- Trim the excess ends off the wire ties after attaching them to the wire harnesses. Do not allow the cut part of the wire tie to interfere with any harness or brake hose.
- After heated grips installation, check the lights (e.g. right / left turn signal lights and brake lights) for proper operation.
- When replacing the Sub Harness or Relay Set, follow the instructions described in these installation instructions.

PREPARING THE RELAY SET

1. Refer to the Service Manual for the motorcycle, remove the maintenance lid, and disconnect the negative (-) cable from the battery.

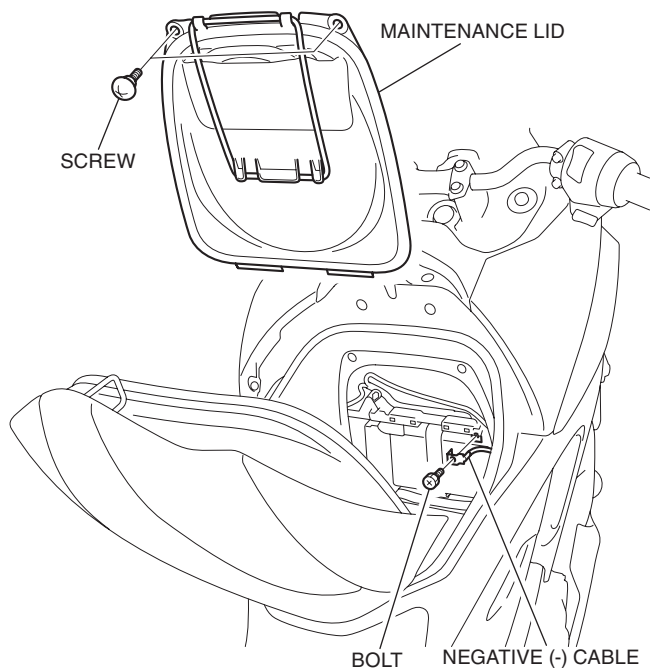

2. Remove the fuse box cover as shown.

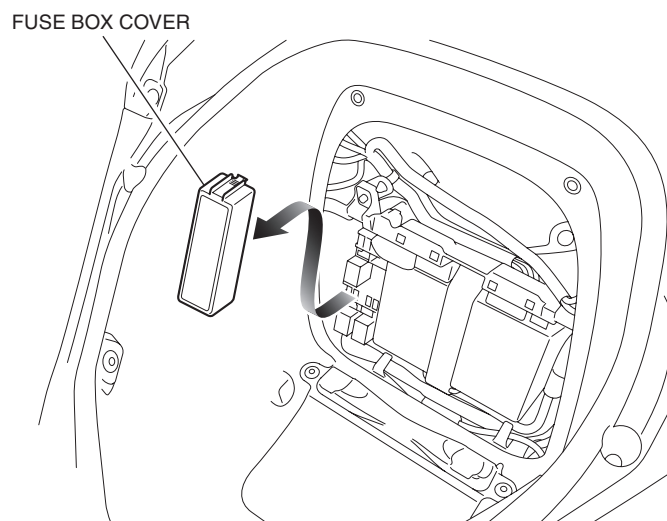

3. Install the relay and fuse in the positions shown.

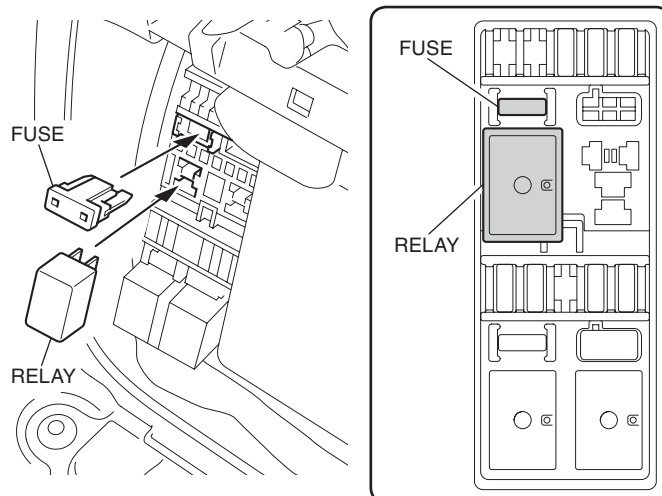

HEATED GRIPS INSTALLATION

1. Confirm the negative (-) cable is disconnected from the battery. See PREPARING THE RELAY SET for detailed instructions.
2. Refer to the Service Manual for the motorcycle, remove the seats.

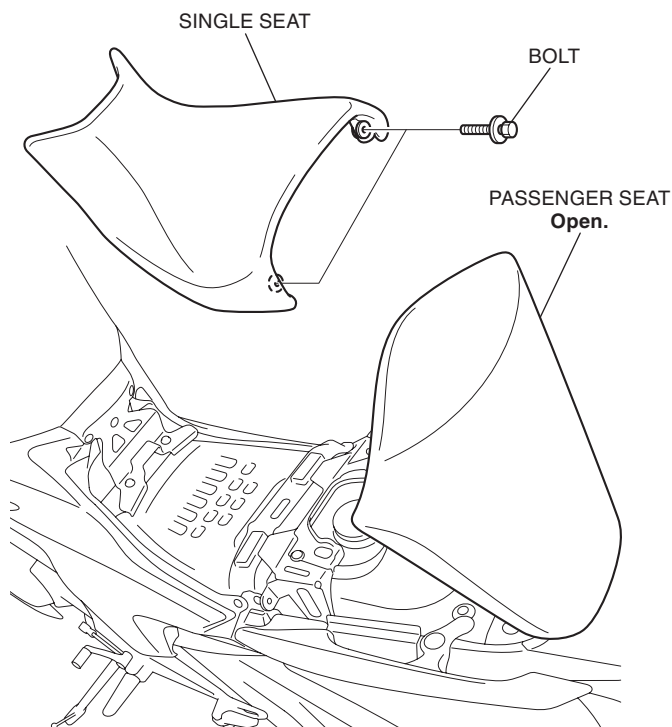

2. Refer to the Service Manual for the motorcycle, remove the left air duct.

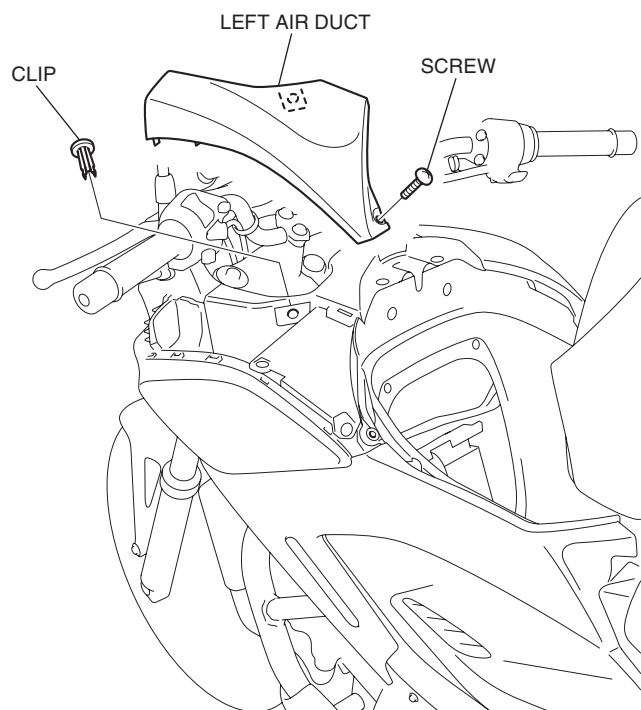

3. Remove the clip and open the front part of the left seat cowl slightly as shown.

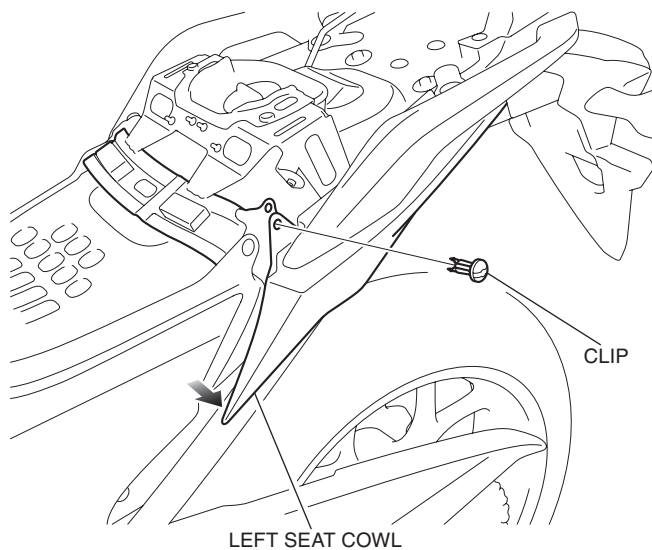

4. Refer to the Service Manual for the motorcycle, remove the left side cover.

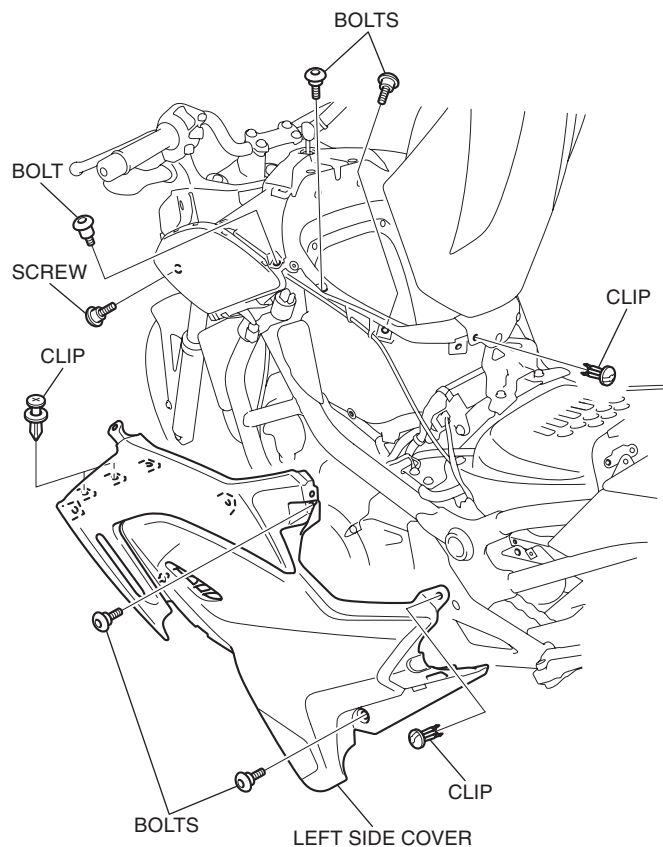

5. Refer to the Service Manual for the motorcycle, remove the left front side cover.

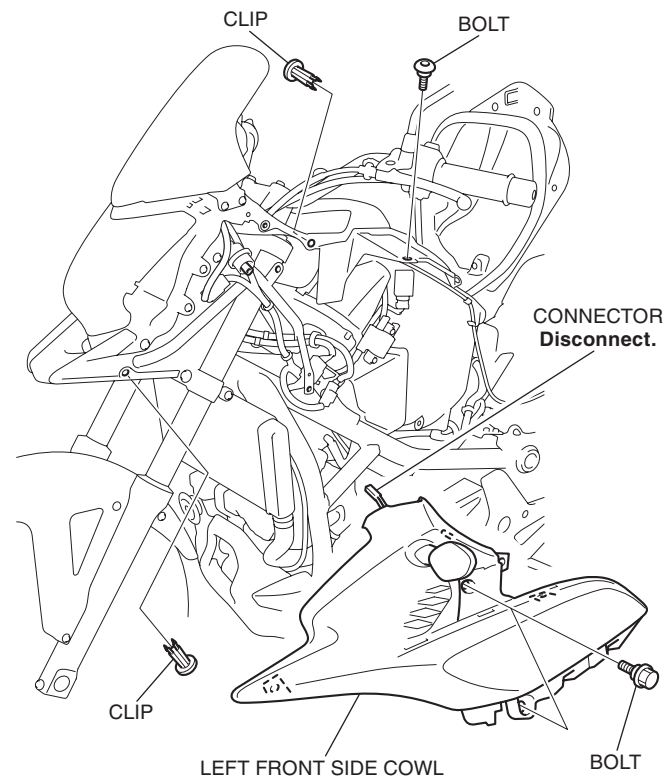

6. Release the motorcycle's 6-pin waterproof connector as shown.

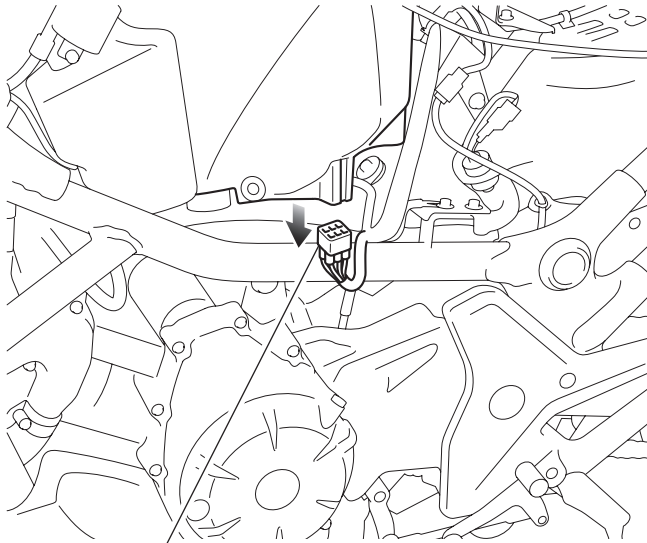

MOTORCYCLE'S 6-PIN WATERPROOF CONNECTOR

7. Connect the sub harness to the motorcycle's harness as shown.

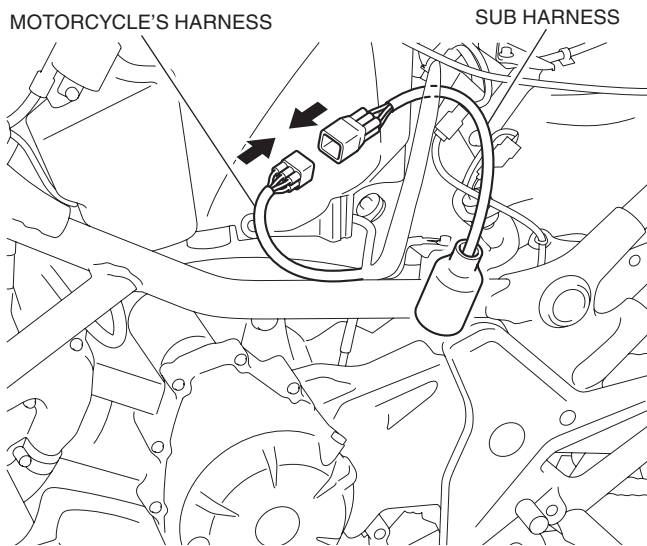

MOTORCYCLE'S HARNESS

SUB HARNESS

8. Secure the 6-pin waterproof connector with electrical tape as shown.

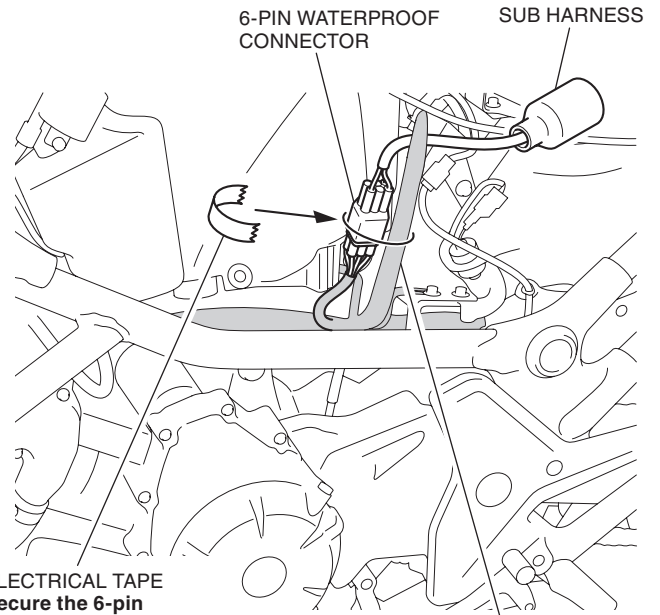

ELECTRICAL TAPE
Secure the 6-pin waterproof connector to the motorcycle's harness.

MOTORCYCLE'S HARNESS

9. Connect the controller to the heated grip harness as shown.

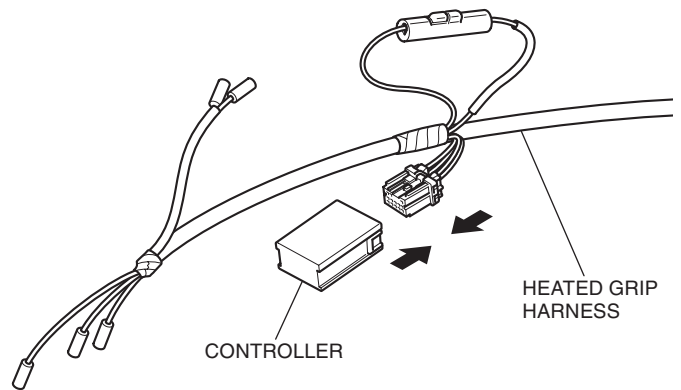

10. Disconnect the fuse as shown.

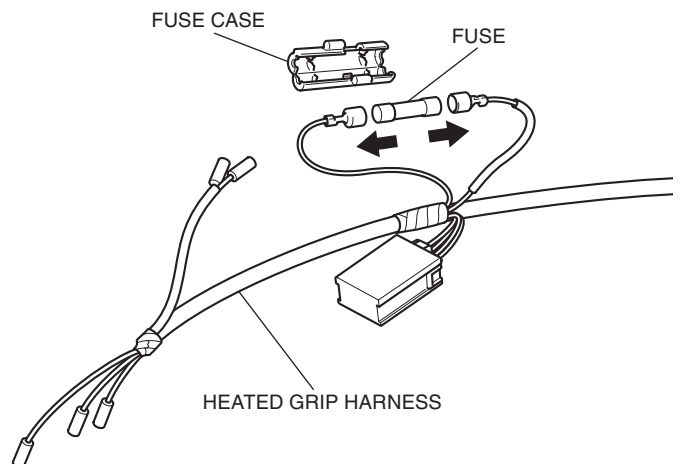

11. Fit the boot over the harness as shown.

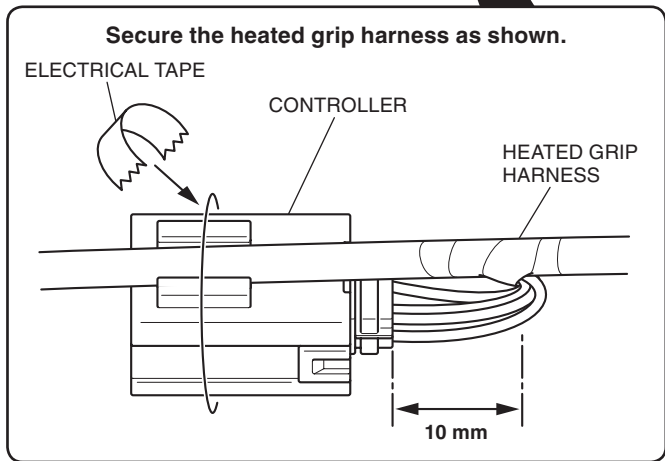
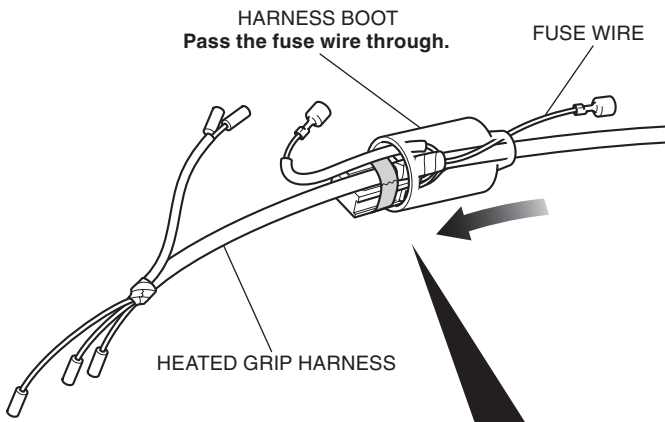

12. Fit the boot over the controller as shown.

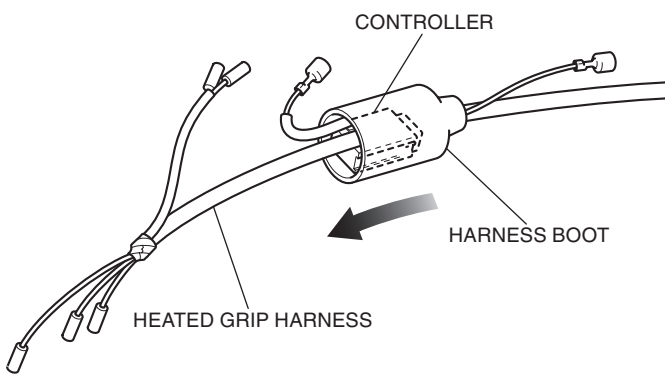

13. Install the fuse in the reverse order of removal.

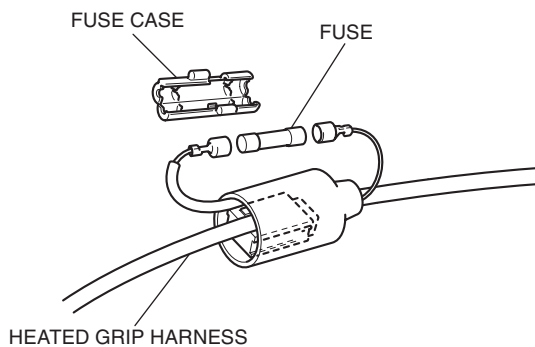

14. Connect the heated grip harness to the sub harness as shown.

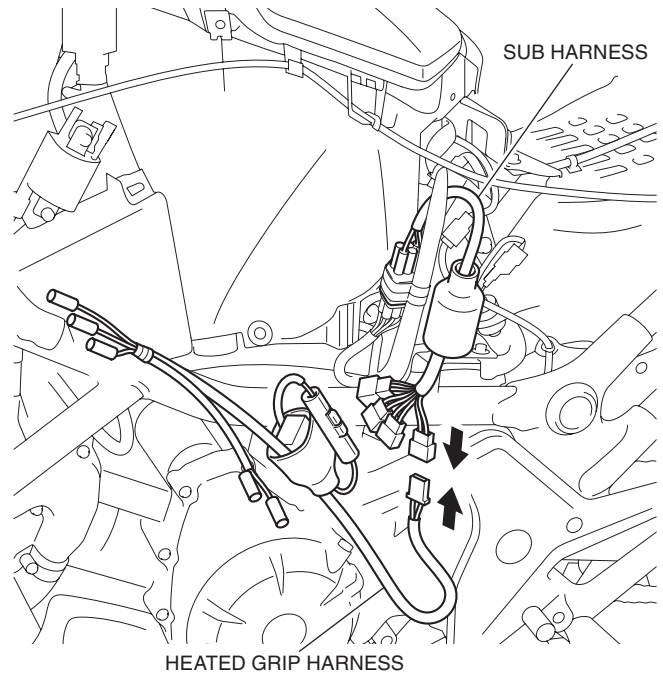

15. Cover the connectors with the harness boot as shown.

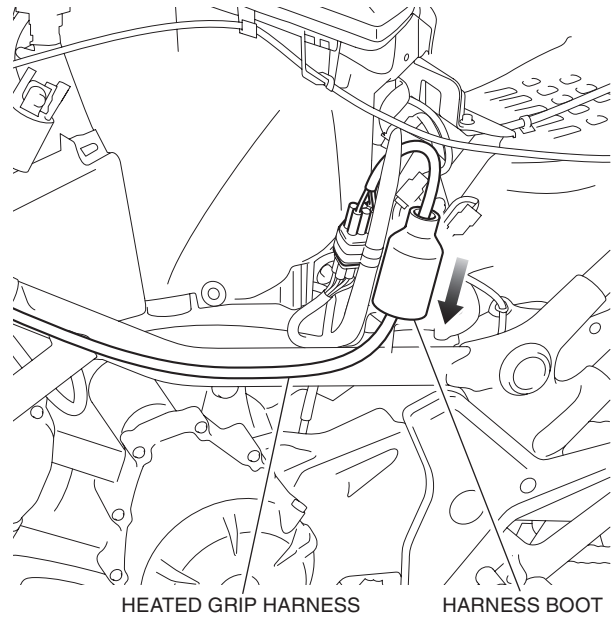

16. Secure the sub harness with the wire tie as shown.

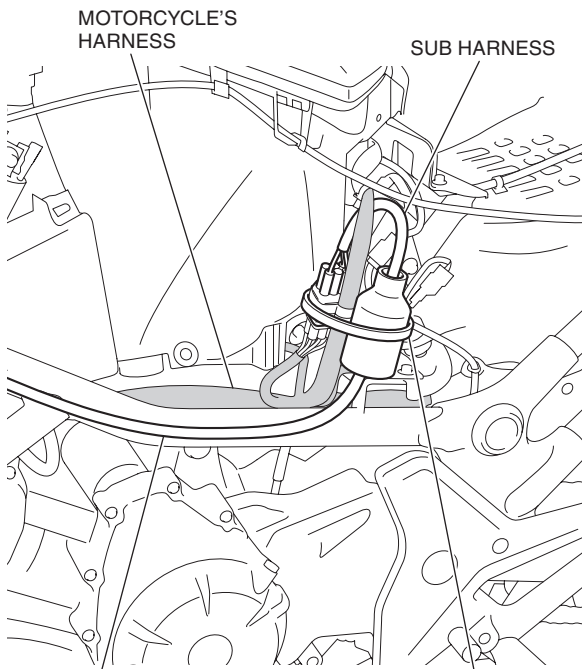

HEATED GRIP HARNESS

WIRE TIE
Included in the Sub harness. Secure the harness boot to the motorcycle's harness.

17. Route and secure the heated grip harness with the wire ties as shown.

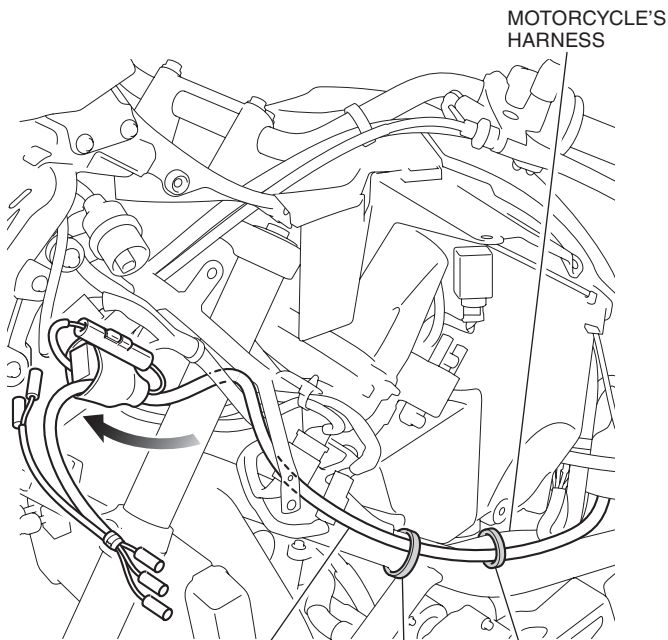

HEATED GRIP HARNESS

WIRE TIE B
Secure the heated grip harness to the motorcycle's harness.

WIRE TIE B
Secure the heated grip harness to the frame.

18. Route the heated grip harness as shown.

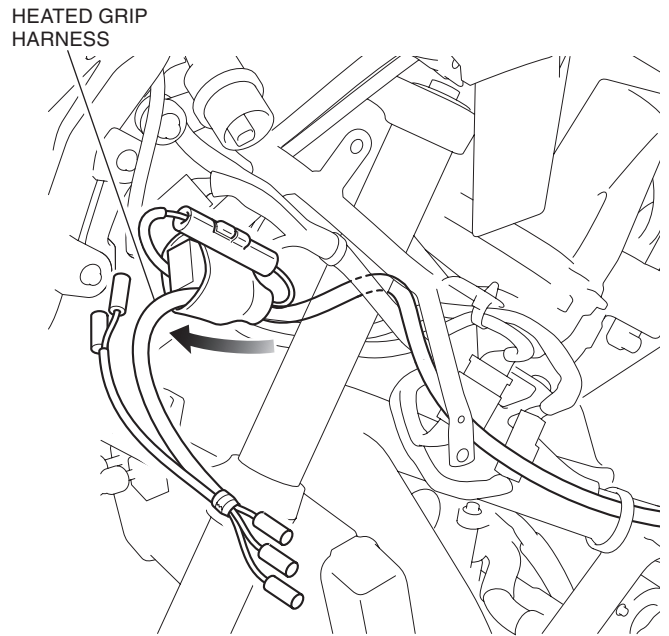

19. Secure the heated grip harness as shown.

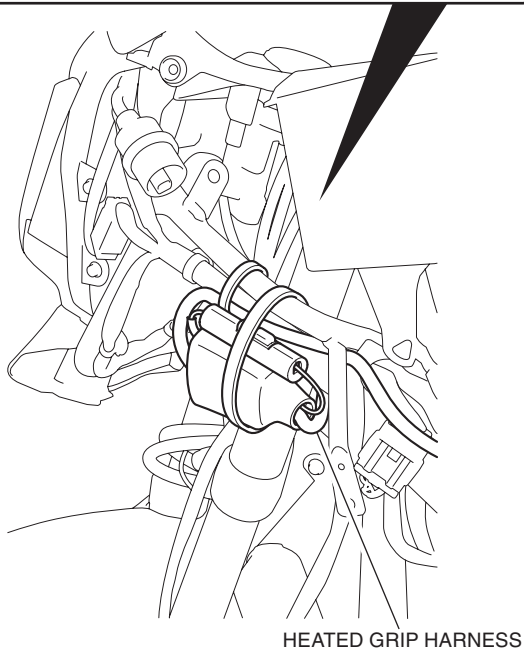
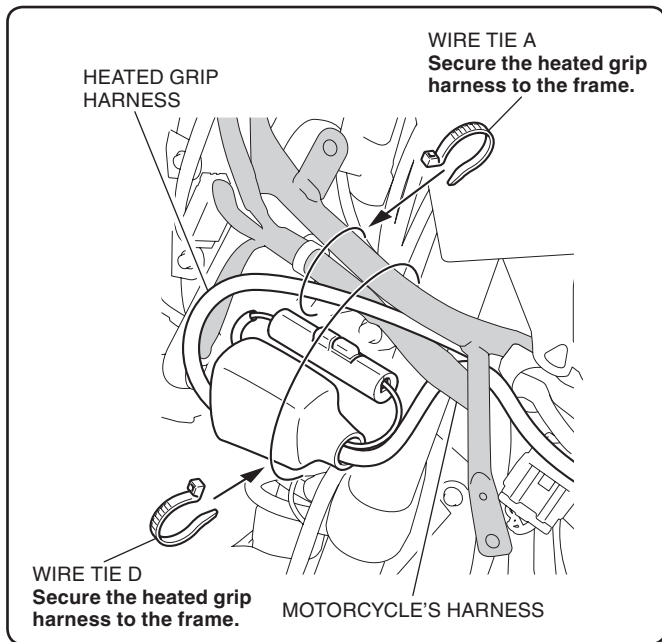

20. Remove the handlebar weight from the motorcycle as shown.

- Repeat on the left side.

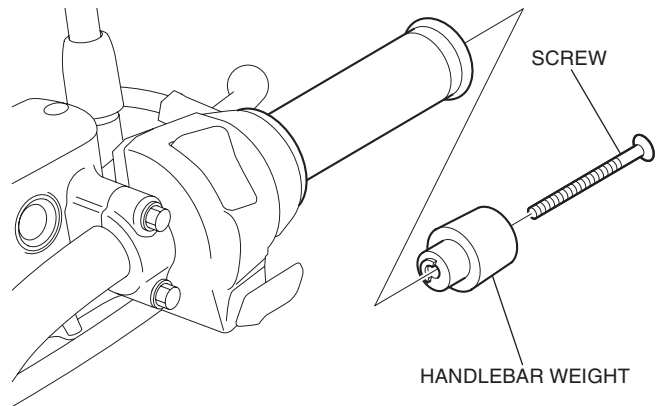

21. Loosen the bolts and slide the master cylinder to the left as shown.

- Be careful not to scratch the handlebar.

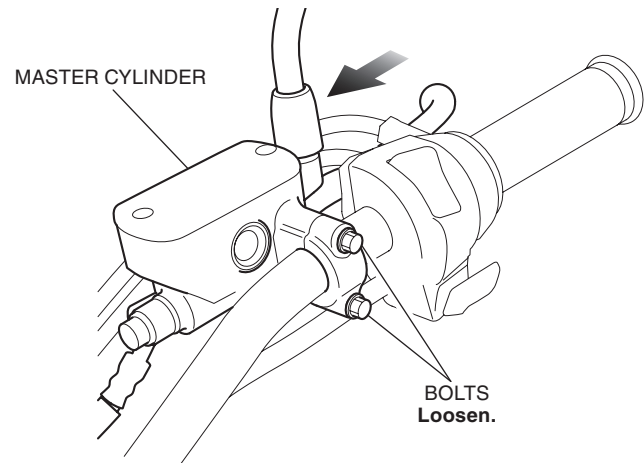

22. Remove the right handlebar switch as shown.

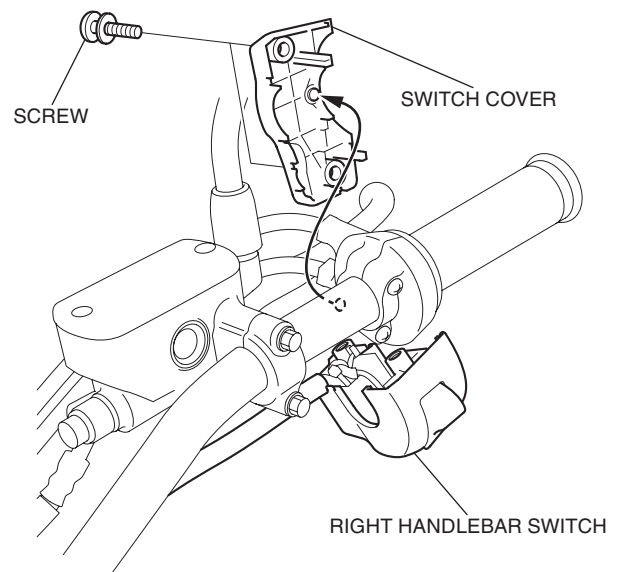

23. Remove the throttle housing cover as shown.

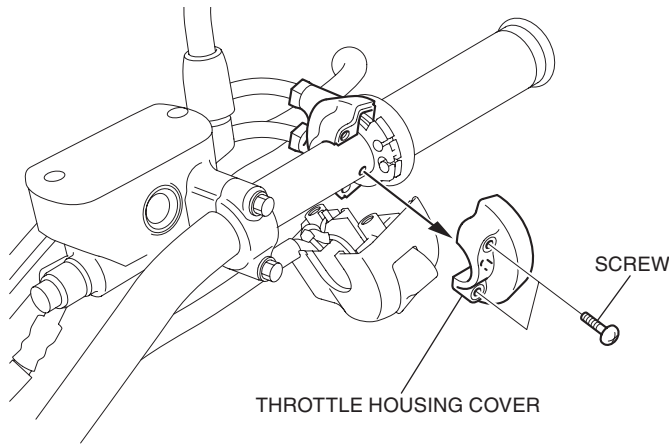

24. Remove the right grip as shown.

NOTE

Disconnect the throttle cable from the right grip as instructed in the motorcycle's Service Manual. Do not try to disconnect the cable with force using pliers, etc. Refer to the motorcycle's Service Manual.

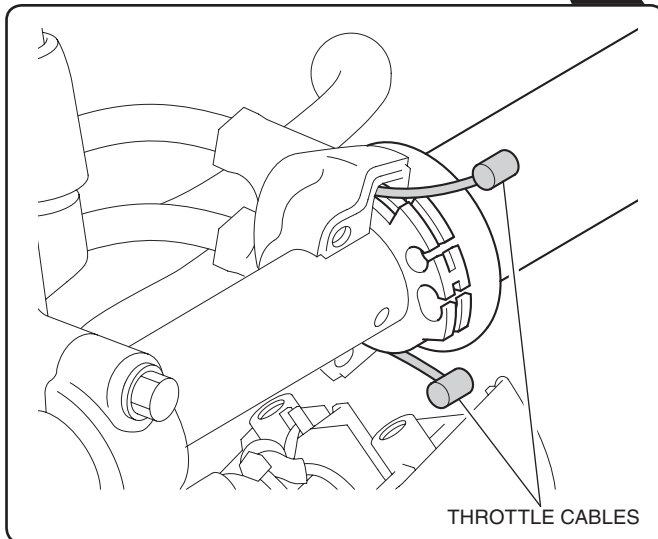
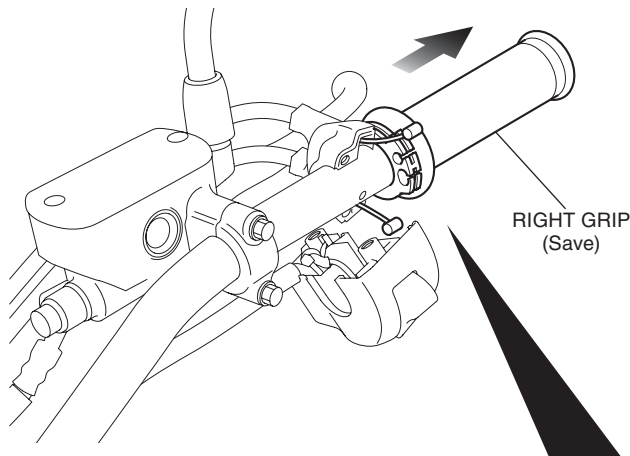

25. Mark the right heated grip harness in the position shown.

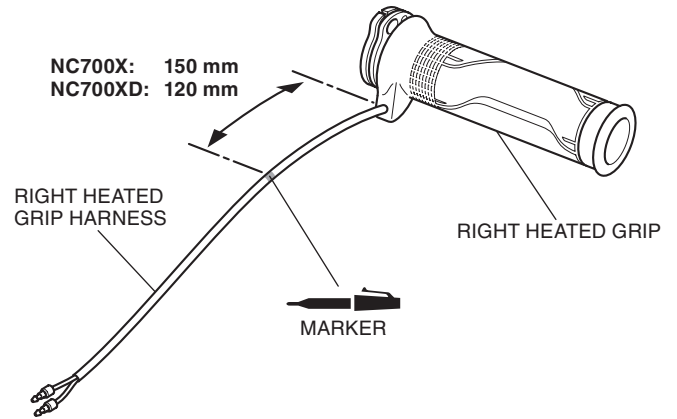

26. Apply grease to the  parts of the throttle cables and throttle pipe as shown.

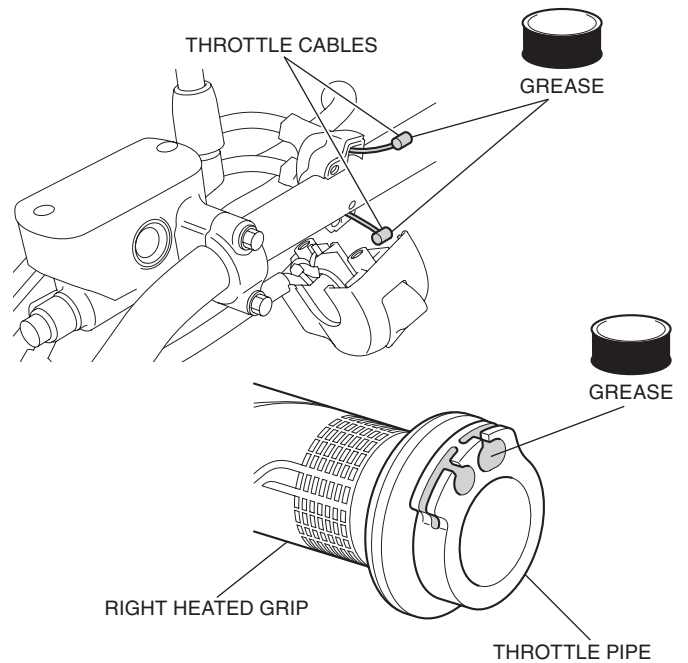

27. Install the right heated grip in the reverse order of the motorcycle's grip removal.

- After installation, refer to the Service Manual and adjust the throttle freeplay.

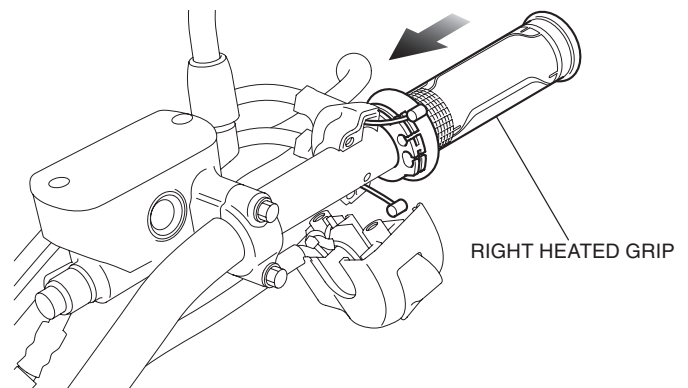

28. Reposition the master cylinder correctly and tighten the bolts as shown.

- **Be careful not to scratch the handlebar.**

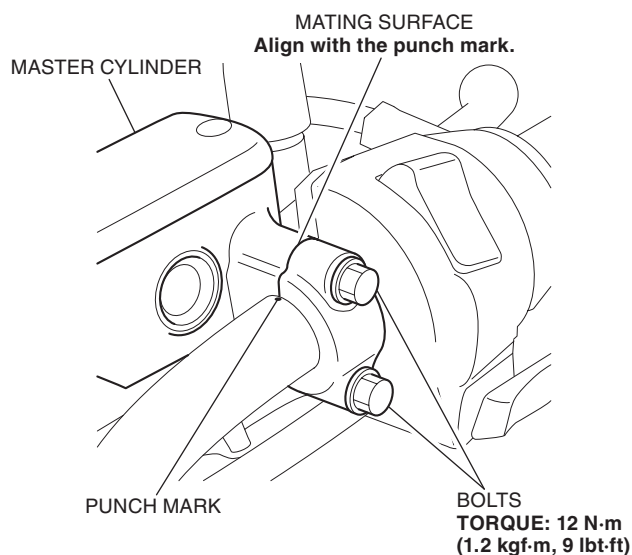

29. Reinstall the handlebar weight as shown.

- **Before applying thread lock, thoroughly clean the screw.**

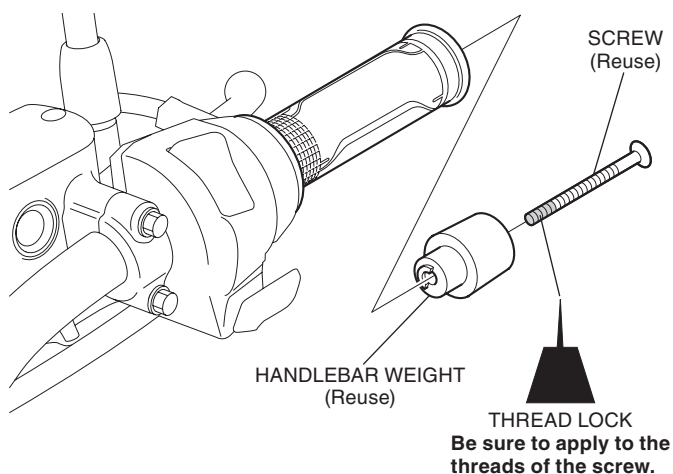

30. Twist the throttle grip as shown.

- **Check that the throttle opens and automatically closes smoothly.**

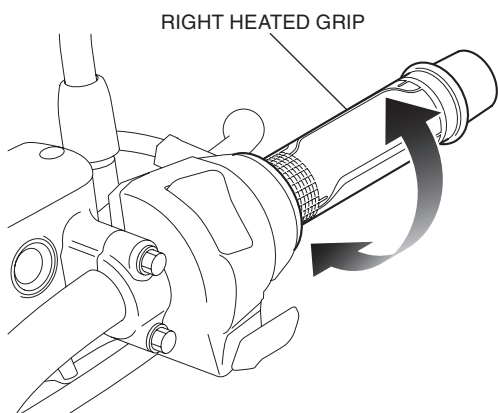

31. Remove the left grip as shown.

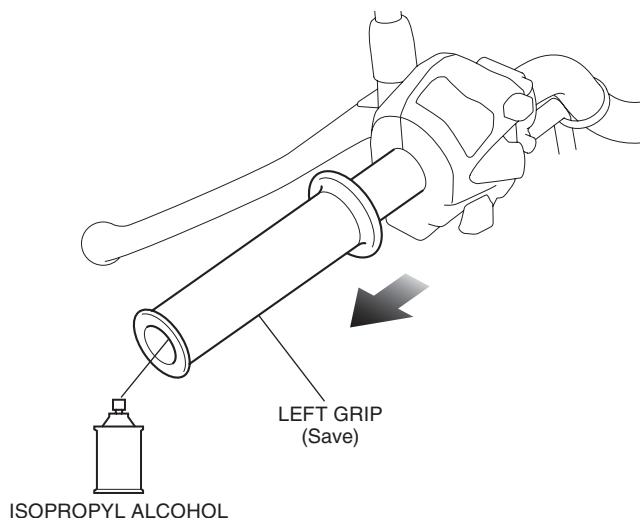

32. Using an isopropyl alcohol, remove all traces of adhesive from the left handlebar.

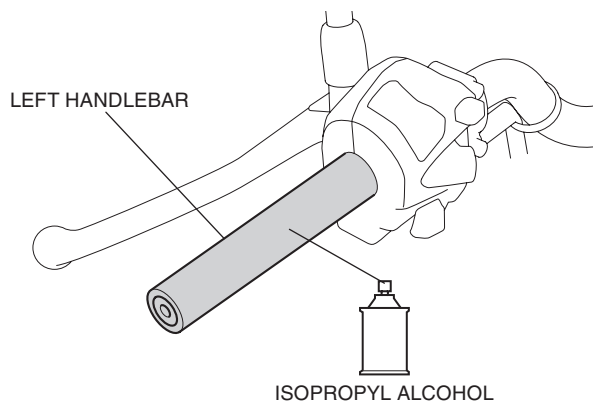

33. Liberally apply Pro Honda Handgrip Cement to the inside of the left heated grip from the kit as shown.

NOTE

Read the Instructions of the steps 33 through 36 carefully before installation and complete the operation quickly before the adhesive cures. Use an assistant to steady the motorcycle while installing the grip.

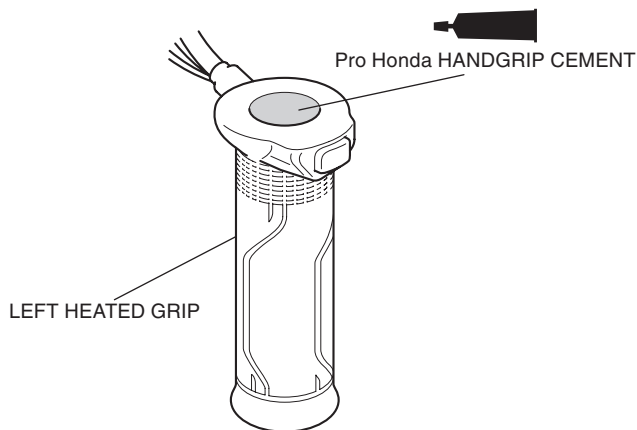

34. Apply Pro Honda Handgrip Cement to the left handlebar as shown.

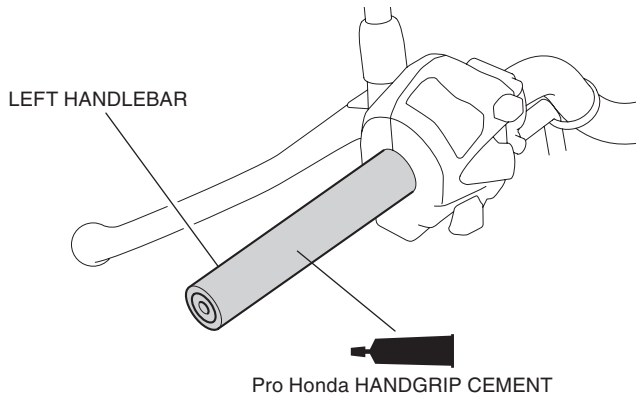

35. Spray isopropyl alcohol over the inside of the left heated grip and outside of the left handlebar.

- This is done to ease alignment between the heated grip and handlebar.

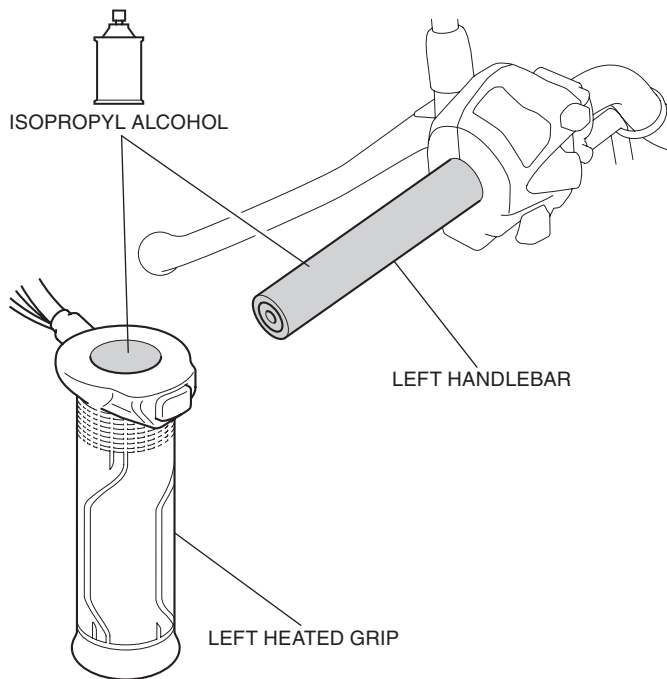

36. Slide the left heated grip onto the left handlebar as indicated.

- Wipe up excess adhesive at once.

NOTICE

- Do not tap on the grip end with a hammer and do not twist the grip with force to insert the left heated grip onto the handlebar, as it can damage the heated grip element.

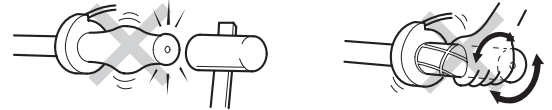

- Avoid putting pressure on the switch part when inserting the left heated grip. There is a possibility that the switch part will break. Also, install so that there is no gap with the left handlebar switch.



- If the grip gets stuck halfway during installation, apply isopropyl alcohol between the heated grip and handlebar. Do not try to remove the left heated grip using force or tools as the heated grip element can be damaged.

<NC700X>

Insert until there is contact with the left handlebar switch, then align with the indicated position.

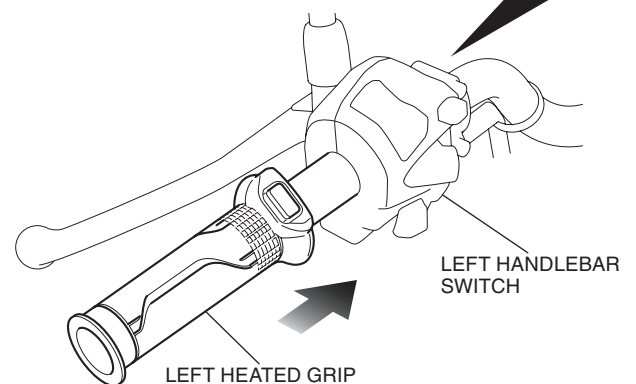
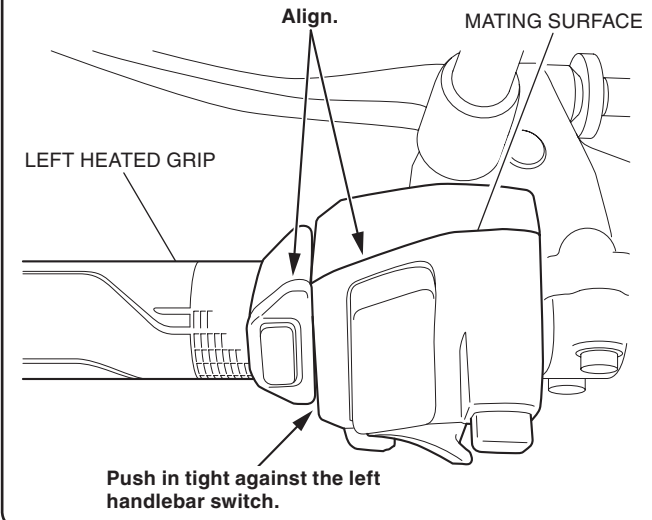

<NC700XD>

Insert until there is contact with the left handlebar switch, then align with the indicated position.

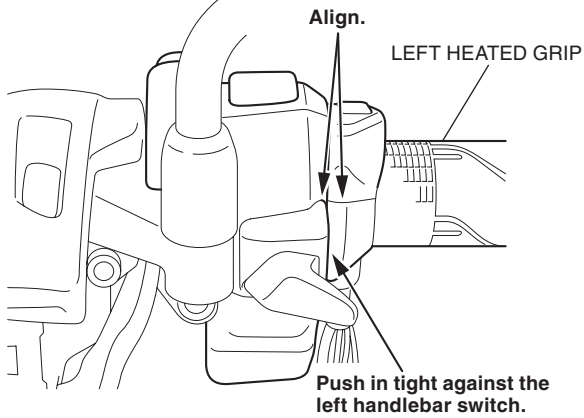

37. Reinstall the handlebar weight as shown.

- Before applying thread lock, thoroughly clean the screw.

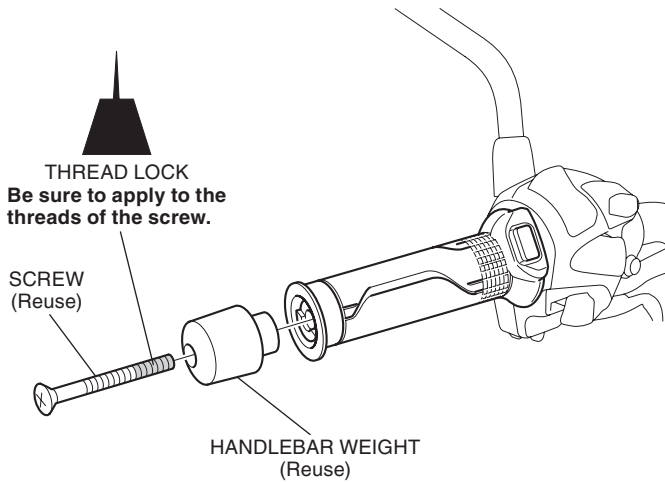

38. Route and secure the heated grip harness as shown.

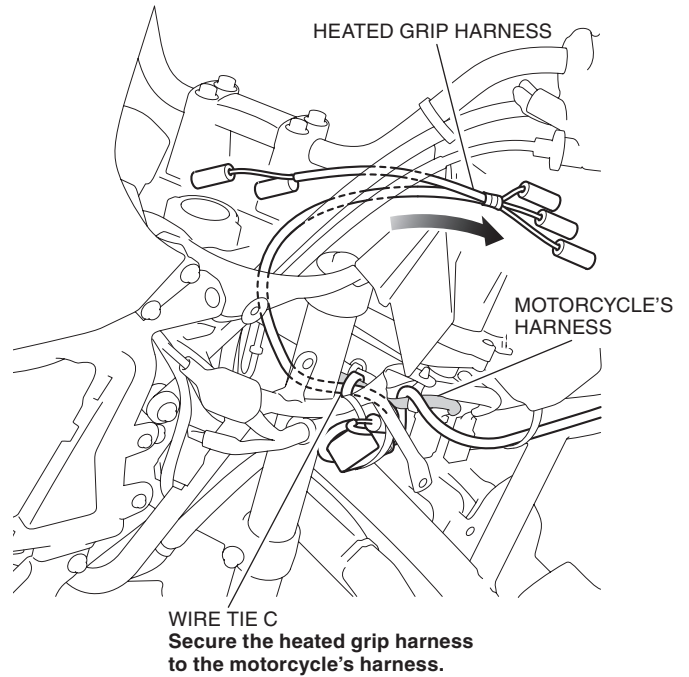

39. Connect the heated grip harness as shown.

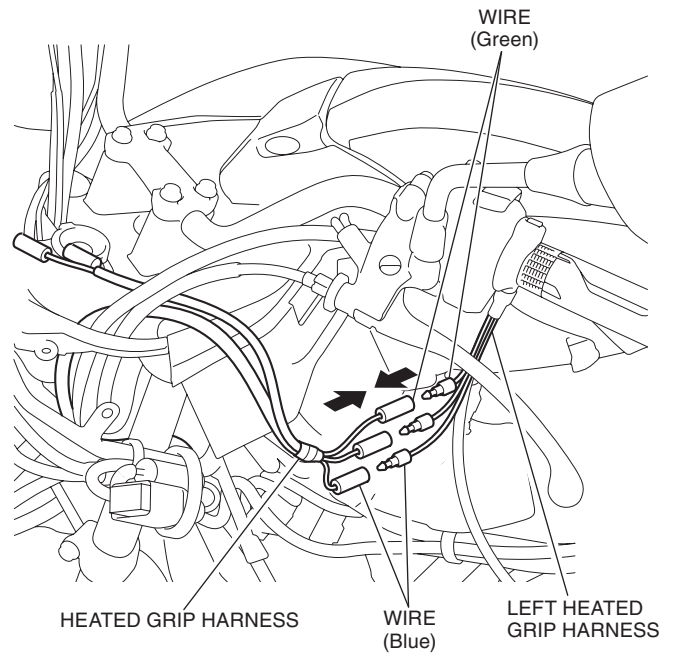

40. Wrap each harness with electrical tape as shown.

ELECTRICAL TAPE

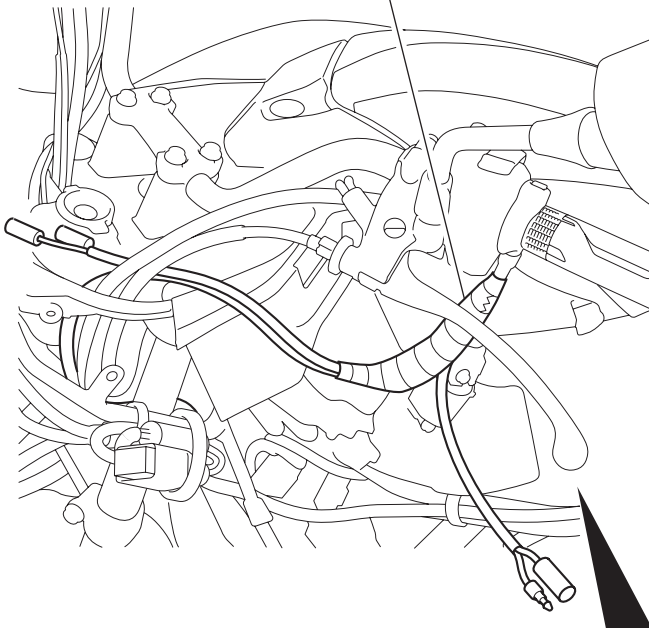

RUBBER

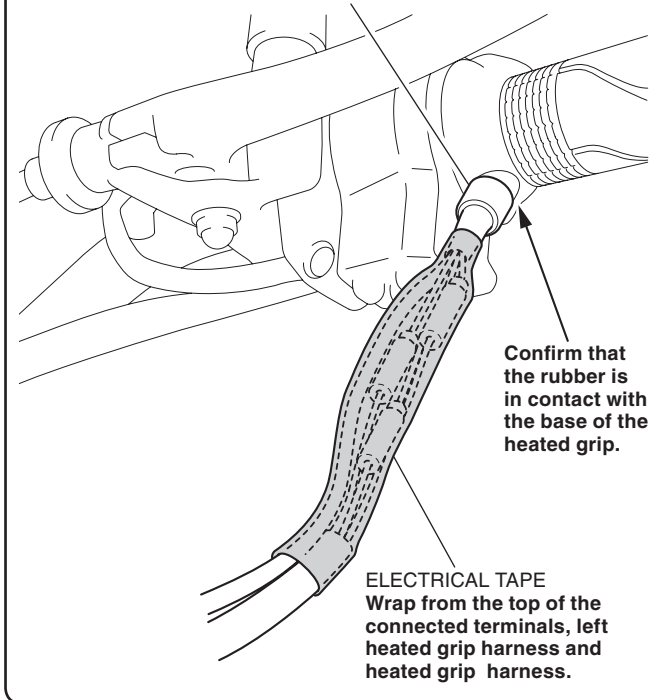

Confirm that the rubber is in contact with the base of the heated grip.

ELECTRICAL TAPE
Wrap from the top of the connected terminals, left heated grip harness and heated grip harness.

41. Secure each harness with the wire ties as shown.

- Secure while the handlebar is turned right fully. After securing, move the handlebar right and left and check that the harnesses are not pinched by the neighboring components and that they are not pulled taut.

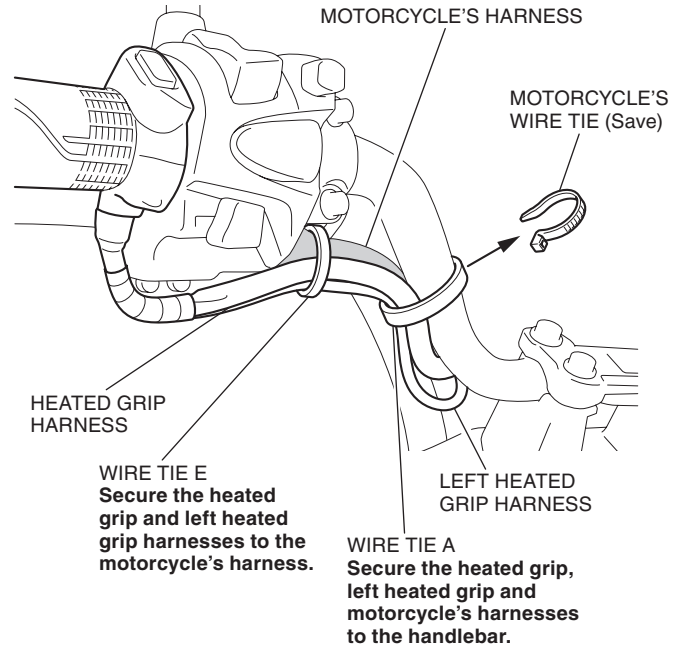

MOTORCYCLE'S HARNESS

MOTORCYCLE'S WIRE TIE (Save)

HEATED GRIP HARNESS

WIRE TIE E
Secure the heated grip and left heated grip harnesses to the motorcycle's harness.

LEFT HEATED GRIP HARNESS

WIRE TIE A
Secure the heated grip, left heated grip and motorcycle's harnesses to the handlebar.

42. Connect each harness as shown.

HEATED GRIP HARNESS

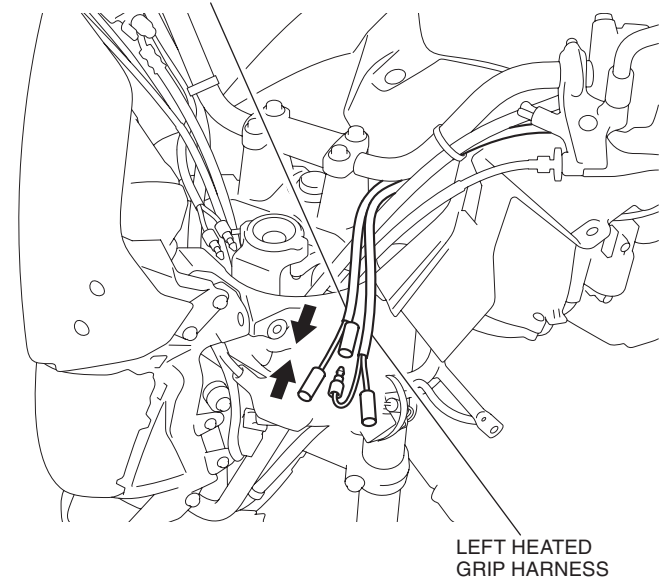

LEFT HEATED GRIP HARNESS

43. Route and connect the right heated grip harness as shown.

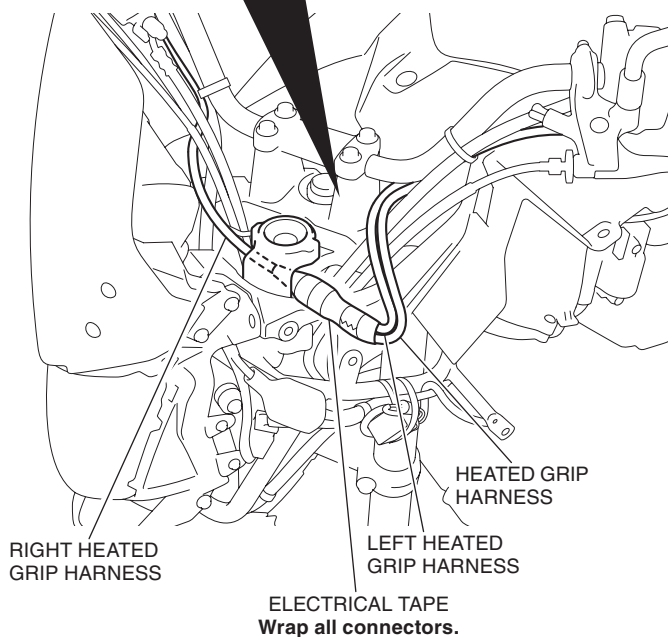
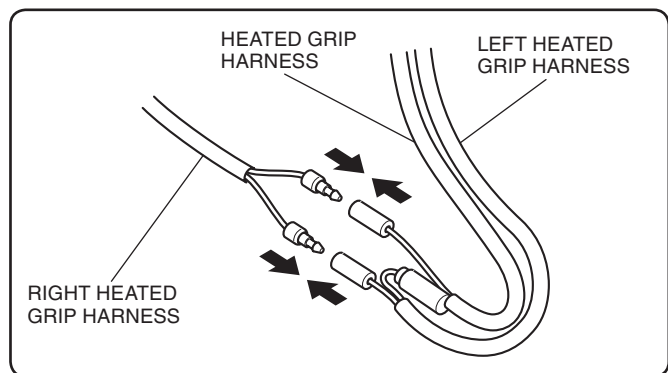

44. Secure each harness with the wire ties as shown.

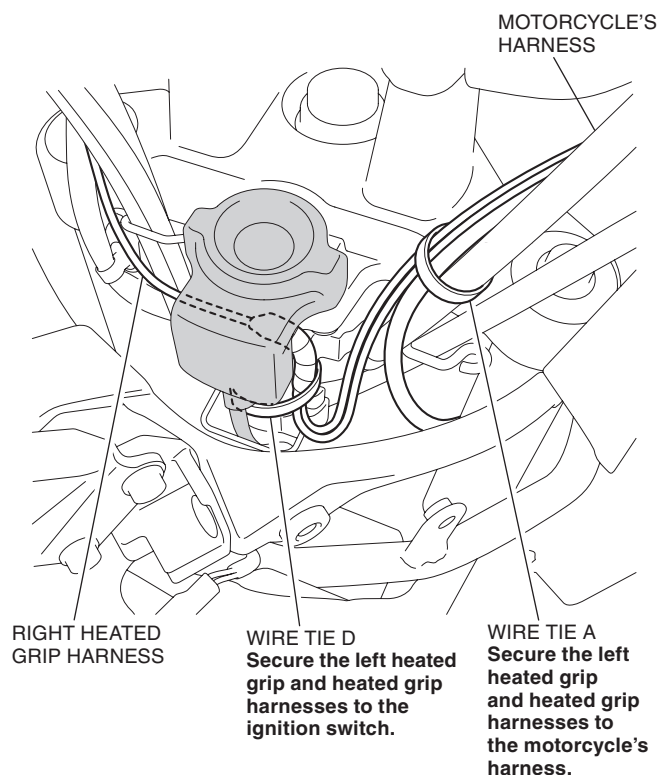

45. Secure the right heated grip harness as shown.

- **Open and close the throttle and confirm that there is no tightness of the heated grip harness.**

<NC700X>

MOTORCYCLE'S WIRE TIE (Reuse)
Secure the right heated grip harness together with the motorcycle's harness.

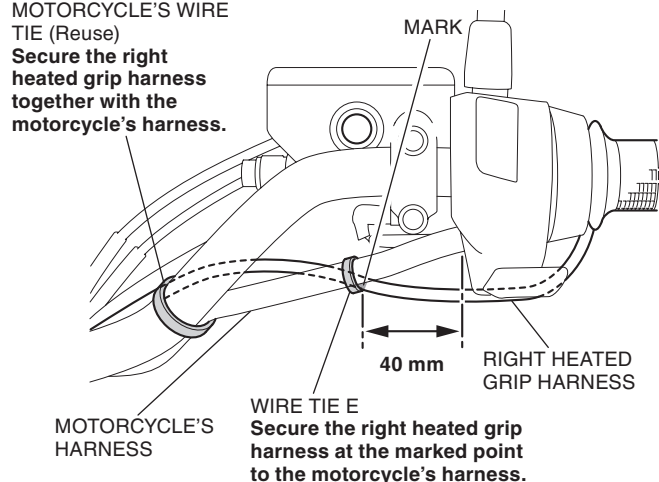

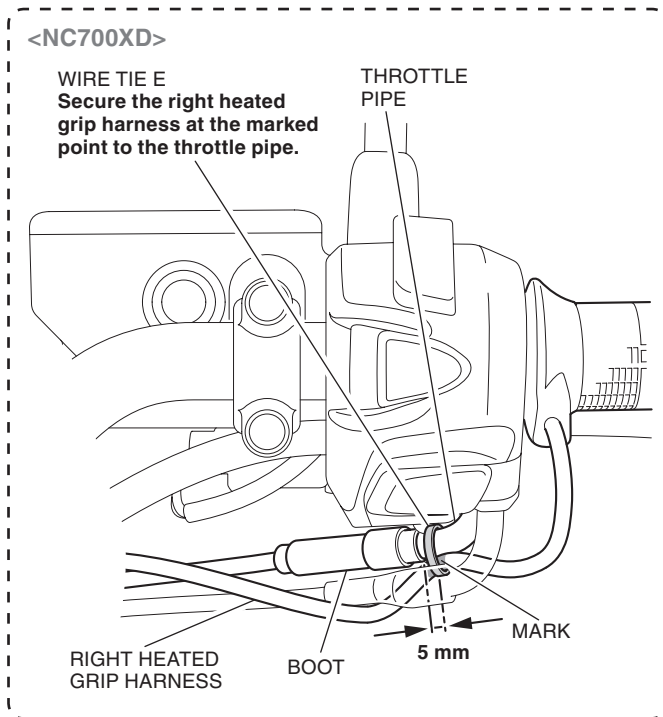

46. Check each harness for sufficient freeplay.
- **Move the handlebar right and left and check that the harnesses are not pinched by the neighboring components and that they are not pulled taut.**
47. Install the motorcycle's parts in the reverse order of removal.
- **Confirm that the harness is not caught or too tight.**

DEALER TROUBLESHOOTING

- Stop the engine and turn the ignition switch OFF when you check the parts and circuits other than those of the heated grips.

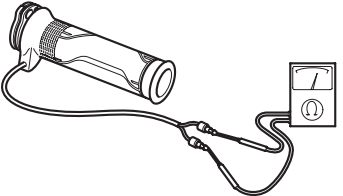
| Symptom | Check |
|---|---|
| Heated grip does not operate; • Faulty heated grip • Faulty heated grip coil • Blown fuse • Open or short circuit in heater harness • Faulty heater switch | <ol style="list-style-type: none"> 1. Check whether wires and cables (terminals and connectors) are connected securely. 2. Heated grip inspection Check for resistance between the terminals. ➔ Standard: Right : 2.2 ohms +/- 10% Left : 2.2 ohms +/- 10%  3. Heater harness inspection: Check for continuity. 4. If no abnormality is found after the above checks 1, 2, and 3, but the heated grip still does not operate properly, replace the heater switch with a new one. <ul style="list-style-type: none"> • It is hard to check the switch with ordinary inspection methods (for continuity, voltage, etc.) because it contains an integrated circuit. |