

HONDA

INSTALLATION INSTRUCTIONS

Accessory
HEATED GRIP ATTACHMENT
P/N 08T70-MGC-D30

Application
CB1100/A

Publication No.
MII 14236
 Issue Date
September 2012

PARTS LIST

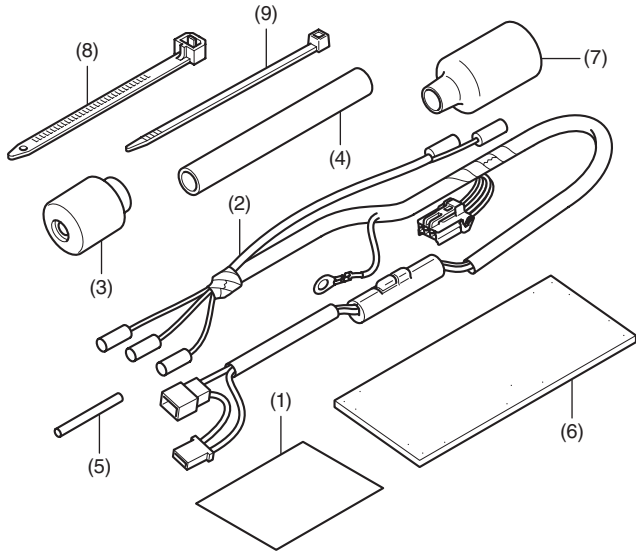

No.	Description	Qty
(1)	User Information URL	1
(2)	Heated grip harness	1
(3)	Handlebar weight	2
(4)	Tube (large)	1
(5)	Tube (small)	1
(6)	Cushion tape	1
(7)	Harness boot	1
(8)	Wire tie (wide)	3
(9)	Wire tie (narrow)	7

TOOLS AND SUPPLIES REQUIRED

- Flat-tip screwdriver
- Side cutters
- Marker
- Scale
- Electrical tape
- Honda bond A or Pro Honda Handgrip Cement
- Thread lock
- Grease
- Isopropyl alcohol
- Shop towel

TORQUE CHART

Refer to the Service Manual for the torque values of the removed parts.

HEATED GRIPS KIT (Sold separately)

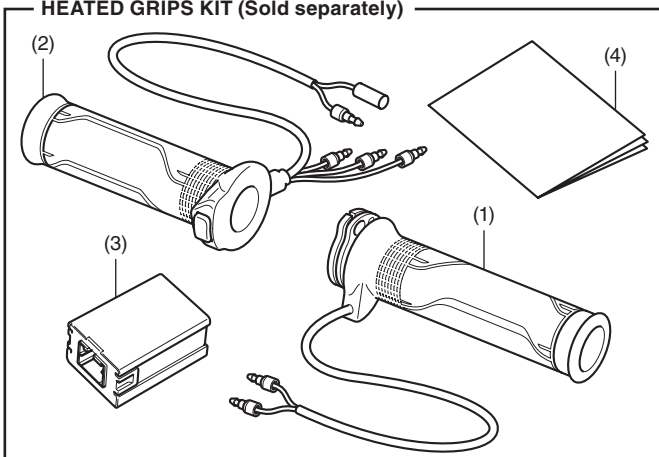

No.	Description	Qty
(1)	Right heated grip	1
(2)	Left heated grip	1
(3)	Controller	1
(4)	Operation Manual	1

INSTALLATION

⚠ CAUTION

- To prevent burns, allow the engine, exhaust system, etc. to cool before installing the accessory.
- Be sure to observe all safety messages and precautions described in the Service Manual while removing and installing the fuel tank.

NOTE:

- The Heated Grip Kit is required for installation of this accessory.
- Disconnect the throttle cable from the right grip as instructed in the motorcycle's Service Manual.
- For secure adhesion of the heated grips use the recommended adhesive agent (Honda Bond A) or equivalent.
- Be sure to open and close the throttle to check for smooth operation after installation of the right heated grip.
- Disconnect the negative (-) cable from the battery before installing this accessory.
- The memories of the tripmeter and clock will be erased when you disconnect the battery. Reset the clock after reconnecting the battery.
- Reinstall the removed parts on the motorcycle and make sure that the wires and harnesses are not pinched.
- Trim the excess ends off the wire ties after attaching them to the wire harnesses. Do not allow the cut part of the wire tie to interfere with another harness or brake hose.
- After handlebar switch and heated grip installation, check the lights (e.g. right / left turn signal lights and brake lights) for proper operation.

When removing the fuel hose from the fuel pump, be sure to replace the retainer and rubber with new ones. Be sure to refer to the Service Manual and cover the joint with a plastic bag or similar to prevent dust from fouling the connector and fuel pump while performing this work.

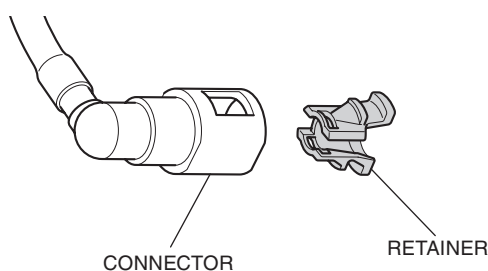

1. Remove the motorcycle's parts as shown, and disconnect the negative (-) cable from the battery.

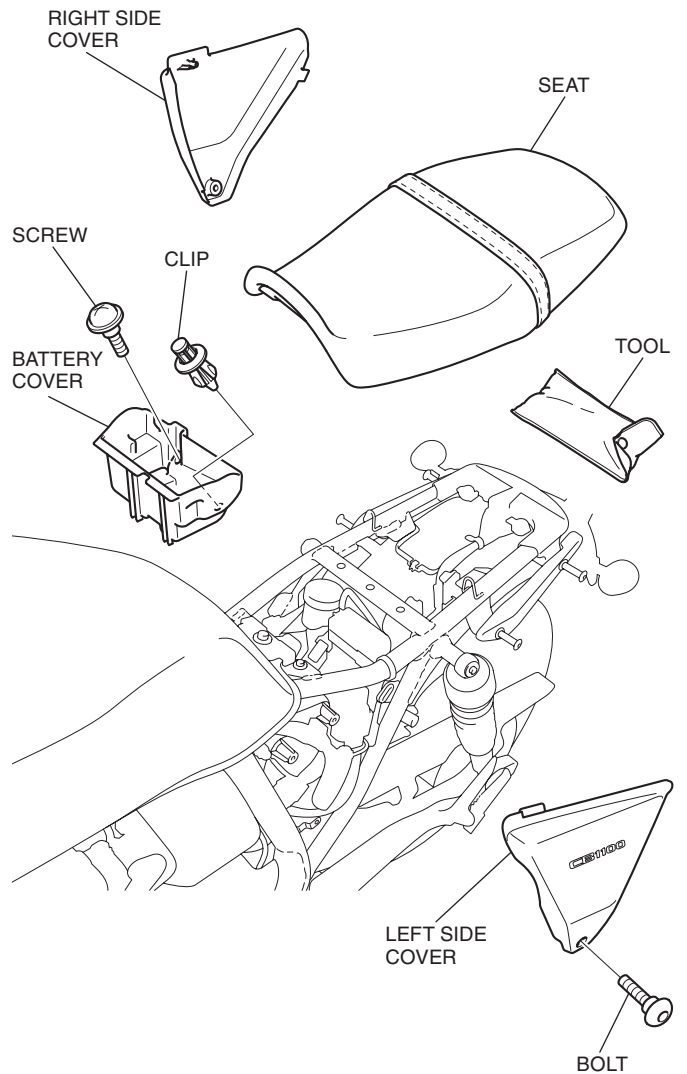

2. Remove the bolts and tilt the headlight to the front.

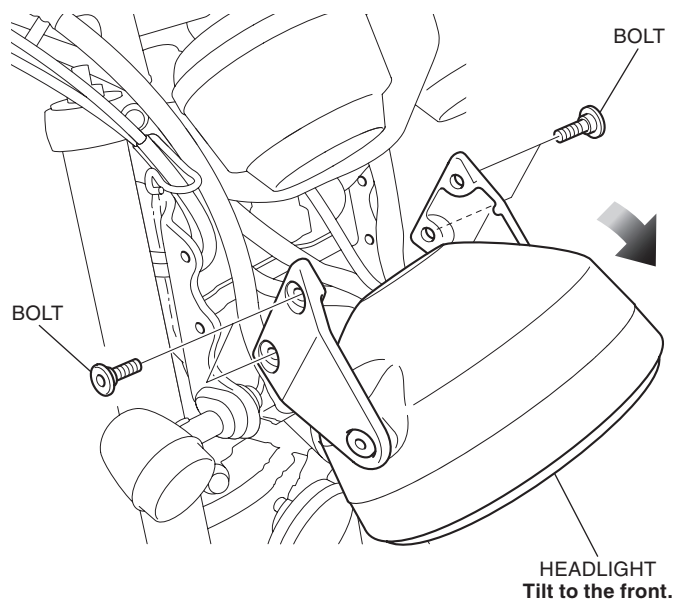

3. Remove the fuel tank as shown.

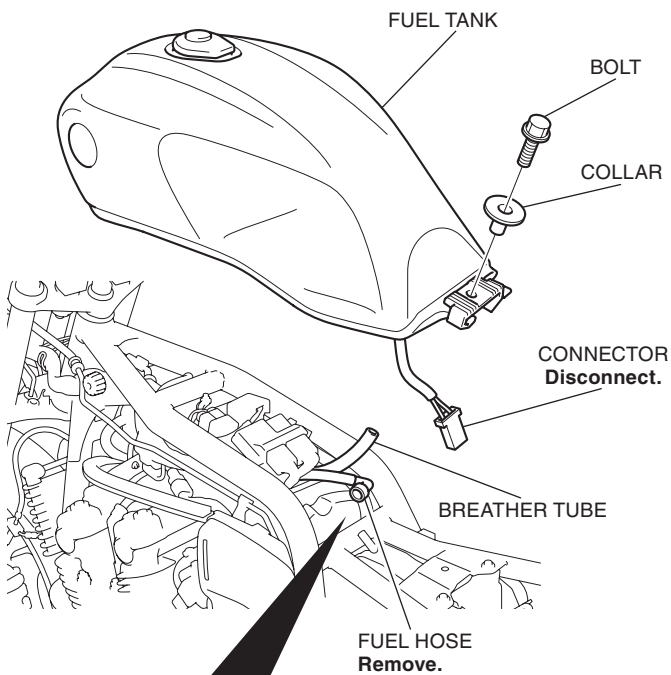

Refer to the Service Manual for removal and installation, be sure to replace the retainer with a new one.

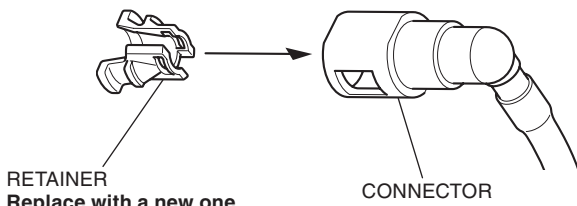

4. Remove the handlebar weight as shown.

- Repeat on the right side.

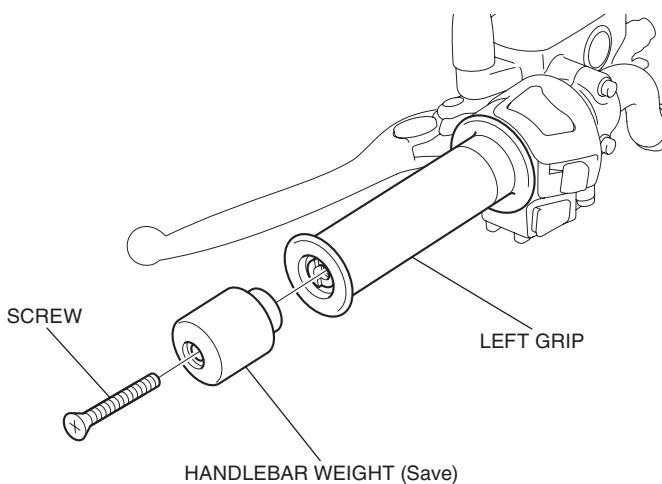

5. Remove the left grip as shown.

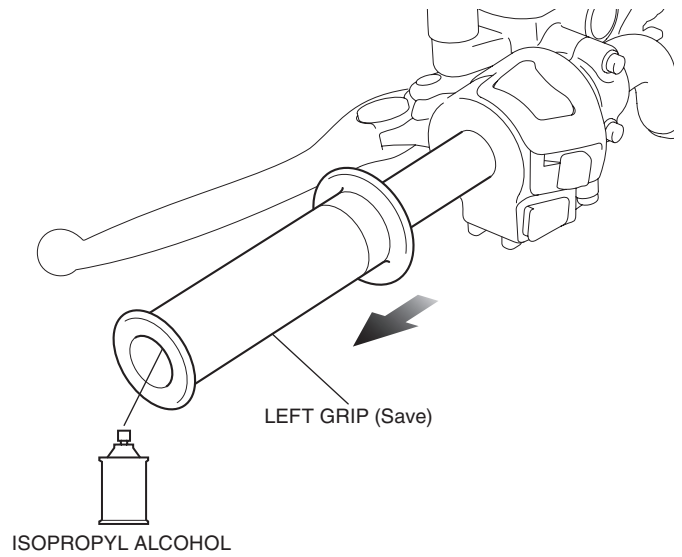

6. Using isopropyl alcohol, remove all traces of adhesive from the left handlebar pipe.

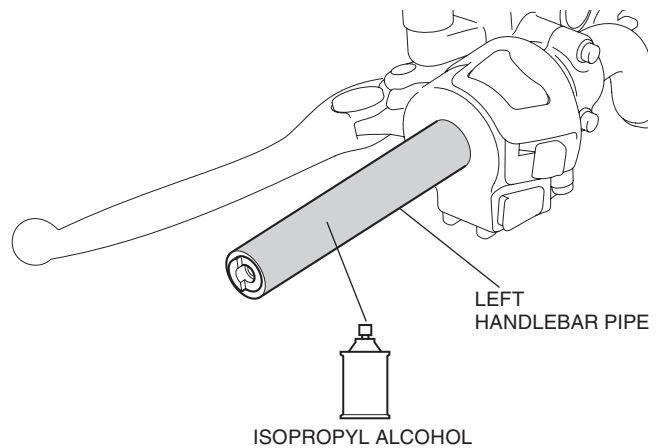

7. Liberally apply the Honda bond A to the inside of the left heated grip as shown.

NOTE

Read the Instructions of the steps 7 through 10 carefully before operation and complete the installation quickly before the adhesive agent cures. Use an assistant to steady the motorcycle while installing the grips.

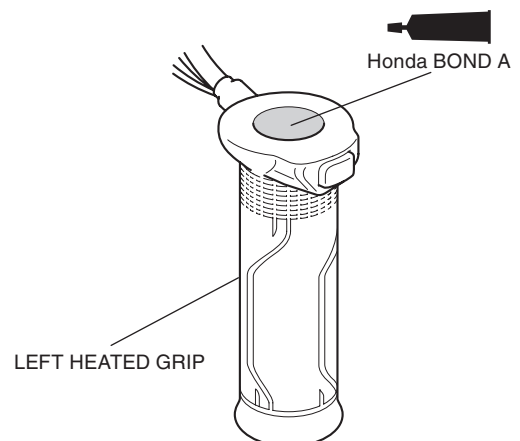

8. Apply Honda bond A to the left handlebar pipe as shown.

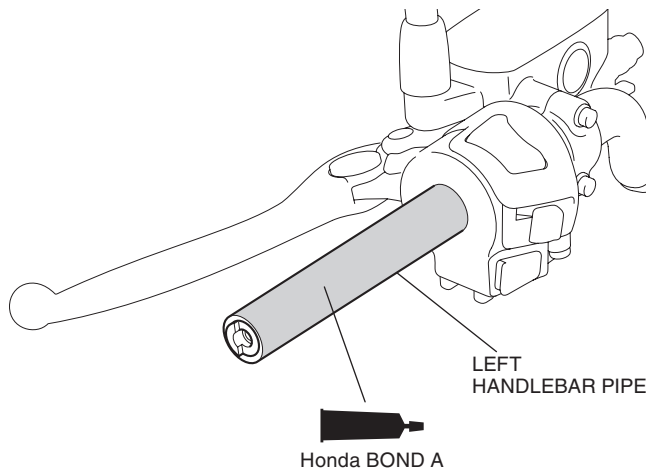

9. Spray isopropyl alcohol over the inside of the heated grip and outside of the left handlebar pipe.

- This is done to ease alignment between the heated grip and the handlebar.

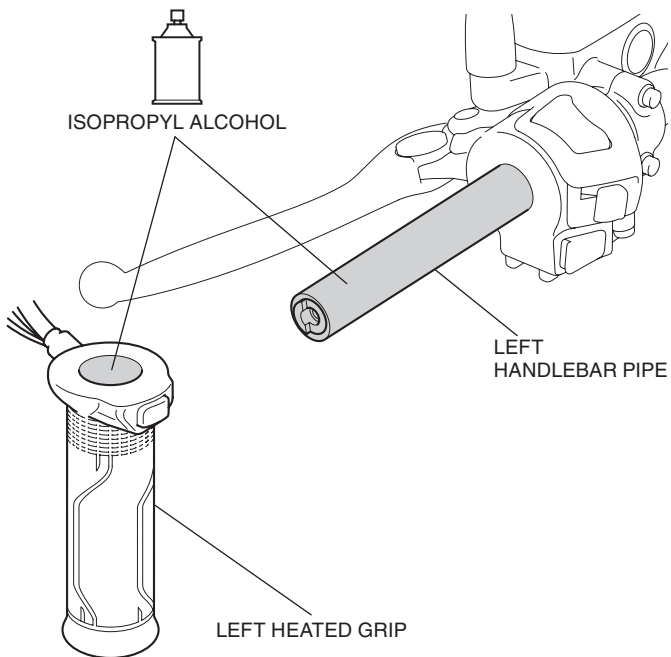

10. Slide the left heated grip onto the left handlebar as indicated.

- Wipe up excess adhesive at once.

NOTICE

- Do not tap on the grip end with a hammer and do not twist the grip to install the heated grip onto the handlebar, as it can damage the element.

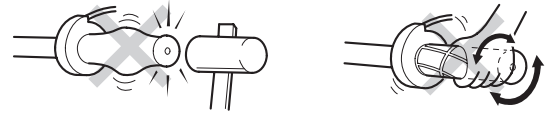

- Avoid putting pressure on the switch part when inserting the left heated grip. There is a possibility that the switch part will break. Also, install so that there is no gap with the switch holder.



- If the grip gets stuck halfway during installation, apply isopropyl alcohol to the gap between the heated grip. Do not try to remove the heater grip using force or a screwdriver, etc. Damage to the heated grip wire can result.

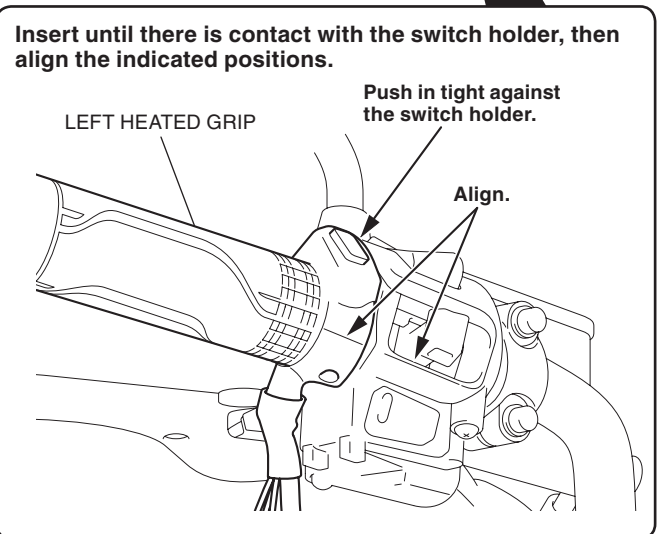
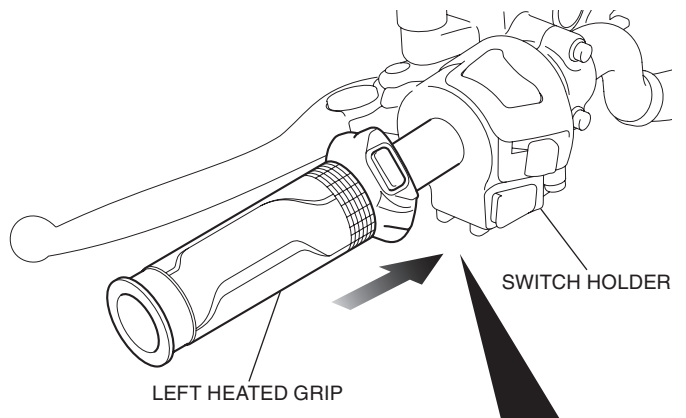

11. Remove the indicated parts.

<Right side>

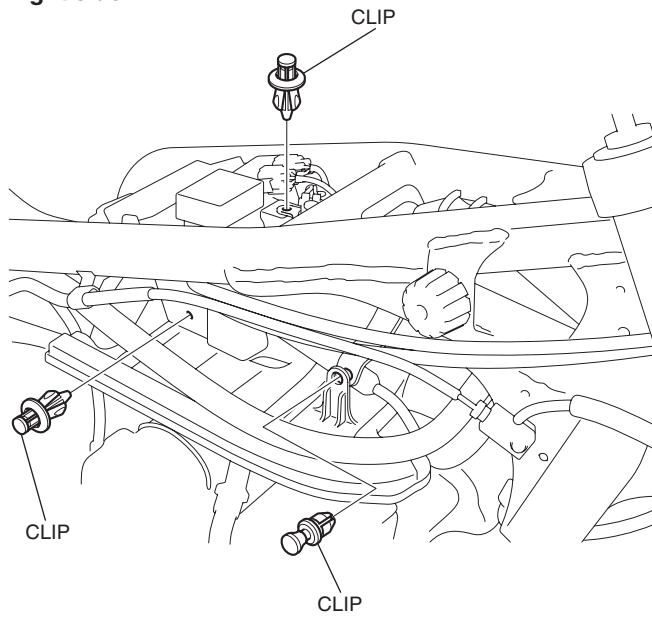

12. Remove the clips as shown and disconnect indicated connector.

<Left side>

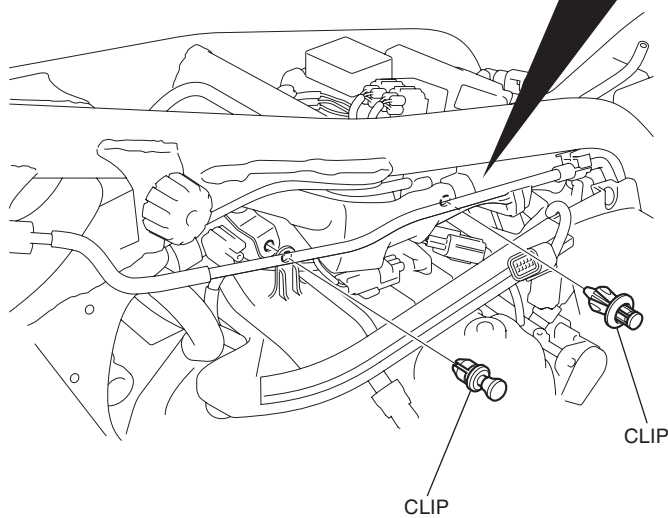
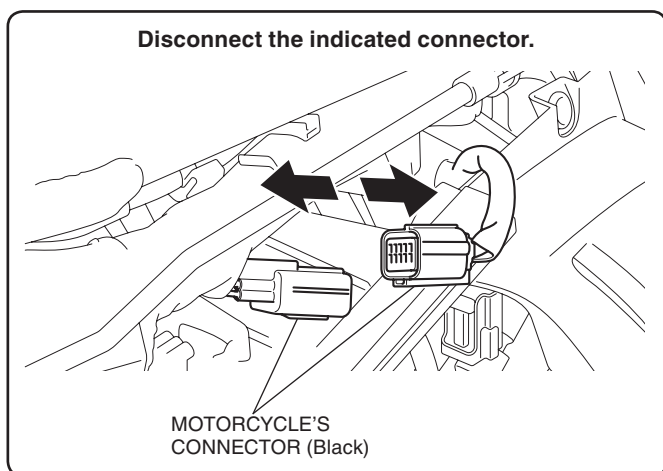

13. Move the indicated parts as shown.

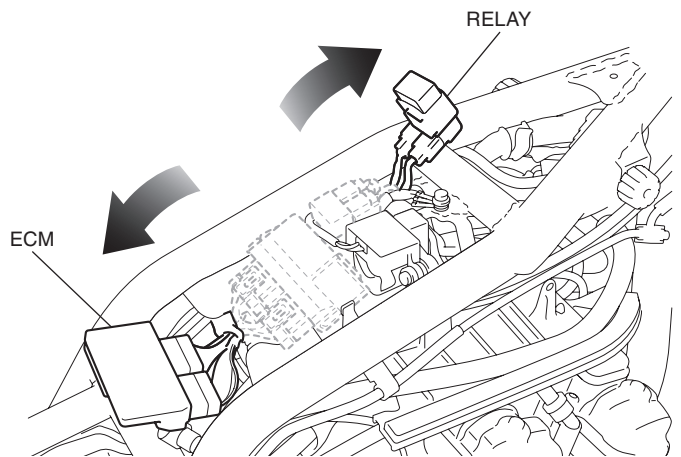

14. Remove the rubber as shown.

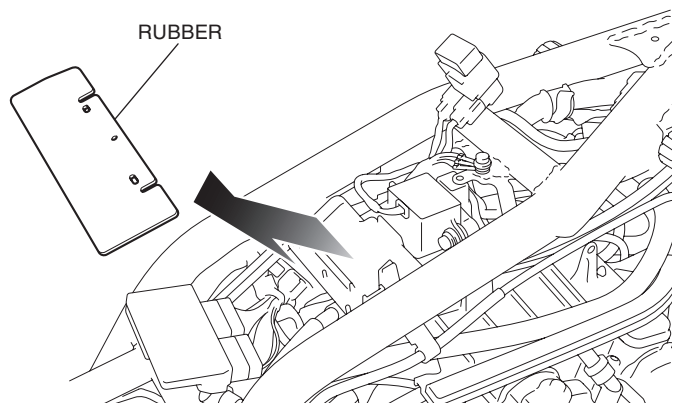

15. Pull out the cover as shown.

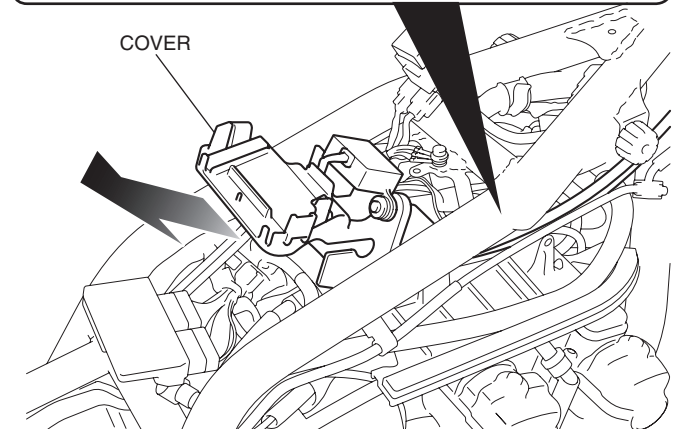
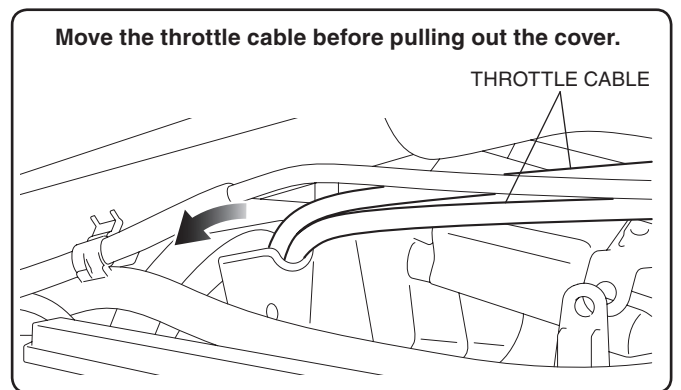

16. Move the cover as shown.

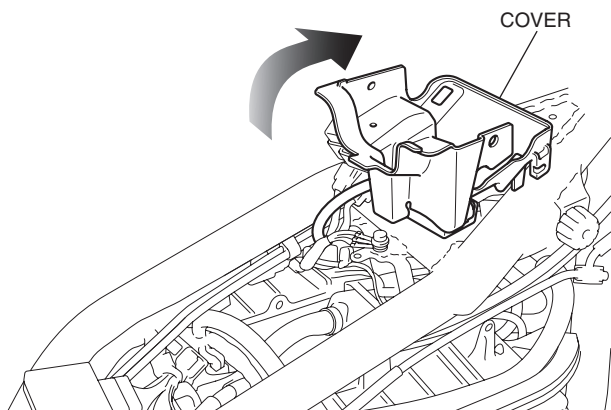

17. Remove the large and small hoses as shown.

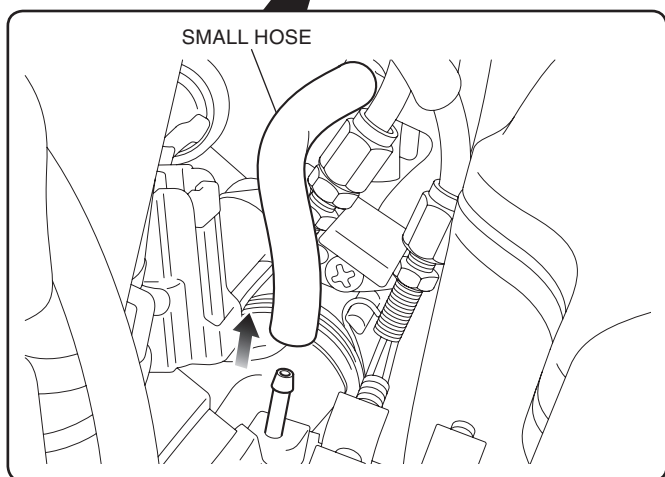
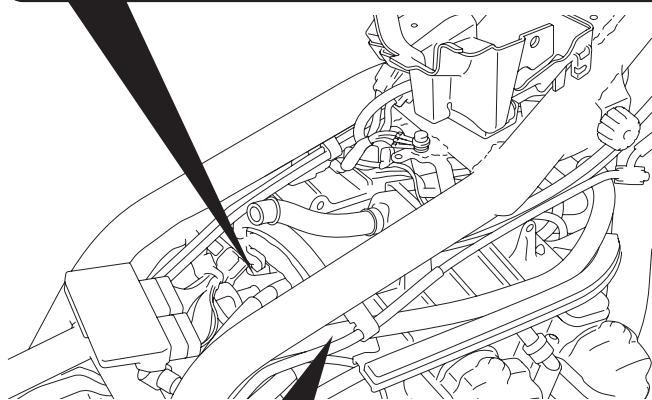
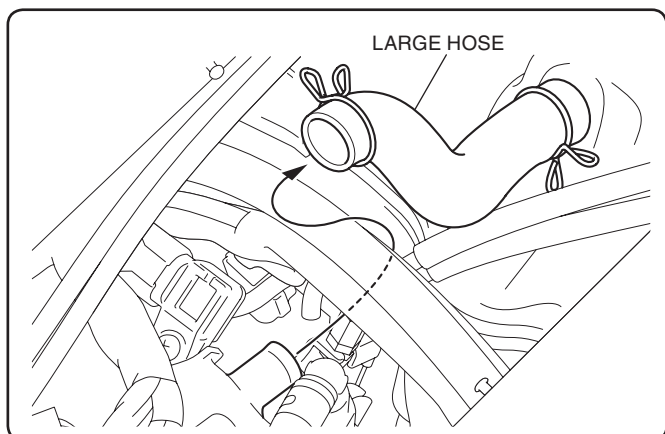

18. Adjust the throttle cable as shown.

- Reinstall the removed hoses after tightening.

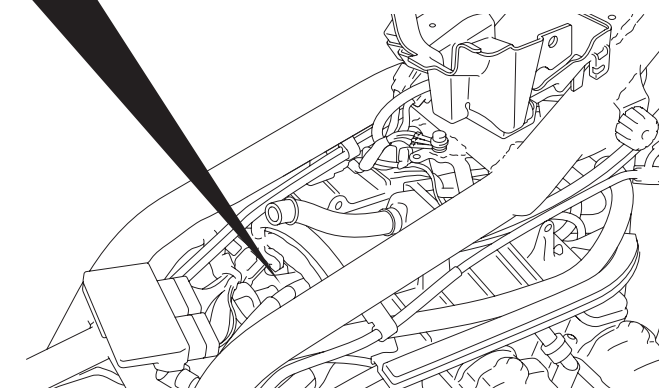
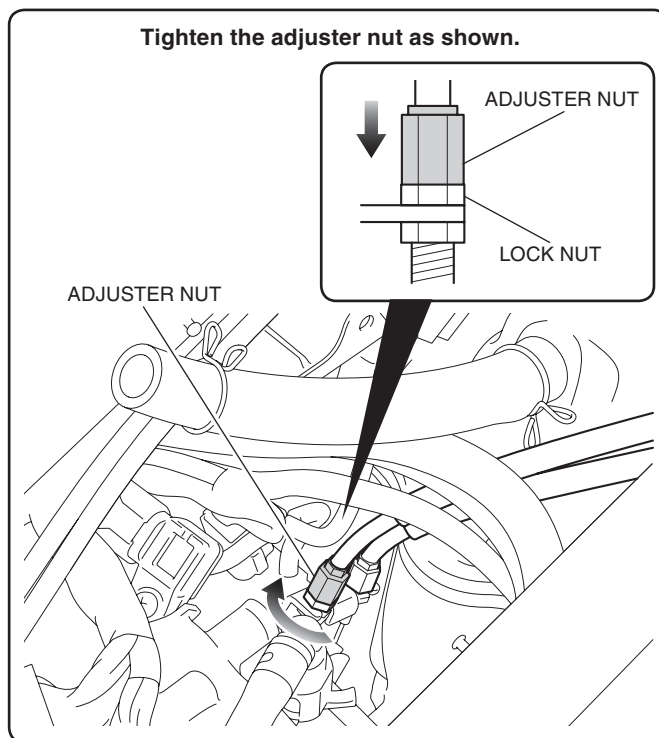

19. Turn the nut of throttle cable as shown.

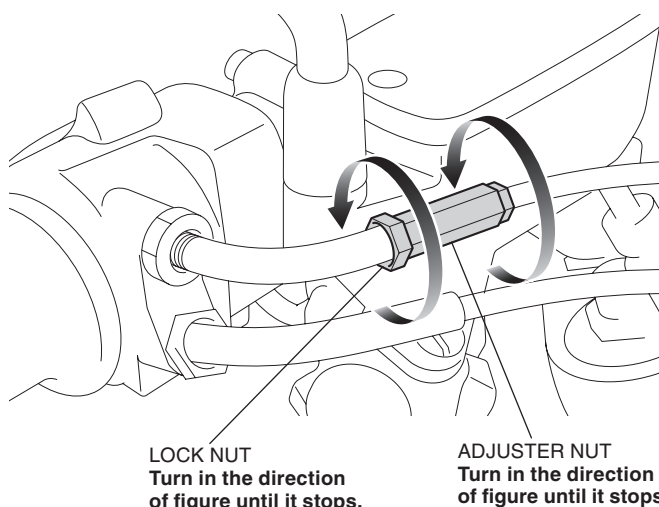

20. Loosen the indicated nuts.

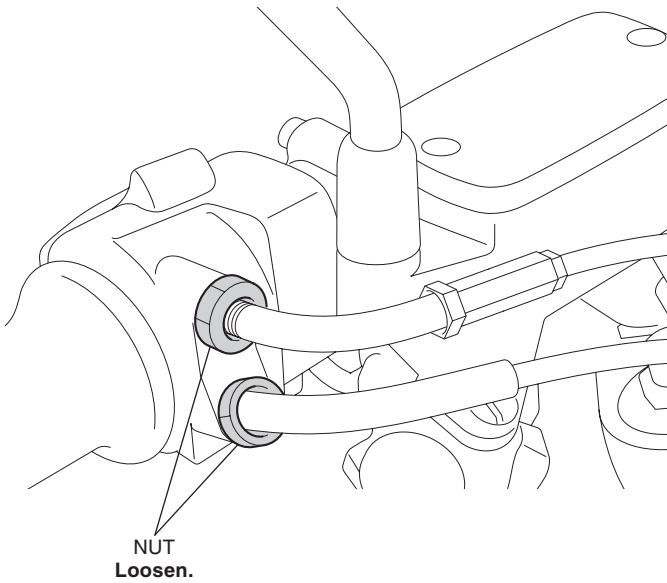

21. Remove the indicated screws.

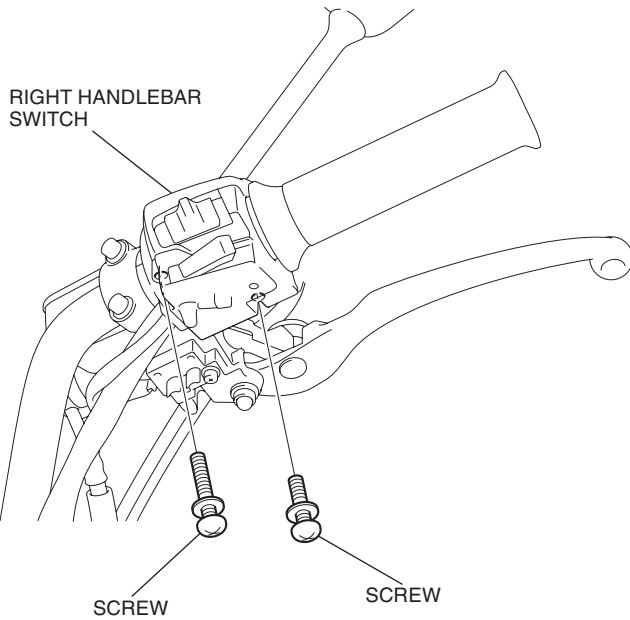

22. Remove the right grip as shown.

NOTE

Disconnect the throttle cable from the right grip as instructed in the motorcycle's Service Manual. Do not try to disconnect the cable with force using pliers, etc.

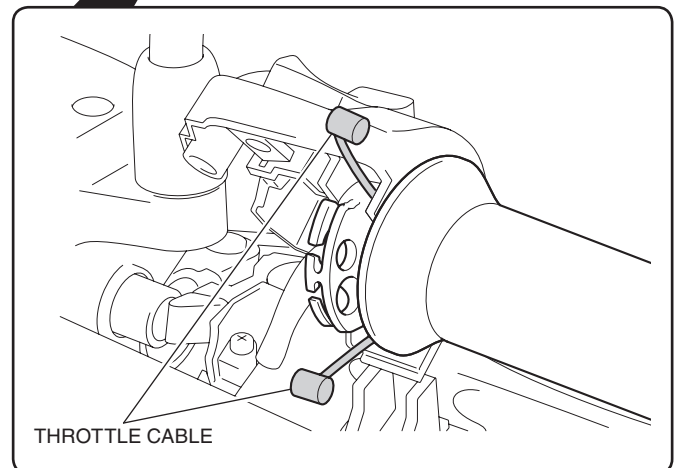
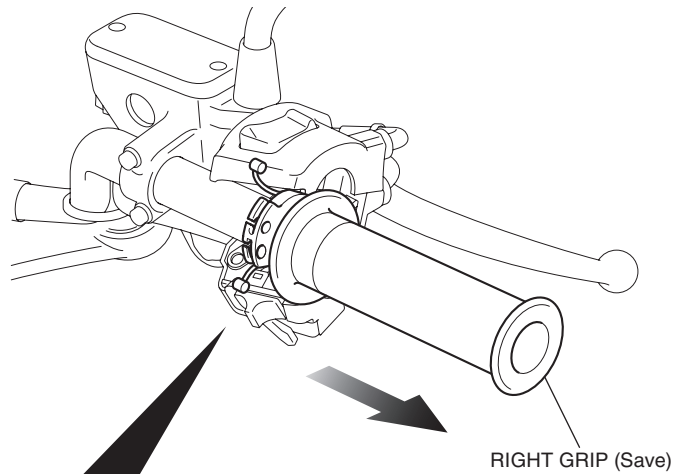

23. Mark the right heated grip harness in the position shown.

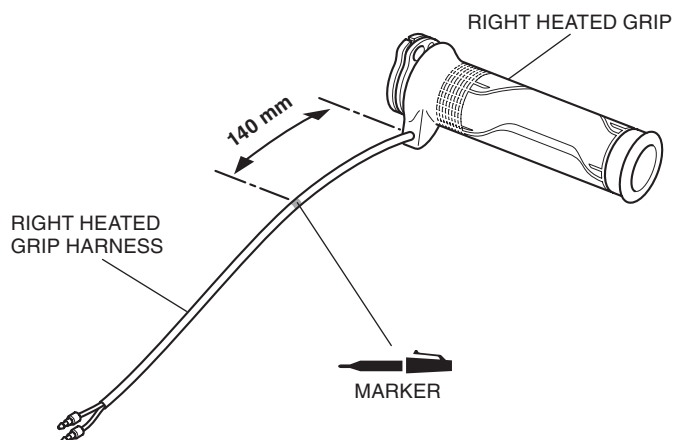

24. Remove the lower throttle cable as shown.

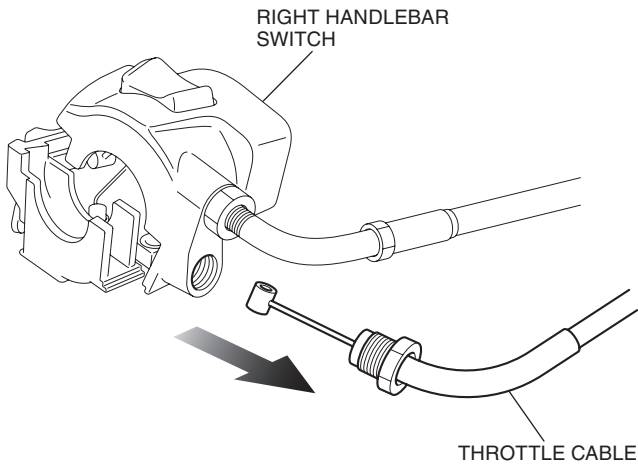

25. Remove the indicated nut.

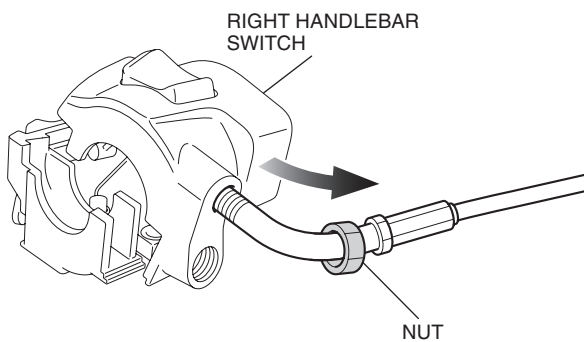

26. Turn the upper throttle cable once as shown.

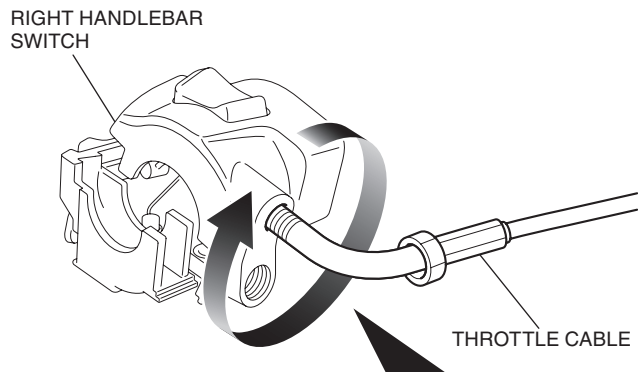

Check that the thread is within measurements in the figure after turning the throttle cable.

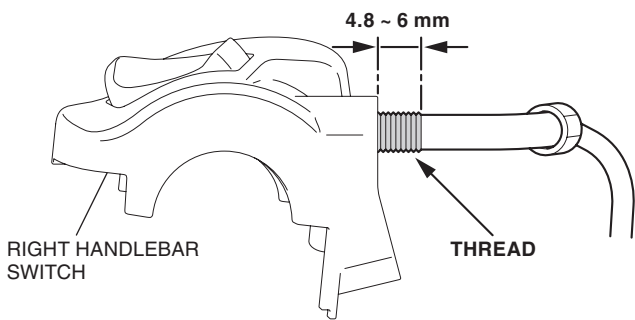

27. Install the lower throttle cable in the reverse order of removal.

28. Apply grease to the [] parts of the throttle cables and inner grip as shown.

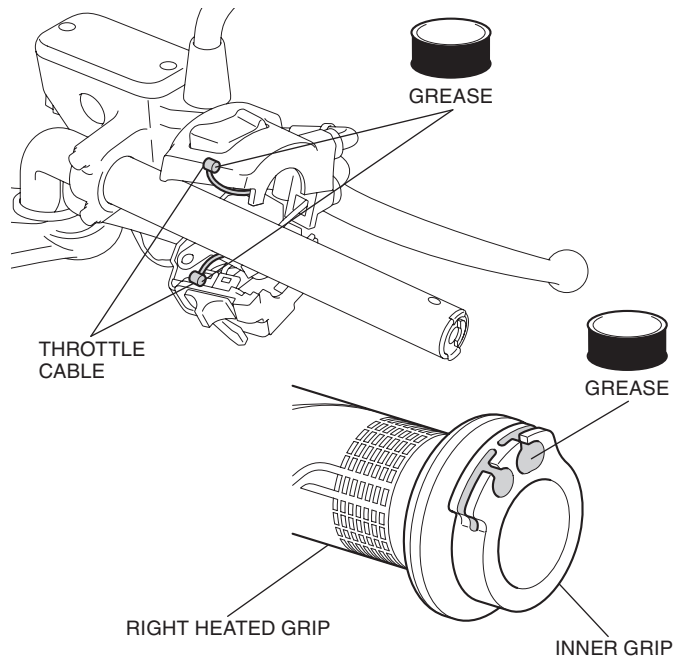

29. Install the right heated grip and right switch holder in the reverse order of removal.

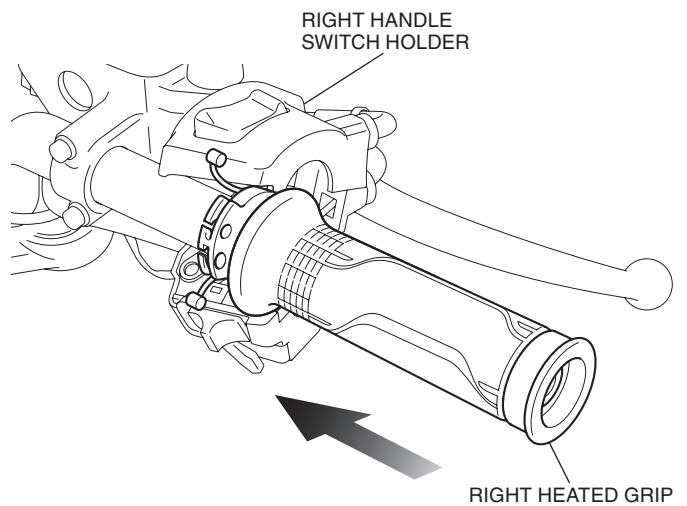

30. Mark the harness at the point of the dimension shown.

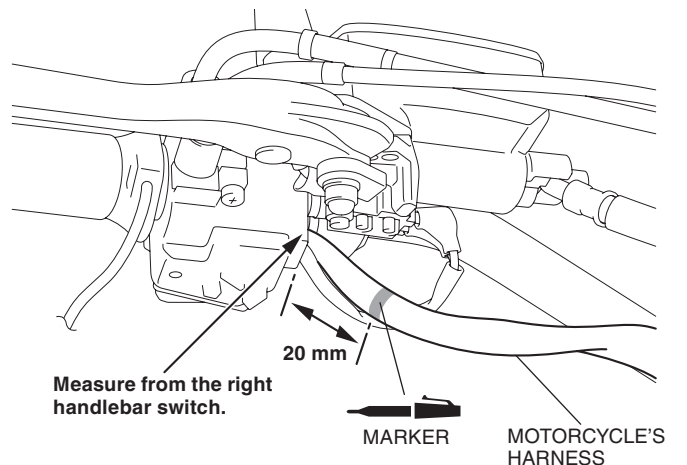

31. Route the right heated grip harness as shown and secure the harness with the wire tie.

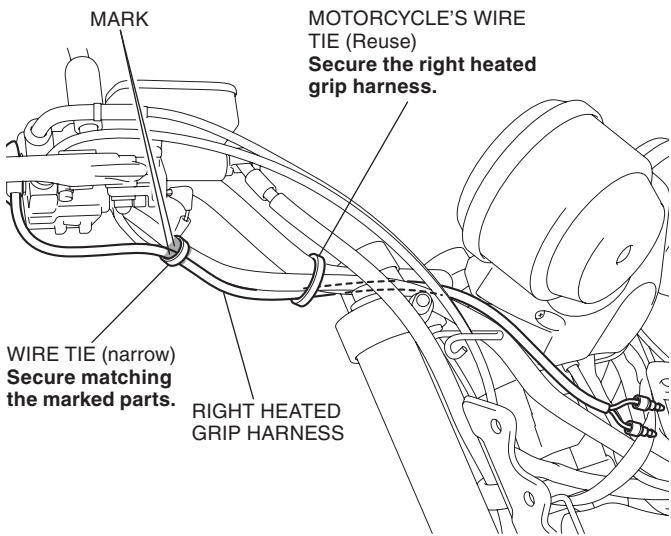

32. Adjust the throttle cable as shown.

- After installation, refer to the Service Manual and adjust the throttle freeplay.
- If there is insufficient throttle freeplay, perform steps 24 to 27.

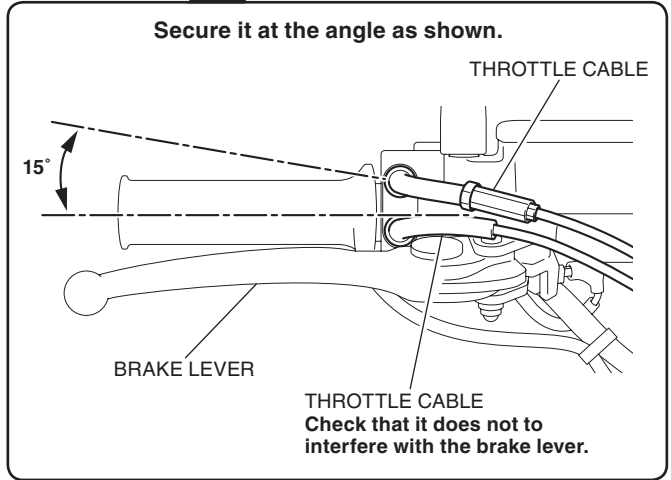
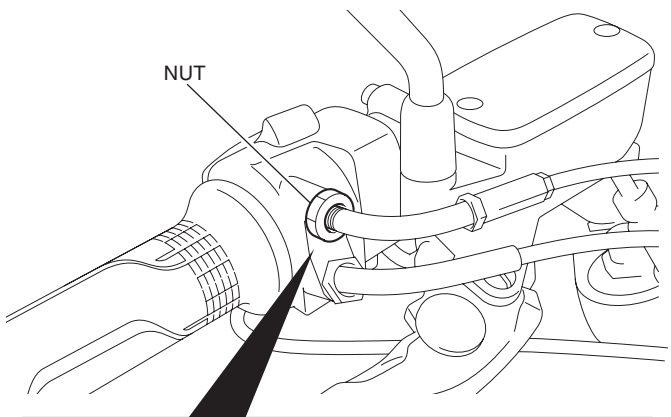

33. Twist the throttle grip as shown.

- Check for smooth opening of the throttle and that it automatically snaps closed from any opening, in all steering positions.

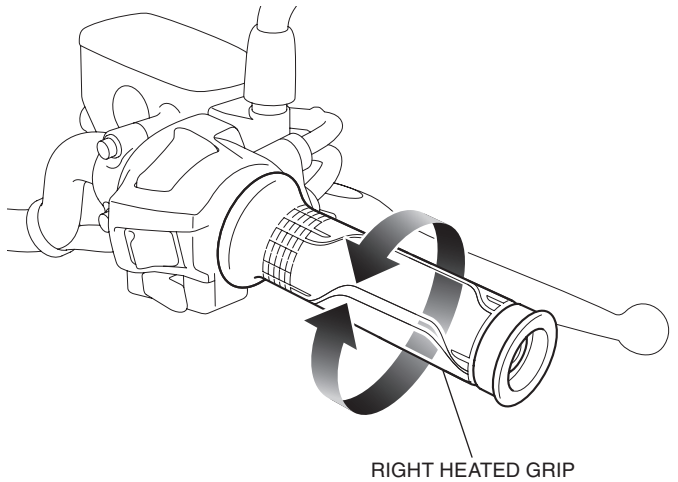

34. Install the cover, relay, ECM, and rubber in the reverse order of removal.

35. Connect the controller as shown.

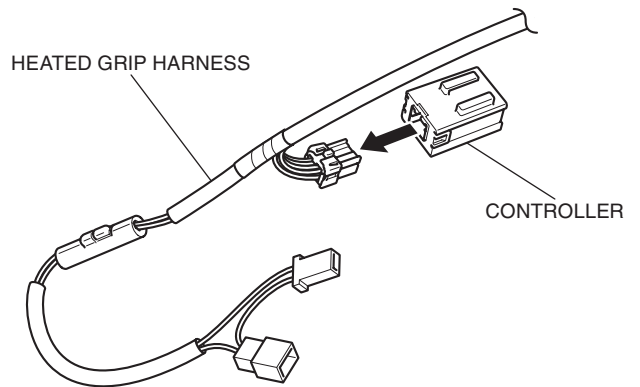

36. Wind the electrical tape as shown.

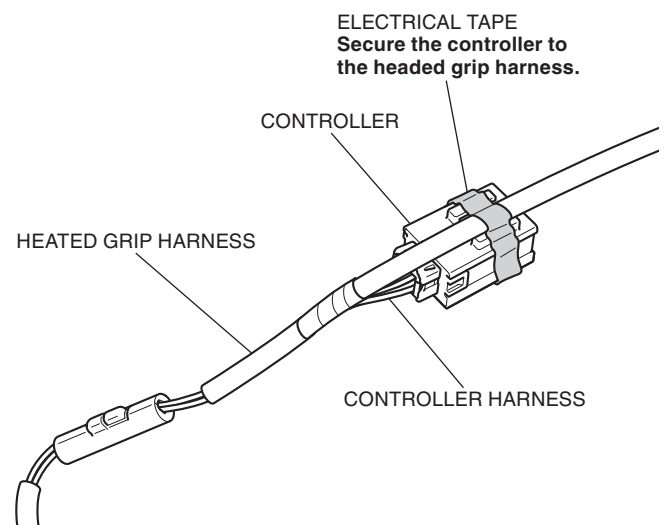

37. Fit the harness boot over the harness as shown.

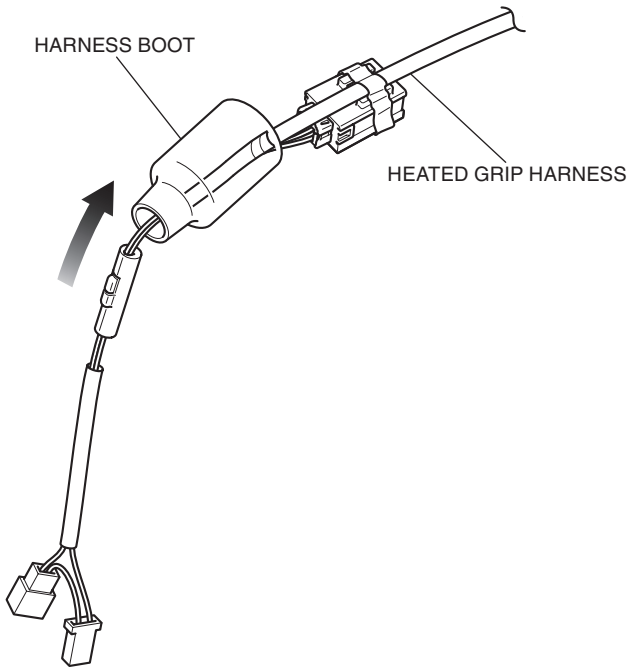

38. Fit the harness boot over the controller as shown.

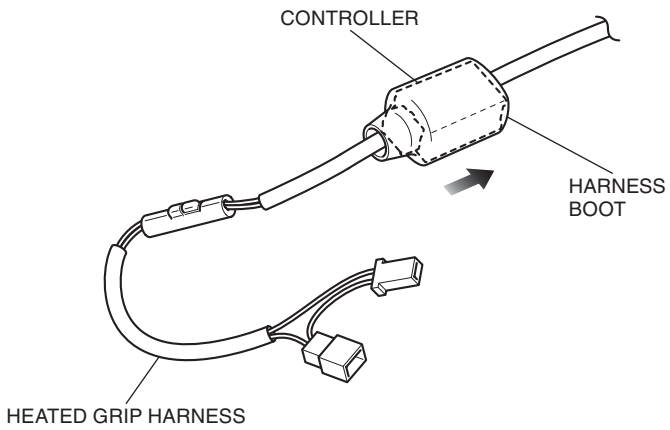

39. Clean the surface of harness boot shown using isopropyl alcohol.

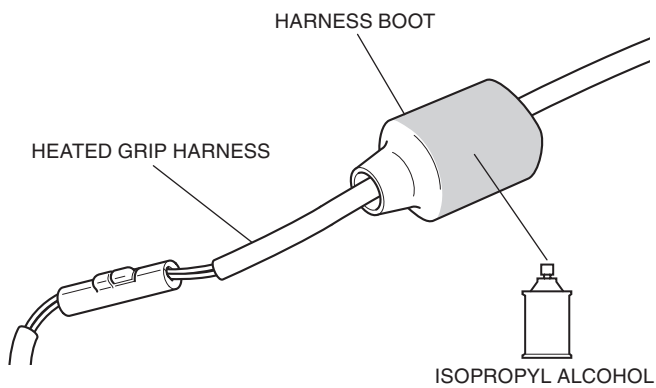

40. Attach the cushion tape to the harness boot as shown.

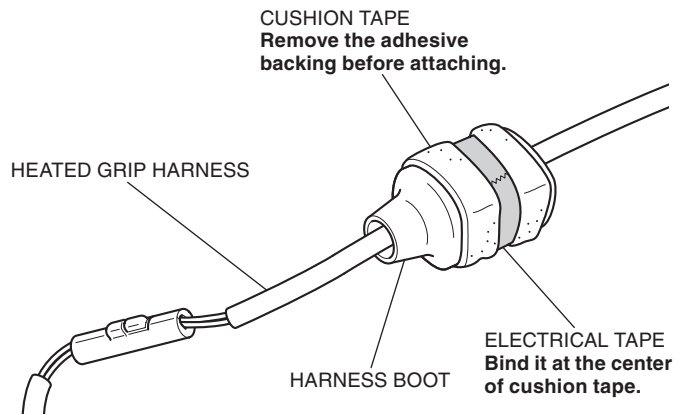

41. Route the heated grip harness as shown.
<Right side>

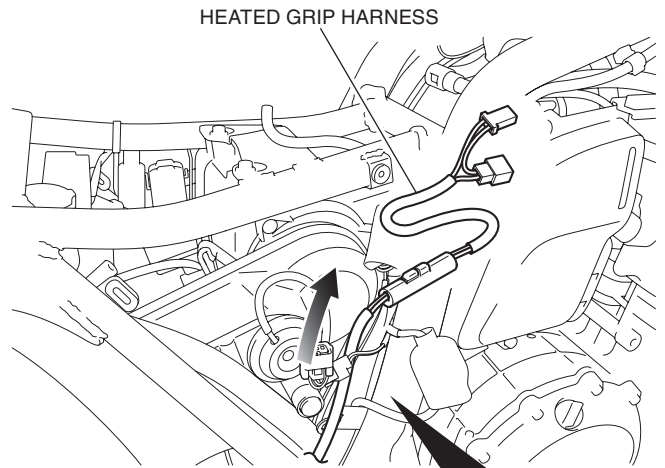

Disconnect the connector and move the harness boot.

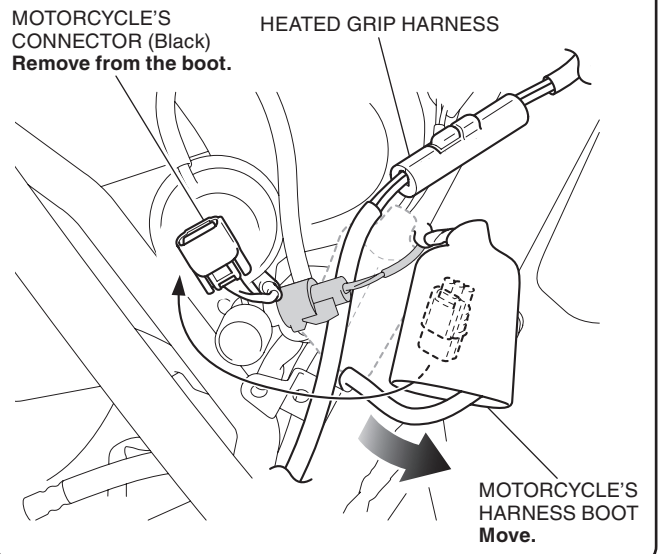

42. Disconnect the indicated connector.

MOTORCYCLE'S 2-PIN CONNECTOR (Black)

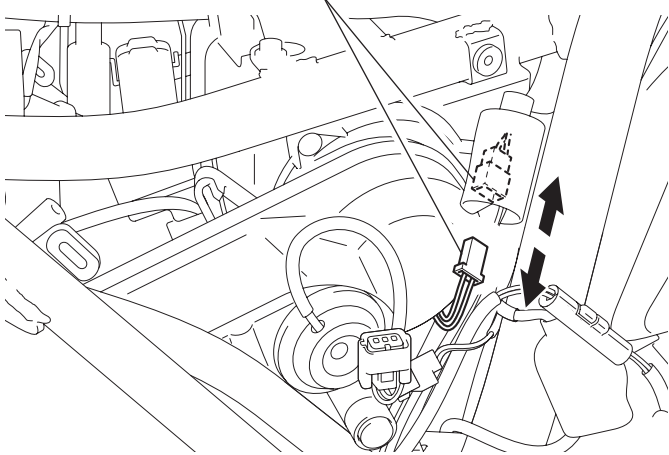

43. Connect the heated grip harness as shown.

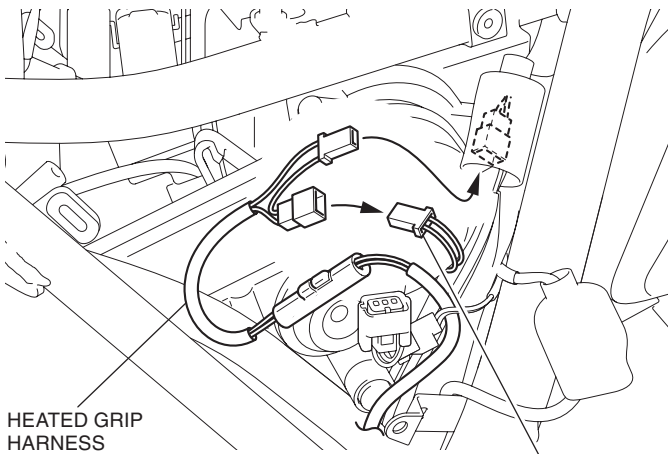

HEATED GRIP HARNESS

MOTORCYCLE'S 2-PIN CONNECTOR (Black)

44. Store the connected heated grip harness in the harness boot as shown.

HEATED GRIP HARNESS
Store the connector and fuse in the boot, then pull out the excess harness and fold it.

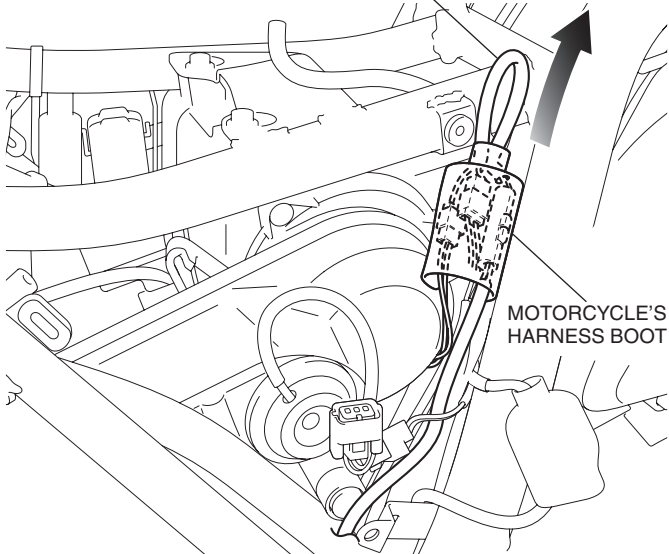

MOTORCYCLE'S HARNESS BOOT

45. Secure the heated grip harnesses with the wire tie as shown.

HEATED GRIP HARNESS

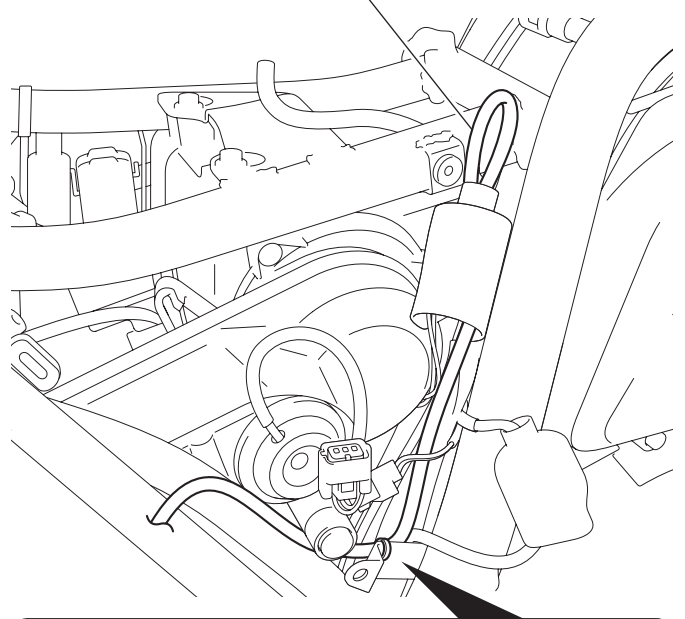

Reconnect the removed connector and return the harness boot to its original position after securing the heated grip harness.

HEATED GRIP HARNESS

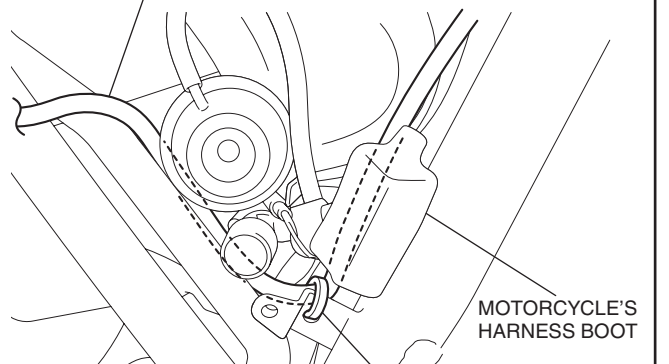

MOTORCYCLE'S HARNESS BOOT

WIRE TIE (narrow)
Secure the heated grip harness to the frame.

46. Route the heated grip harness and secure it as shown using a wire tie.

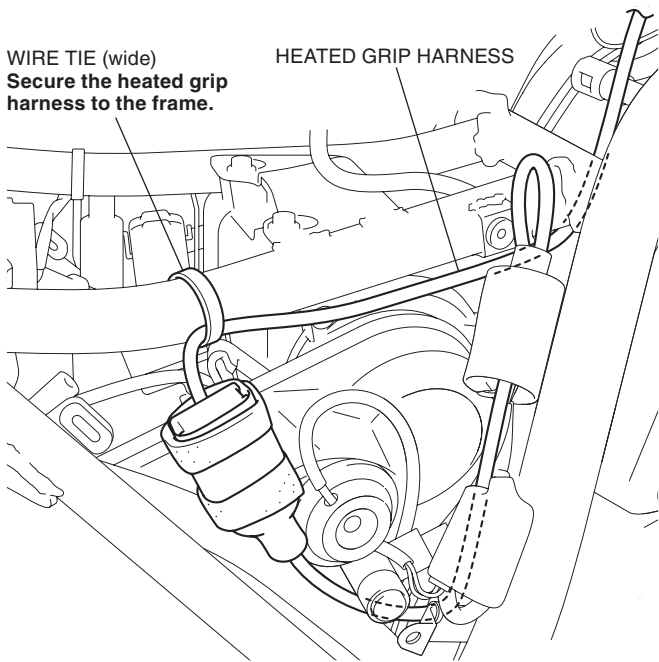

47. Route the heated grip harness and secure it as shown using a wire tie.

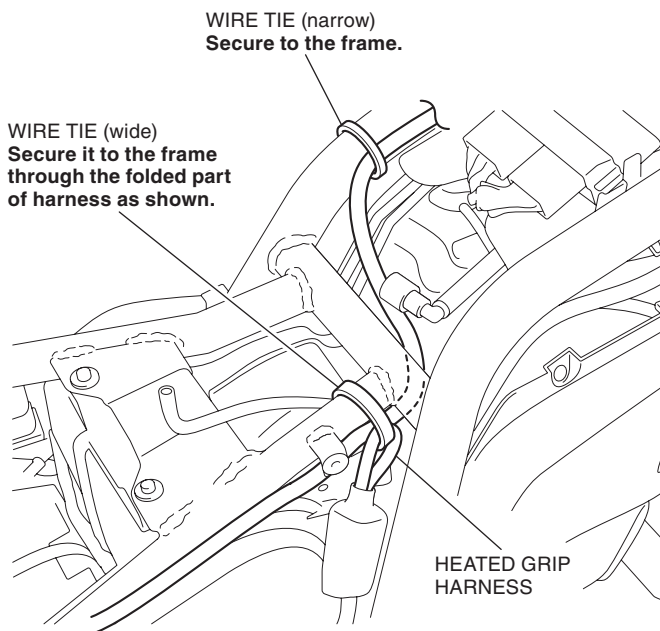

48. Route the heated grip harness and connect the ground terminal as shown.

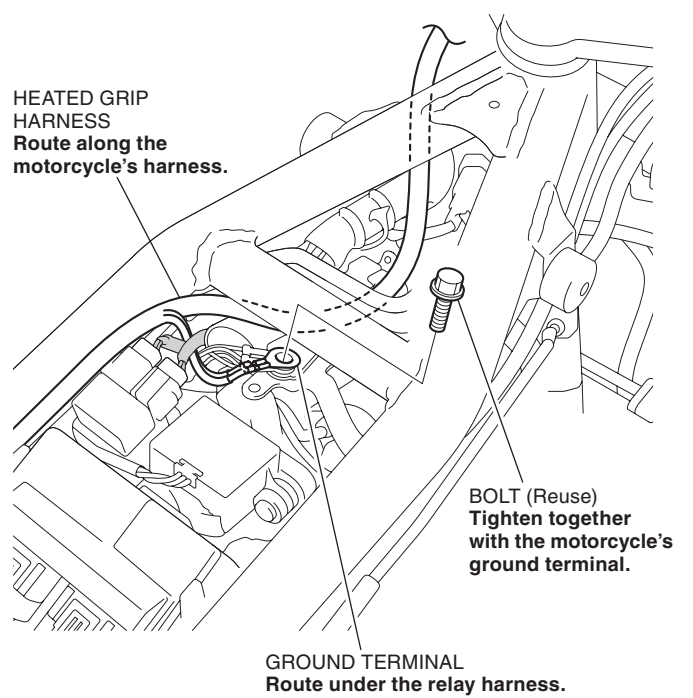

49. Route the heated grip harness and secure it as shown using a wire tie.

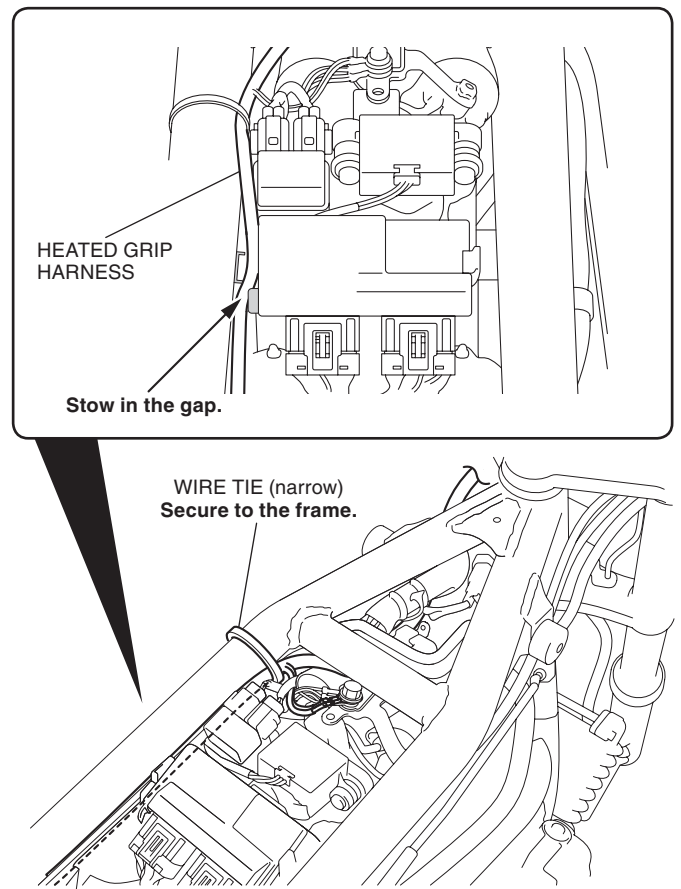

50. Route the heated grip harness as shown.

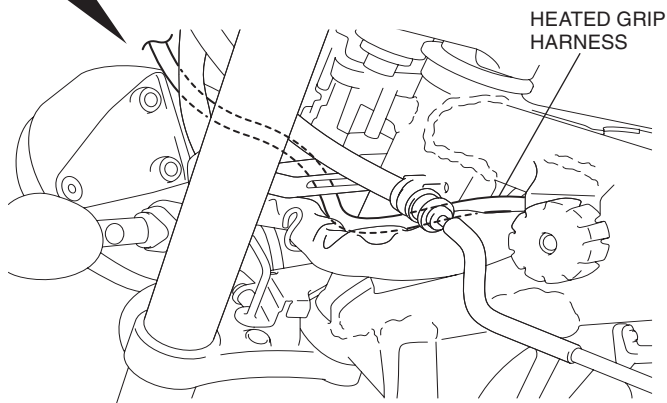
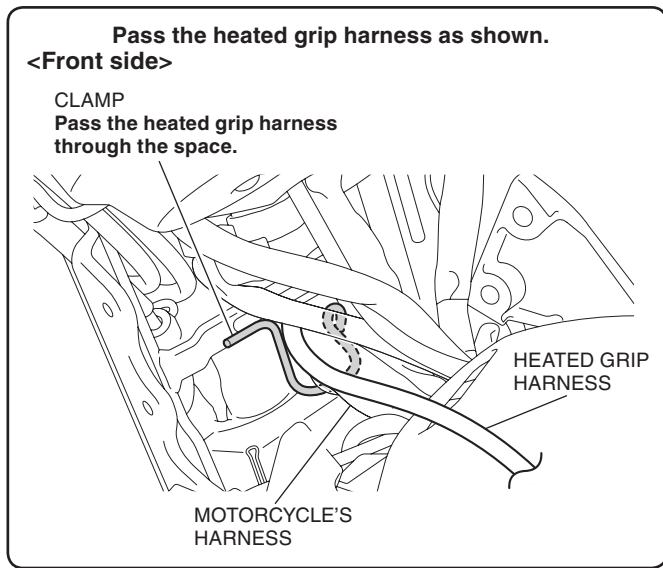

51. Route the heated grip harness as shown.

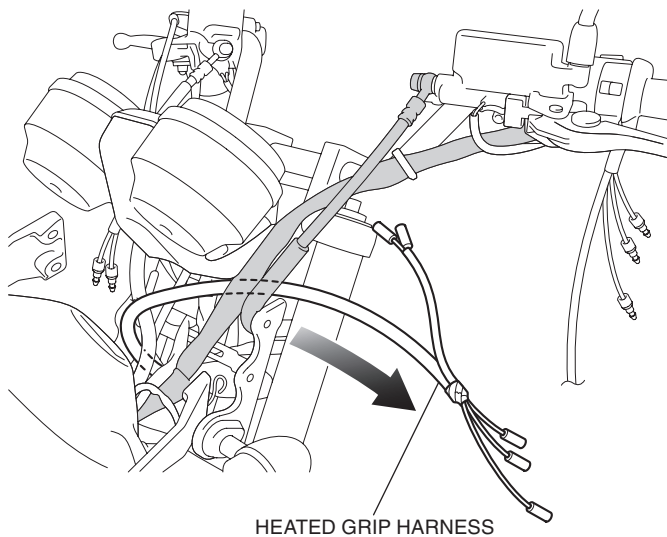

52. Fit the tube over the left heated grip harness as shown.

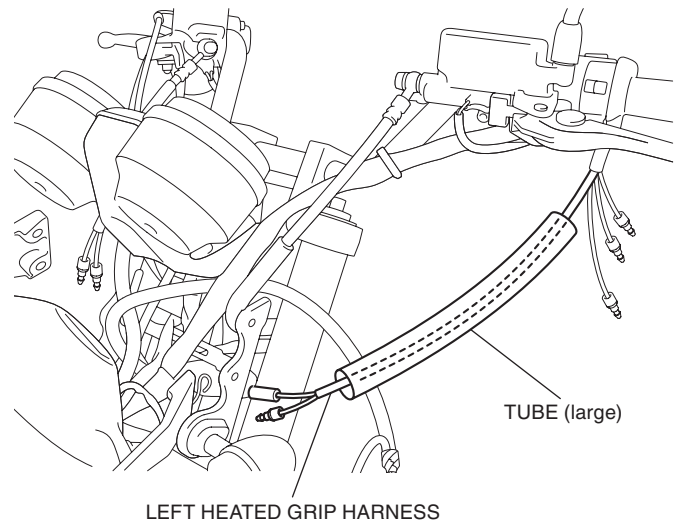

53. Move the tube to the base of the left heated grip harness as shown.

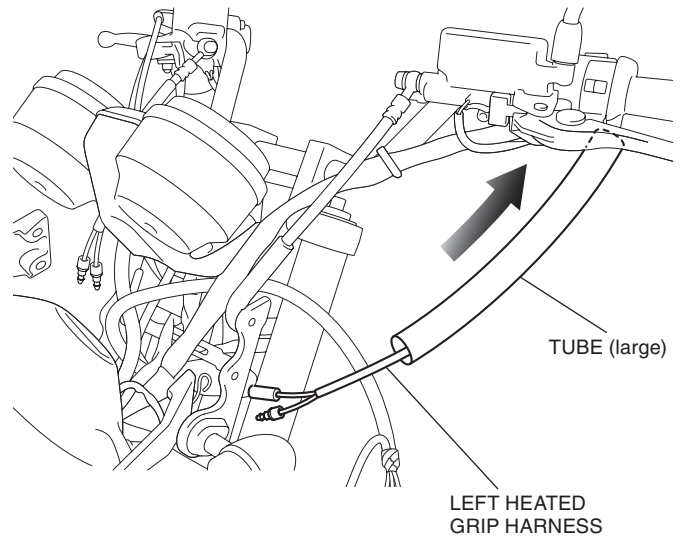

54. Pass the heated grip harness through the tube as shown.

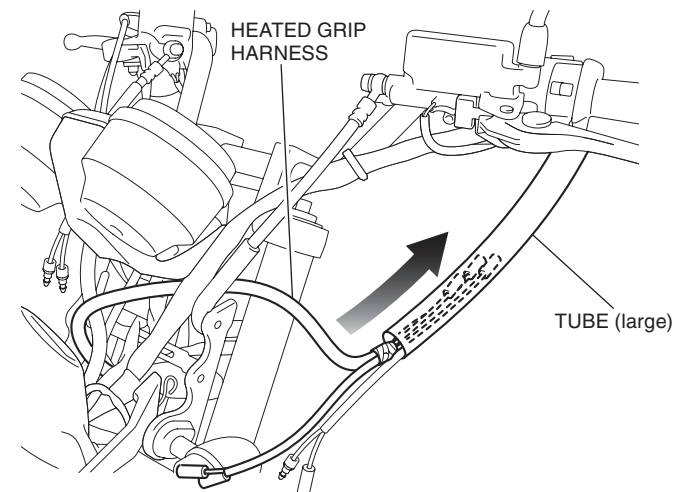

55. Move the tube and pull out the heated grip harness as shown.

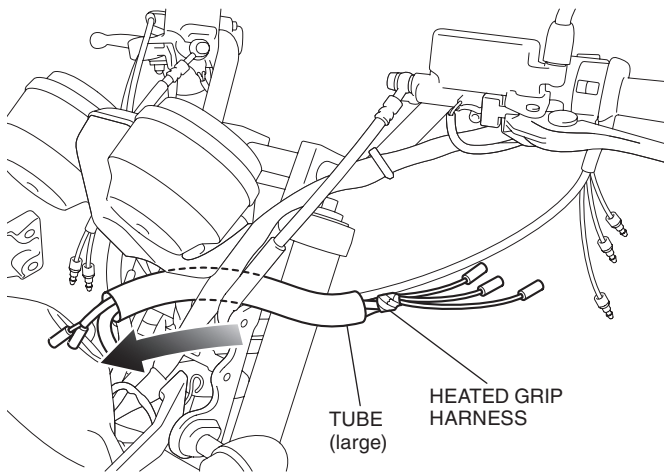

56. Install the tube (small) as shown.

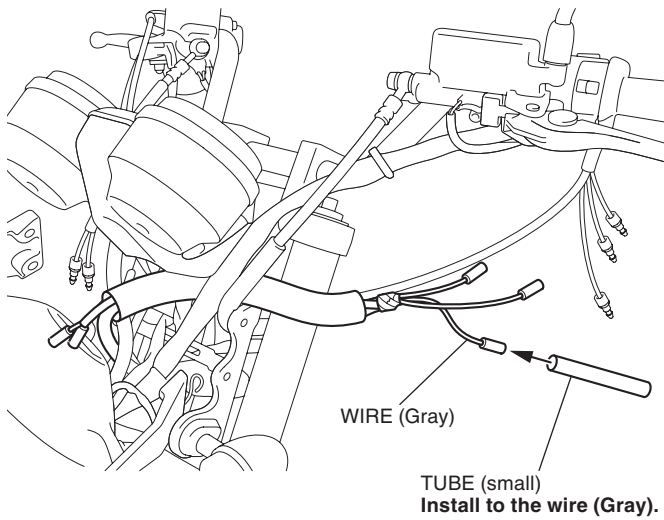

57. Connect the heated grip harness as shown.

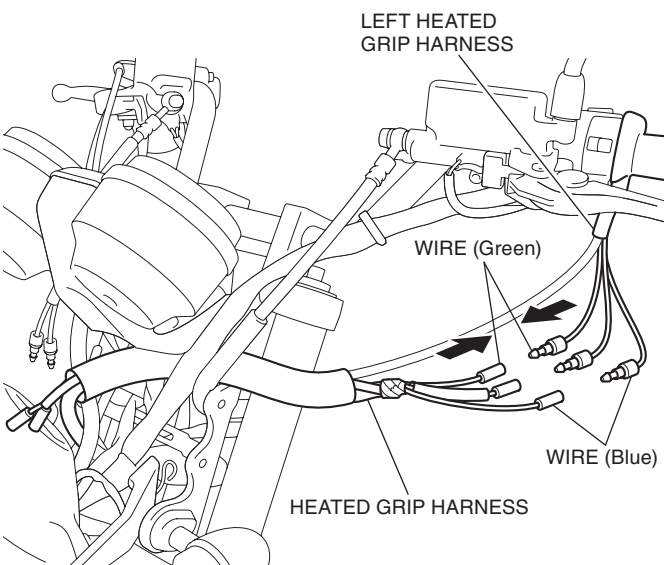

58. Attach tape at the indicated position.

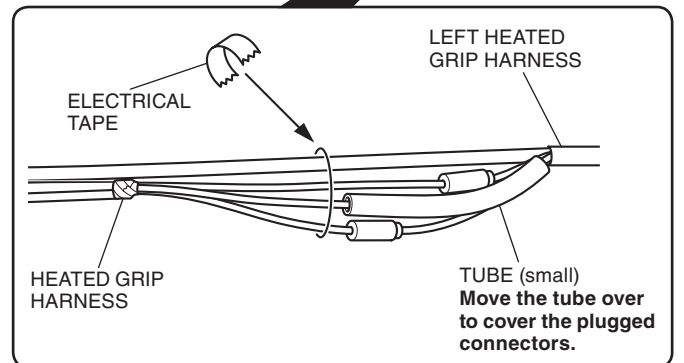
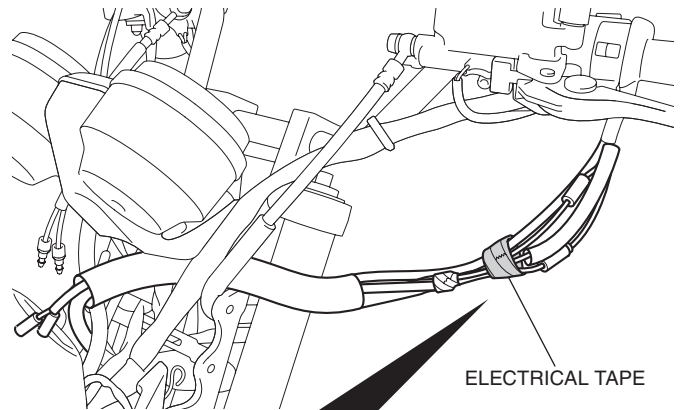

59. Move the tube as shown and secure it with electrical tape.

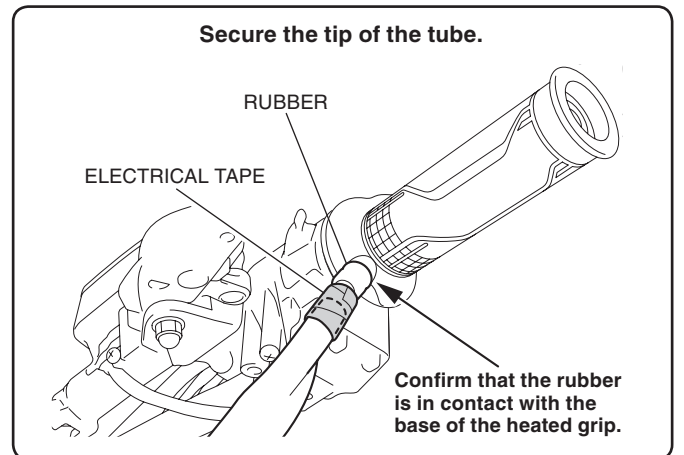
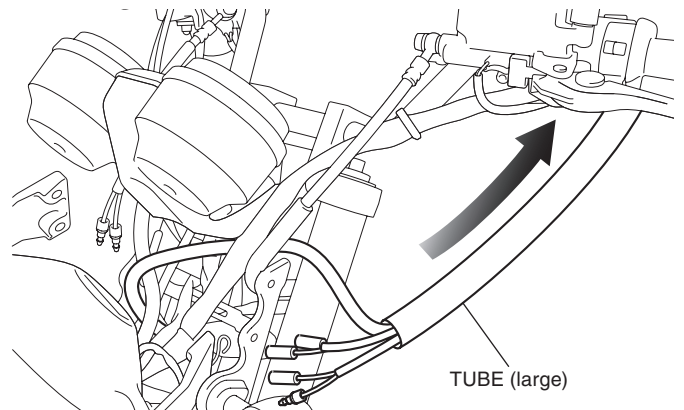

60. Route the harnesses as shown.

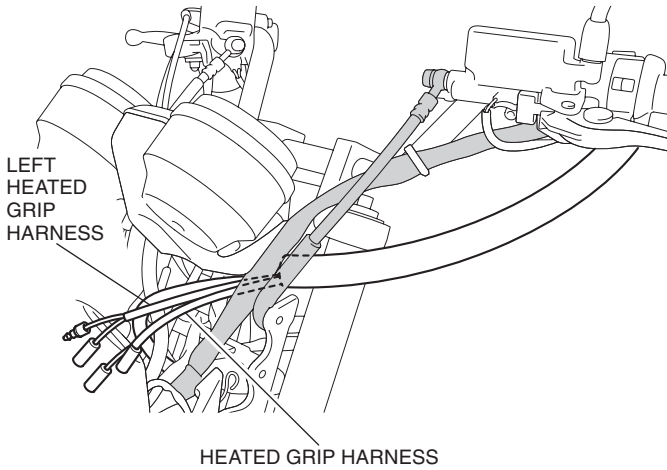

61. Connect the heated grip harness as shown.

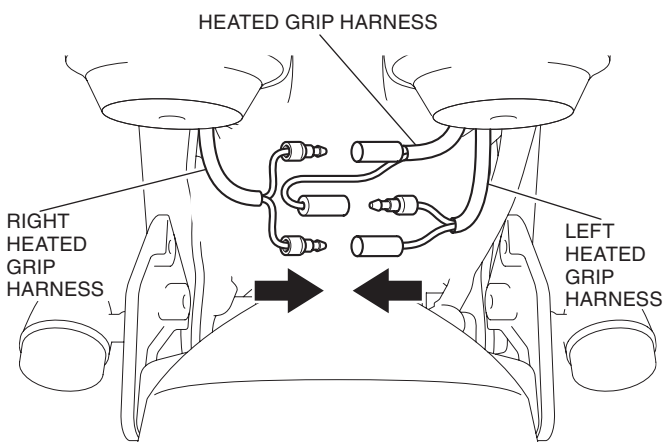

62. Wrap the connected terminals with electrical tape.

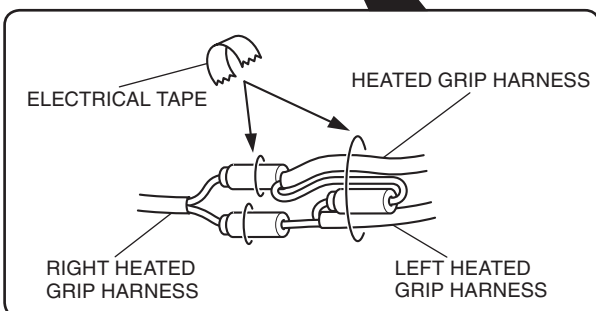
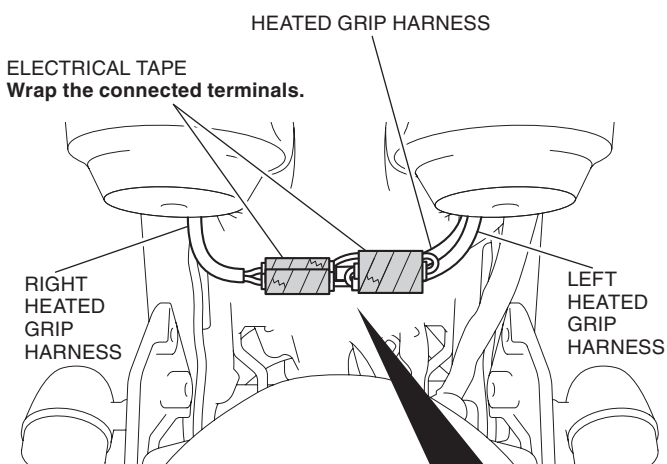

63. Remove the motorcycle's wire tie as shown.

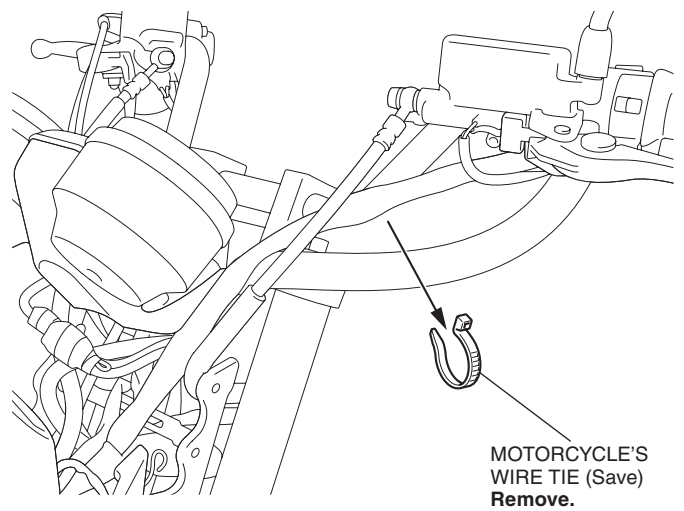

64. Secure the connected heated grip harness with the wire tie as shown.

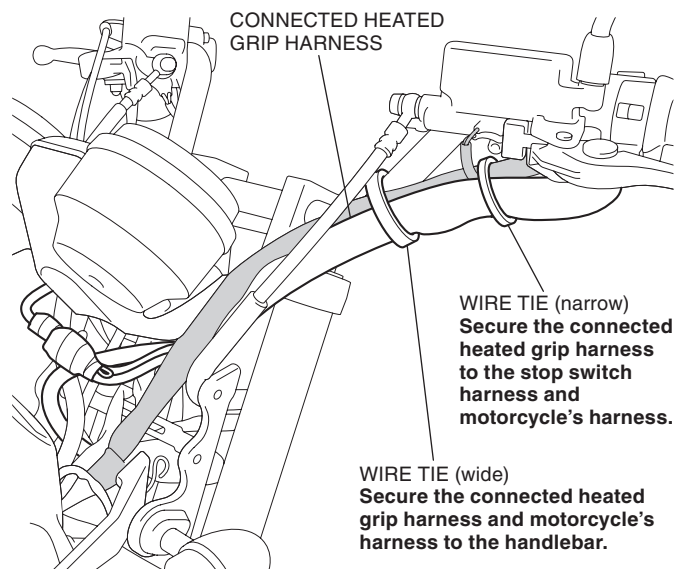

65. Secure the left and right heated grip harness in the position shown using a wire tie.

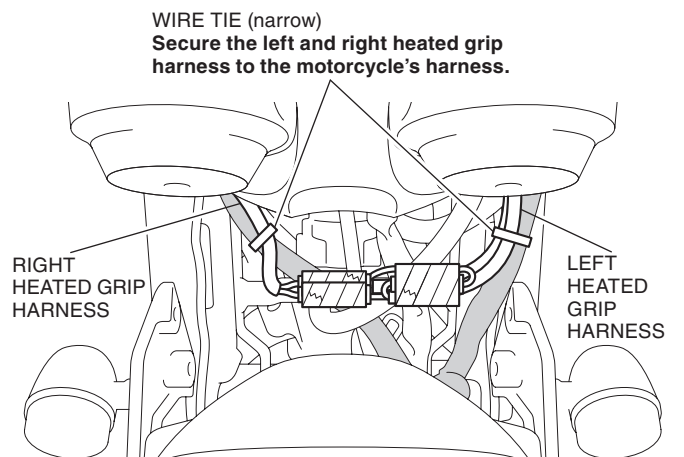

66. Install the headlight stay in the reverse order of removal.
- **Align the alignment marks of headlight stay and headlight case on both sides.**
 - **Move the handlebar right and left and check that the harnesses are not pinched by the neighboring components and that they are not pulled taut.**

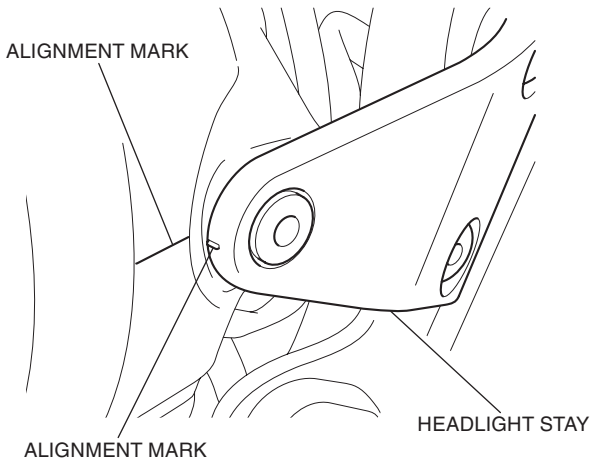

67. Reinstall the right handlebar weight as shown.
- **Repeat on the left side.**
 - **Clean up with isopropyl alcohol before applying thread lock.**
 - **Be sure to apply to the threads of the screw.**

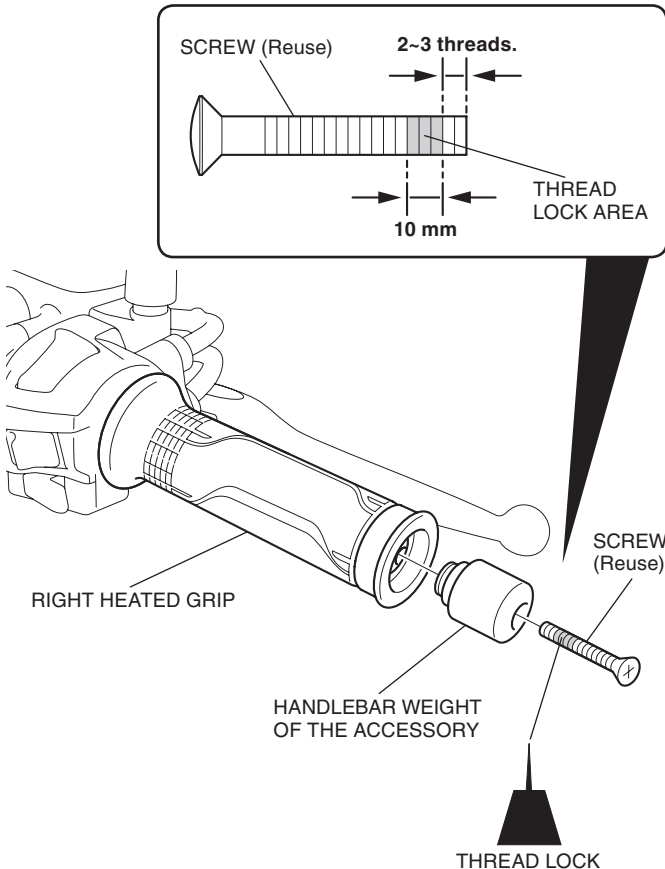

68. Install the motorcycle's parts in the reverse order of removal.
- **Install the right side cover and fuel tank with care not to pinch the harness and not to pull the harness taut.**
69. Check the heated grip, throttle, headlight and the other lights for proper operation.

DEALER TROUBLESHOOTING

- Stop the engine and turn the main switch OFF when you check the parts and circuits other than those of the heated grips.

Symptom	Check
Heated grip does not operate; <ul style="list-style-type: none"> • Faulty heated grip • Faulty heated grip coil • Blown fuse • Open or short circuit in heater harness • Faulty heater switch 	<ol style="list-style-type: none"> 1. Check whether wires and cables (terminals and connectors) are connected securely. 2. Heated grip inspection Check for resistance between the terminals. <ul style="list-style-type: none"> ➔ Standard: Right : 2.2 ohms +/- 10% Left : 2.2 ohms +/- 10% 3. Heater harness inspection: Check for continuity by referring to the wiring diagram. 4. If no abnormality is found after the above checks 1, 2, and 3, but the heated grip still does not operate properly, replace the left heated grip/switch with a new one. <ul style="list-style-type: none"> • It is hard to check the switch with ordinary inspection methods (for continuity etc.) because it contains an integrated circuit (IC).

