

# HONDA

## INSTALLATION INSTRUCTIONS

Accessory  
**WINDSHIELD**  
P/N 08R70-K53-D00

Application  
**SH300A**

Publication No.  
**MII**  
Issue Date  
**January 2015**

**Honda Dealer: Please give a copy of these instructions to your customer.**

### PARTS LIST

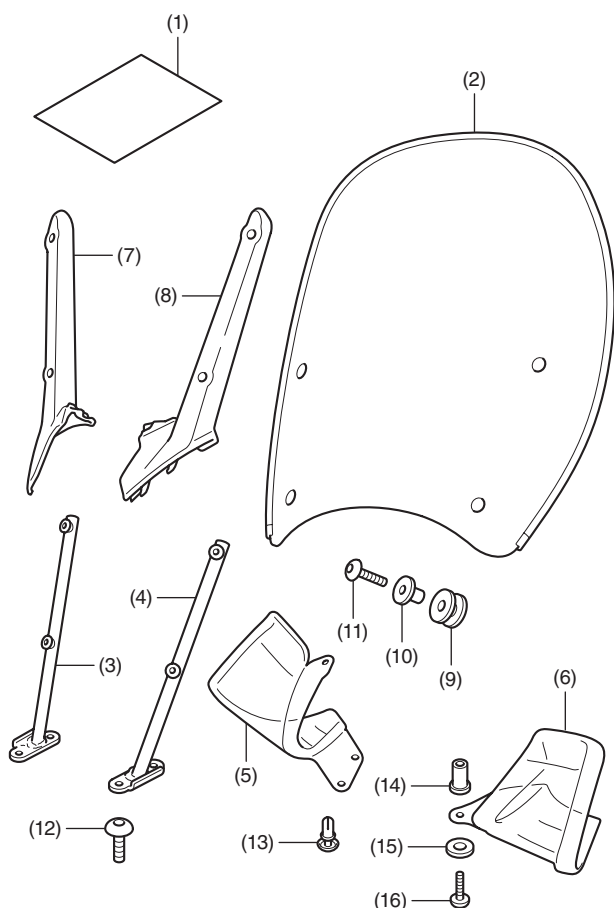

No.	Description	Qty
(1)	URL paper	1
(2)	Windshield	1
(3)	Right stay	1
(4)	Left stay	1
(5)	Right knuckle visor	1
(6)	Left knuckle visor	1
(7)	Right shield cover	1
(8)	Left shield cover	1
(9)	Grommet	4
(10)	Flange collar	4
(11)	6 mm socket bolt	4
(12)	8 mm socket bolt	4
(13)	Clip	4
(14)	5 mm well nut	2
(15)	Washer	2
(16)	5 mm socket bolt	2

### TOOLS REQUIRED

Hex wrench (3, 4 and 5 mm)

Torque wrench

### TORQUE CHART

Tighten all screws, bolts, and nuts to their specified torque values. Refer to the Service Manual for the torque values of the removed parts.

Item	N-m	kgf-m	lbf-ft
5 mm socket bolt	0.4	0.04	0.3
6 mm socket bolt	10	1.0	7
8 mm socket bolt	22	2.2	16

### INSTALLATION

#### ▲ CAUTION

- To prevent burns, allow the engine, exhaust system, radiator, etc., to cool before installing the accessory.

#### NOTE:

- Take care not to damage the painted surfaces of the motorcycle.

- Refer to the Service Manual for the motorcycle, remove the motorcycle parts.

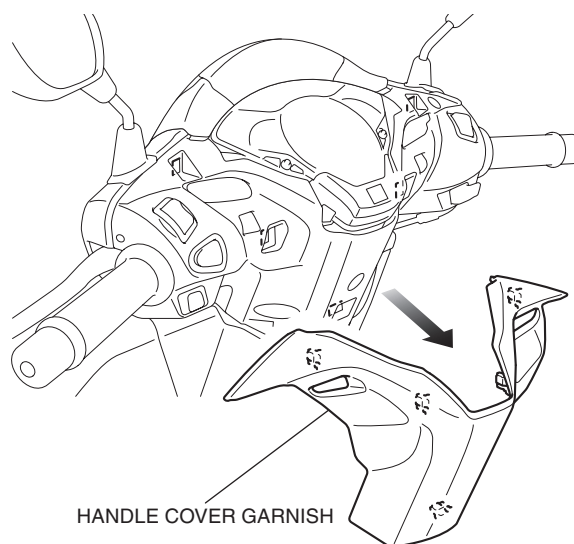

2. Refer to the Service Manual for the motorcycle, remove the motorcycle parts.

- **First remove the front part tab of the meter top cover.**

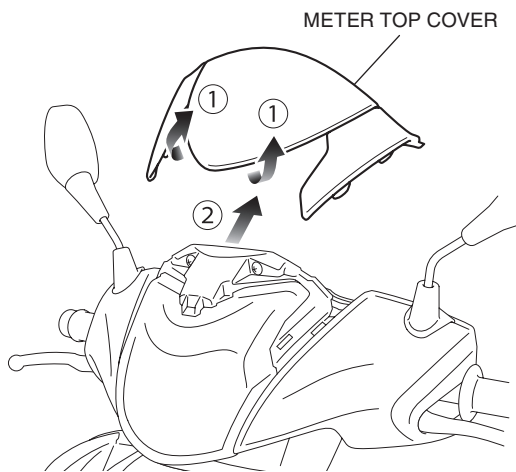

3. Refer to the Service Manual for the motorcycle, remove the motorcycle parts.

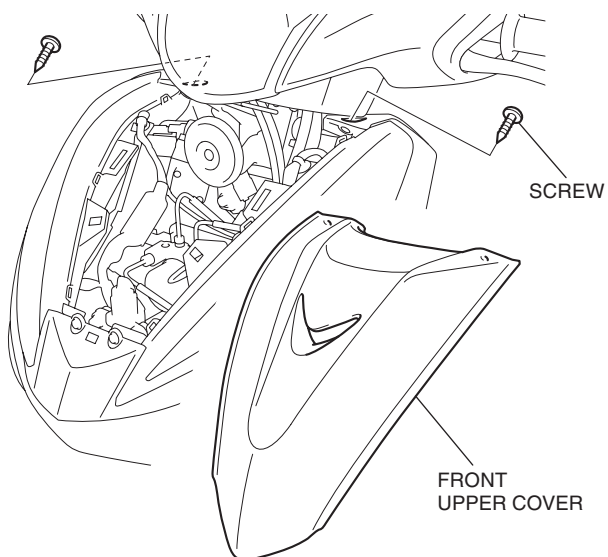

4. Refer to the Service Manual for the motorcycle, remove the motorcycle parts.

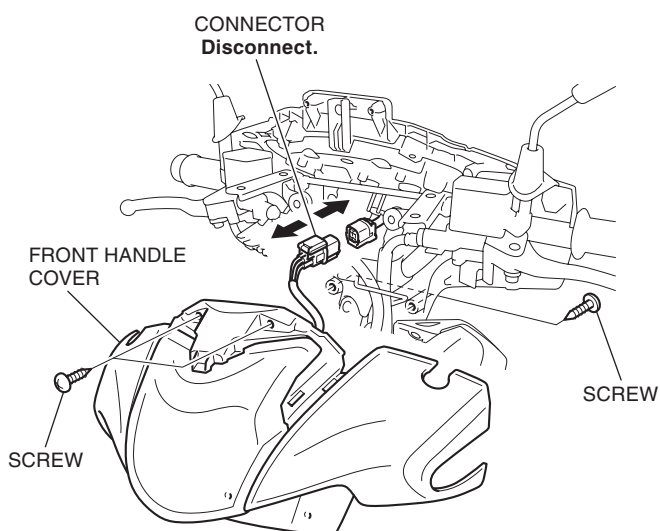

5. Loosely install the right and left stays as shown.

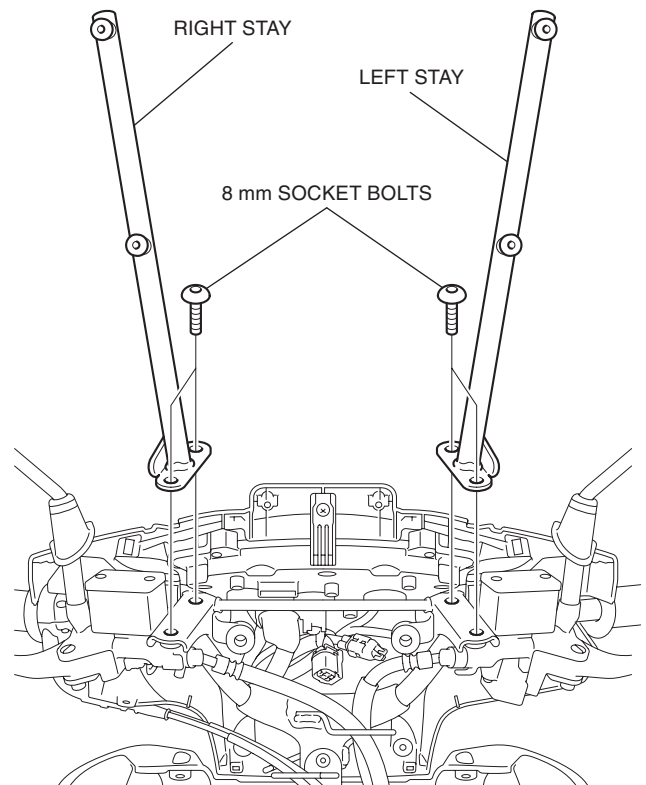

6. Install the grommets and flange collars as shown.

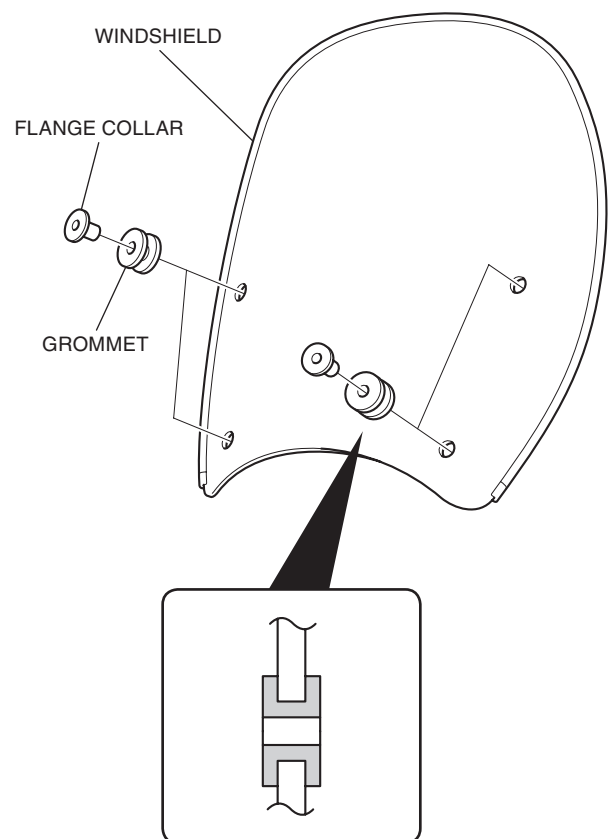

7. Temporarily install the windshield as shown.

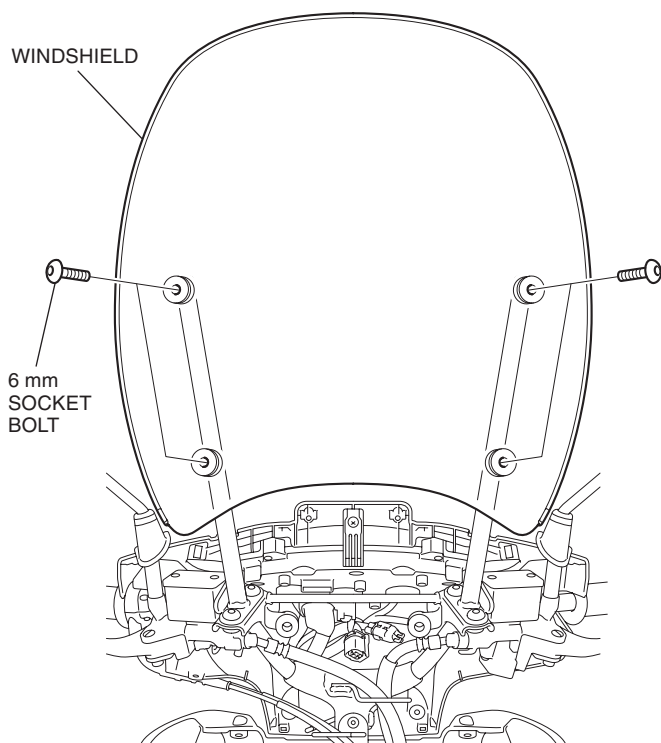

8. Tighten the loosely installed 8 mm socket bolts as shown.

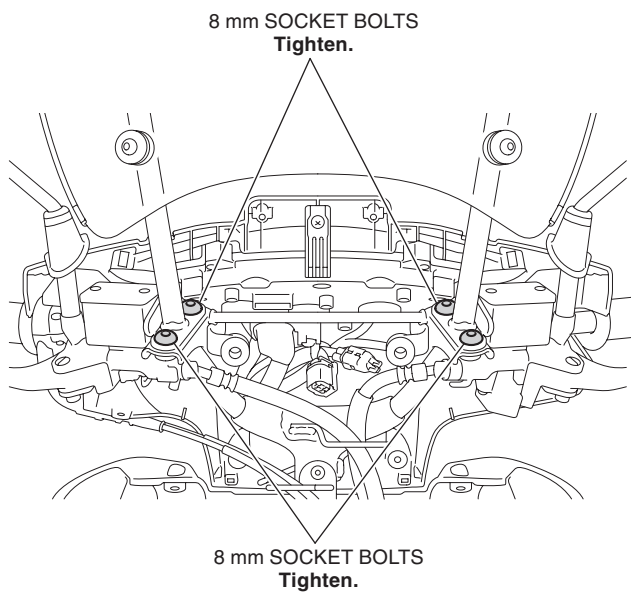

9. Remove the temporarily installed windshield.
- **It is not necessary to disassemble the flange collars and grommets.**
10. Install the front handle cover and front upper cover in reverse order of removal.
11. Install the left shield cover as shown.
- **Repeat on the right side.**

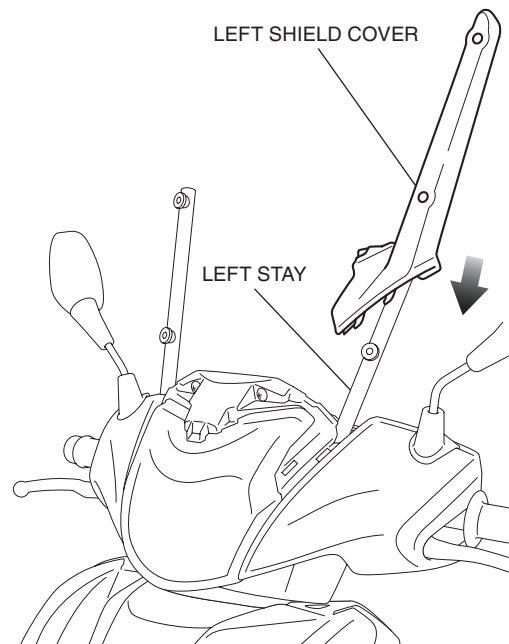

12. Disassemble the meter top cover as shown.

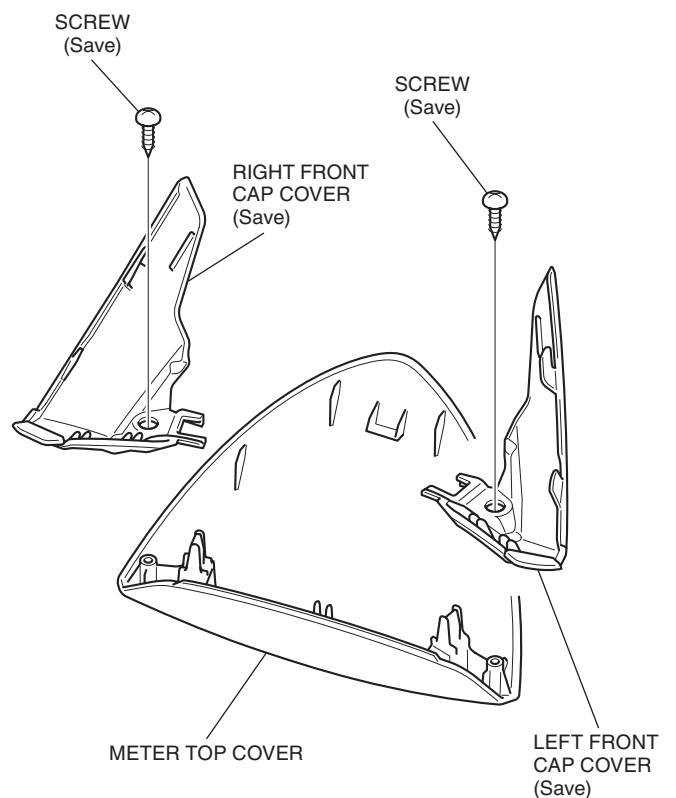

13. Install the meter top cover as shown.

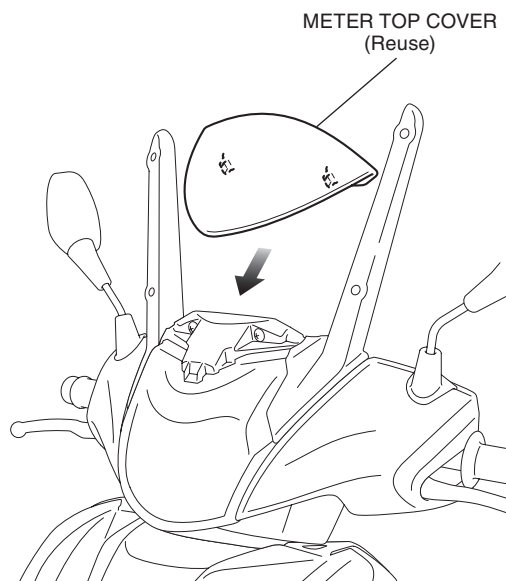

14. Install the handle cover garnish in reverse order of removal.

15. Install the windshield as shown.

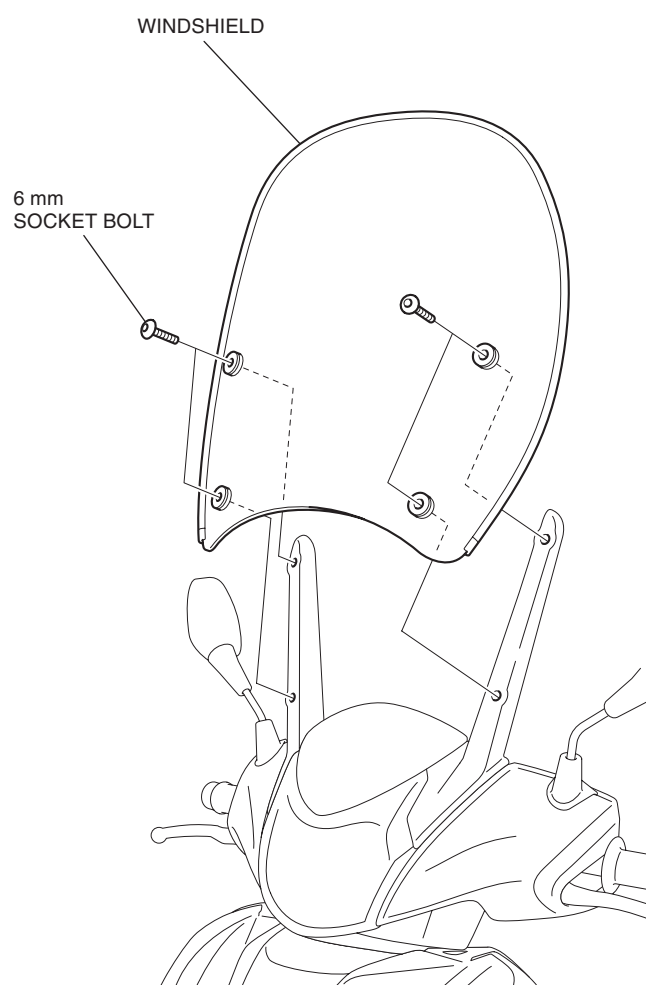

16. Install the well nut as shown.

- Repeat on the right side.

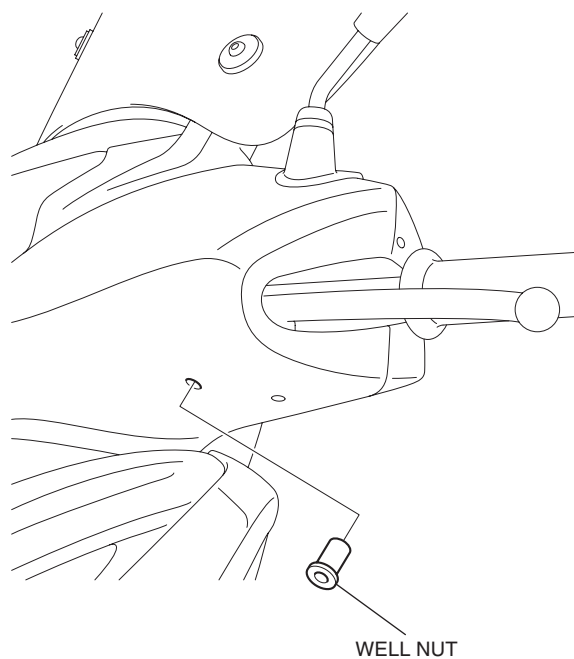

17. Install the left knuckle visor as shown.

- Repeat on the right side.

