



INSTALLATION INSTRUCTIONS

Accessory
REAR CARRIER
P/N 08L70-MGC-JB0

Application
CB1100CA/NA

Publication No.
MII
Issue Date
November 2016

Honda Dealer: Please give a copy of these instructions to your customer.

PARTS LIST

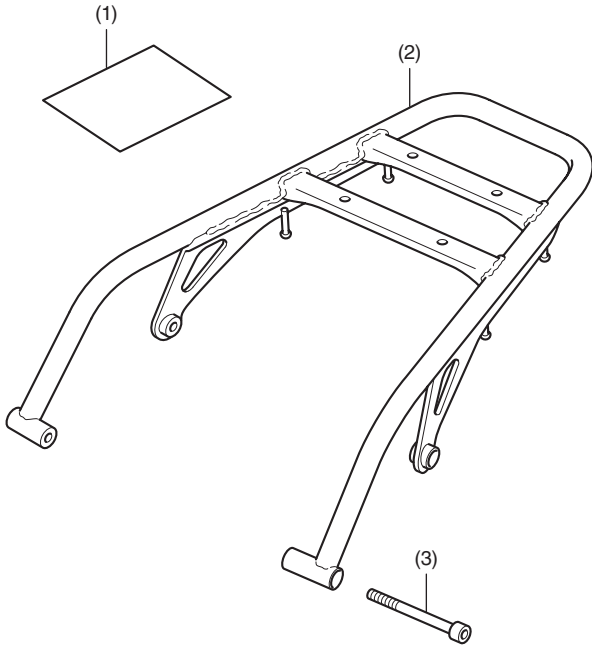

No.	Description	Qty
(1)	URL paper	1
(2)	Rear carrier	1
(3)	8 mm socket bolt	4

TOOLS REQUIRED

Hex wrench (8 mm)
Torque wrench

TORQUE CHART

Tighten all screws, bolts, and nuts to their specified torque values. Refer to the Service Manual for the torque values of the removed parts.

Item	N-m	kgf-m	lbf-ft
8 mm socket bolt	40	4.1	30

MAXIMUM LOADING CAPACITY

- The weight of the cargo must not exceed the following maximum loading capacity:

Maximum Loading Capacity	
Rear carrier	8.0 kg (17.6 lb)

INSTALLATION

▲ CAUTION

- To prevent burns, allow the engine, exhaust system, radiator, etc., to cool before installing the accessory.

- Remove the motorcycle's parts as shown.
 - Repeat on the right side.

<Left side>

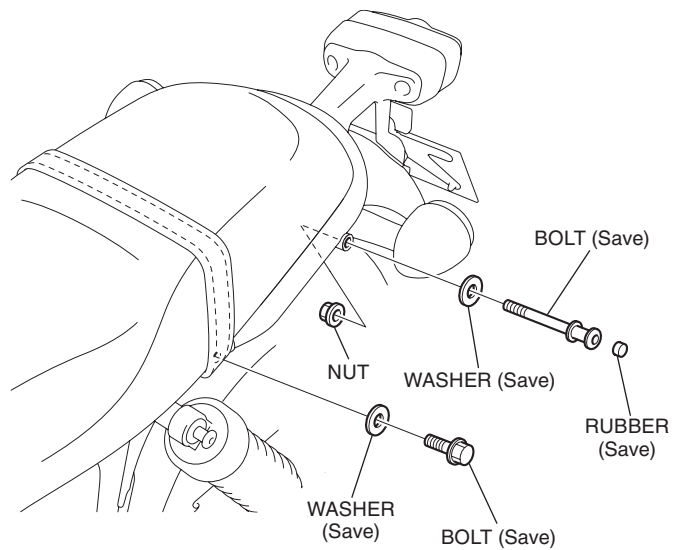

- Install the rear carrier as shown.
 - Repeat on the right side.

