



INSTALLATION INSTRUCTIONS

Accessory

REAR CARRIER
P/N 08L70-MKC-C40

Application

GL1800/B/BD/D/DA

Publication No.

MII

Issue Date

January 2018

Honda Dealer: Please give a copy of these instructions to your customer.

PARTS LIST

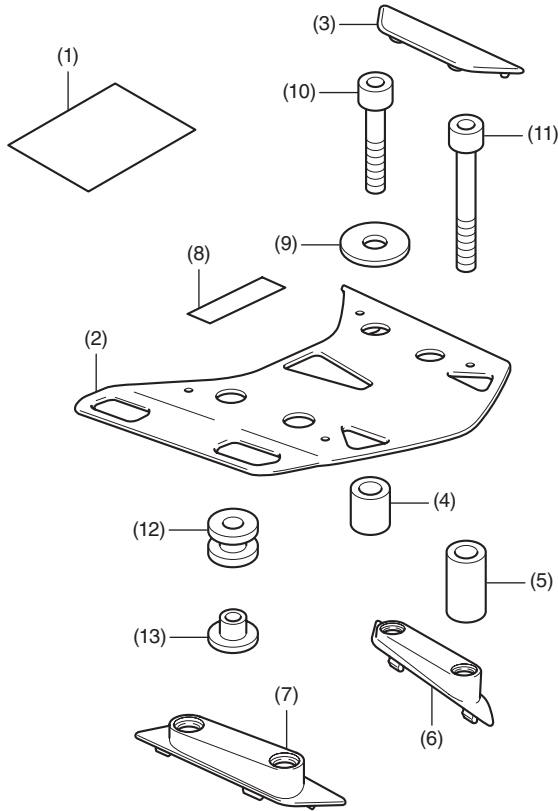

No.	Description	Qty
(1)	Installation Instructions URL	1
(2)	Rear carrier	1
(3)	Carrier cover	2
(4)	Collar (short)	2
(5)	Collar (long)	2
(6)	Right cover	1
(7)	Left cover	1
(8)	Label	1
(9)	Washer	4
(10)	8 mm socket bolt (short)	2
(11)	8 mm socket bolt (long)	2
(12)	Rubber	4
(13)	Flange collar	4

TOOLS AND SUPPLIES REQUIRED

- Hex wrench (6 mm)
- Scale
- Scissors
- Isopropyl alcohol
- Shop towel
- Torque wrench

TORQUE CHART

Tighten all screws, bolts, and nuts to their specified torque values. Refer to the Service Manual for the torque values of the removed parts.

Item	N-m	kgf-m	lbf-ft
8 mm socket bolt	22	2.2	16

MAXIMUM LOADING CAPACITY

- The weight of the cargo must not exceed the following maximum loading capacity:

Maximum Loading Capacity	
Rear carrier	6.6 lb (3.0 kg)

INSTALLATION

▲ CAUTION

- To prevent burns, allow the engine, exhaust system, radiator, etc., to cool before installing the accessory.

NOTE:

- Heat the bonding surfaces with a hair dryer if the ambient air temperature is below 70°F (21°C).
- The adhesive reaches full strength in 72 hours. Wait at least 24 hours before riding your motorcycle.

- Remove the right and left rear top lid as shown.

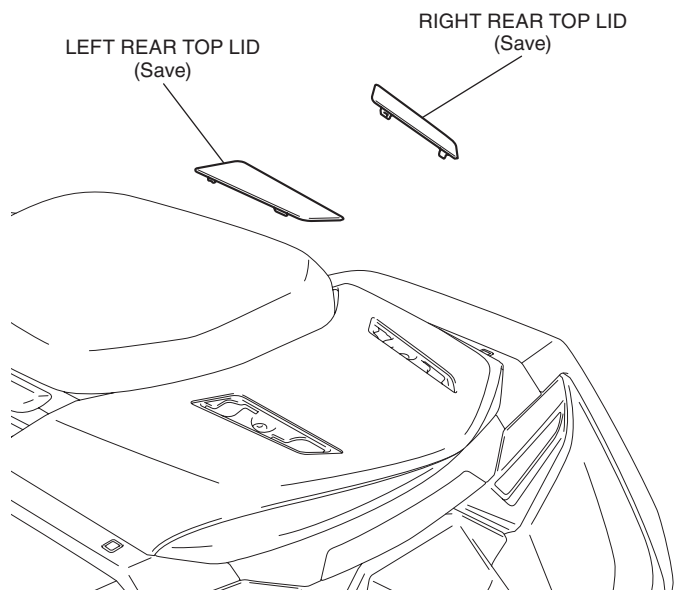

2. Attach the label as shown.

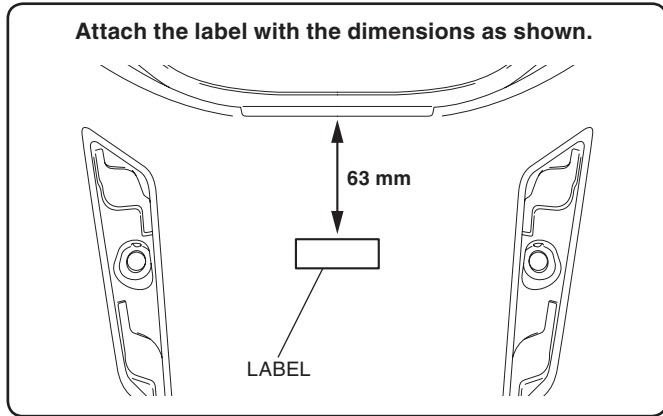

LABEL
Remove the adhesive backing before attaching.

ISOPROPYL ALCOHOL
Thoroughly clean the area where the label will be attached.

A small icon of an isopropyl alcohol bottle is shown next to the text.

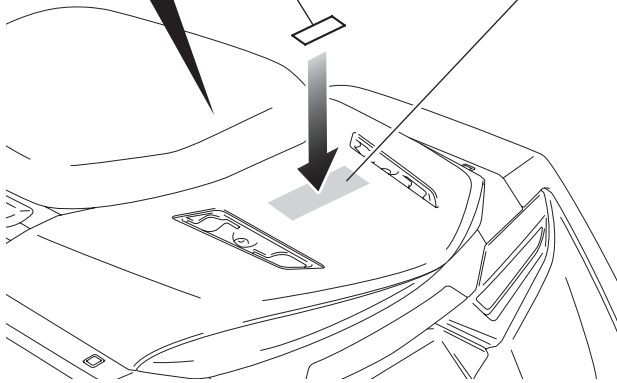

3. Install the rubbers as shown.

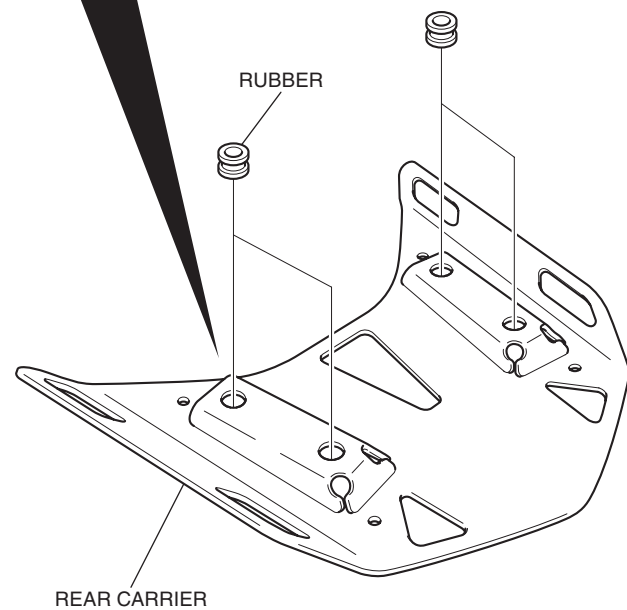
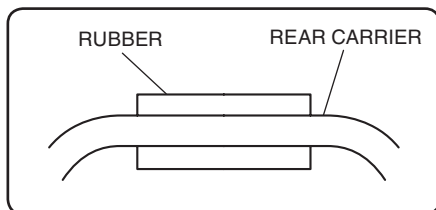

4. Install the flange collars as shown.

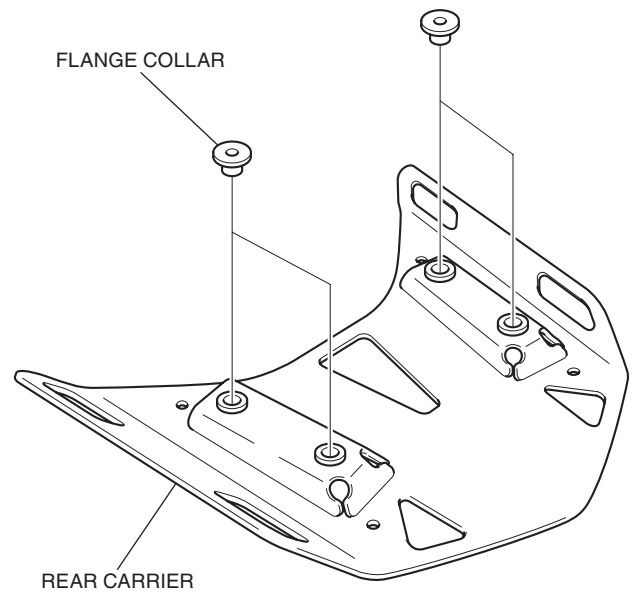

5. Install the right and left cover as shown.

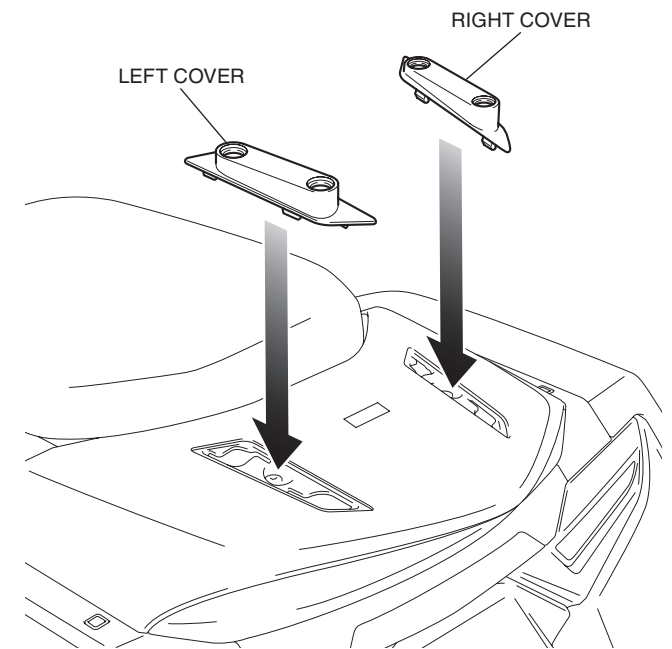

6. Install the collars as shown.

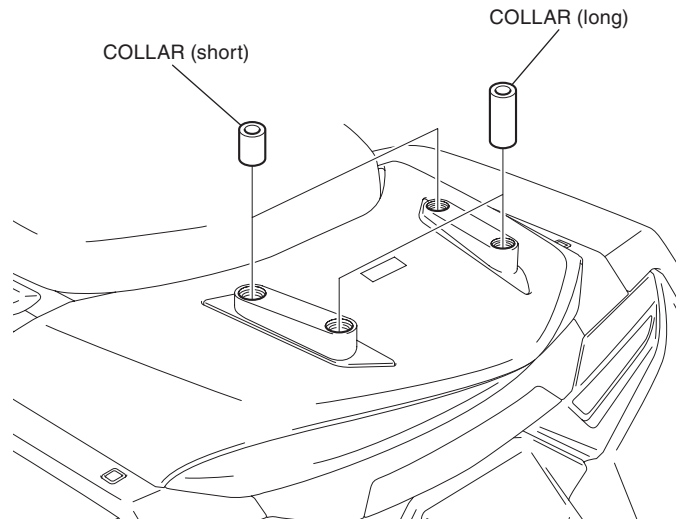

7. Install the rear carrier as shown.

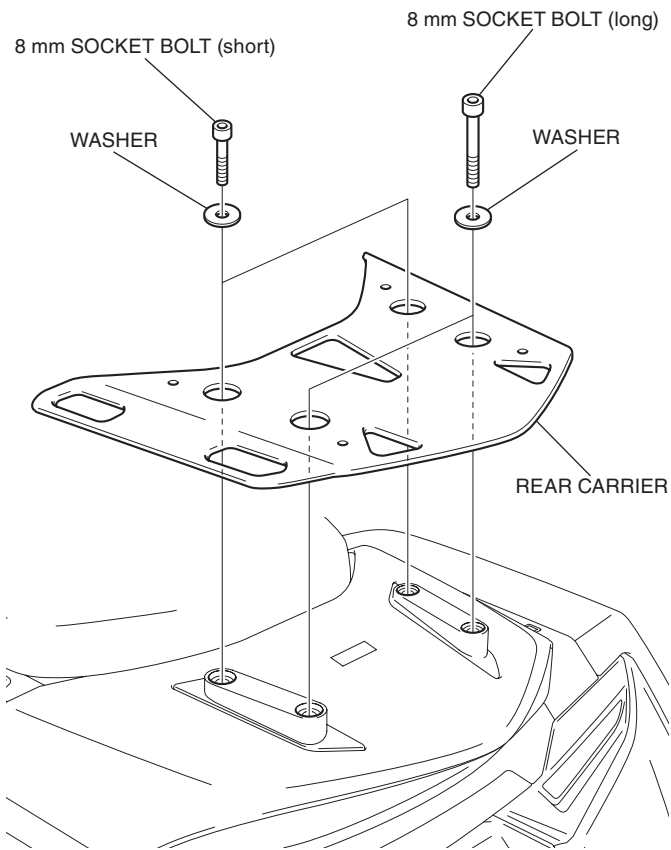

8. Cut the carrier covers to the dimensions shown.

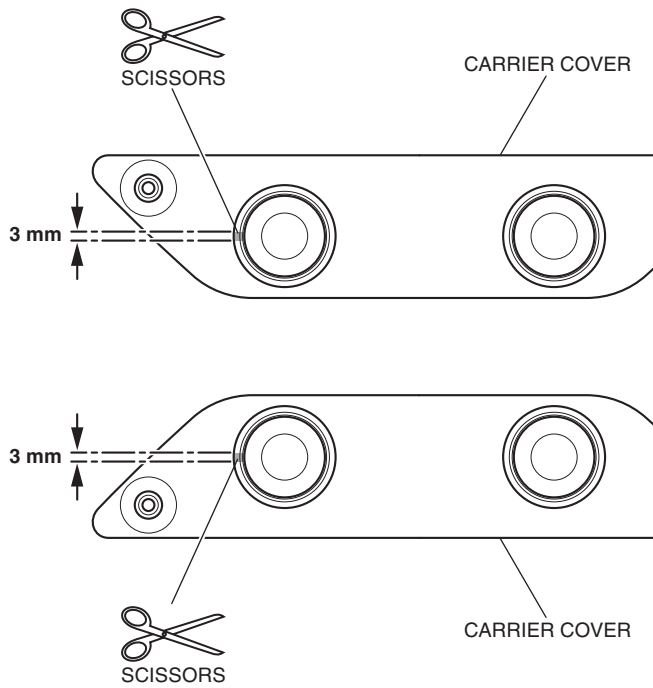

9. Install the carrier covers as shown.

