



# INSTALLATION INSTRUCTIONS

Accessory

QUICK SHIFTER  
P/N 08U73-MKR-D10

Application

CBR1000ST/SP

Publication No.

MII

Issue Date

December 2019

**Honda Dealer: Please give a copy of these instructions to your customer.**

## PARTS LIST

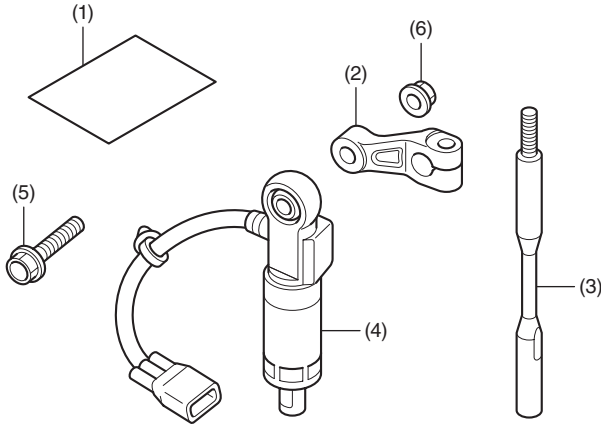

No.	Description	Qty
(1)	URL paper	1
(2)	Gear change arm	1
(3)	Change bar	1
(4)	Stroke sensor	1
(5)	7 mm flange bolt	1
(6)	7 mm flange nut	1

## TOOLS AND SUPPLIES REQUIRED

Socket (8 and 10 mm)

Ratchet

Open-end wrench (8 and 10 mm)

Scale

Marker

Tape

Torque wrench

## TORQUE INFORMATION

Tighten all screws, bolts, and nuts to their specified torque values. Refer to the Service Manual for the torque values of the removed parts.

Item	N·m	kgf·m	lbf·ft
7 mm flange bolt and nut	12	1.2	9

## INSTALLATION

### ▲ CAUTION

- To prevent burns, allow the engine, exhaust system, radiator, etc. to cool before installing the accessory.

### NOTE:

- Take care not to damage the painted surfaces of the motorcycle.
- Disconnect the negative (-) cable from the battery before installing this accessory.
- After reconnecting the battery, refer to the motorcycle Owner's Manual and set the meter.
- After this accessory installation, check the lights (e.g. right/left turn signal lights and brake lights) for proper operation.
- Save all removed parts unless otherwise indicated.

- Illustration shows CBR1000ST type, another type is similar.**

- Refer to the Service Manual for the motorcycle, remove the motorcycle parts, and disconnect the negative (-) cable from the battery as shown.

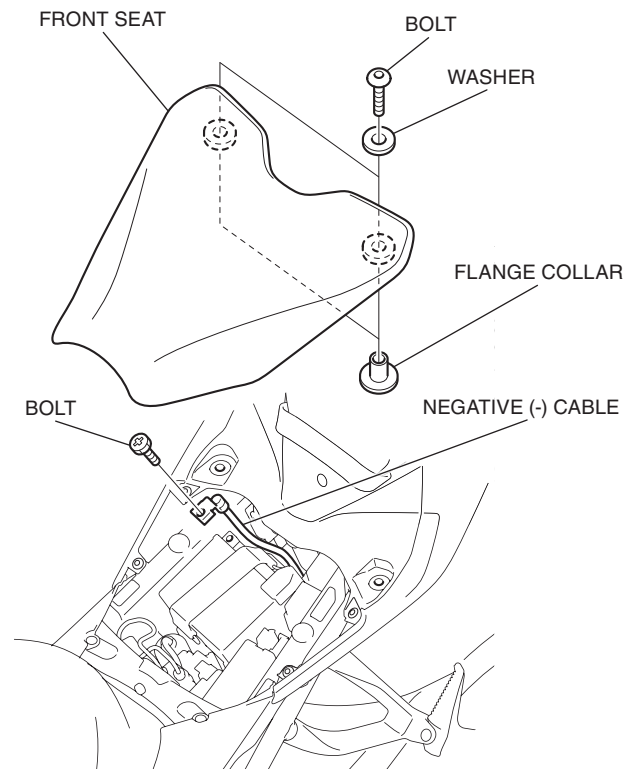

2. Mark at the original height of the gearshift pedal as shown.

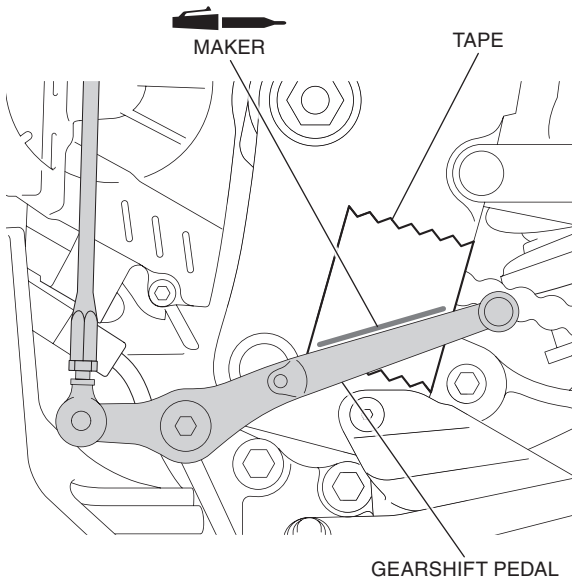

3. Refer to the Service Manual for the motorcycle, remove the motorcycle parts.

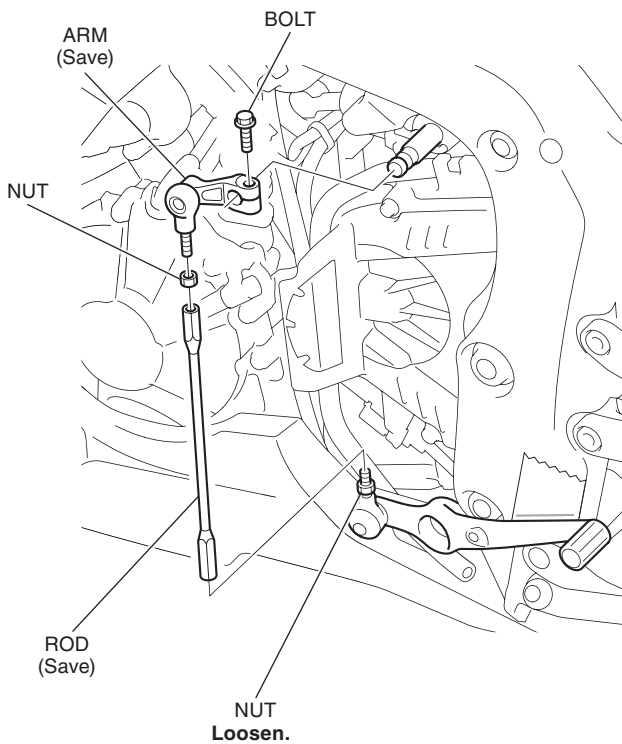

4. Assemble the stroke sensor and gear change arm as shown.

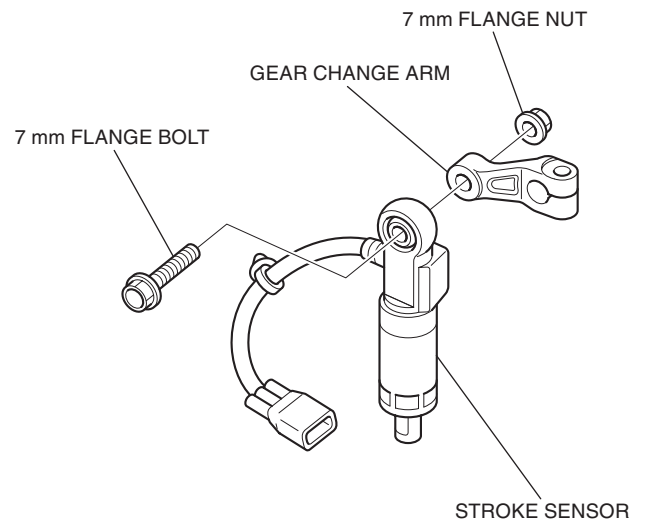

5. Install the stroke sensor/gear change arm as shown.
  - **Align the punch mark on the gearshift spindle with the slit of the gear change arm.**

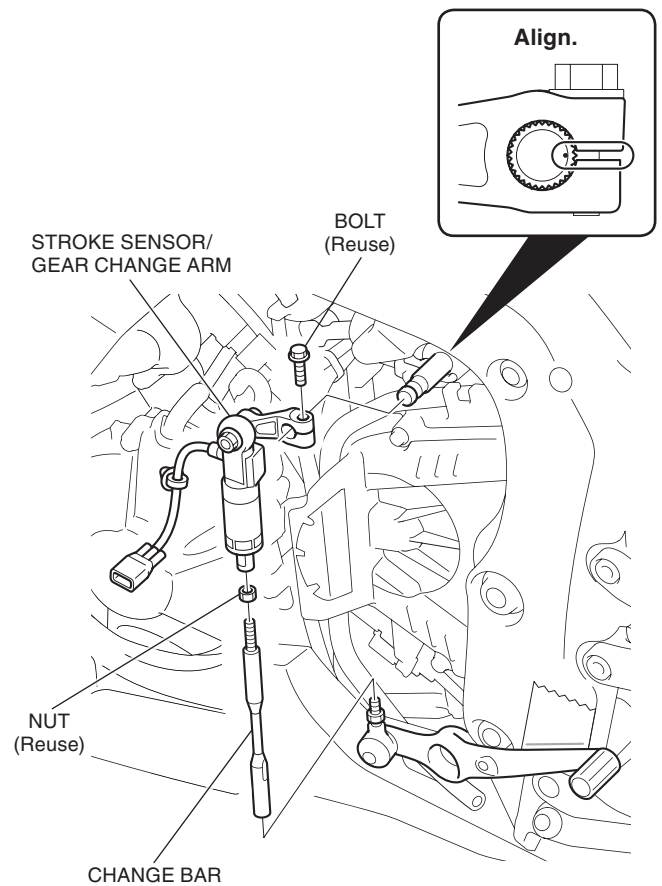

- Adjust the quick shifter length to the specified as shown.

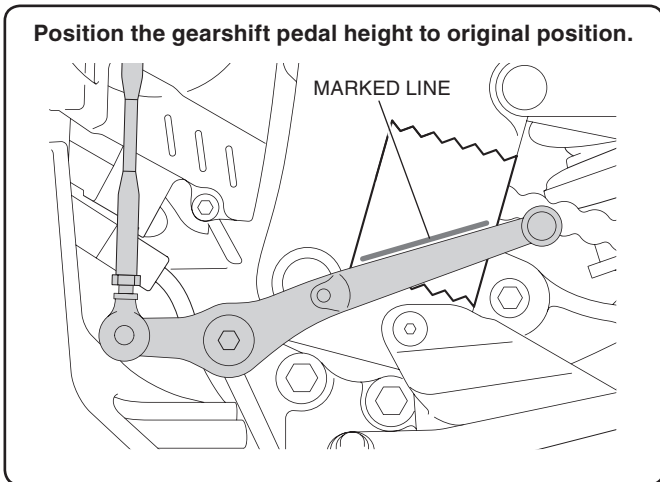

- Remove the dummy connector as shown.

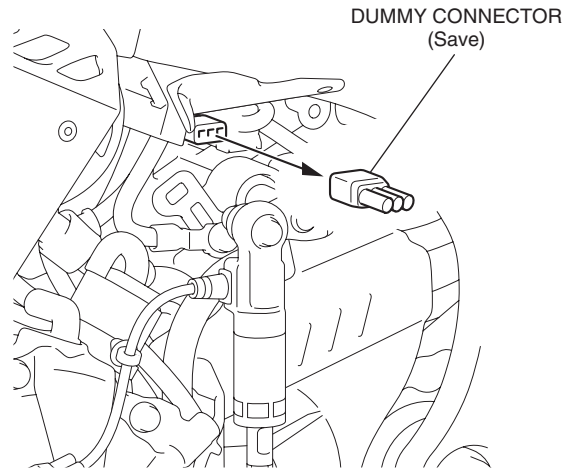

- Connect the stroke sensor connector as shown.

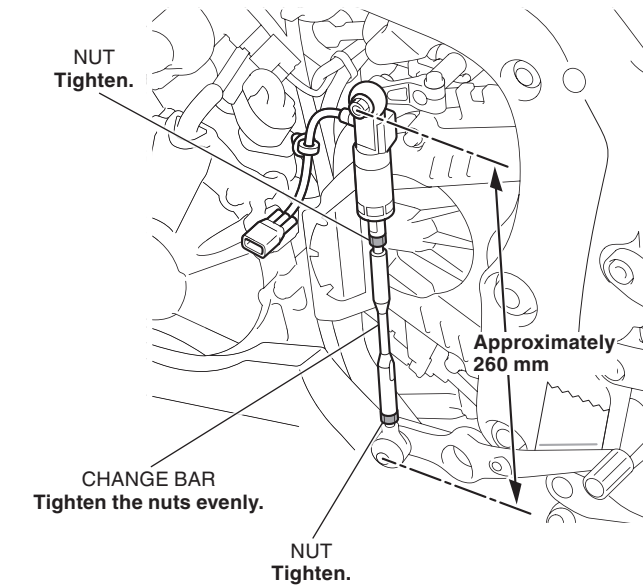
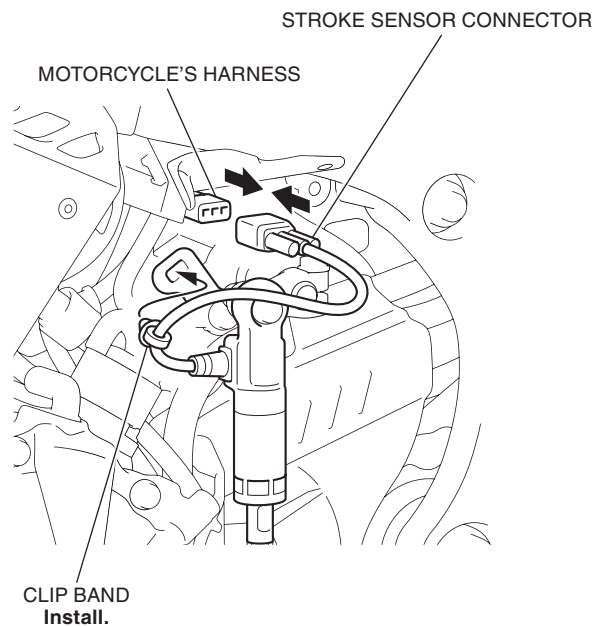

- Open the motorcycle's cover as shown.

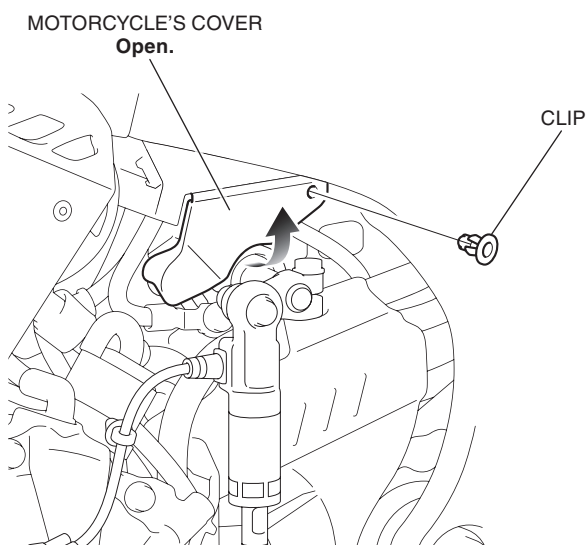

- Install the motorcycle's parts in the reverse order of removal.

- Confirm that the harness is not caught or too tight.
- After installing the quick shifter, perform the setting and initialization.

## SETTING INSTRUCTIONS

1. Open the front seat and connect the SCS short connector (070MZ-0010300).
2. Turn the ignition switch ON with the engine stop switch RUN, but does not start the engine.
3. Push and hold the Sel left switch to enter the setting mode.

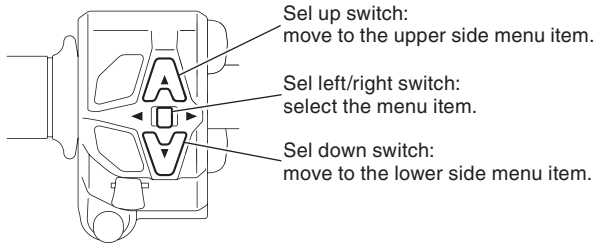

4. Select the SERVICE and EQUIPMENT.

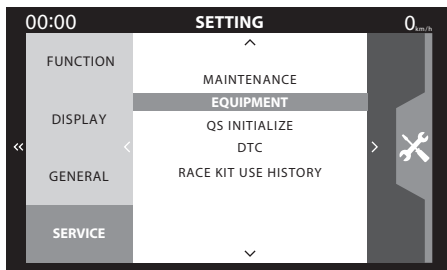

5. Set ON. (After removing the quick shifter, set OFF.)

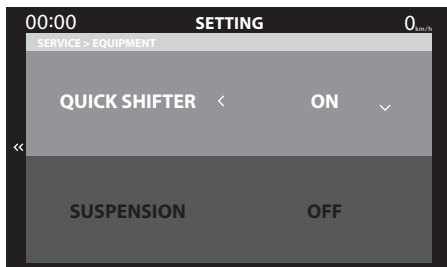

6. Turn the ignition switch OFF and remove the SCS short connector.

## INITIALIZATION INSTRUCTIONS

1. Open the front seat and connect the SCS short connector (070MZ-0010300).
2. Turn the ignition switch ON with the engine stop switch RUN, but does not start the engine.
3. Push and hold the Sel left switch to enter the quick shifter initialization mode.
4. Select the SERVICE, QS INITIALIZE, and INITIALIZE OK.

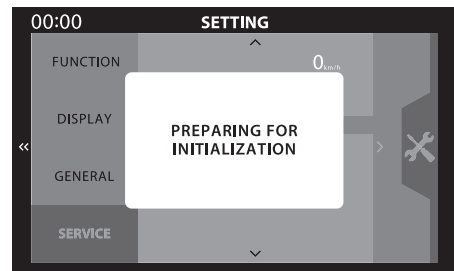
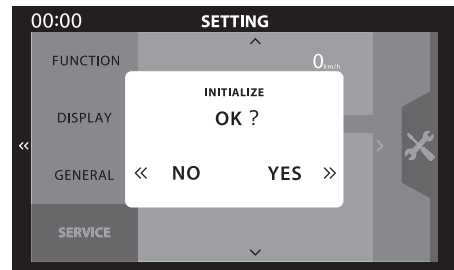
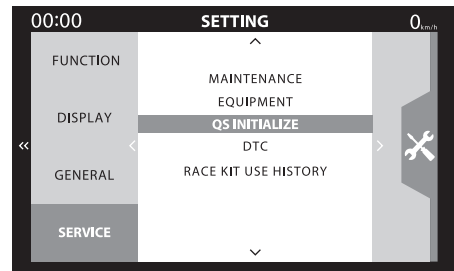

5. Start the engine and let it idle.
  - Hold the neutral gear position.

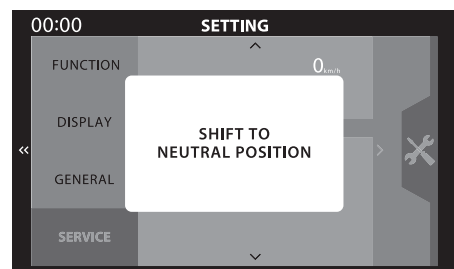

6. Wait until switched to the display.

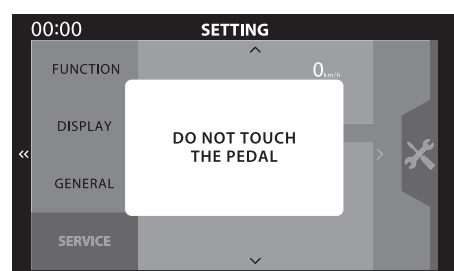

7. Wait until switched to the initialization completion display shown.

- **If the initialization failure, try again from first.**
- **When you do not complete even after repeating the initialization, check the mounting state of the stroke sensor.**

Initialization completion

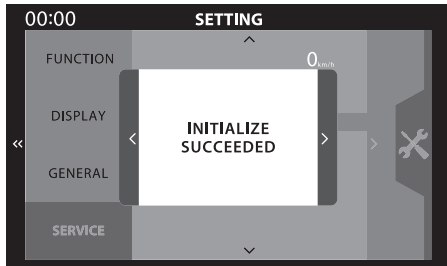

Initialization failure

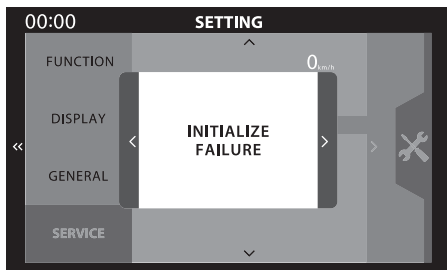

8. Turn the ignition switch OFF and remove the SCS short connector.

## OPERATING INSTRUCTIONS

This accessory enable the shift change without clutch operation when shifting up and down during acceleration. (Engine speed is more than 1,500 rpm on upshifting or more than the idle speed on downshifting).

- If the gear position display is not normal, the shift feeling may change.
- When the shift change do not operate normally, the shift change by clutch operation can be operated.

If you cannot shift up and down by operating the shift pedal during acceleration or deceleration, a failure may occur. Refer to the Service Manual for the troubleshoot of the Quick Shifter.

### NOTE:

- **For setting the UP LVL or DOWN LVL of the Quick Shifter, refer to the Owner's Manual.**