



# INSTALLATION INSTRUCTIONS

Accessory	Application	Publication No.
<b>TOP BOX (SMART) P/N 08L70-MKT-D00</b>	<b>ADV750</b>	<b>MII</b>
		Issue Date
		<b>October 2020</b>

Accessory	Application	Publication No.
<b>TOP BOX (SMART) P/N 08L70-MKT-D00</b>	<b>ADV750</b>	<b>MII</b>
		Issue Date
		<b>October 2020</b>

Accessory	Application	Publication No.
<b>TOP BOX (SMART) P/N 08L70-MKT-D00</b>	<b>ADV750</b>	<b>MII</b>
		Issue Date
		<b>October 2020</b>

**Honda Dealer: Please give a copy of these instructions to your customer.**

## PARTS LIST

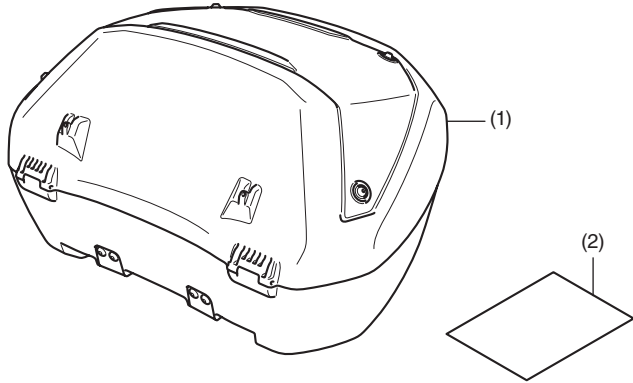

No.	Description	Qty
(1)	Top box	1
(2)	URL paper	1

## TOP BOX OPENER Sold separately

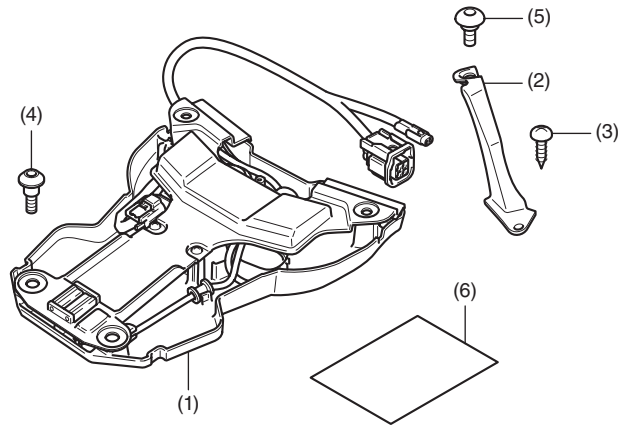

**For the installation, refer to the Installation Instructions of accessory.**

No.	Description	Qty
(1)	Lid opener	1
(2)	Harness cover	1
(3)	4 mm screw	1
(4)	5 mm screw (long)	4
(5)	5 mm screw (short)	1
(6)	URL paper	1

## REAR CARRIER Sold separately

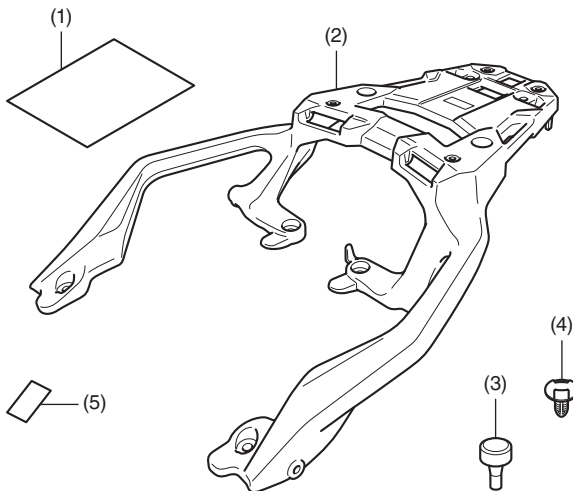

**For the installation, refer to the Installation Instructions of accessory.**

No.	Description	Qty
(1)	URL paper	1
(2)	Rear carrier	1
(3)	Stopper rubber <b>(Not used.)</b>	4
(4)	Clip	4
(5)	Protector film	2

- Stopper rubber should be used when installing the top box (other than SMART).
- Do not used stopper rubber when installing the top box (SMART).

## MAXIMUM LOADING CAPACITY

- The weight of the cargo must not exceed the following maximum loading capacity:

Maximum Loading Capacity	
Top box	6.0 kg (13.2 lb)

## FOR USE OF THE TOP BOX

### ⚠ CAUTION

- To prevent burns, allow the engine, exhaust system, radiator, etc., to cool before installing and removing the accessory.

### How to Open the Top box (State attached to the motorcycle)

1. Make sure the Honda SMART Key is activated, and then enter the operating range with the Honda SMART Key.
  - When you enter the operating range of the Honda SMART Key system with the Honda SMART Key on you, the top box can be opened.
2. Push the lid switch as shown and open the lid.

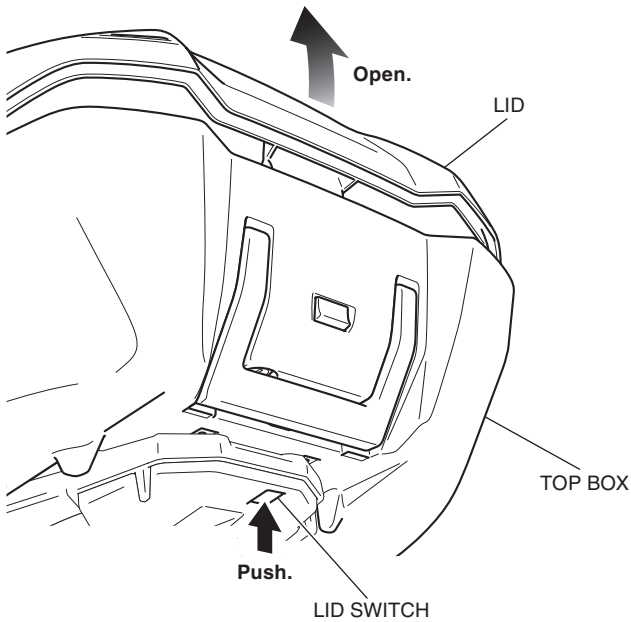

### How to Open the Top box (State removed from motorcycle)

1. Raise the handle as shown.

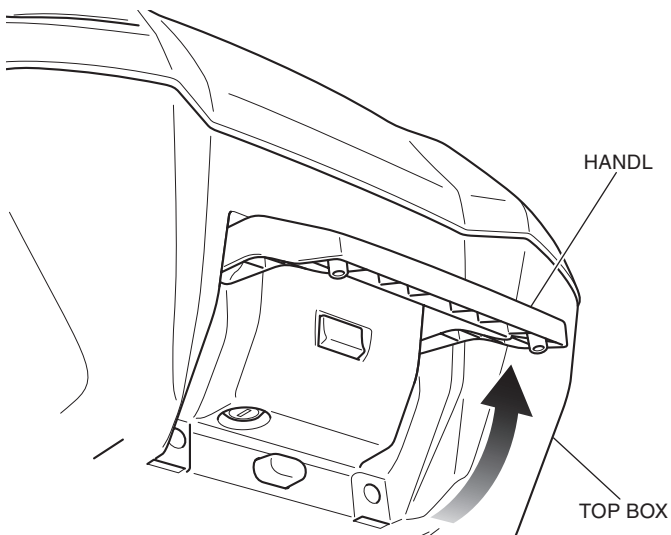

2. Insert the key and release the lock by turning the key clockwise.

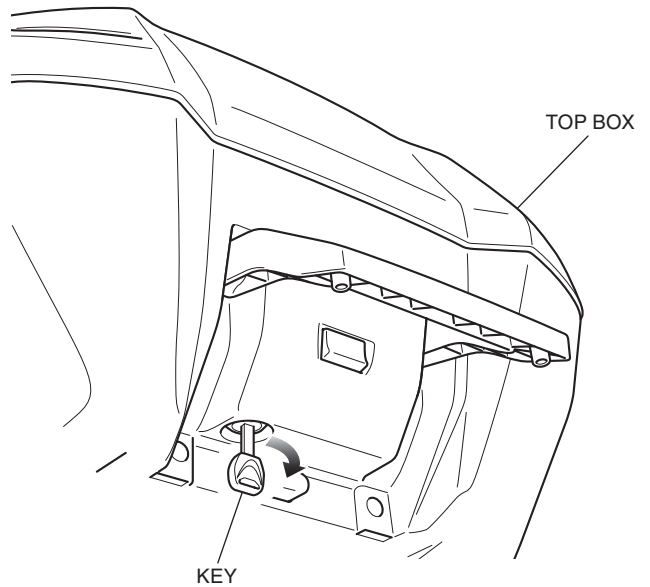

3. Push the lid opener button as shown and open the lid.

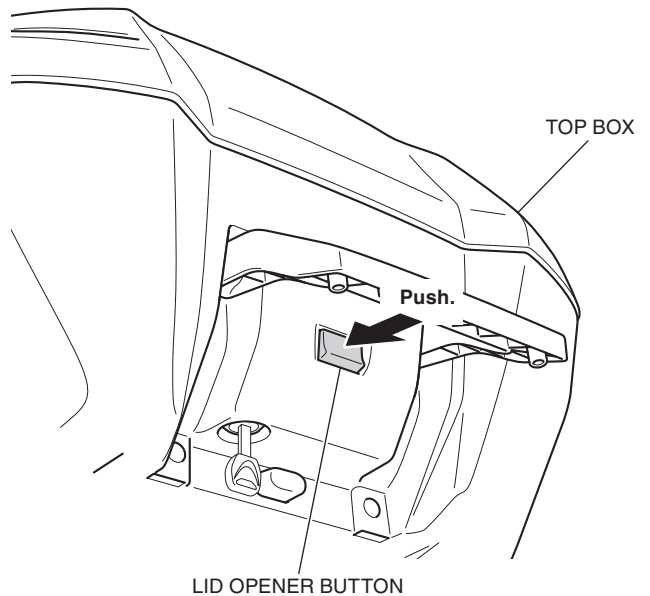

## How to Close the Top box (State attached to the motorcycle)

1. Close the lid as shown.
  - **Make sure the lid is locked down securely.**
  - **Be careful not to have the stored item pinched when the top box is closed.**

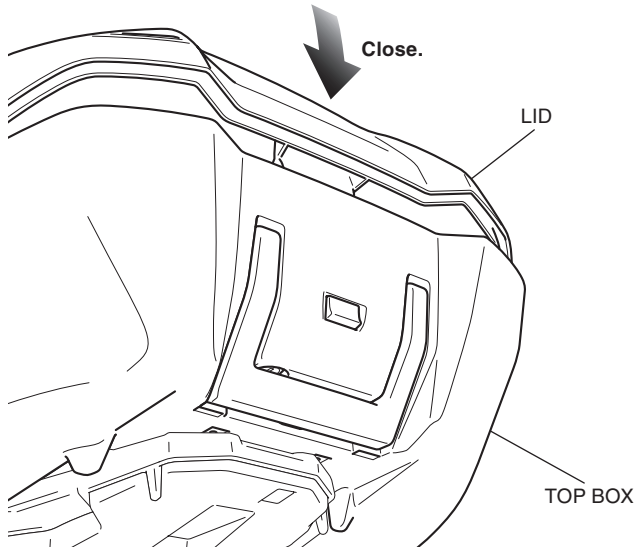

## How to Close the Top box (State removed from motorcycle)

1. Close the lid.

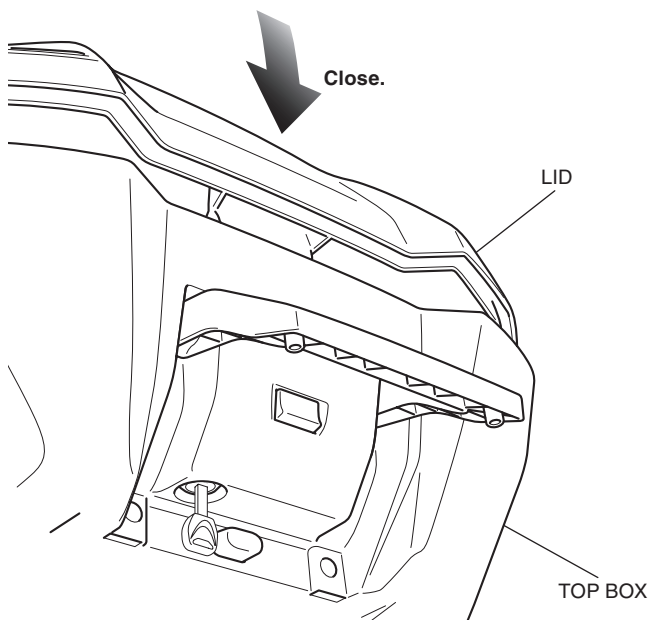

2. Turning the key counter-clockwise as shown.

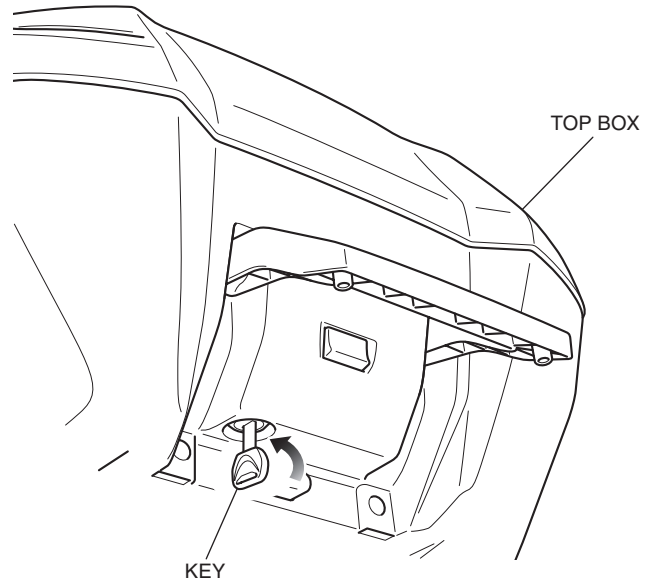

3. Remove the key, and lower the handle as shown.
  - **Make sure the lid is locked down securely.**
  - **Be careful not to have the stored item pinched when the top box is closed.**

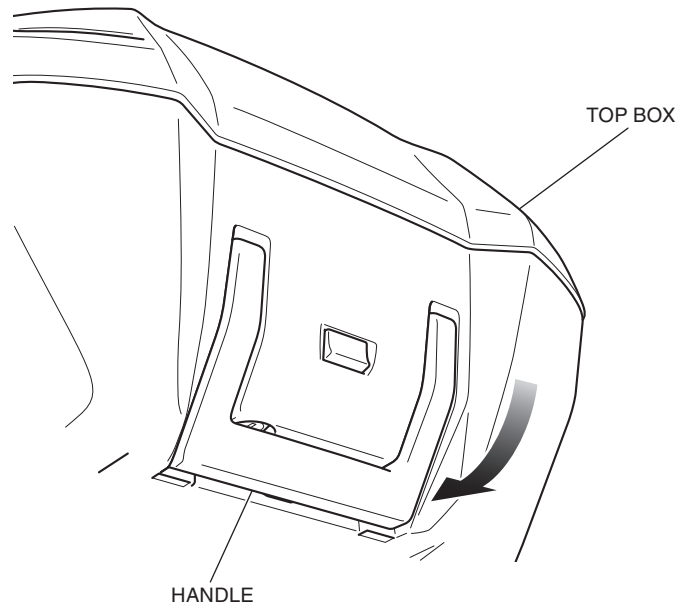

## How to Install the Top box

1. Install the separately sold rear carrier and top box opener.
2. Raise the handle as shown.

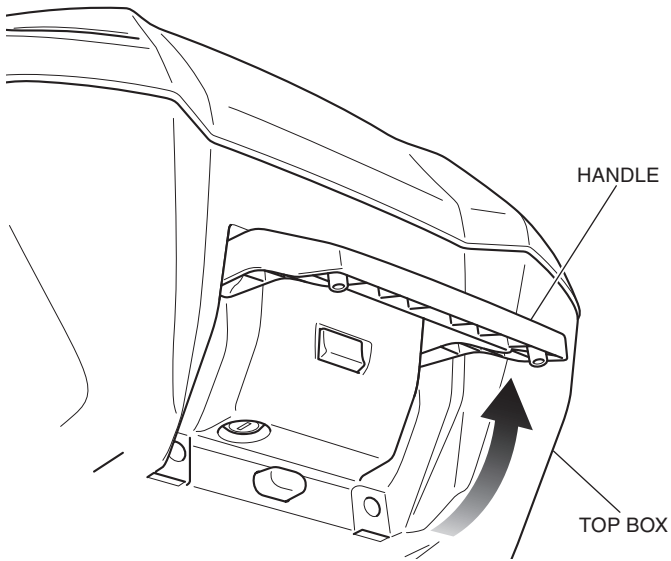

3. Insert the key and release the lock by turning the key clockwise.

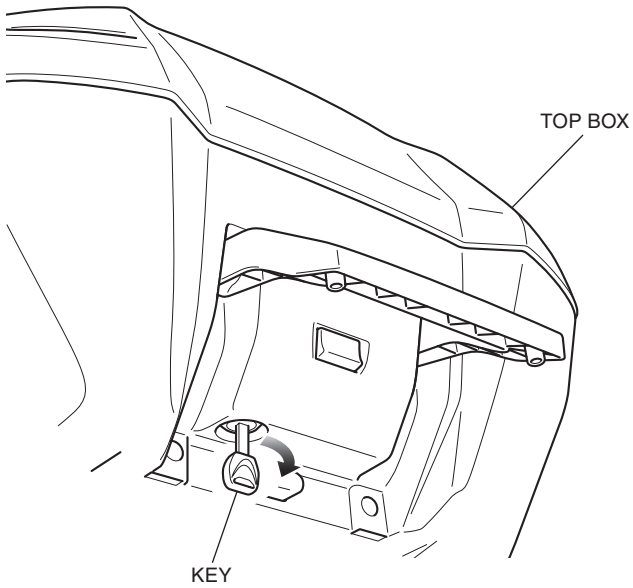

4. Insert the retaining tabs of the top box into the hole of the rear carrier as shown.

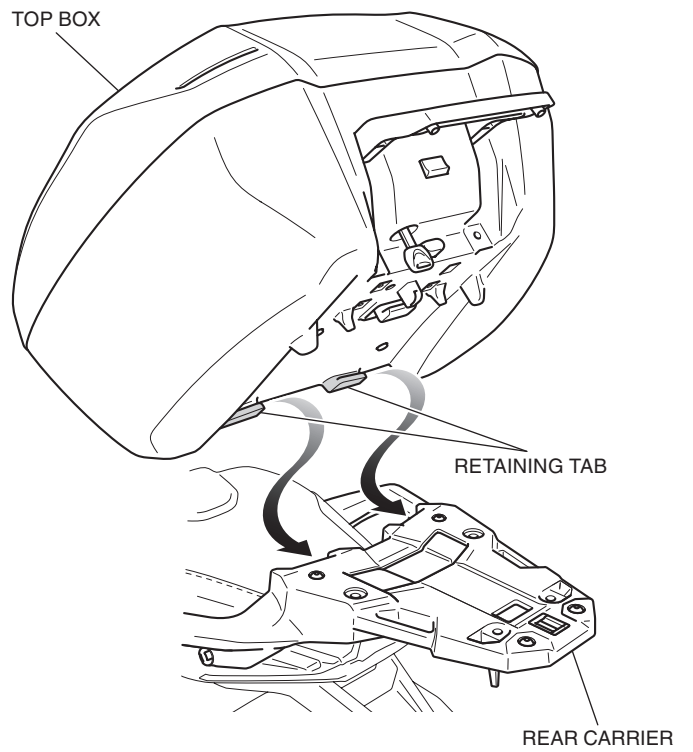

5. Position the hook of the top box on the rear carrier as shown.

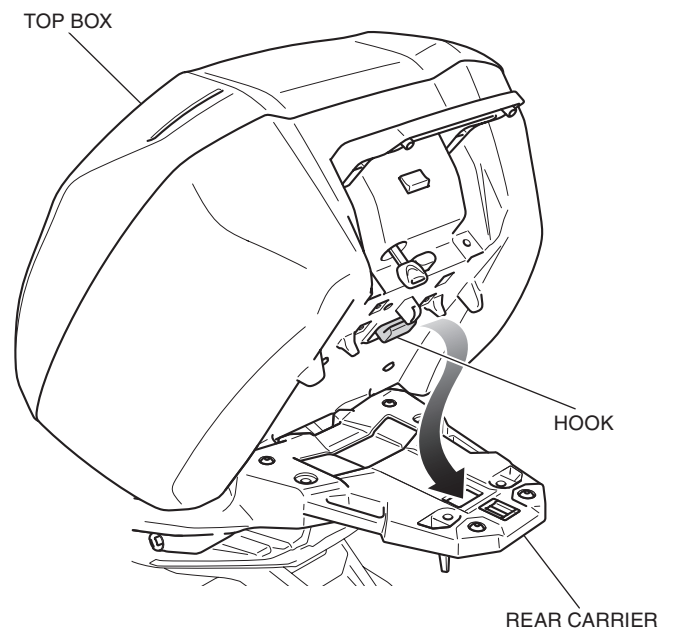

6. Lock the top box by turning the key counter-clockwise and remove the key.
- **When the key cannot be turned and removed, the top box may not be locked normally.**

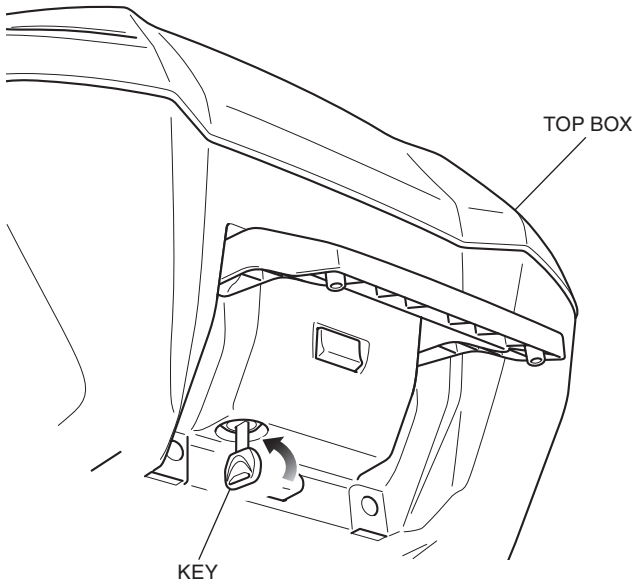

7. Lower the handle. Be sure that the top box is installed securely.

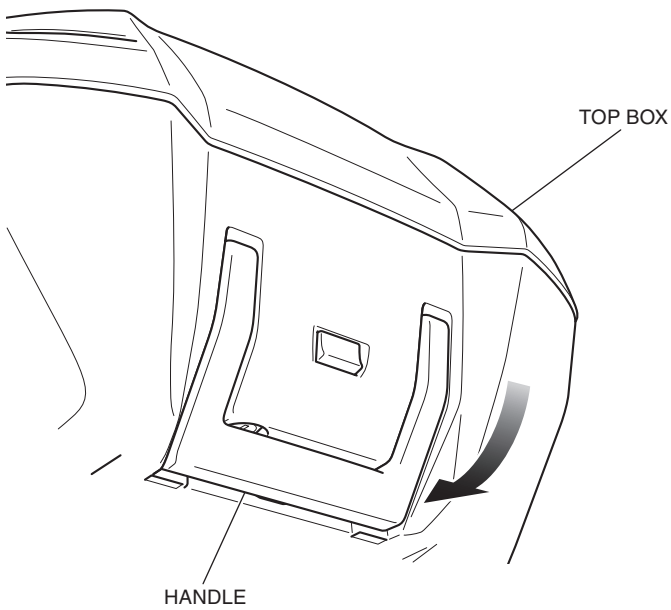

8. Check that the top box is installed securely by swinging the top box taking care not to fall the motorcycle down.
- **The top box can come off during riding unless it is mounted securely.**

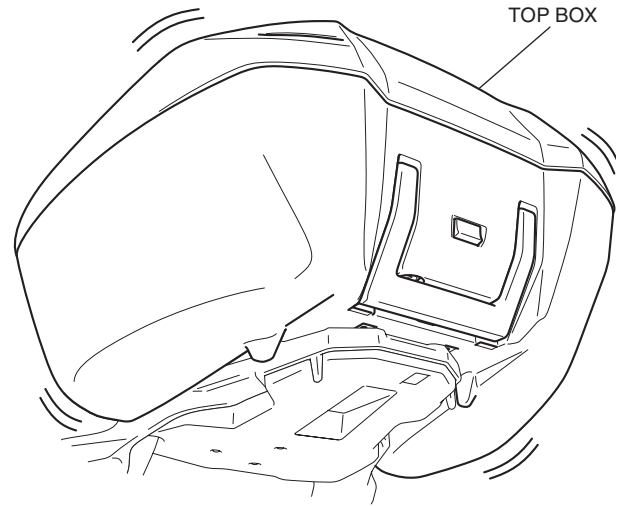

### How to Remove the Top box

1. Raise the handle as shown.

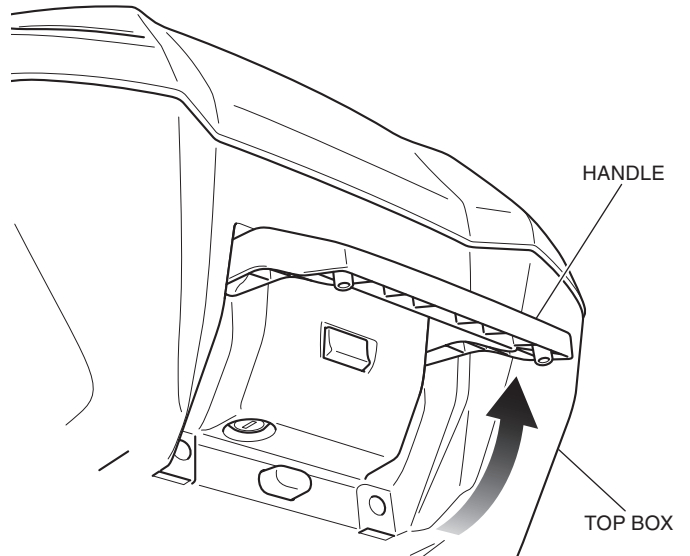

2. Insert the key and release the lock by turning the key clockwise.

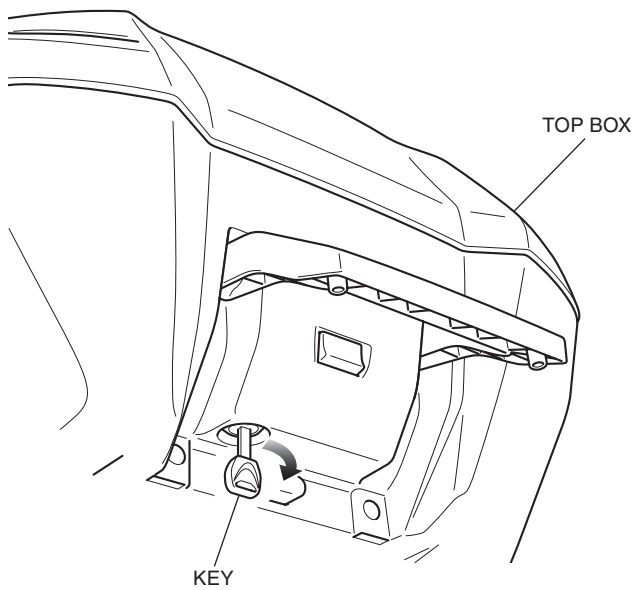

3. While pushing the hook button, lift up the top box and remove it from the rear carrier.

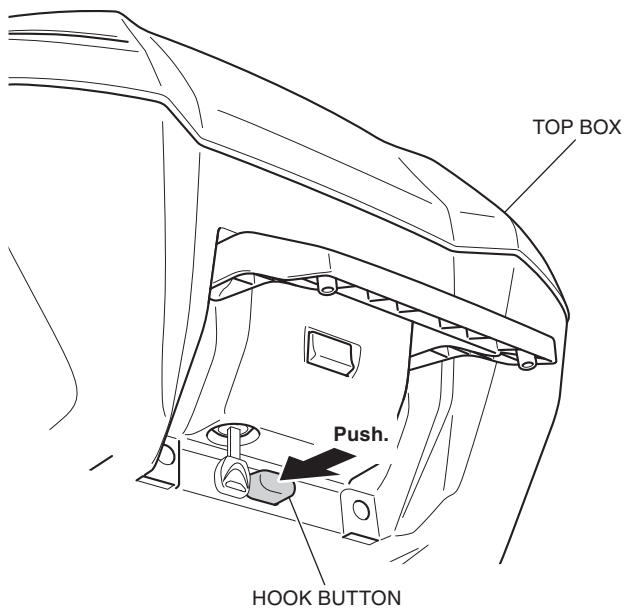

### How to Store the Top box inner bag

1. Open the top box and store the top box inner bag.
2. Close the top box.
  - **Be careful not to have the stored item pinched when the top box is closed.**