



INSTALLATION INSTRUCTIONS

Accessory	Application	Publication No.
CONSOLE BAG P/N 08L79-MKT-D00	ADV750	MII
		Issue Date
		October 2020

Accessory	Application	Publication No.
CONSOLE BAG P/N 08L79-MKT-D00	ADV750	MII
		Issue Date
		October 2020

Accessory	Application	Publication No.
CONSOLE BAG P/N 08L79-MKT-D00	ADV750	MII
		Issue Date
		October 2020

Honda Dealer: Please give a copy of these instructions to your customer.

PARTS LIST

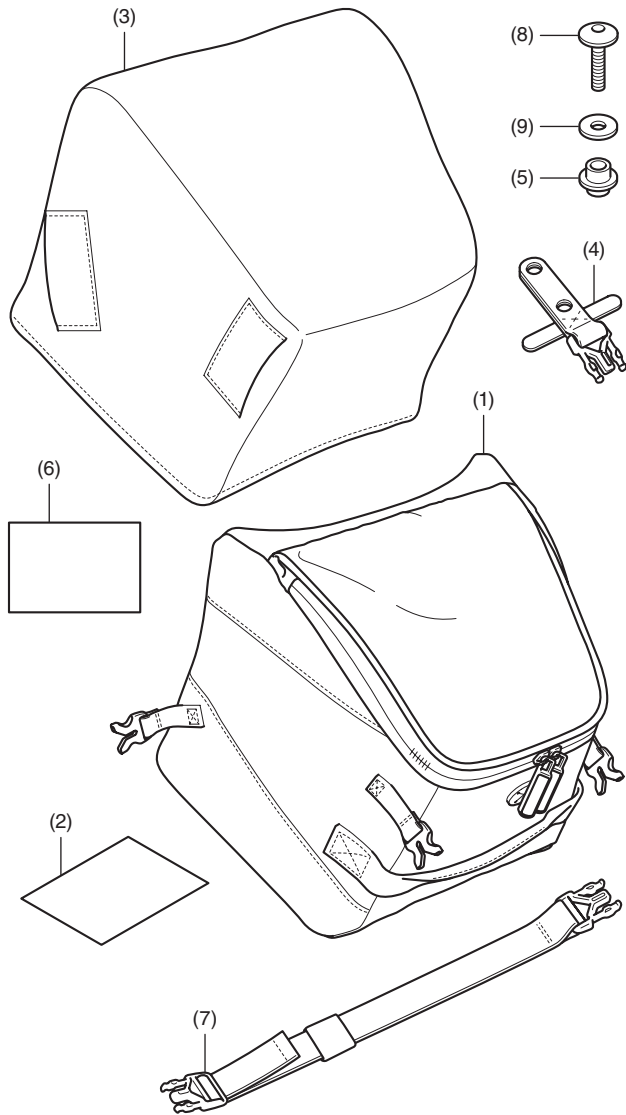

No.	Description	Qty
(1)	Console bag	1
(2)	URL paper	1
(3)	Rain cover	1
(4)	Strap	2
(5)	Collar	2
(6)	Protector seal	1
(7)	Adjust strap	1
(8)	5 mm screw	2
(9)	Washer	2

TOOLS AND SUPPLIES REQUIRED

- Hex wrench (5 mm)
- Tape
- Scissors
- Isopropyl alcohol
- Shop towel
- Torque wrench

TORQUE CHART

Tighten all screws, bolts, and nuts to their specified torque values. Refer to the Service Manual for the torque values of the removed parts.

Item	N-m	kgf-m	lbf-ft
5 mm screw	4.2	0.4	3.1

MAXIMUM LOADING CAPACITY

- The weight of the cargo must not exceed the following maximum loading capacity:

Maximum Loading Capacity	
Console bag	3.0 kg (6.6 lb)

INSTALLATION

▲ CAUTION

- To prevent burns, allow the engine, exhaust system, radiator, etc., to cool before installing the accessory.

NOTE:

- Heat the bonding surfaces with a hair dryer if the ambient air temperature is below 70°F (21°C).
- The adhesive reaches full strength in 72 hours. Wait at least 24 hours before riding your motorcycle.
- Before installation, remove all dust, sand, etc. from console bag installation part and console bag, as otherwise the console bag installation part may be damaged.

- Remove the screws as shown.

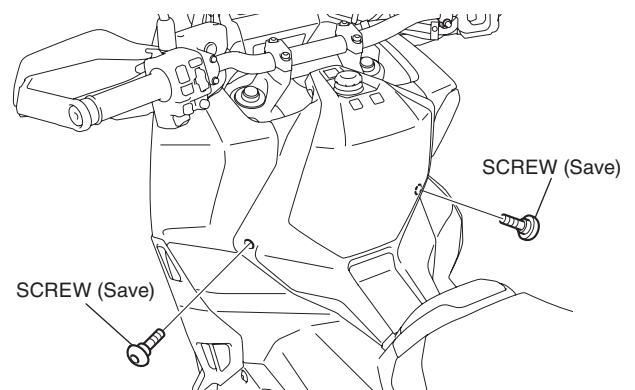

2. Cut out the two templates along the solid line and attach it to the protector seal.

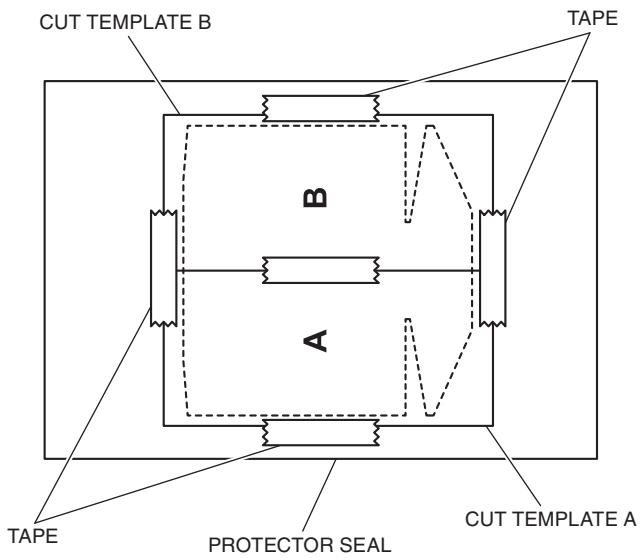

3. Cut both the templates and protector seal together along the dotted line as shown.

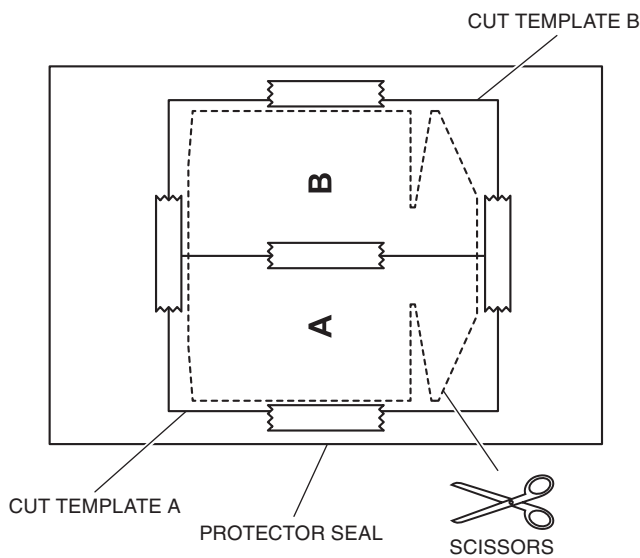

4. Clean the surface of the area shown using an isopropyl alcohol.

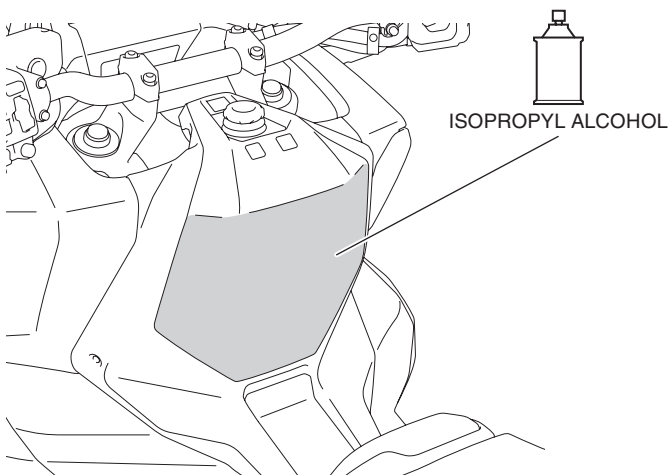

5. Attach the protector seal to the inner cover as shown.

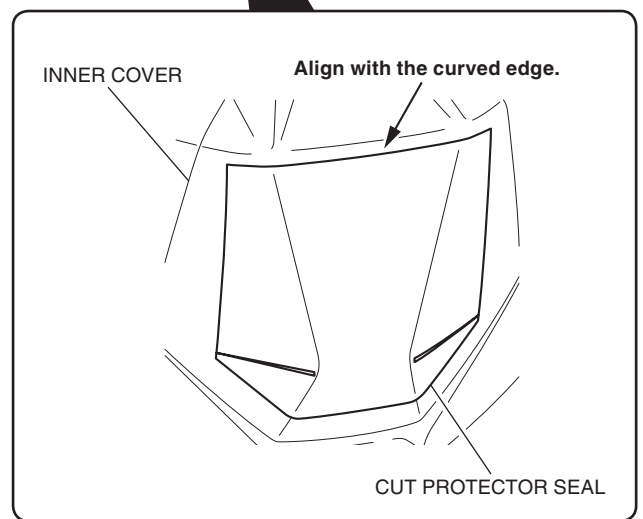
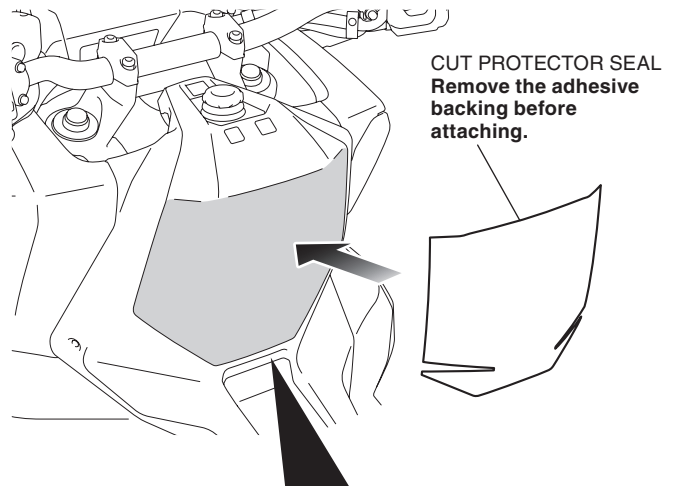

6. Install the strap as shown.
 - Repeat on the right side.

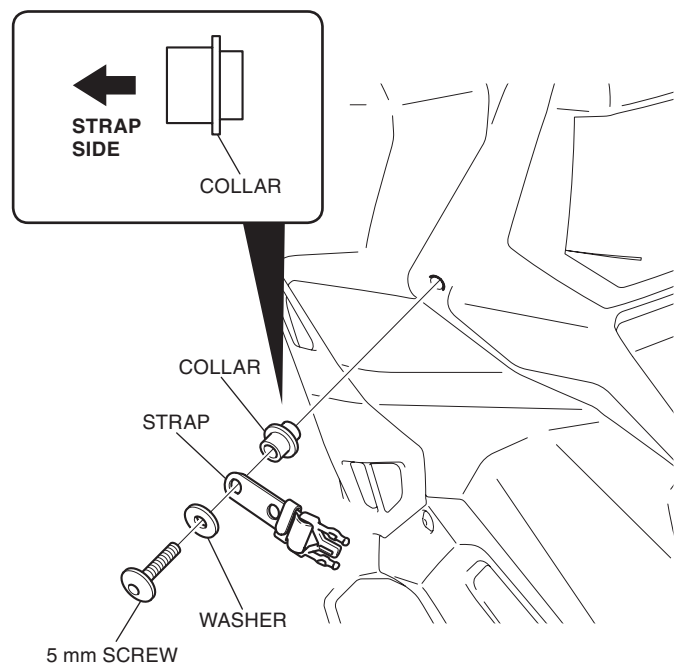

7. Open the seat, and route the adjust strap as shown.

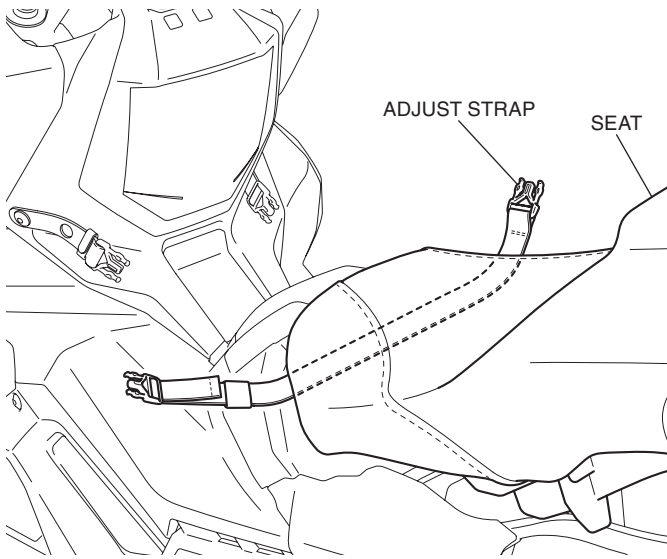

8. Install the console bag as shown.

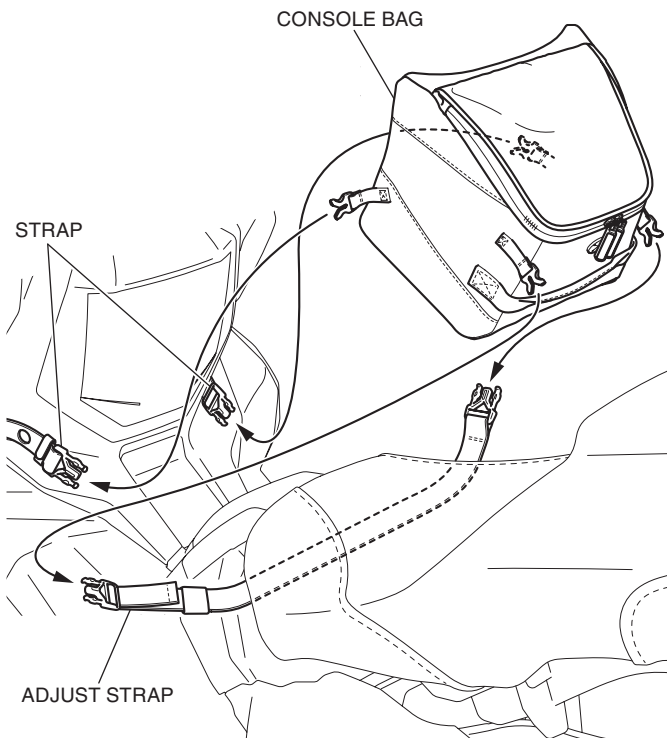

9. Tighten the adjust strap as shown, and close the seat.

- **Secure well by pulling the adjust strap tight.**

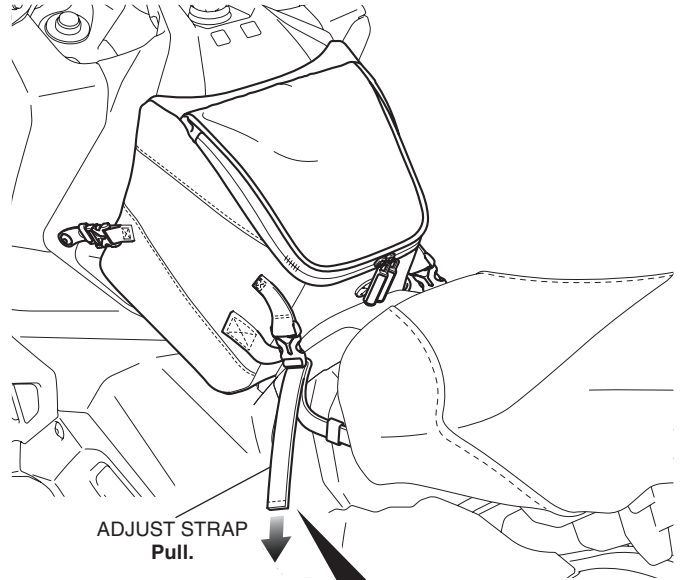

Pass the excess adjust strap through the elastic band.

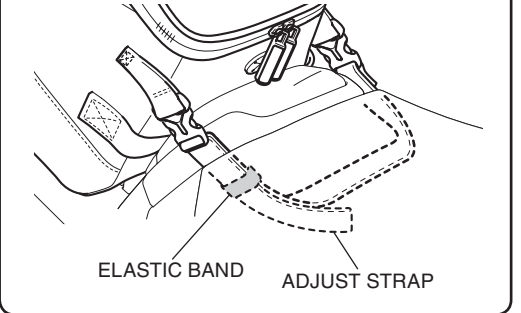

10. Check that the console bag is installed securely by swinging the console bag taking care not to fall the motorcycle down.

- **The console bag can come off during riding unless it is mounted securely.**

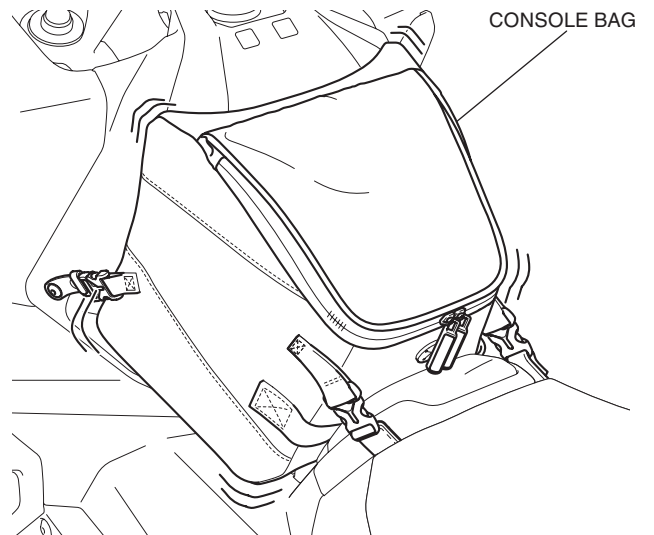

<TEMPLATE>

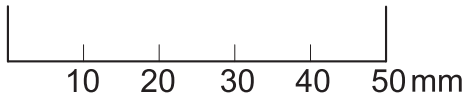
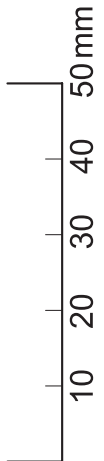
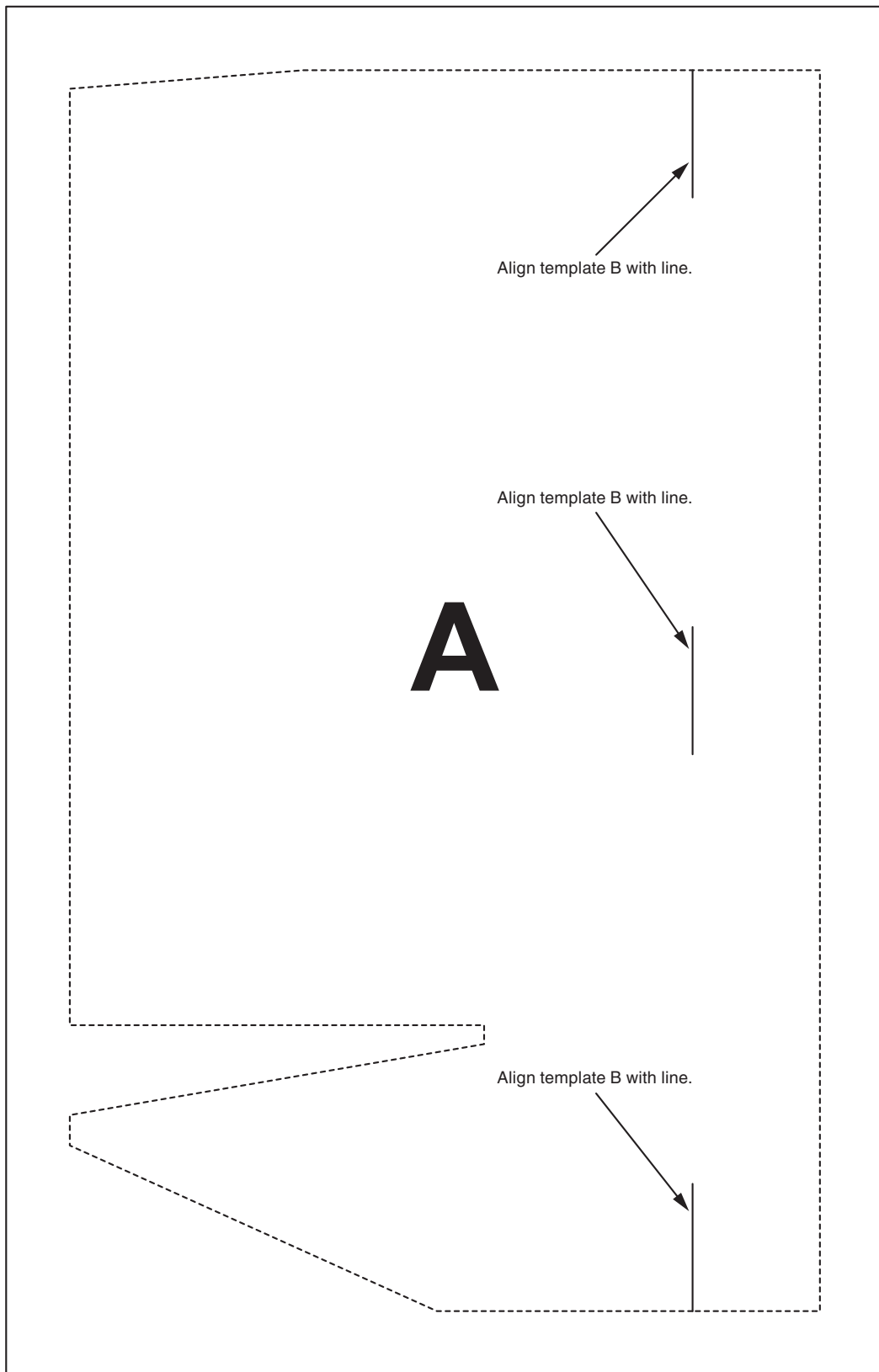

<TEMPLATE>

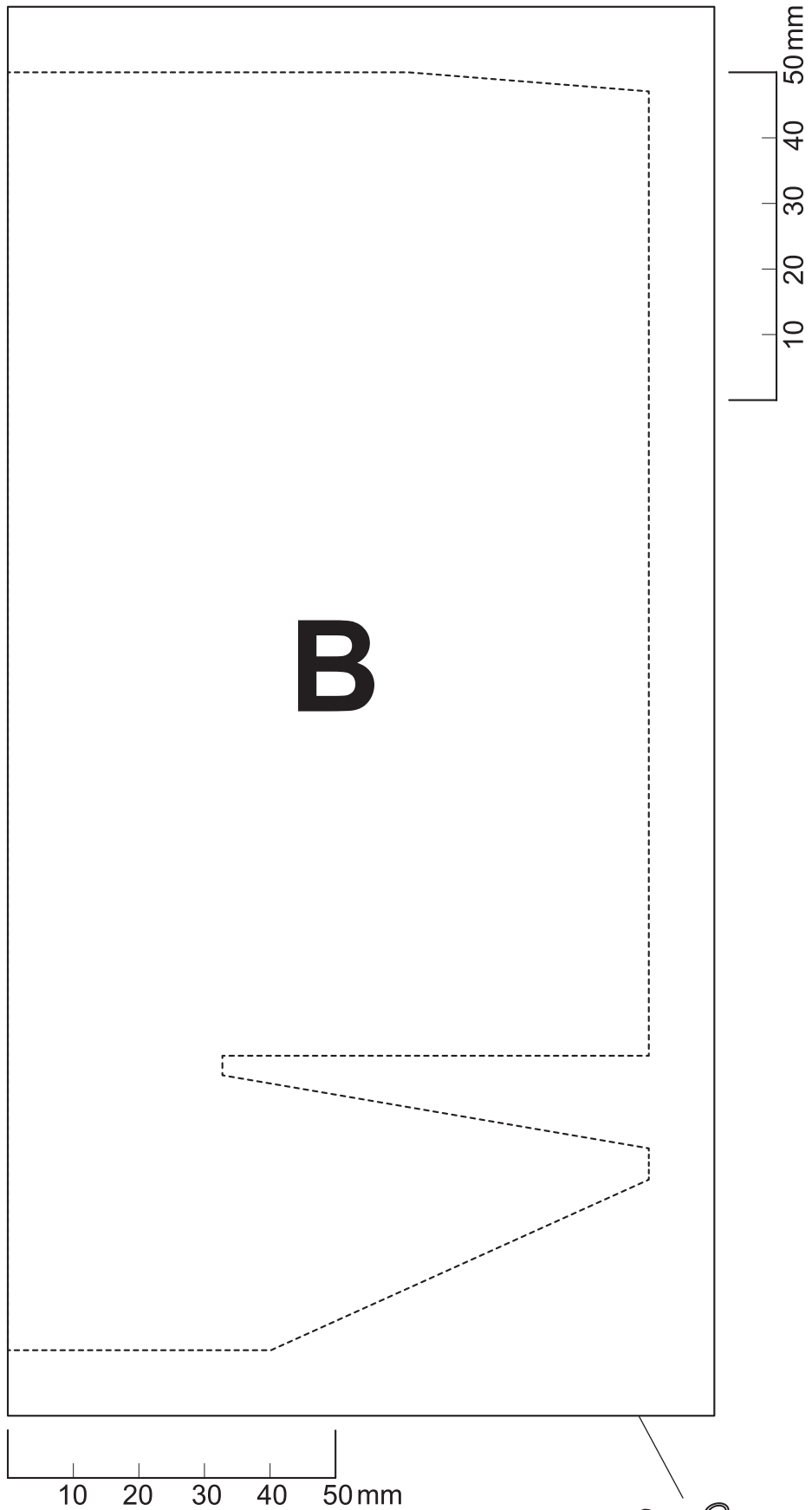

B

