



INSTALLATION INSTRUCTIONS

Accessory
FRONT LED FOG LIGHT ATTACHMENT
 P/N 08E71-MKT-D00

Application
ADV750

Publication No.
MII
 Issue Date
December 2020

Honda Dealer: Please give a copy of these instructions to your customer.

PARTS LIST

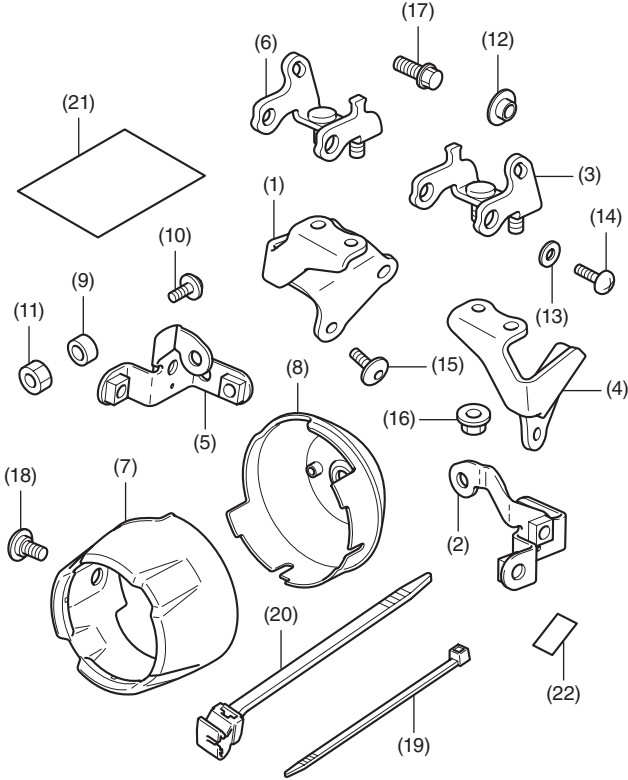

No.	Description	Qty
(1)	Right fog mount stay	1
(2)	Fog stay A (for left side)	1
(3)	Fog inner stay (for left side)	1
(4)	Left fog mount stay	1
(5)	Fog stay A (for right side)	1
(6)	Fog inner stay (for right side)	1
(7)	Fog lamp cover	2
(8)	Fog lamp cap	2
(9)	Collar	2
(10)	6 mm bolt (Silver)	2
(11)	6 mm nut	2
(12)	Flange collar	4
(13)	Washer	4
(14)	6 mm screw	4
(15)	6 mm bolt (Black)	4
(16)	6 mm flange nut	4
(17)	6 mm SH flange bolt	2
(18)	6 mm shoulder socket screw	4
(19)	Wire tie	2
(20)	Harness clip	2
(21)	URL paper	1
(22)	Protector film	2

SIDE PIPE

Sold separately

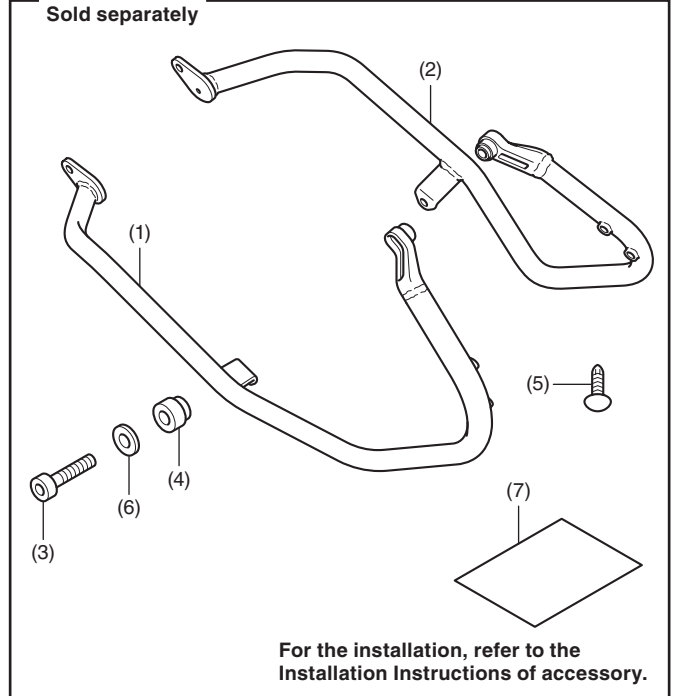

No.	Description	Qty
(1)	Right side pipe	1
(2)	Left side pipe	1
(3)	8 mm socket bolt	6
(4)	Collar	4
(5)	Clip (Not used.)	4
(6)	Washer	6
(7)	URL paper	1

FRONT FOG LIGHT

Sold separately

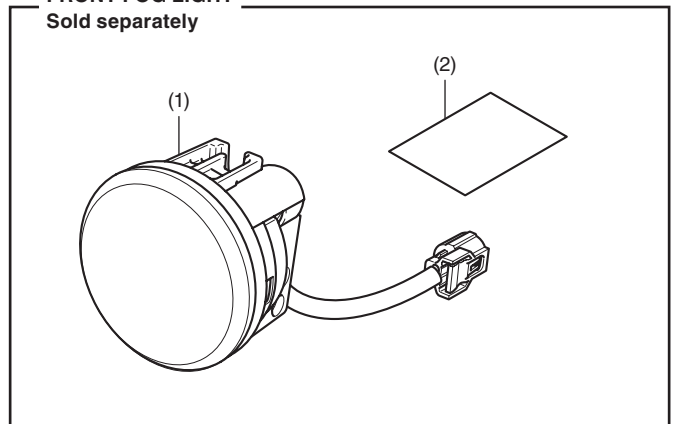

No.	Description	Qty
(1)	Front fog light	2
(2)	URL paper	1

TOOLS AND SUPPLIES REQUIRED

Socket (8 and 10 mm)
Ratchet
Hex wrench (5 mm)
Phillips ® screwdriver
Nippers
Marker
Scale
Electrical tape
Isopropyl alcohol
Shop towel
Torque wrench

TORQUE CHART

Tighten all screws, bolts, and nuts to their specified torque values. Refer to the Service Manual for the torque values of the removed parts.

Item	N·m	kgf·m	lbf·ft
6 mm screw	9	0.9	6.6
6 mm shoulder socket screw	9	0.9	6.6
6 mm bolt	10	1.0	7
6 mm SH flange bolt	10	1.0	7
6 mm flange nut	12	1.2	9

INSTALLATION

▲ CAUTION

- To prevent burns, allow the engine, exhaust system, radiator, etc., to cool before installing the accessory.

NOTE:

- Heat the bonding surfaces with a hair dryer if the ambient air temperature is below 70°F (21°C).
- The adhesive reaches full strength in 72 hours. Wait at least 24 hours before riding your motorcycle.
- Disconnect the negative (-) cable from the battery before installing this accessory.
- The memories of the clock will be erased when you disconnect the battery. Reset the memories after reconnecting the battery.
- Reinstall the removed parts on the motorcycle and make sure that the wires and harnesses are not pinched.
- Cut the wire tie and harness clip at 5 mm from the lock part after attaching them to the wire harnesses. Do not allow the cut part of the wire tie and harness clip to interfere with another harness or brake hose.
- Setting is necessary after installing this accessory.

1. Open the seat.
2. Remove the maintenance lid as shown, and disconnect the negative (-) cable of the battery.

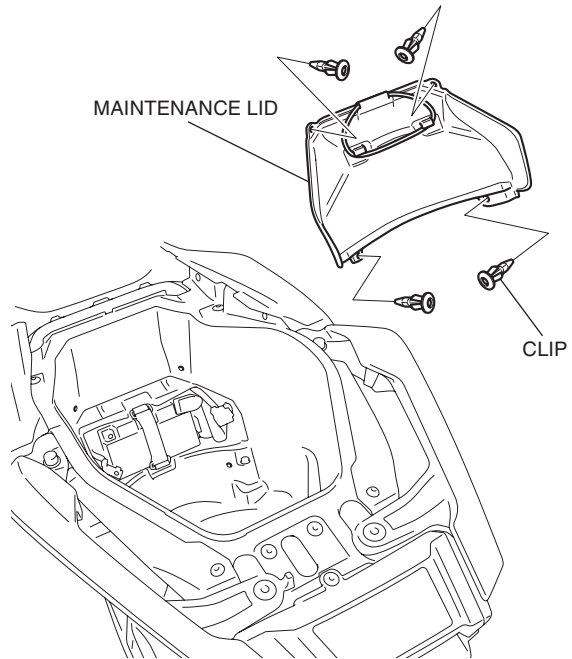

3. Remove the left rear cowl as shown.
<Left side>

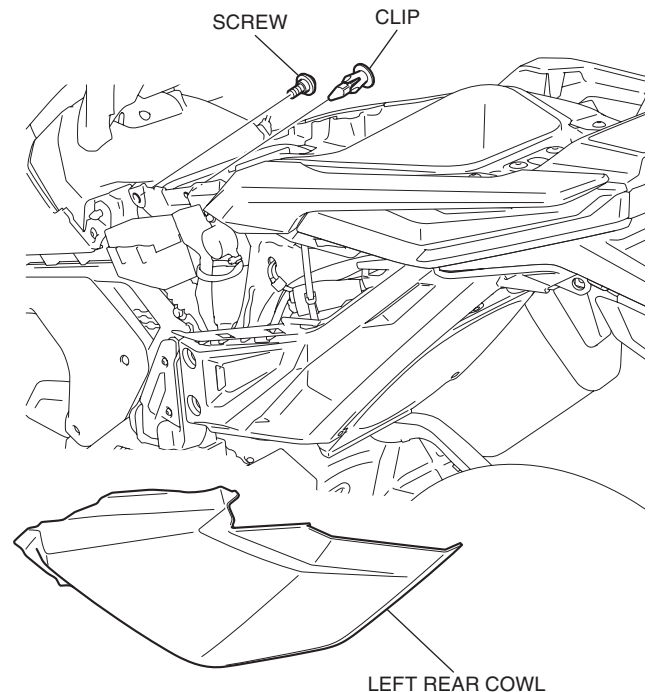

4. Remove the left side pipe as shown.
- Perform this step for the motorcycle equipped with the side pipe.
 - Repeat on the right side.

<Left side>

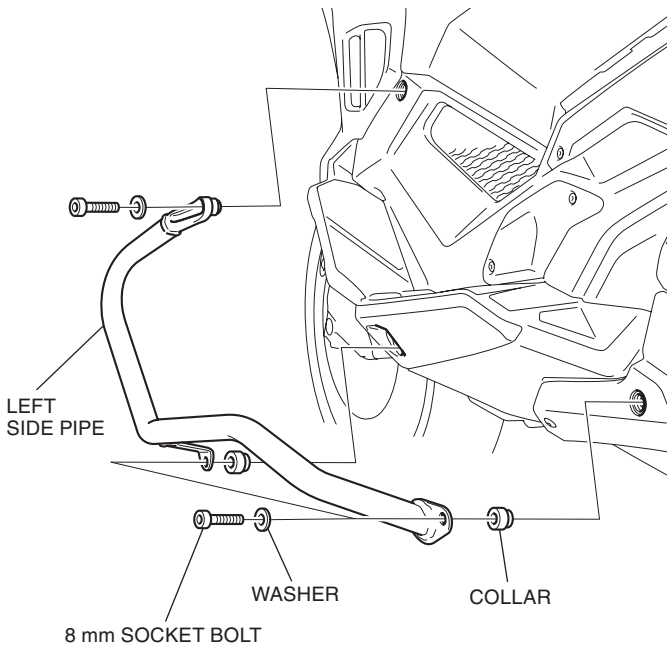

5. Remove the inner cover as shown.

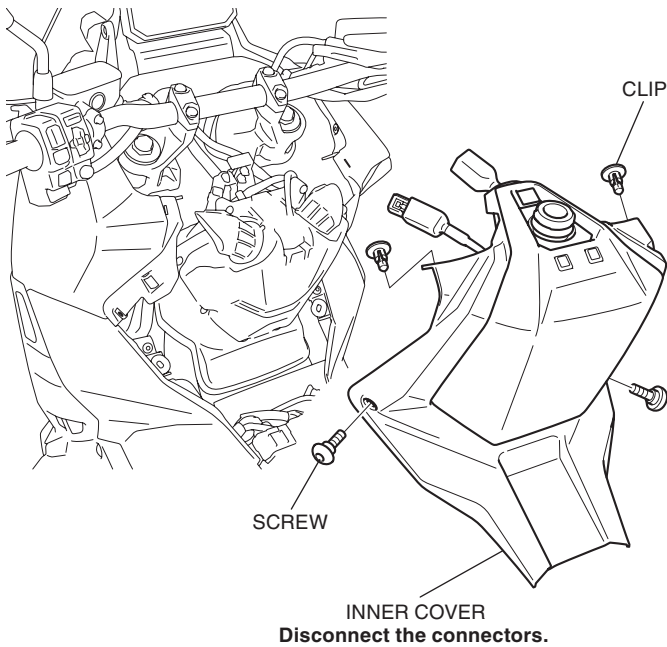

6. Remove the screws as shown.

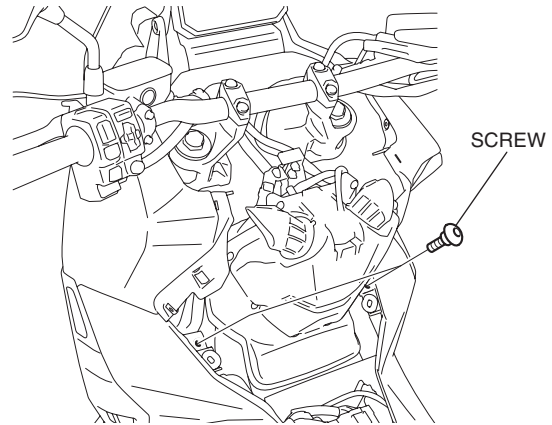

7. Remove the left inner upper panel and screw as shown.
- Repeat on the right side.

<Left side>

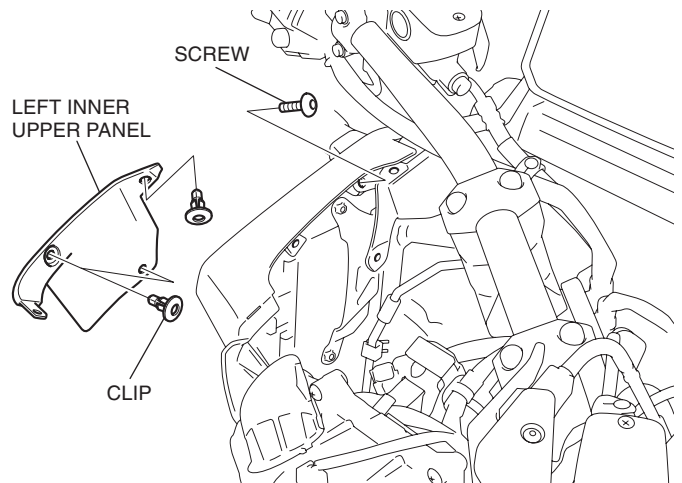

8. Remove the clips as shown.

<Left side>

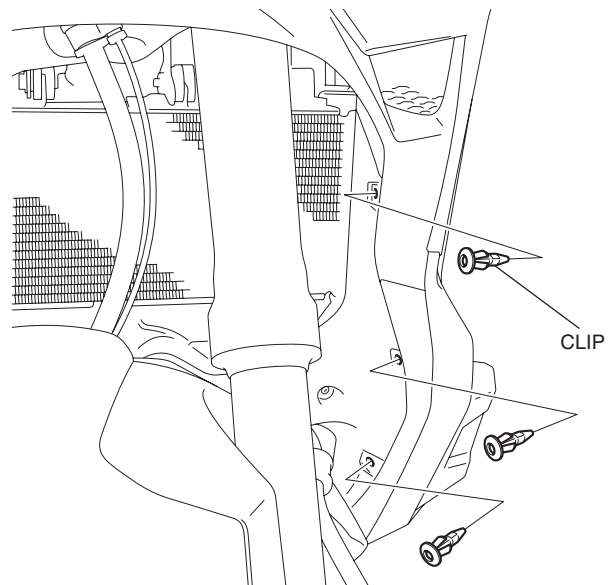

9. Remove the left side cowl as shown.

<Left side>

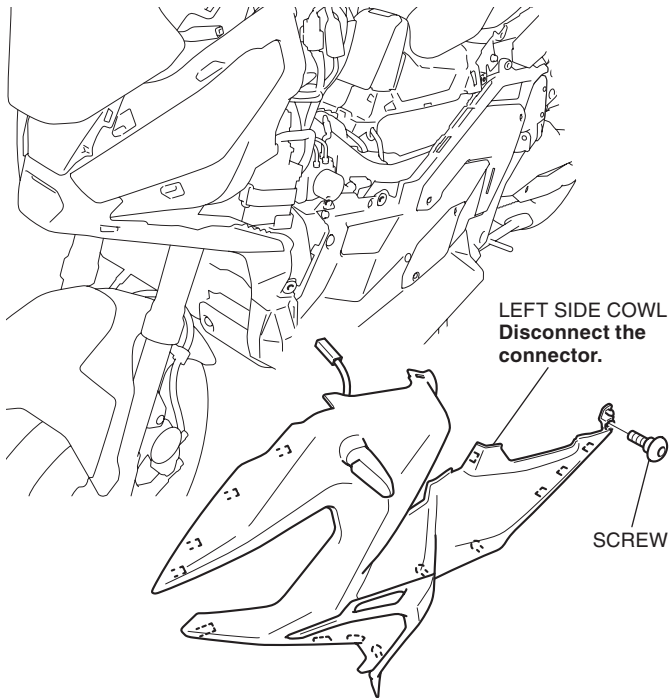

10. Mark the front fog light harness at the position with the indicated dimensions.

<for Left side>

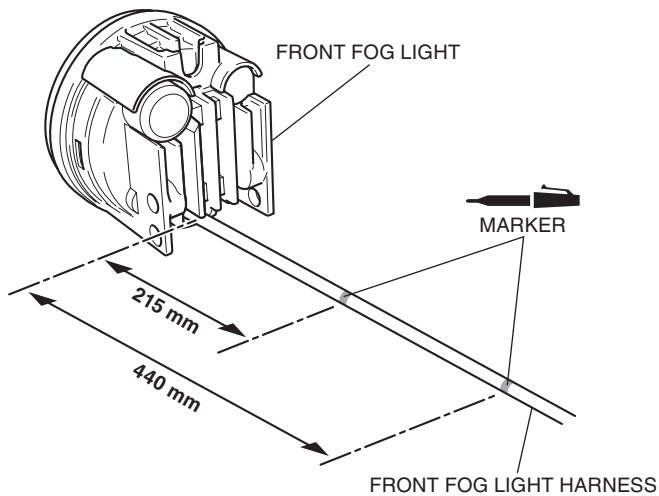

<for Right side>

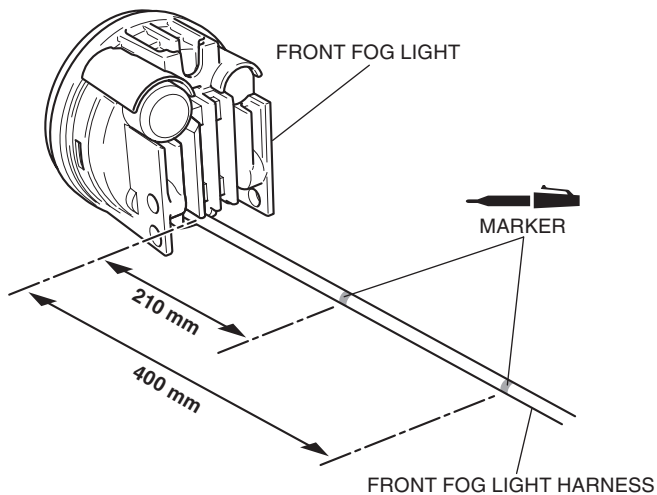

11. Install the harness clip as shown.

- Perform this step for both fog lights.

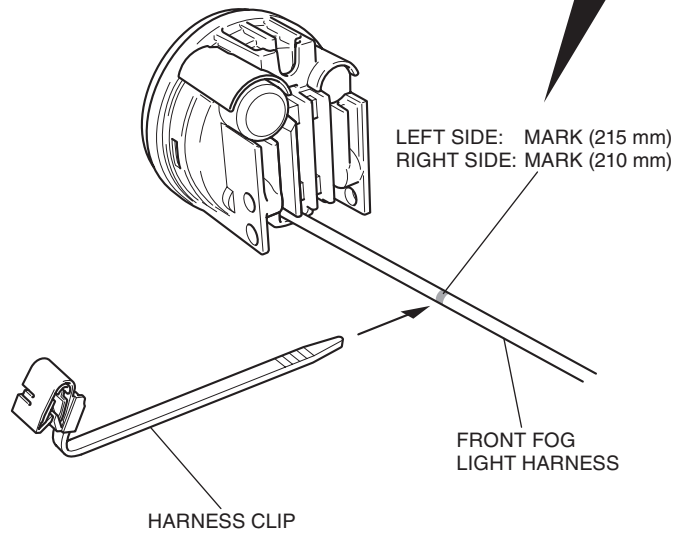
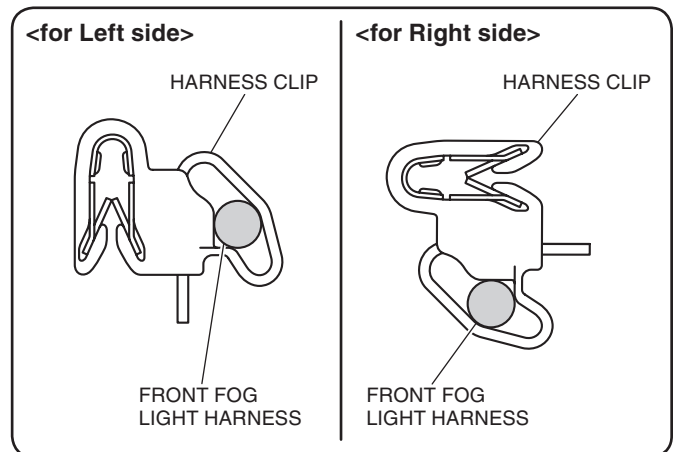

12. Bundle the front fog light harness as shown.
<for Left side>

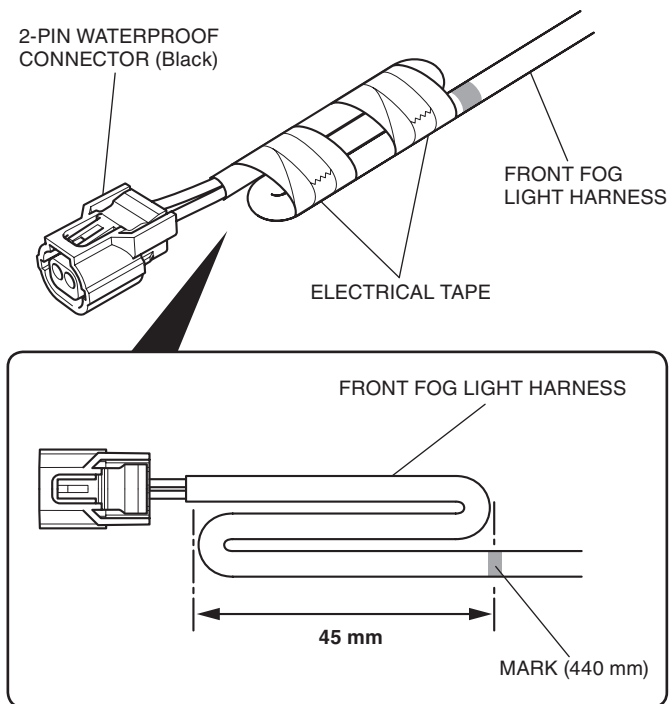

<for Right side>

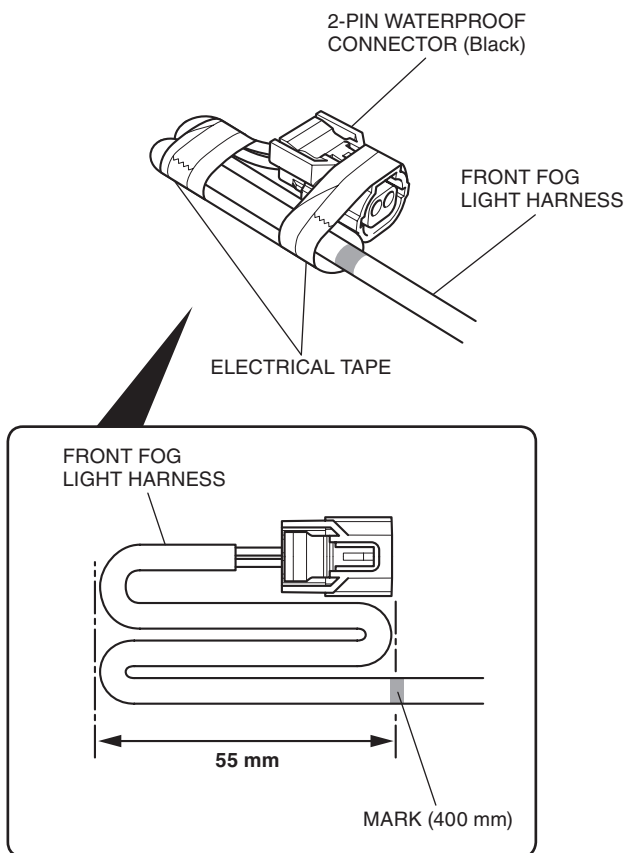

13. Install the flange collars to the fog inner stay (for right side) as shown.

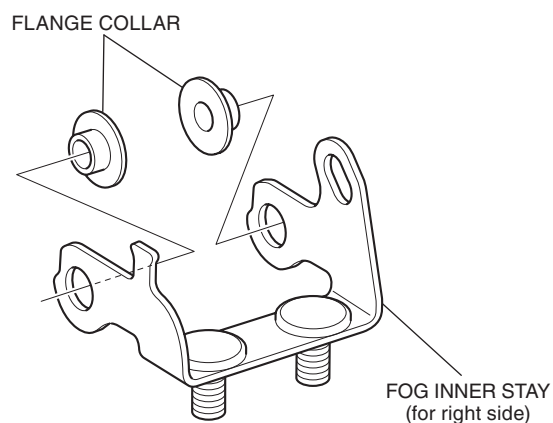

14. Loosely install the assembled fog inner stay (for right side) as shown.

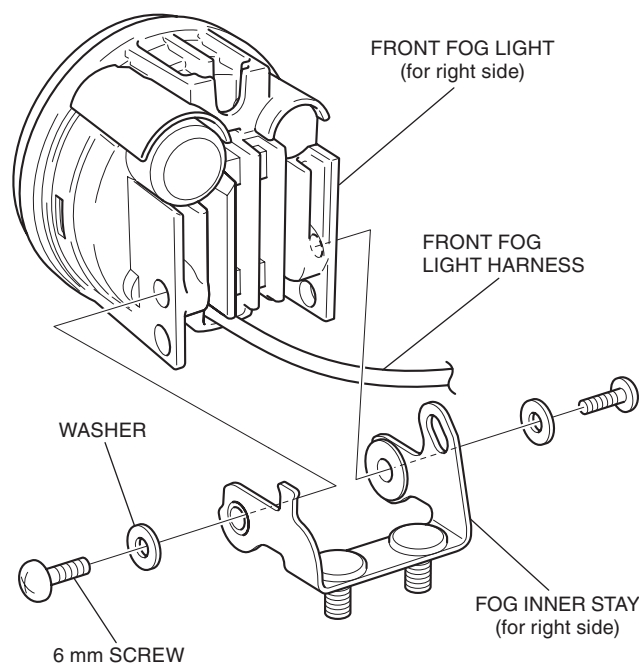

15. Install the 6 mm nut to the assembled right front fog light as shown.

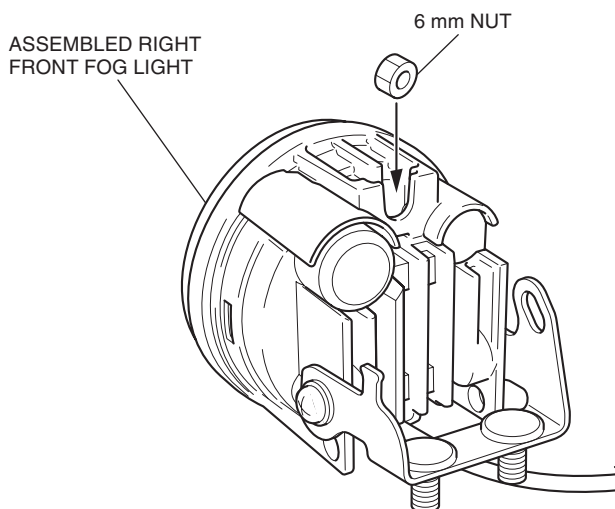

16. Loosely install the fog stay A (for right side) as shown.

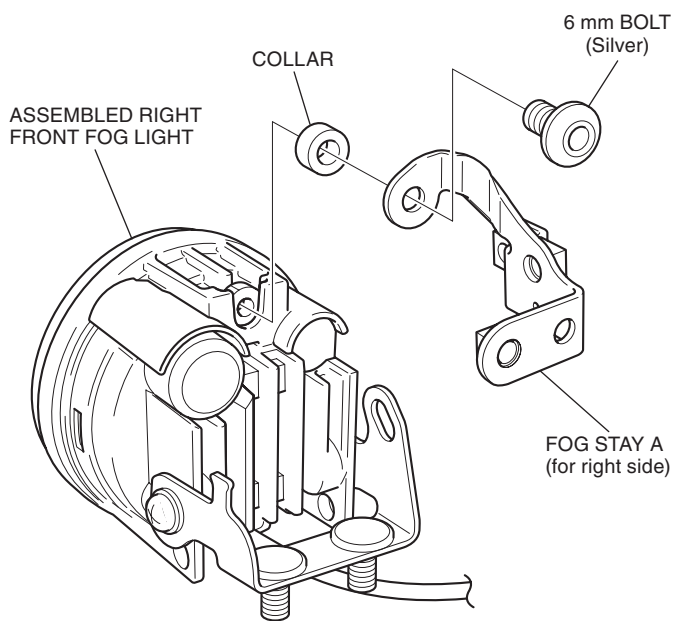

17. Secure the fog inner stay (for right side) and fog stay A (for right side) as shown.

- **To adjust the fog light aiming, loosen the 6 mm SH flange bolt and 6 mm screws.**

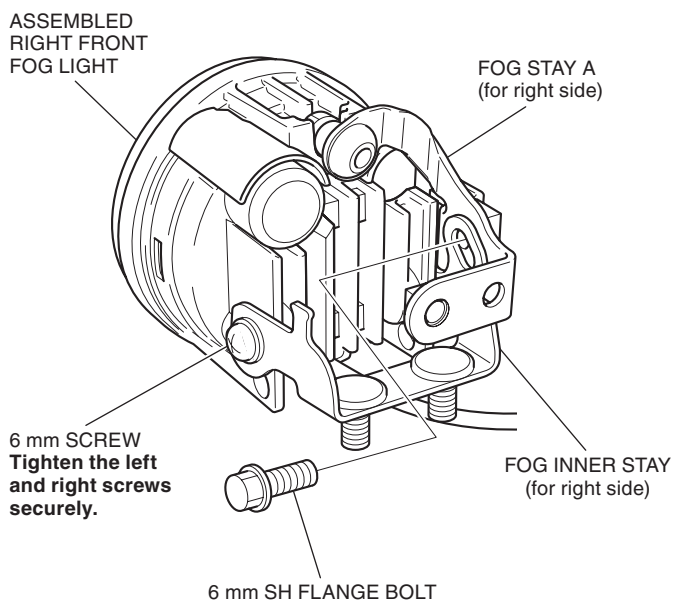

18. Clean the surface of the area shown using an isopropyl alcohol.

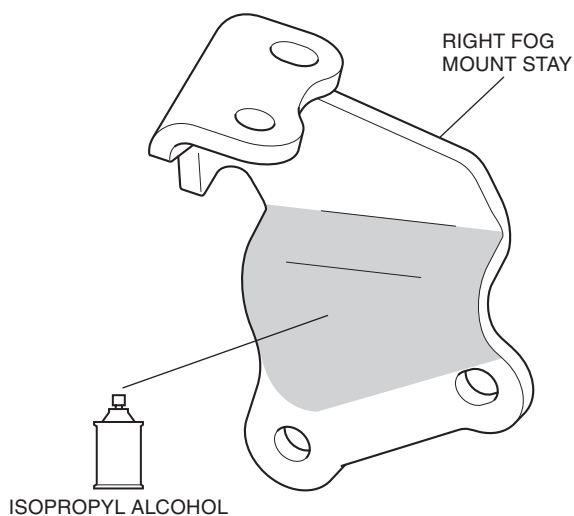

19. Attach the protector film to the position shown.

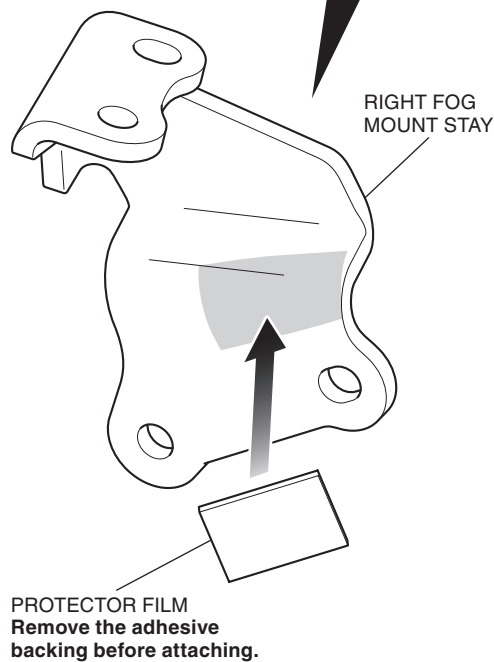
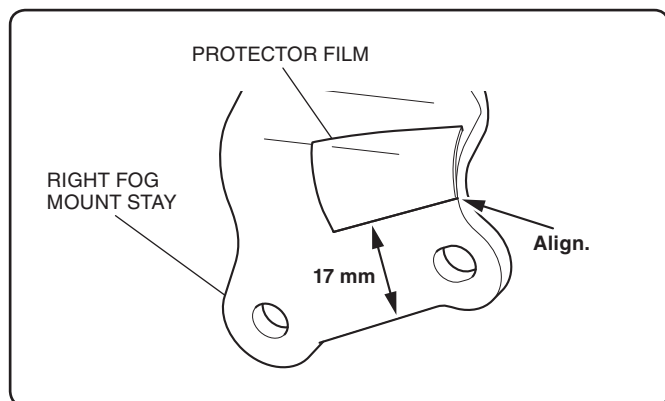

20. Install the right fog mount stay as shown.

- To adjust the fog light aiming, loosen the 6 mm flange nuts.

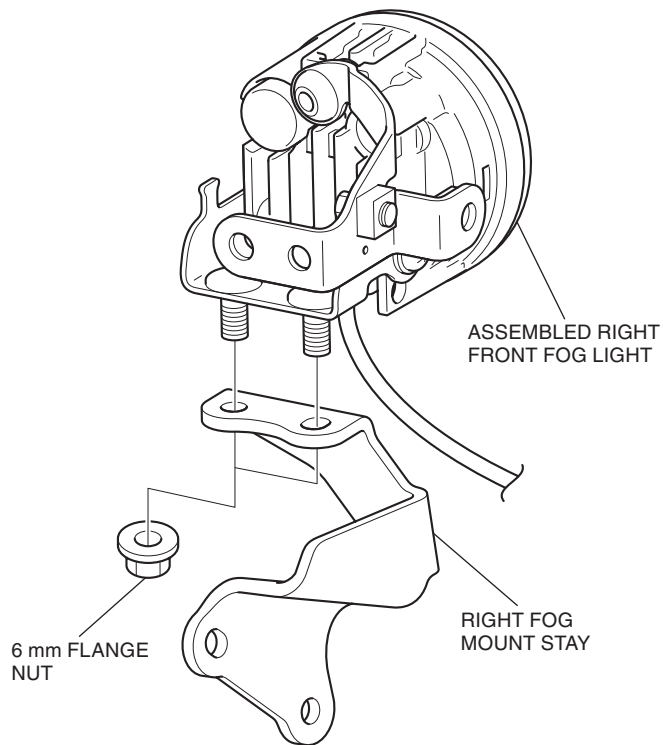

21. Install the fog lamp cover as shown.

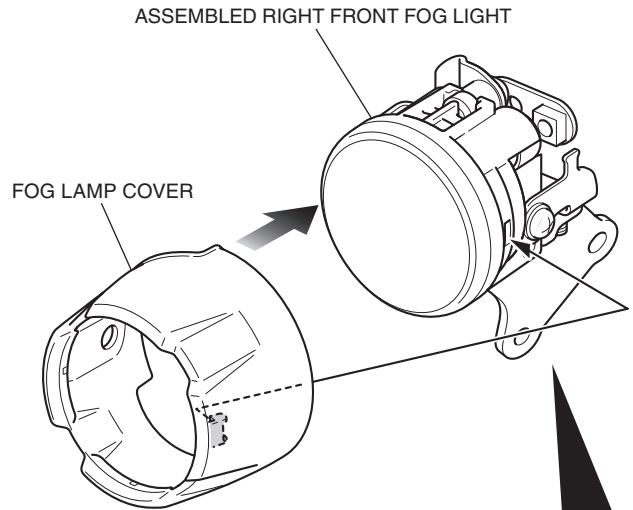

Put the front fog light with the tabs of fog lamp cover.

<Rear side>

ASSEMBLED RIGHT FRONT FOG LIGHT

TAB

FOG LAMP COVER

22. Secure the fog lamp cover as shown.

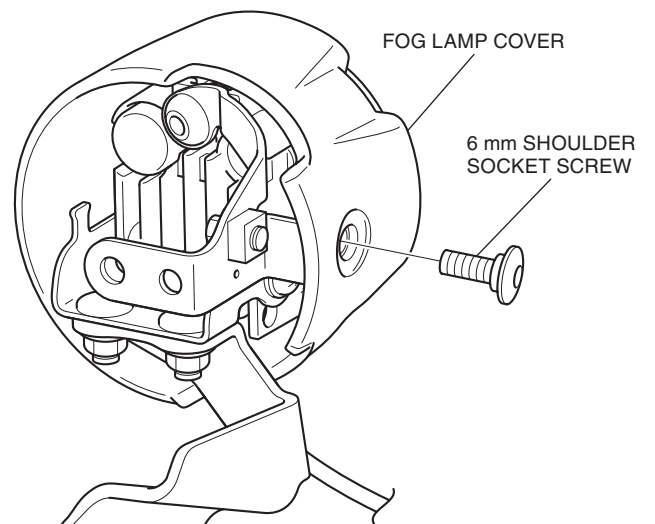

23. Assemble the left front fog light in the same manner as the right side.

24. Remove the clips as shown.
- **Perform this step for the motorcycle equipped with the side pipe.**
 - **Repeat on the right side.**

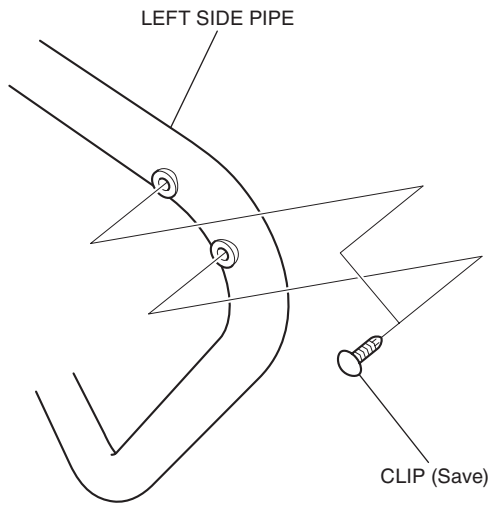

25. Install the assembled left front fog light as shown.
- **Repeat on the right side.**

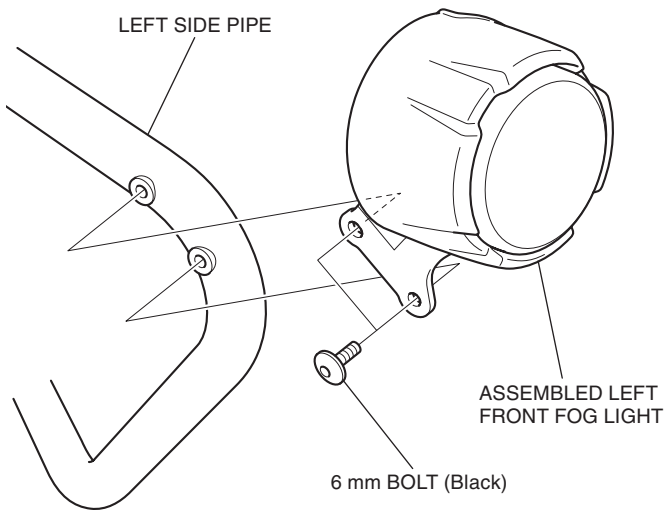

26. Perform the step 1 and 3 to 6 on the Side pipe (sold separately) installation instructions.

27. Route the left front fog light harness and secure the harness clip to the left front lower cover as shown.
- **Repeat on the right side.**

<Left side>

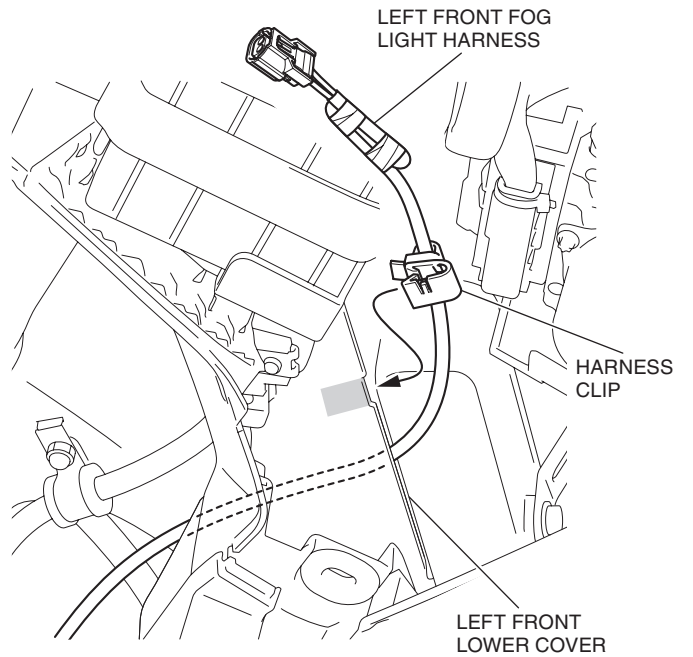

28. Remove the dummy connector as shown.

<Left side>

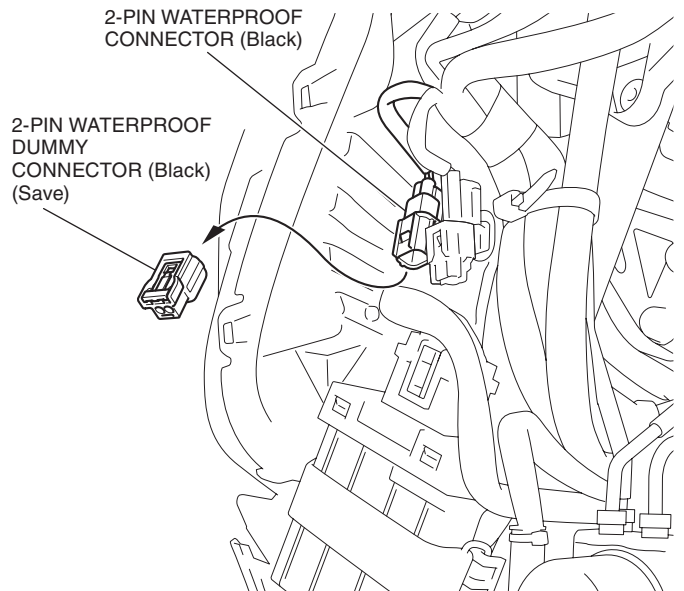

29. Connect the left front fog light harness as shown.

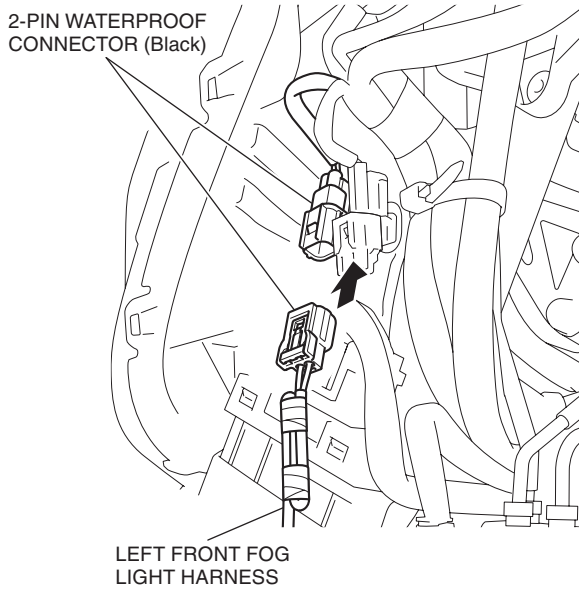

30. Secure the left front fog light harness with the wire tie as shown.

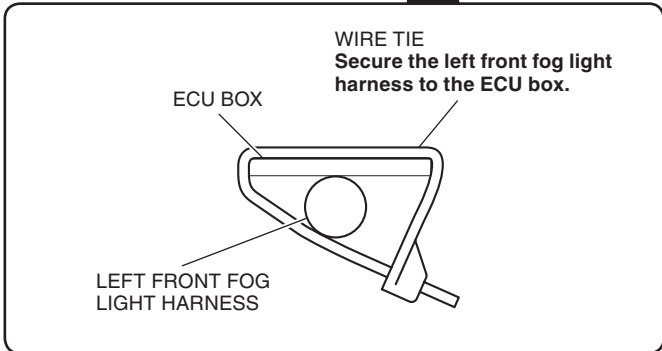
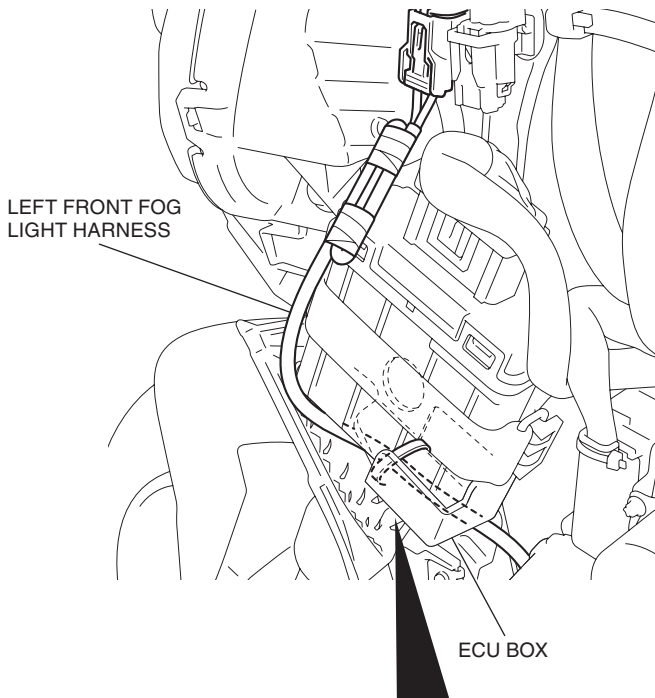

31. Remove the dummy connector as shown.

<Right side>

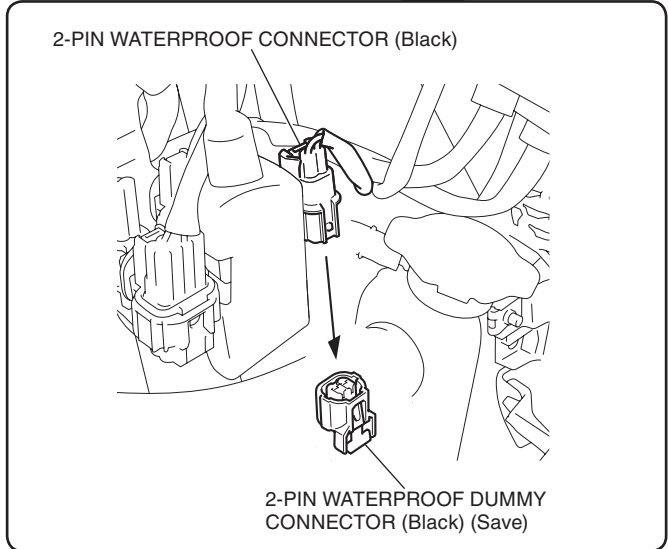
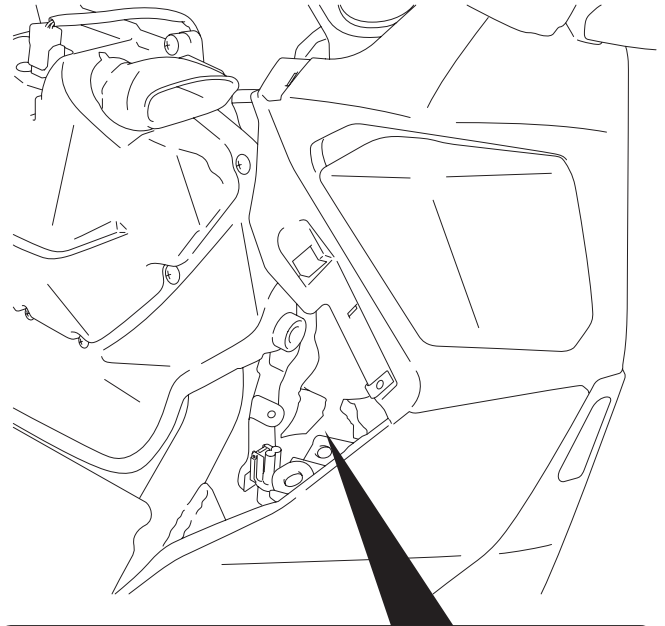

32. Route and connect the right fog light harness as shown.

2-PIN WATERPROOF CONNECTOR (Black)

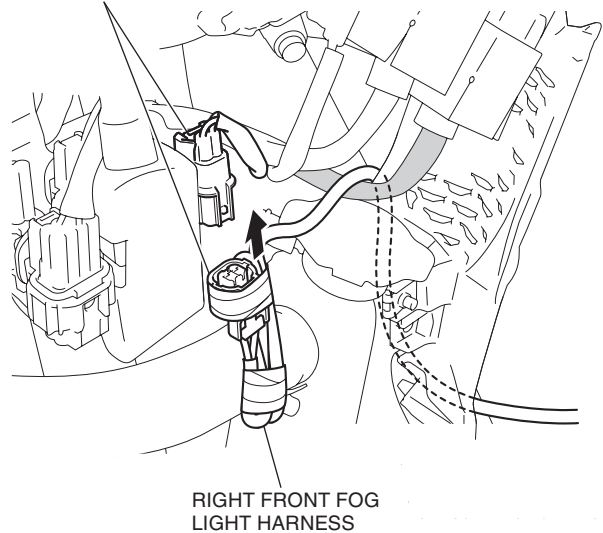

33. Secure the right front fog light harness with the wire tie as shown.

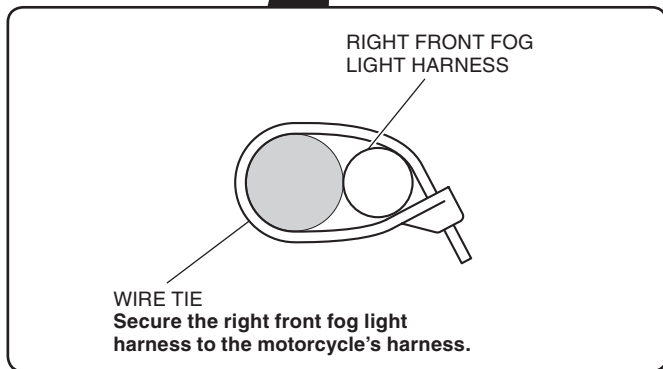
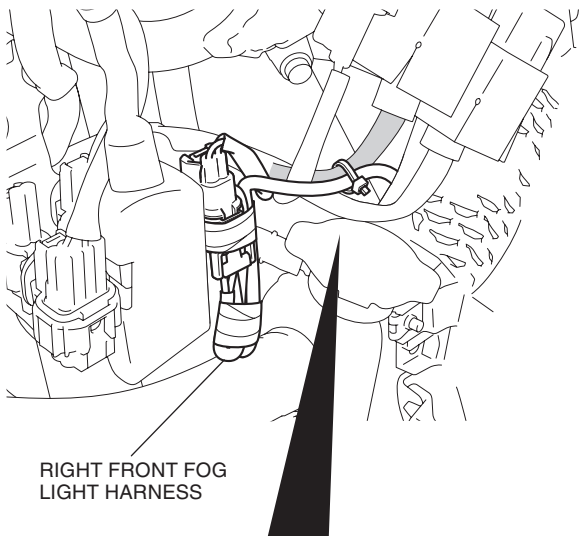

34. Install the motorcycle's parts in the reverse order of removal.

- Confirm that any wire harness is not caught or too tight.
- After installing the fog light, perform the setting.

35. Perform the ADJUSTING THE FOG LAMP AIMING.

36. Install the fog lamp cap as shown.

- Repeat on the left side.

<Right side>

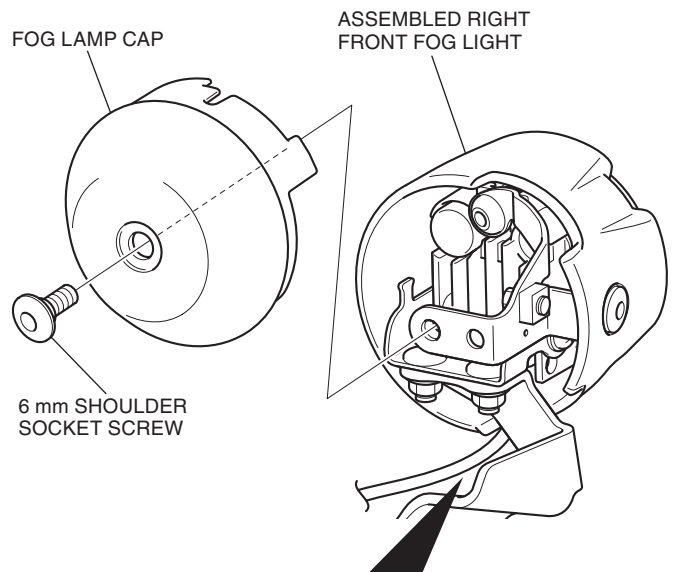

Install with the both clear apertures aligned.

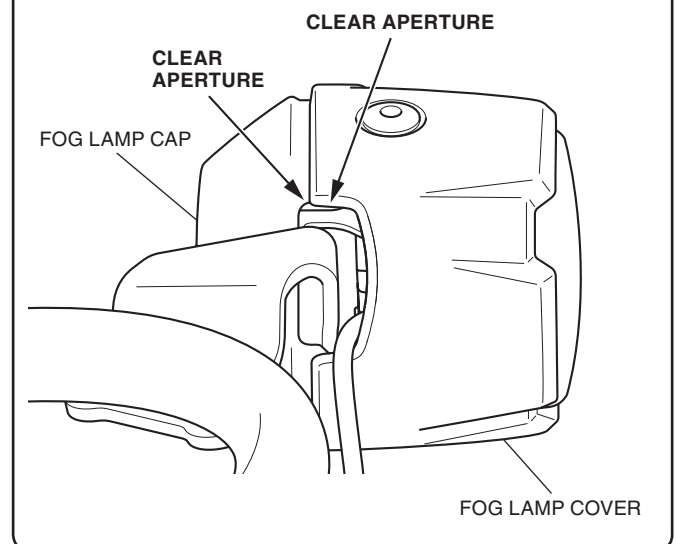

37. Check the fog light, headlight and the other lights for proper operation.

SETTING

1. Connect the SCS short connector (070MZ-0010300).
2. Turn the ignition switch ON.
3. Press and hold the Sel switch ► to display "SETTING".

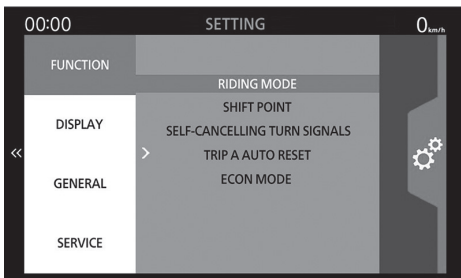
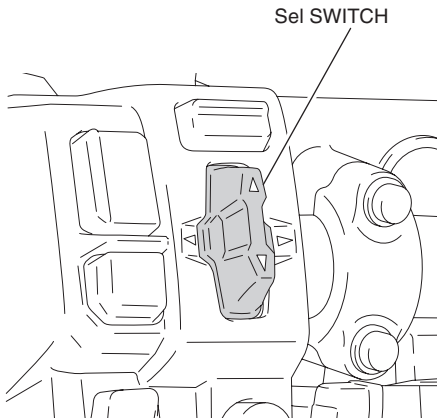

4. Select the "SERVICE", and then press the Sel switch ►.

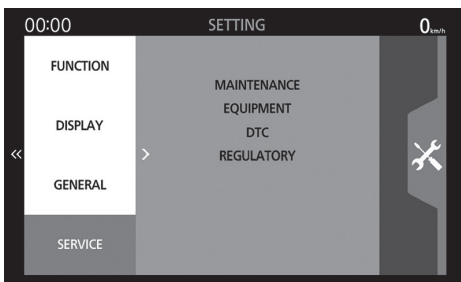

5. Select the "EQUIPMENT", and then press the Sel switch ►.

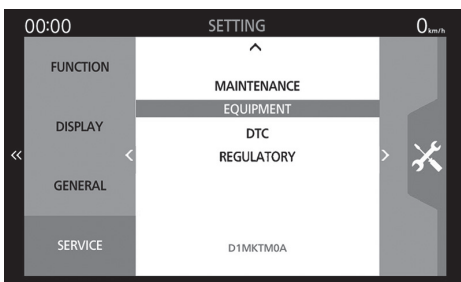

6. Select the "FOG", and then press the Sel switch ►.

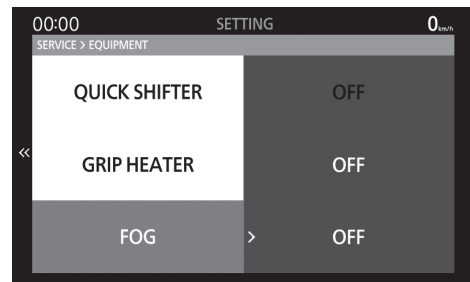

7. Press the Sel switch ▲/▼ to select "ON".

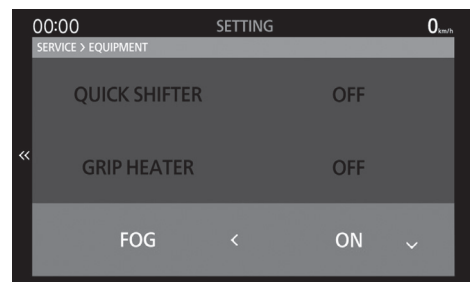

8. Press the Sel switch ◀, and then press and hold the Sel switch ◀ to return to the top screen.
9. Turn the ignition switch OFF and remove the SCS short connector.

ADJUSTING THE FOG LIGHT AIMING

1. Place the motorcycle on a level surface, 5 m away from the aiming screen.
2. Turn the ignition switch to ON.
3. Select the FOG of multi function using the Fn switch.



4. Push up or down the Sel switch to select the "ON" of the FOG.



5. Measure the mounting height of the fog light from the floor.
6. Aim the fog lights so that the cut-off line of the light pattern on the aiming screen is the same distance above the floor as the fog light mounting height.

