



# INSTALLATION INSTRUCTIONS

Accessory  
**HIGH SCREEN**  
P/N 08R70-MKW-D00

Application  
**NC750XA/XD**

Publication No.  
**MII**  
Issue Date  
**January 2021**

**Honda Dealer: Please give a copy of these instructions to your customer.**

## PARTS LIST

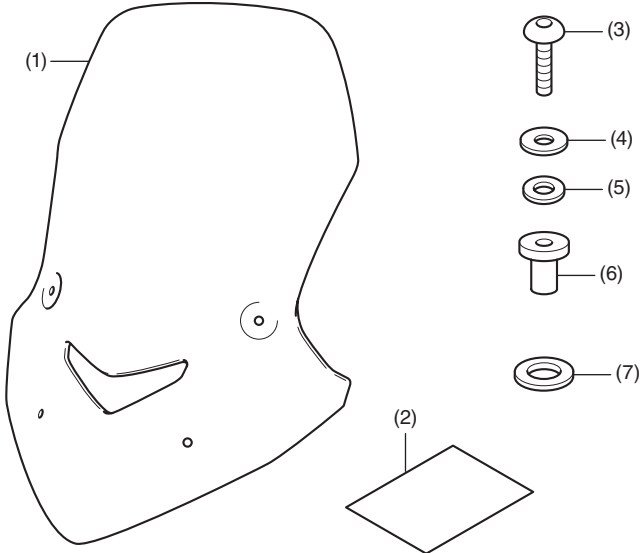

No.	Description	Qty
(1)	High wind screen	1
(2)	URL paper	1
(3)	5 mm screw	4
(4)	Washer (small)	6
(5)	Rubber washer	6
(6)	Well nut	4
(7)	Washer (large)	4

## TOOLS REQUIRED

Hex wrench (5 mm)  
Torque wrench

## TORQUE CHART

Tighten all screws, bolts, and nuts to their specified torque values. Refer to the Service Manual for the torque values of the removed parts.

Item	N·m	kgf·m	lbf·ft
5 mm screw	0.8	0.08	0.6

## INSTALLATION

1. Remove the wind screen as shown.

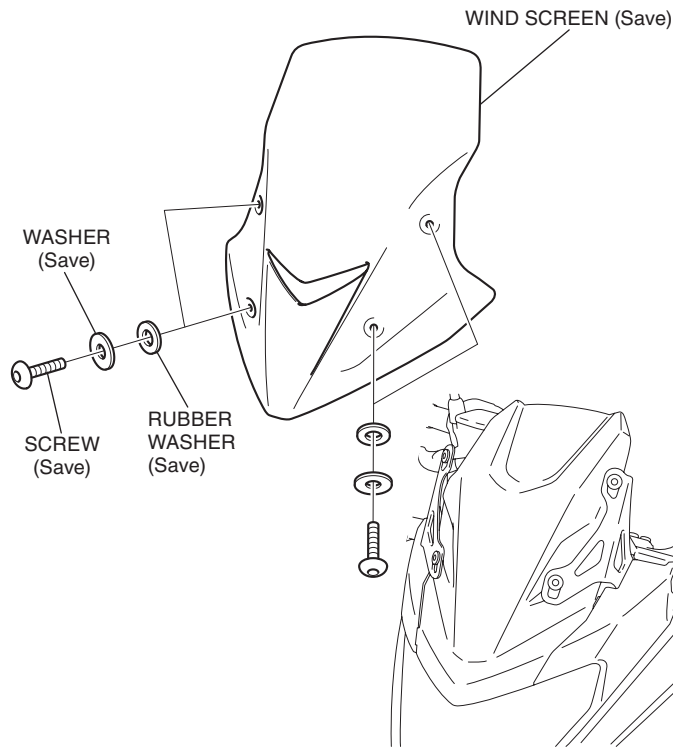

2. Remove the well nuts and washers as shown.

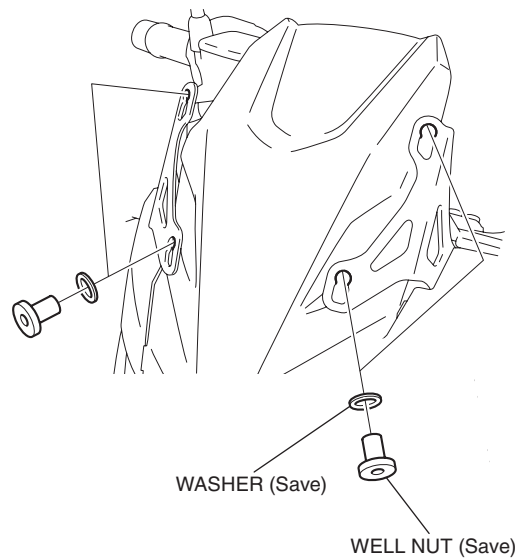

3. Install the well nuts and washers as shown.

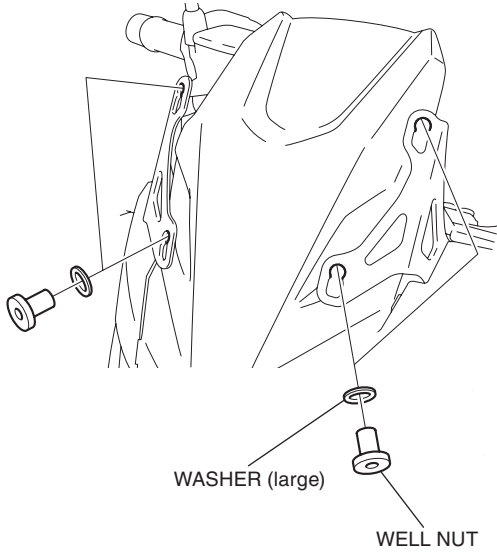

4. Loosely install the high wind screen as shown.

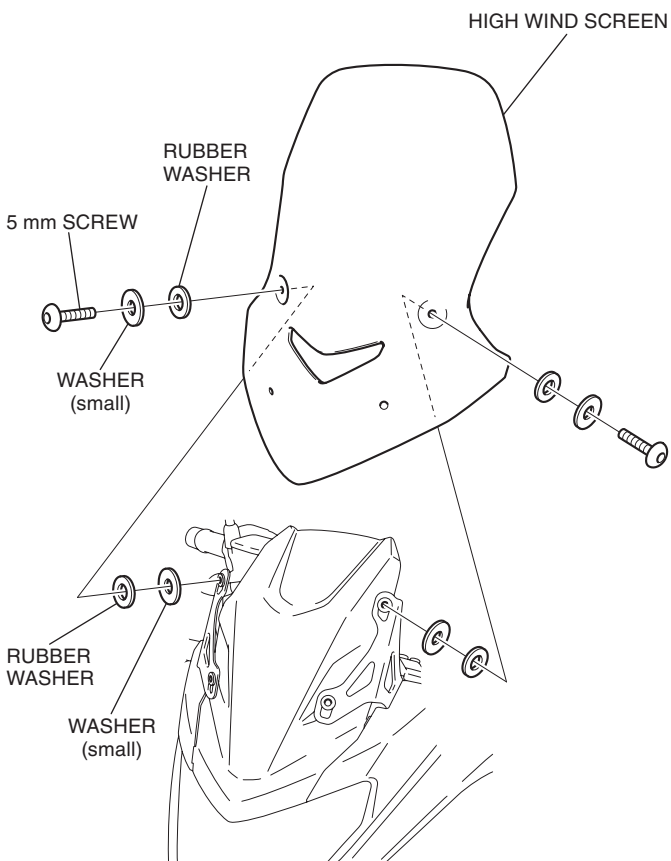

5. Loosely install the 5 mm screws as shown.

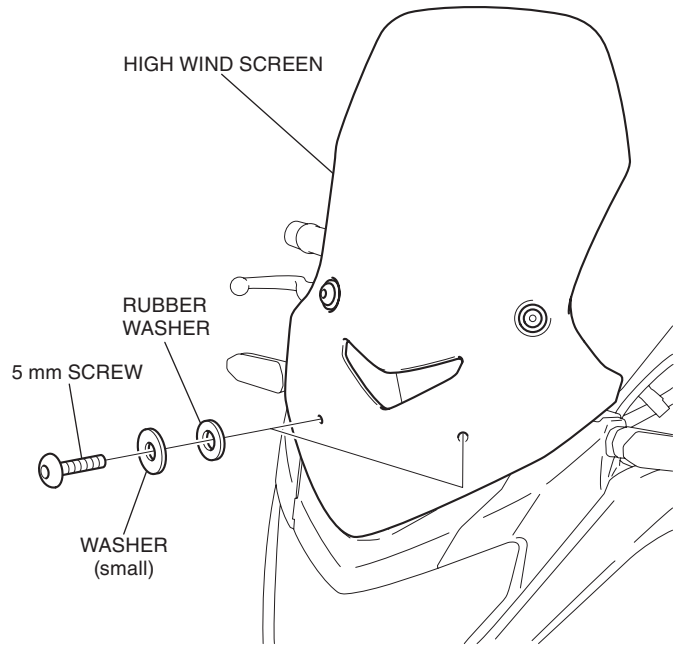

6. Tighten all loosely installed parts securely.