



INSTALLATION INSTRUCTIONS

Accessory
FRONT LED FOG LIGHT ATTACHMENT
 P/N 08V70-MKW-D00

Application
NC750XA/XD

Publication No.
MII
 Issue Date
January 2021

Honda Dealer: Please give a copy of these instructions to your customer.

PARTS LIST

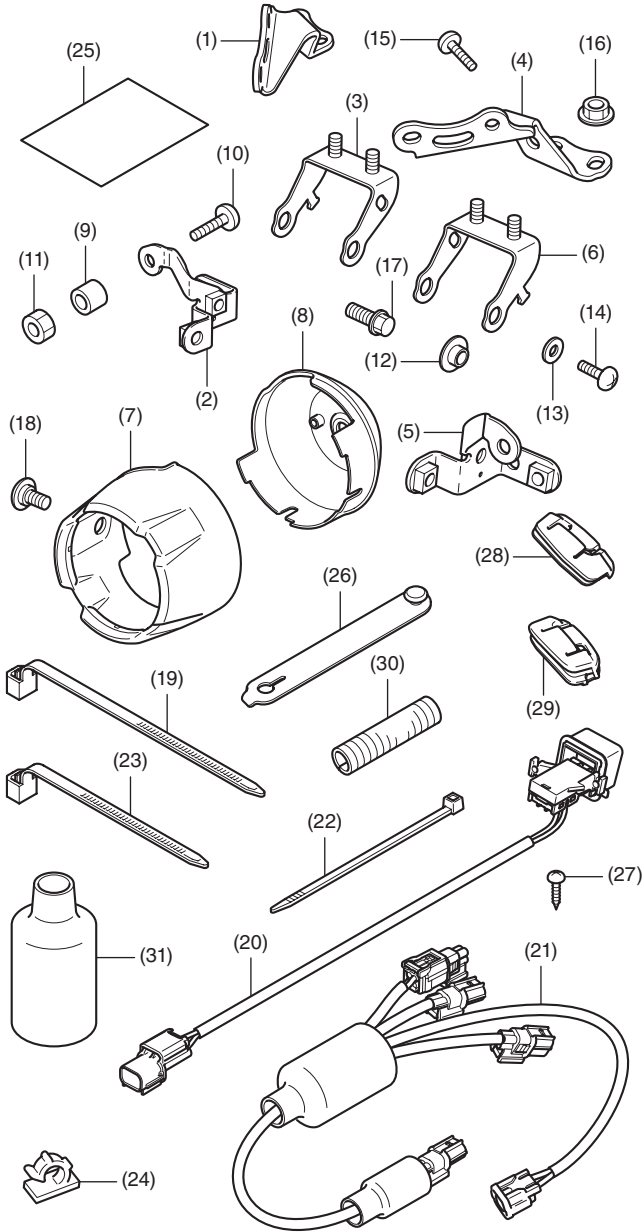

No.	Description	Qty
(1)	Right fog mount stay	1
(2)	Right fog stay A	1
(3)	Right fog stay B	1
(4)	Left fog mount stay	1
(5)	Left fog stay A	1
(6)	Left fog stay B	1
(7)	Fog lamp cover	2
(8)	Fog lamp cap	2
(9)	Collar	2
(10)	6 mm bolt	2
(11)	6 mm nut	2
(12)	Flange collar	4
(13)	Washer	4
(14)	6 mm screw	4
(15)	6 mm socket screw	4
(16)	6 mm flange nut	4
(17)	6 mm SH flange bolt	2
(18)	6 mm shoulder socket screw	4
(19)	Wire tie (wide/long)	3
(20)	Fog light switch	1
(21)	Fog lamp sub harness	1
(22)	Wire tie (narrow)	3
(23)	Wire tie (wide/short)	4
(24)	Harness clip	3
(25)	URL paper	1
(26)	Rubber band	1
(27)	3 mm screw	2
(28)	Right fog lamp rubber	1
(29)	Left fog lamp rubber	1
(30)	Corrugate tube	1
(31)	Connector cover	1

FRONT SIDE PIPE
Sold separately

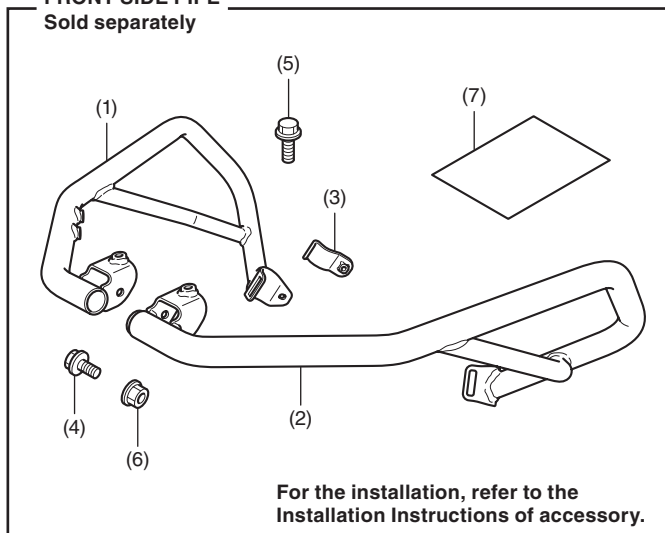

No.	Description	Qty
(1)	Right front side pipe	1
(2)	Left front side pipe	1
(3)	Front side pipe holder	2
(4)	6 mm flange bolt (short)	3
(5)	6 mm flange bolt (long)	2
(6)	6 mm flange nut	3
(7)	URL paper	1

FRONT FOG LIGHT
Sold separately

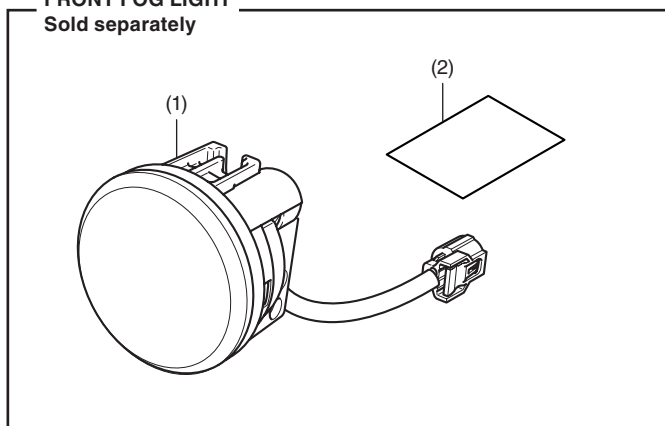

No.	Description	Qty
(1)	Front fog light	2
(2)	URL paper	1

TOOLS AND SUPPLIES REQUIRED

- Socket (8 and 10 mm)
- Ratchet
- Hex wrench (5 mm)
- Phillips ® screwdriver
- Nippers
- Marker
- Scale
- Electrical tape
- Isopropyl alcohol
- Shop towel
- Torque wrench

TORQUE CHART

Tighten all screws, bolts, and nuts to their specified torque values. Refer to the Service Manual for the torque values of the removed parts.

Item	N·m	kgf·m	lbf·ft
6 mm screw	9	0.9	6.6
6 mm shoulder socket screw	9	0.9	6.6
6 mm socket screw	9	0.9	6.6
6 mm bolt	10	1.0	7
6 mm SH flange bolt	10	1.0	7
6 mm flange nut	12	1.2	9

INSTALLATION

▲ CAUTION

- To prevent burns, allow the engine, exhaust system, radiator, etc., to cool before installing the accessory.

NOTE:

- Heat the bonding surfaces with a hair dryer if the ambient air temperature is below 70°F (21°C).
- The adhesive reaches full strength in 72 hours. Wait at least 24 hours before riding your motorcycle.
- Disconnect the negative (-) cable from the battery before installing this accessory.
- The memories of the clock will be erased when you disconnect the battery. Reset the memories after reconnecting the battery.
- Reinstall the removed parts on the motorcycle and make sure that the wires and harnesses are not pinched.
- Cut the wire tie at 5 mm from the lock part after attaching them to the wire harnesses. Do not allow the cut part of the wire tie to interfere with another harness or brake hose.
- Although the illustration is of NC750XA, use the same procedures for other models.

1. Open the pillion seat, and remove the single seat as shown.

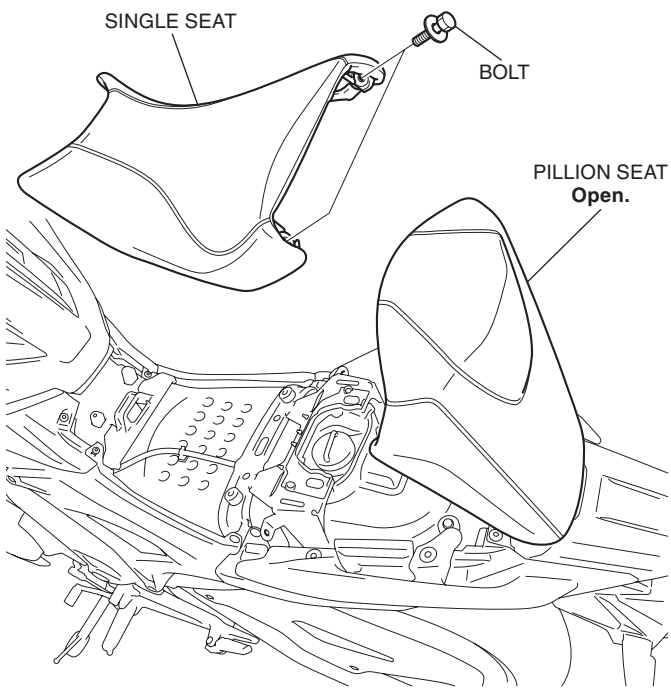

2. Open the luggage lid, and remove the maintenance lid and disconnect the negative (-) cable of the battery.

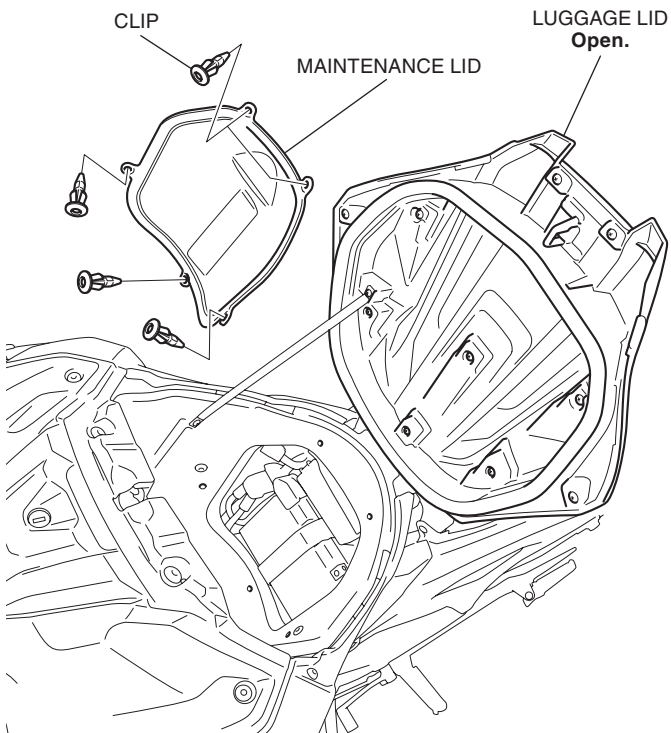

3. Remove the center cover as shown.

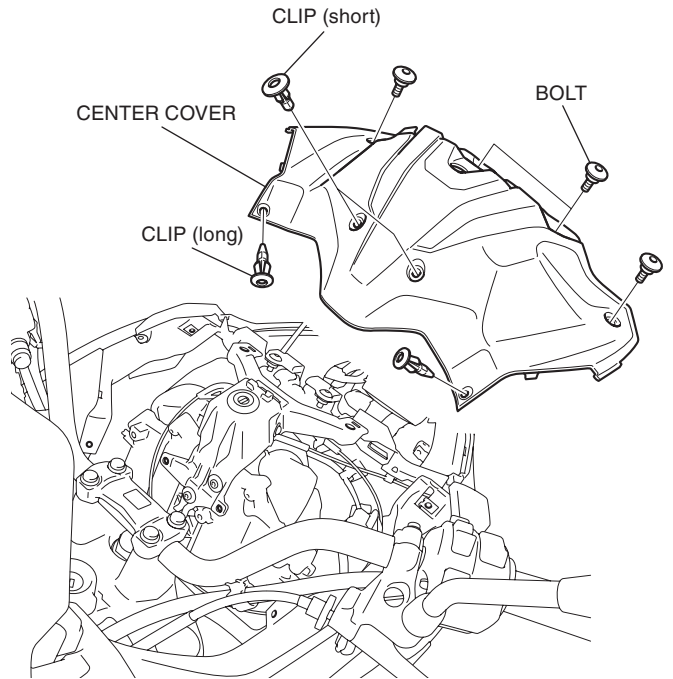

4. Remove the clip as shown.
 - Repeat on the right side.

<Left side>

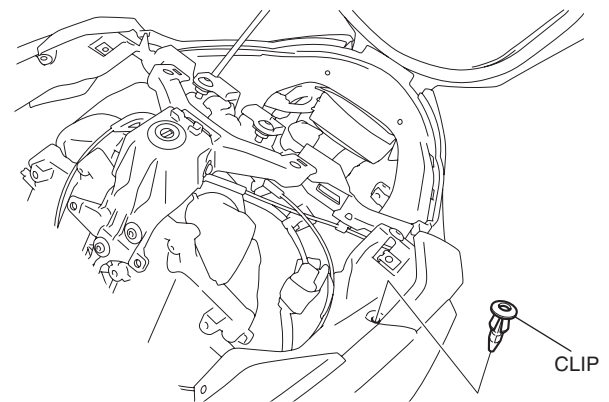

5. Remove the left side panel as shown.

<Left side>

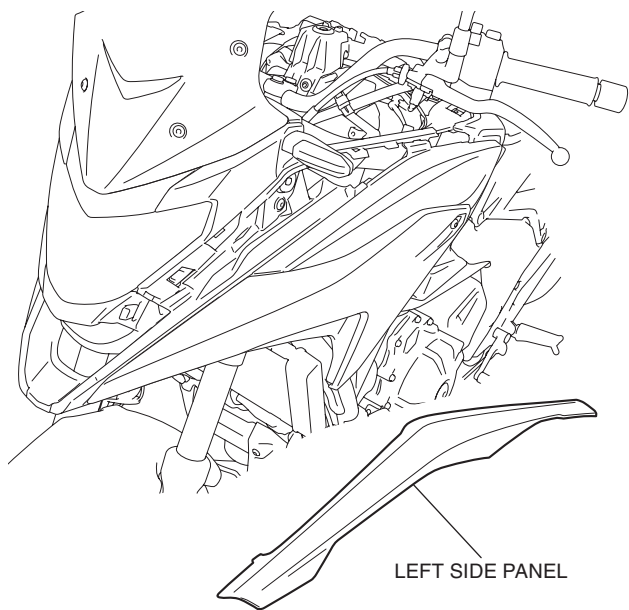

6. Remove the left middle cowl as shown.

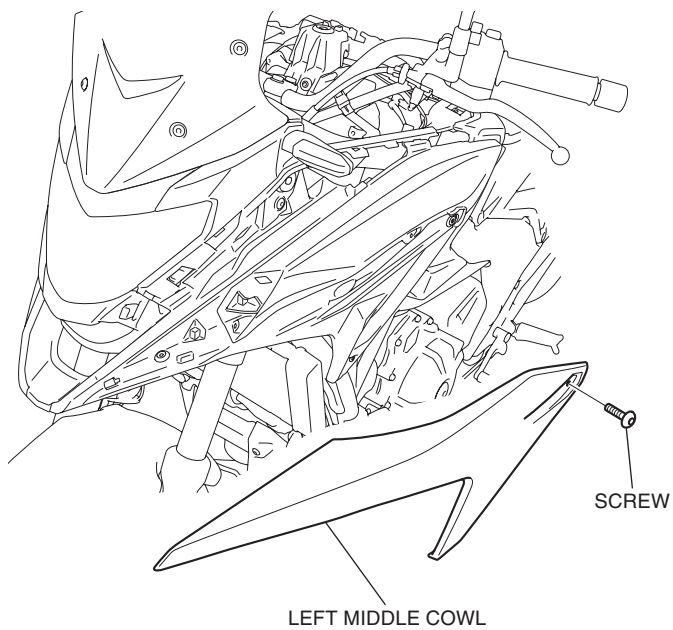

7. Remove the left front side cowl as shown.

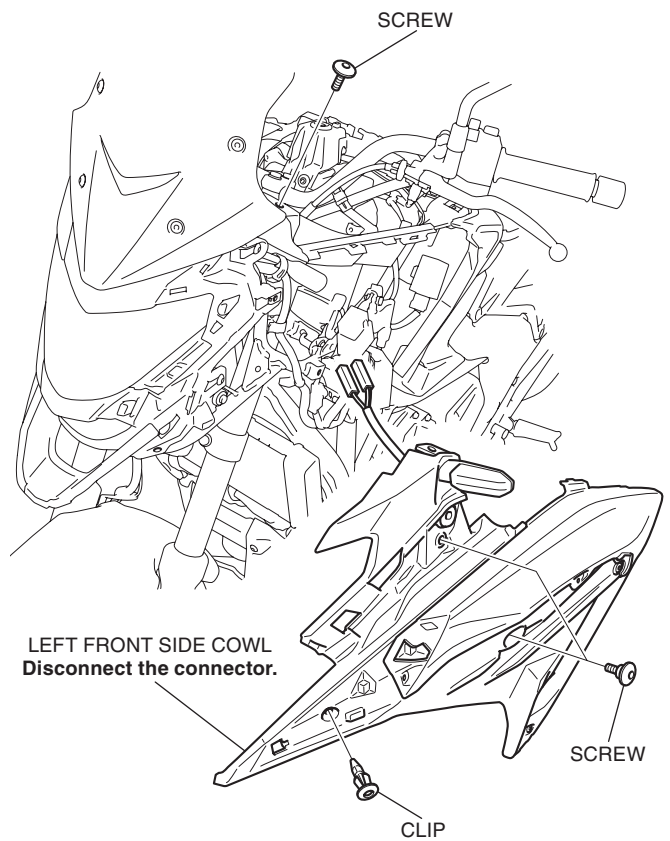

8. Remove the right side panel, right middle cowl and right front side cowl in the same manner as the left side.

9. Remove the inner upper cover as shown.

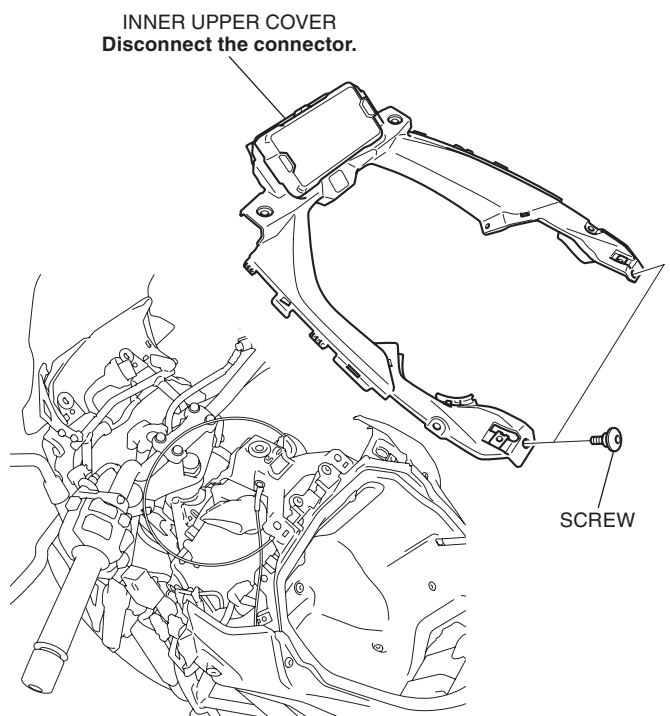

10. Clean the surface of the area shown using an isopropyl alcohol.

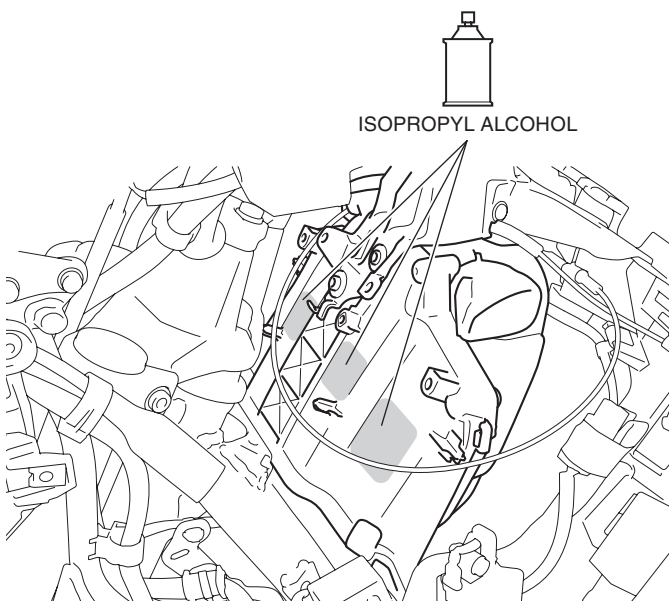

11. Attach the harness clips as shown.

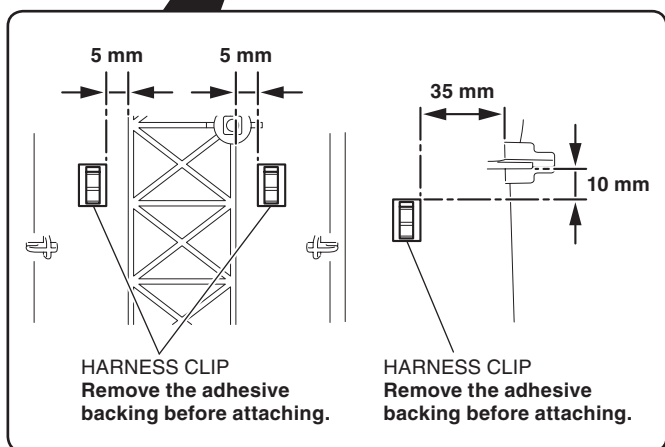
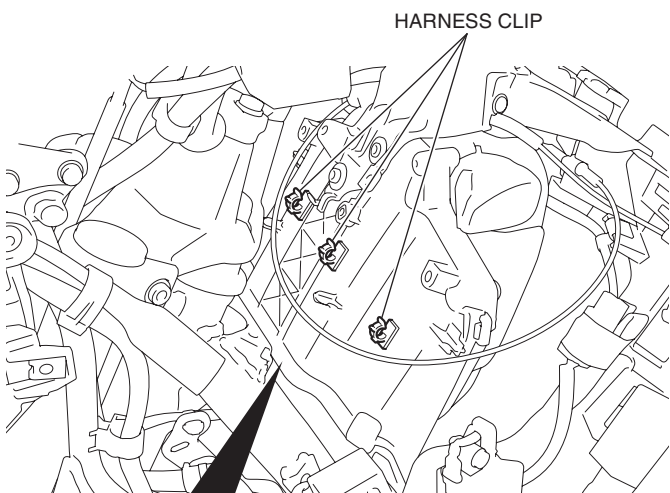

12. Route and secure the fog lamp sub harness as shown.

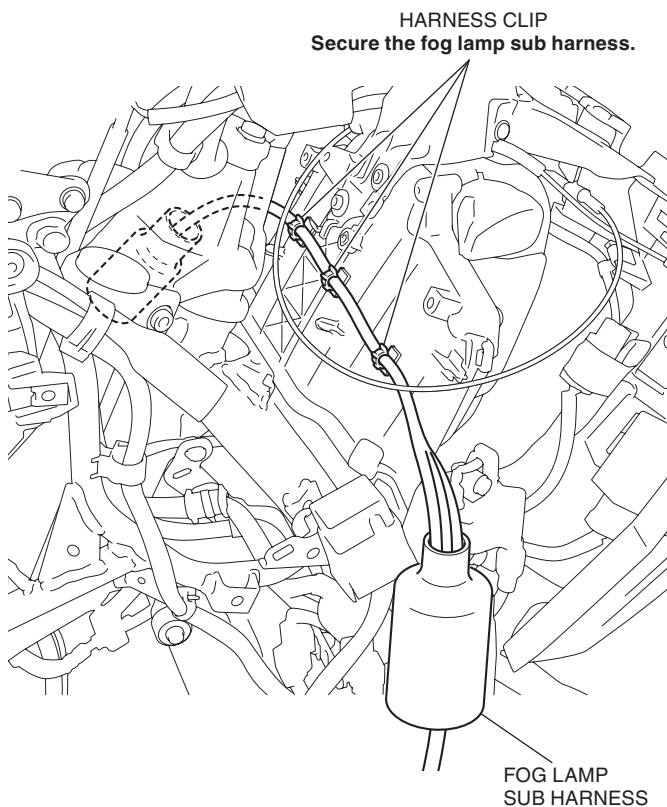

13. Remove the switch cover as shown.

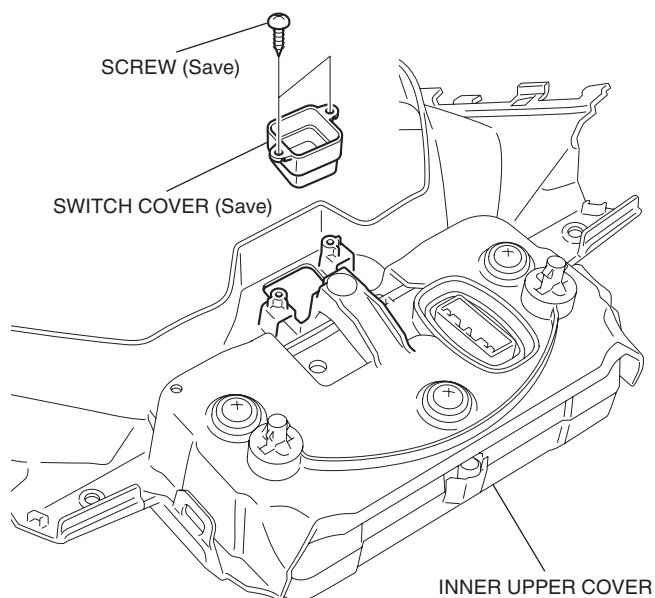

14. Pass the connector cover over the fog light switch harness as shown.

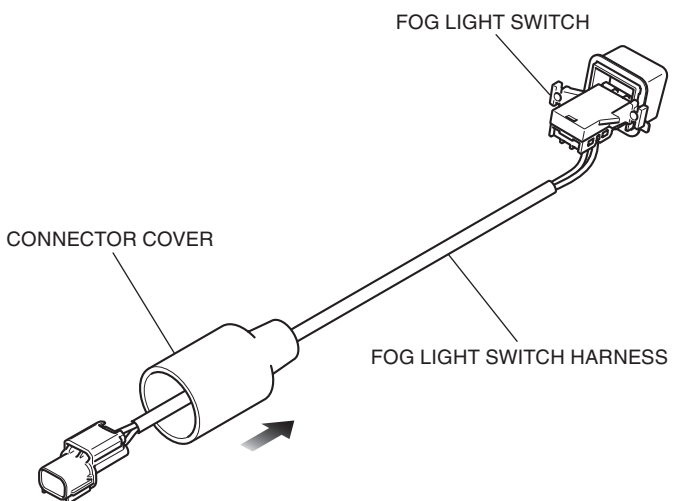

15. Install the fog light switch as shown.

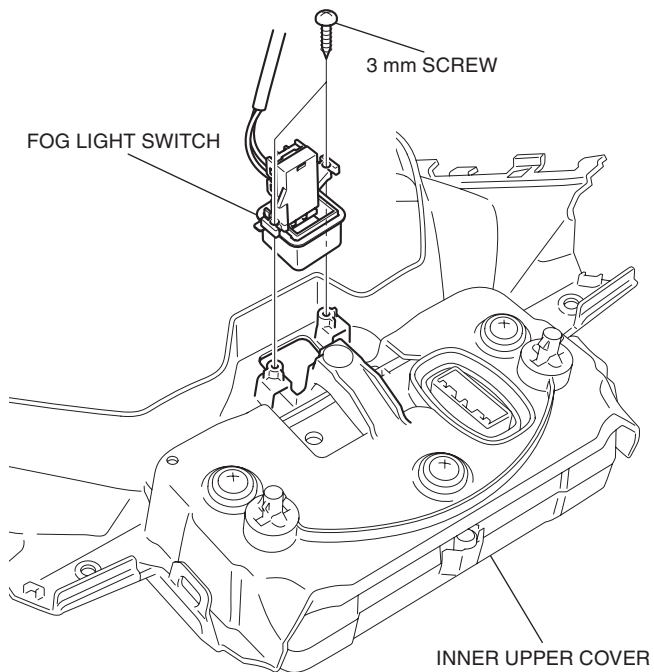

16. Route the fog light switch harness as shown.
<Left side>

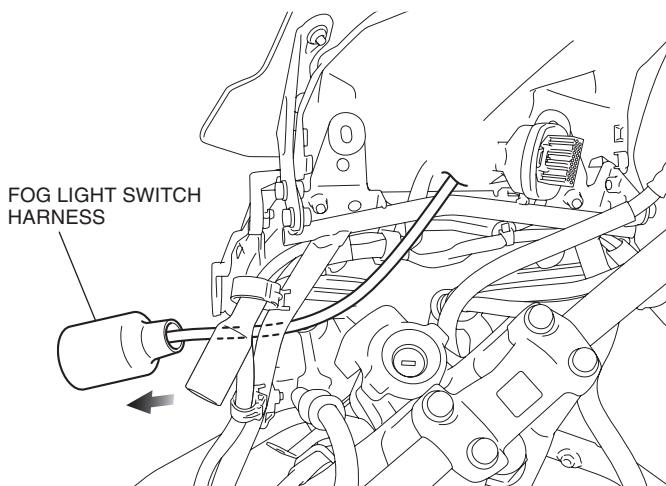

17. Install the inner upper cover in the reverse order of removal.

18. Secure the fog light switch harness with the wire tie as shown.

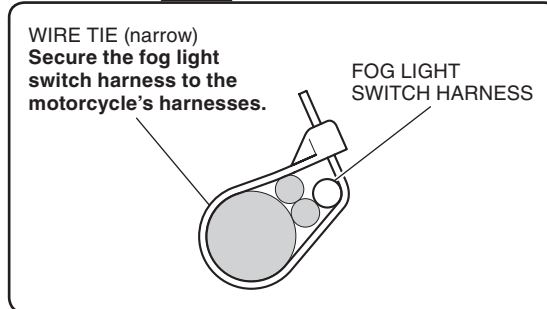
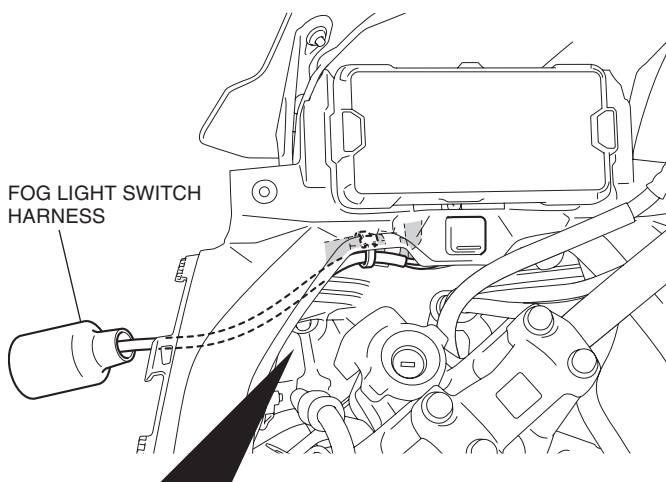

19. Install the front side pipe (sold separately).

20. Mark the front fog light harness at the position with the indicated dimensions.

- Perform this step for both fog lights.

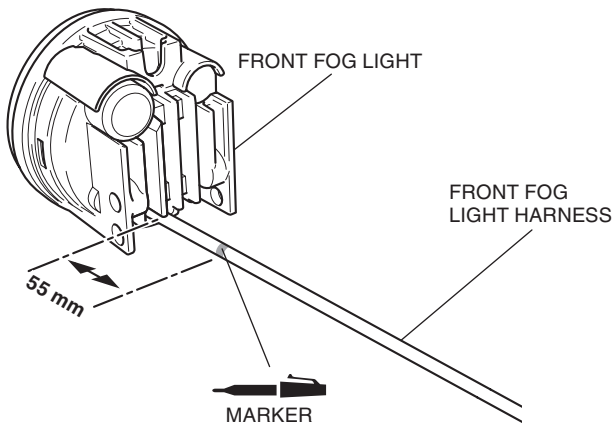

21. Install the flange collars to the left fog stay B as shown.

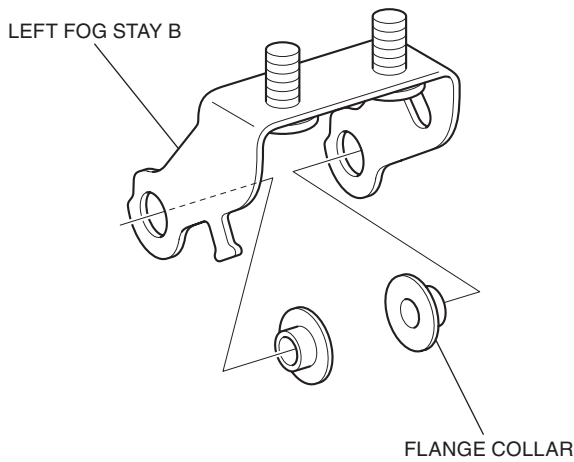

22. Loosely install the assembled left fog stay B to the front fog light as shown.

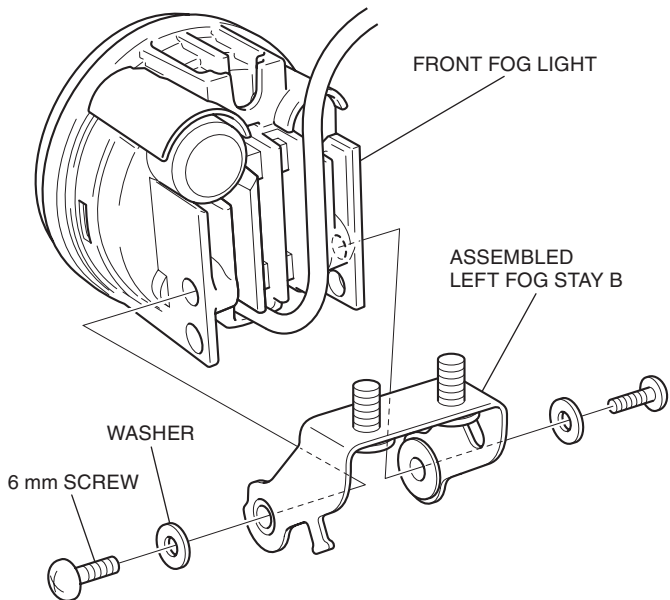

23. Install the 6 mm nut to the assembled left front fog light as shown.

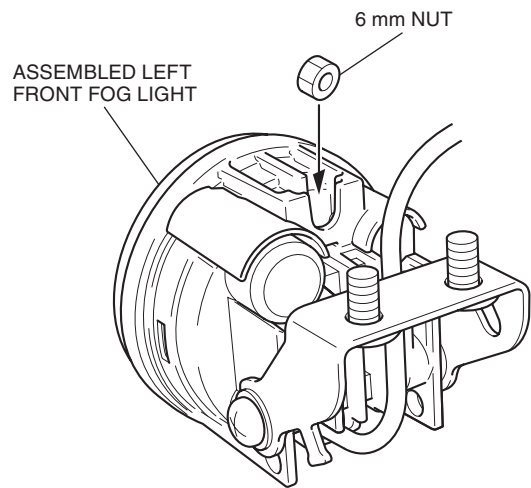

24. Loosely install the fog light stay A as shown.

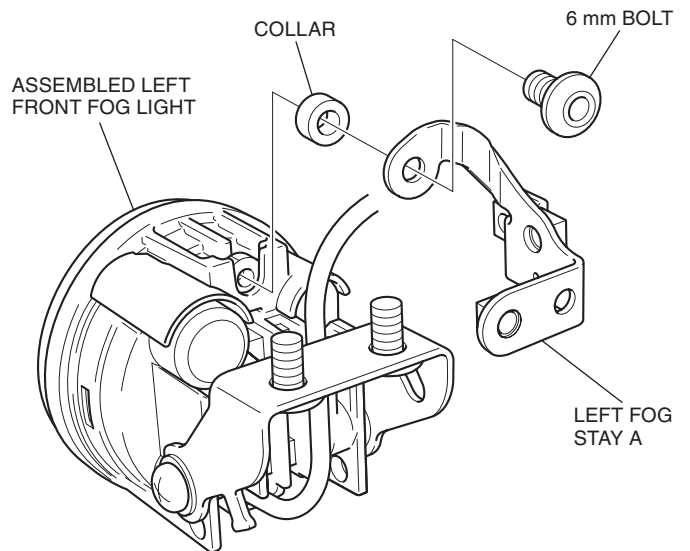

25. Secure the left fog stay B and left fog stay A as shown.

- To adjust the fog light aiming, loosen the 6 mm SH flange bolt and 6 mm screws.

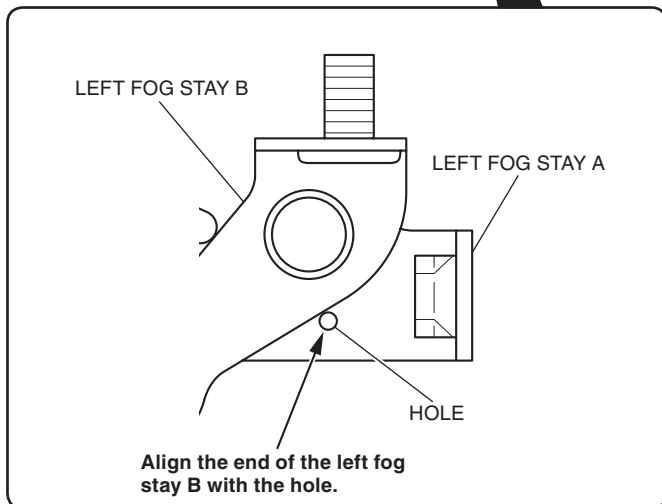
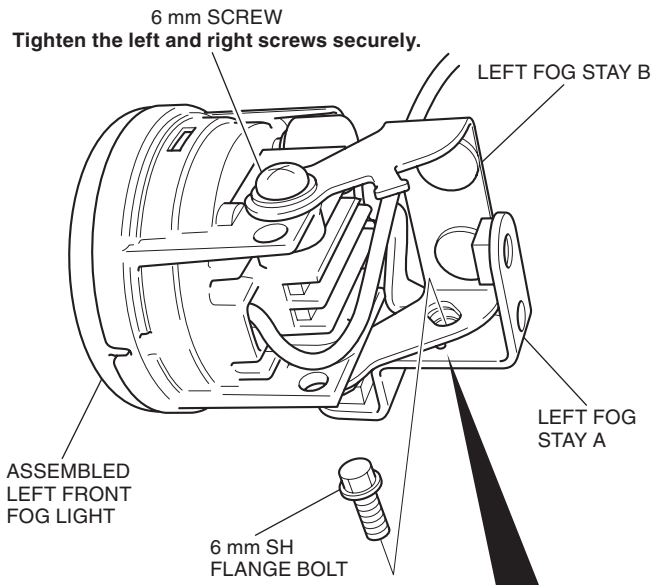

26. Secure the front fog light harness with the wire tie as shown.

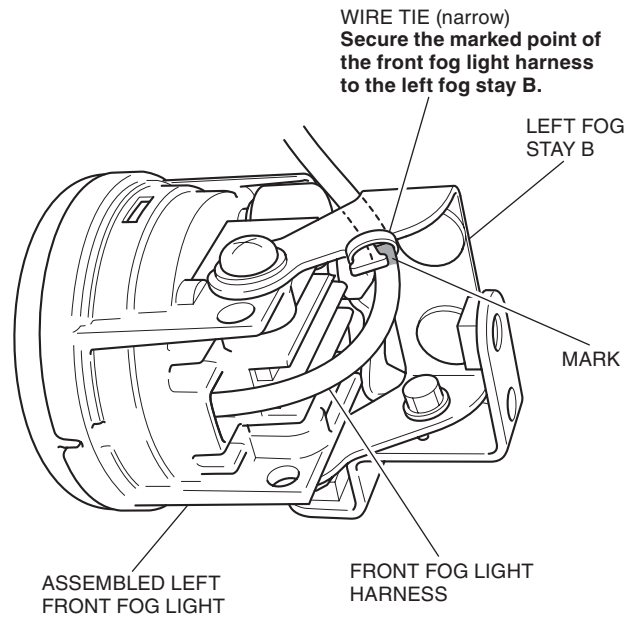

27. Install the left fog mount stay as shown.

- To adjust the fog light aiming, loosen the 6 mm flange nuts.

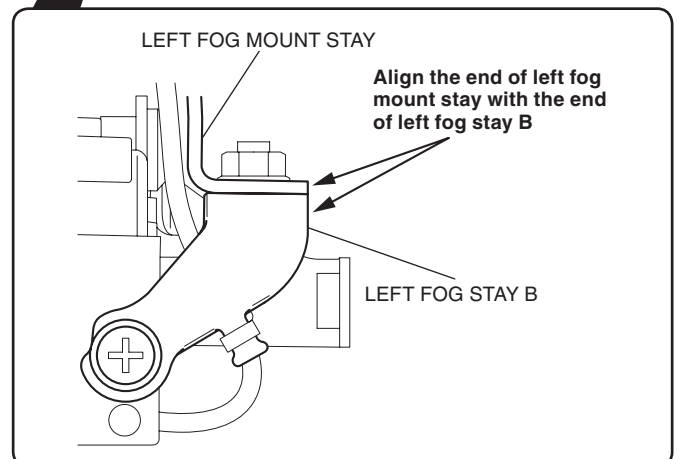
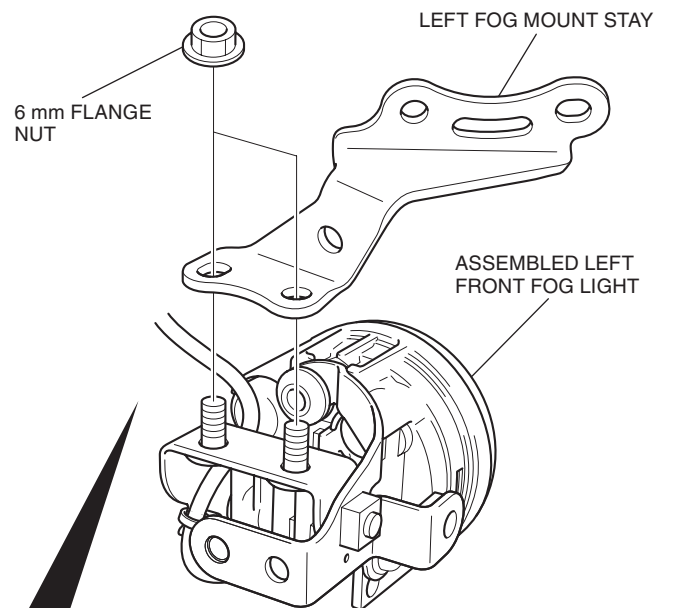

28. Install the fog lamp cover as shown.

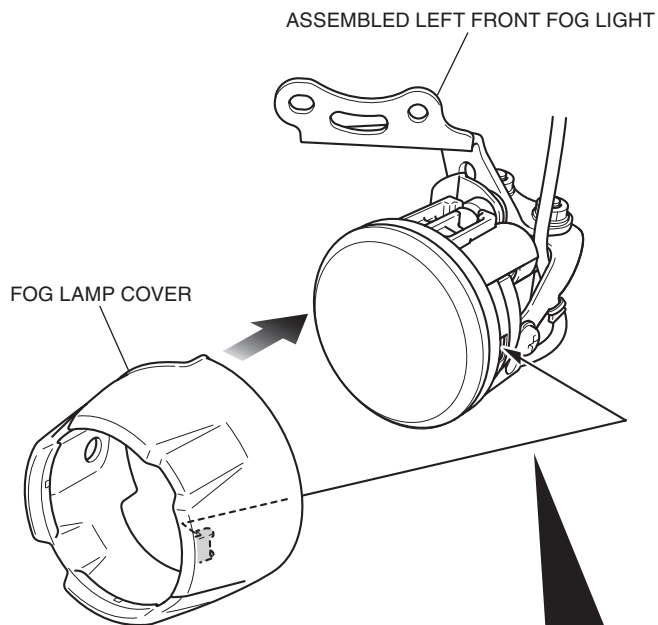

Put the front fog light with the tabs of fog lamp cover.

<Rear side>

ASSEMBLED LEFT FRONT FOG LIGHT

TAB

FOG LAMP COVER

29. Secure the fog lamp cover as shown.

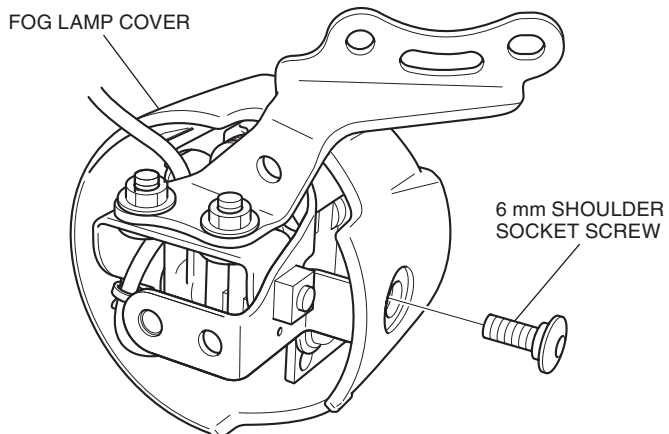

30. Route the front fog light harness as shown and install the left fog lamp rubber.

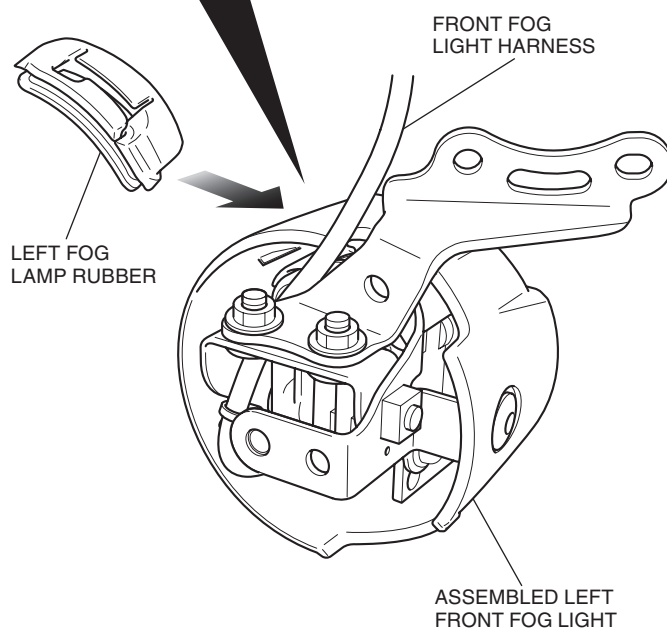
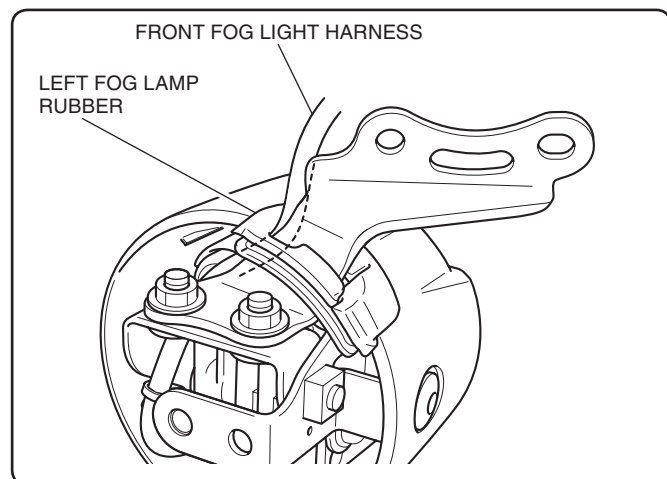

31. Install the fog lamp cap as shown.

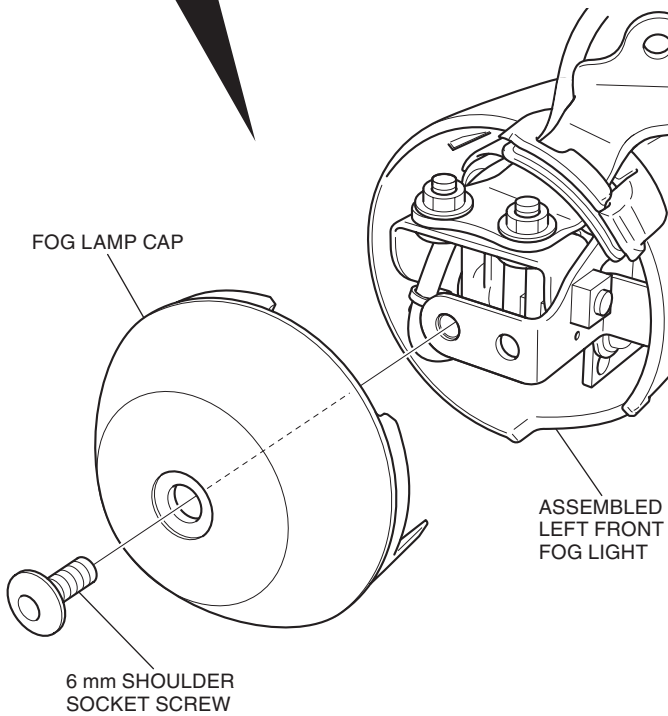
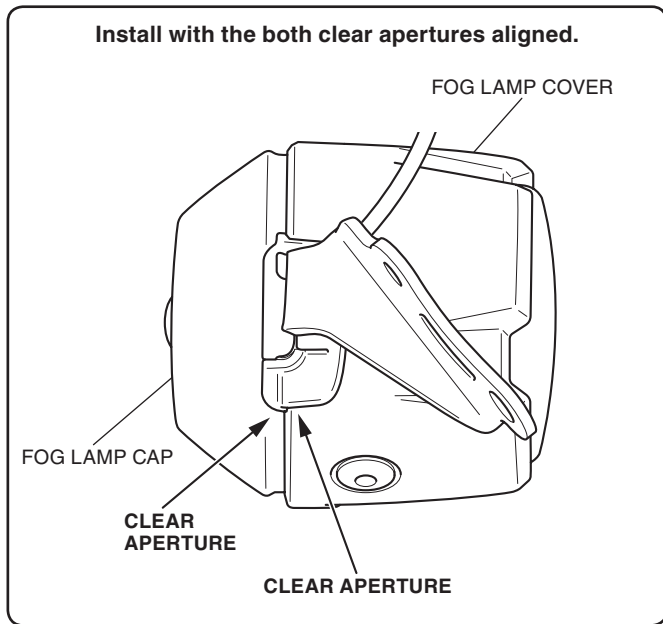

32. Assemble the right front fog light in the same manner as the left side.

34. Install the assembled left front fog light as shown.

- Repeat on the right side.

<Left side>

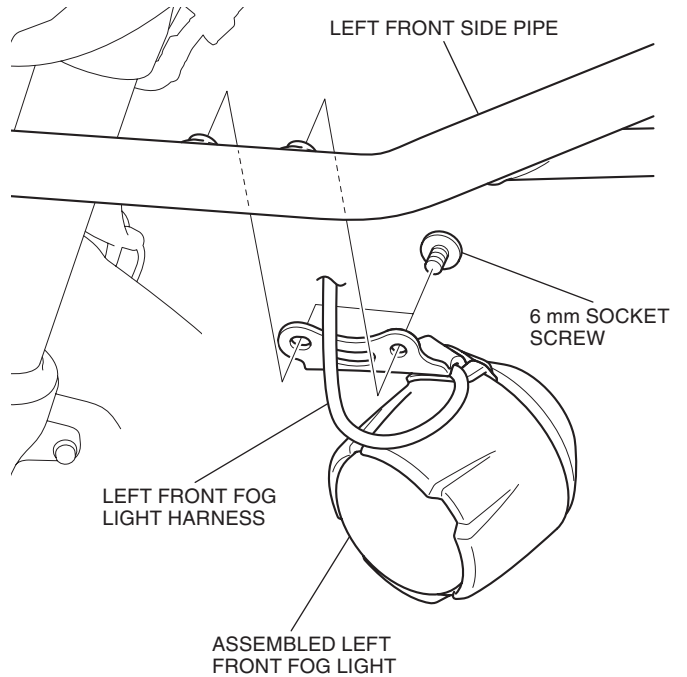

33. Remove the USB sub harness as shown.

- Perform this step for the motorcycle equipped with the USB charger.

<Left side>

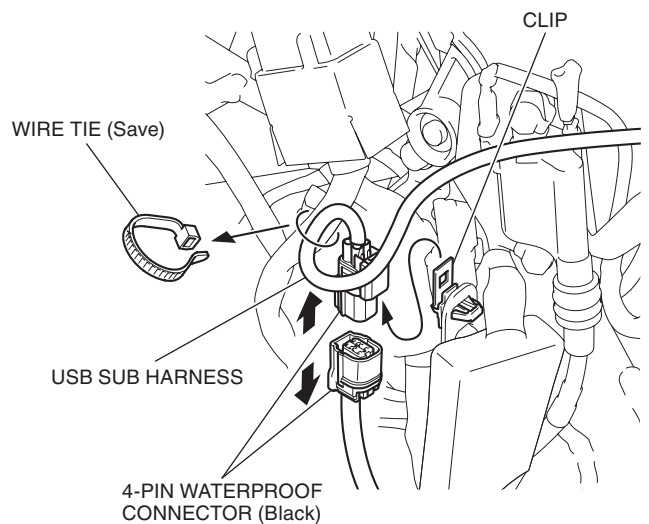

35. Remove the dummy connector as shown.

<Left side>

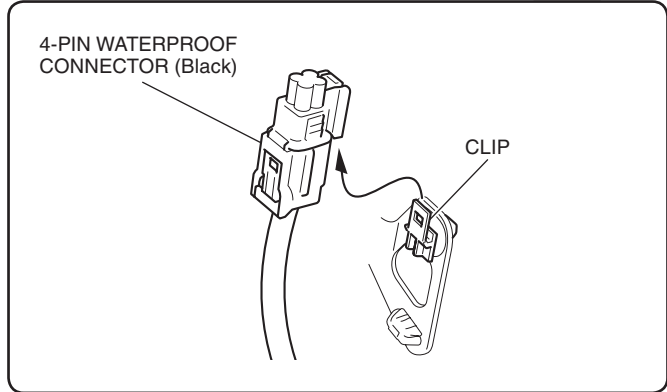
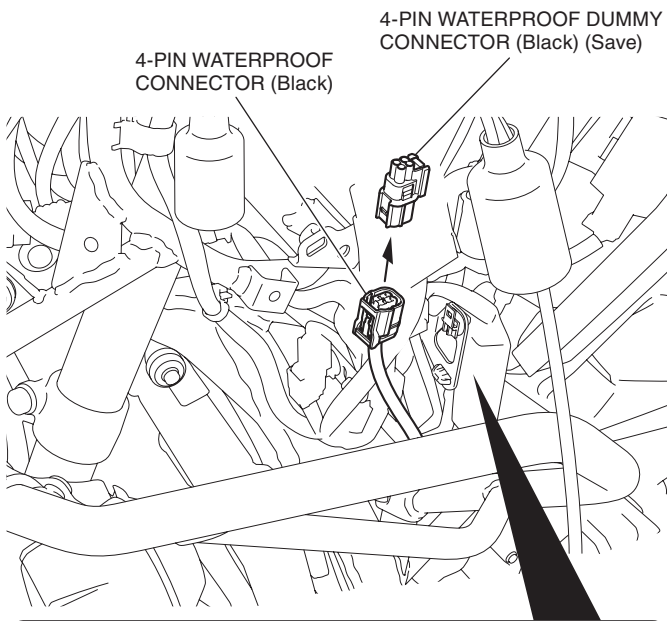

36. Connect the fog lamp sub harness as shown.

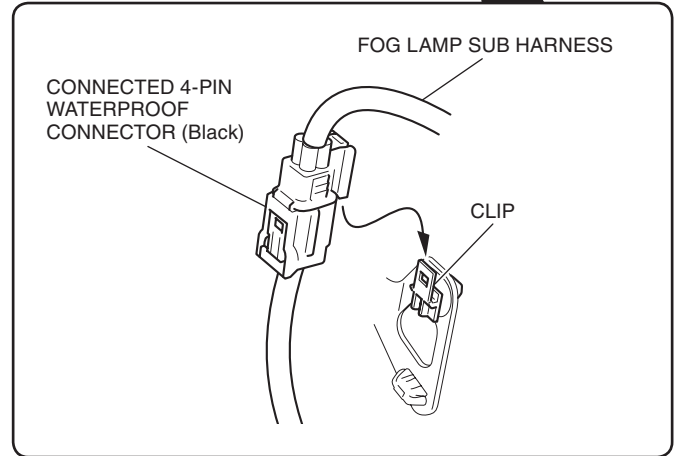
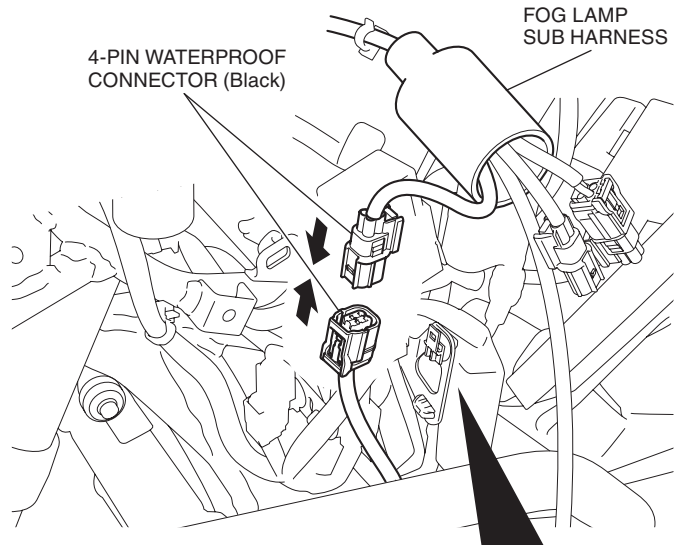

37. Connect the fog light switch harness as shown.

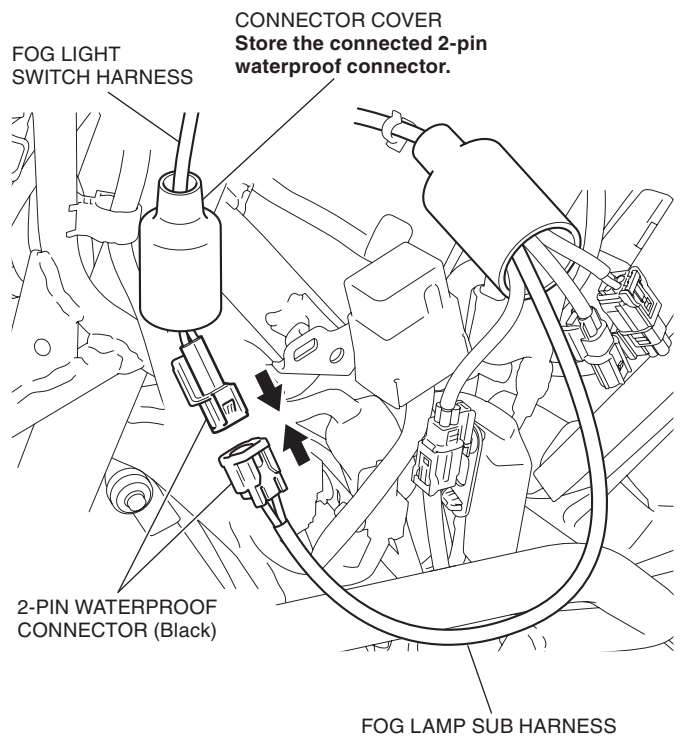

38. Connect the left front fog light harness as shown.

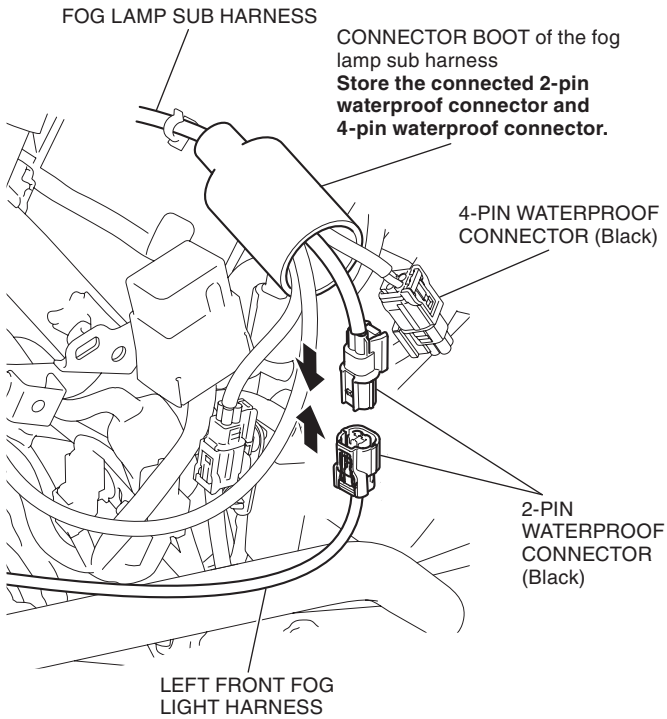

When installing the USB charger

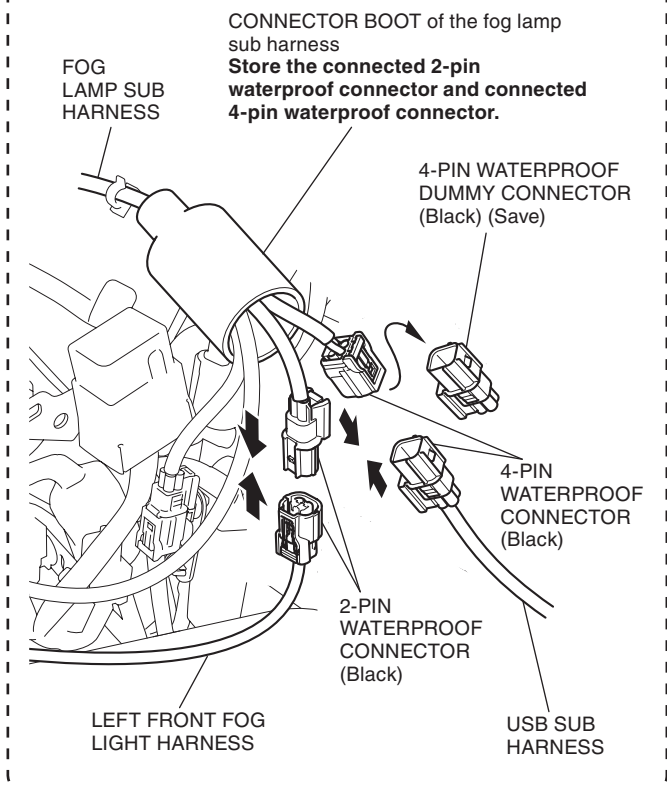

39. Secure the connector boot with the wire tie as shown.

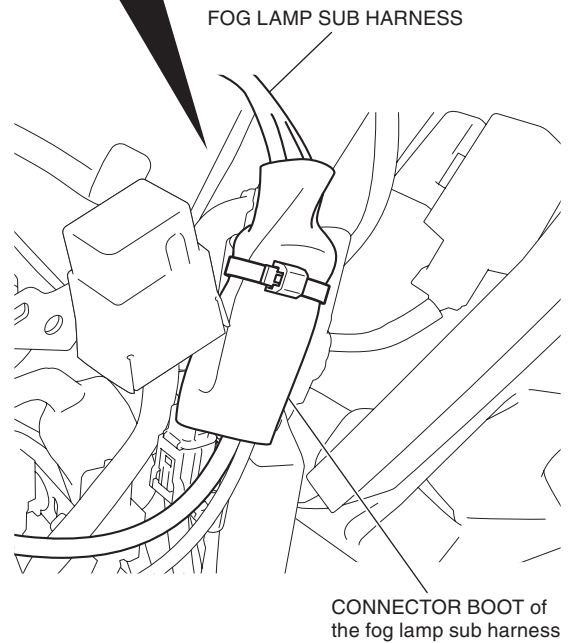
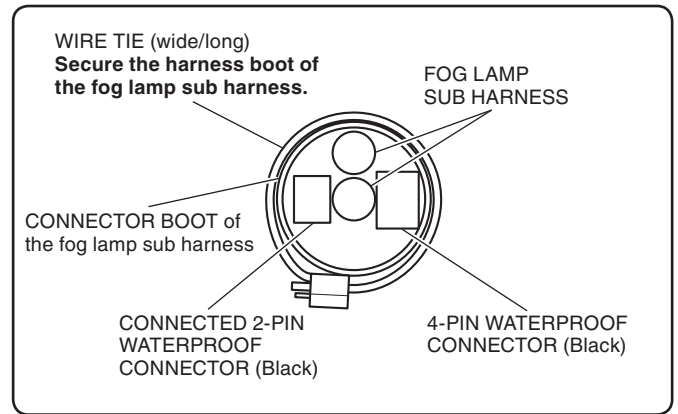

40. Secure the connector cover with the wire tie as shown.

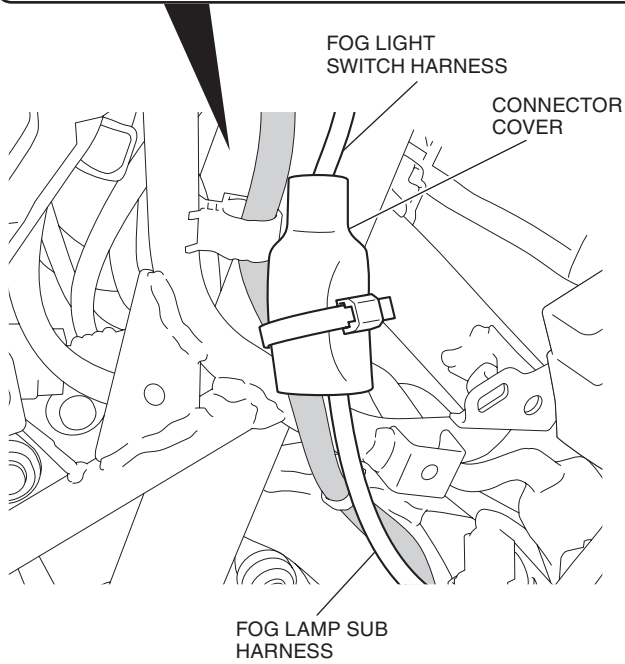
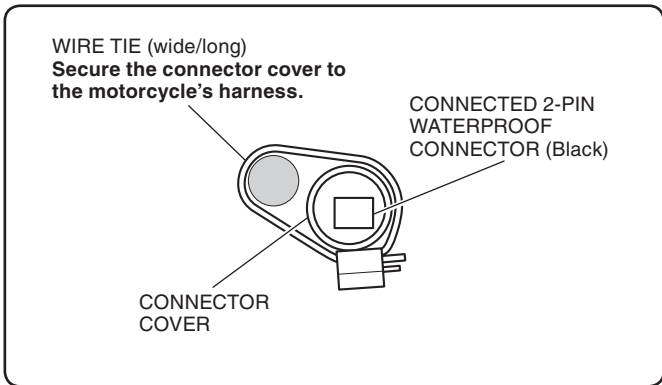

41. Secure the fog lamp sub harness and left front fog light harness with the wire tie as shown.

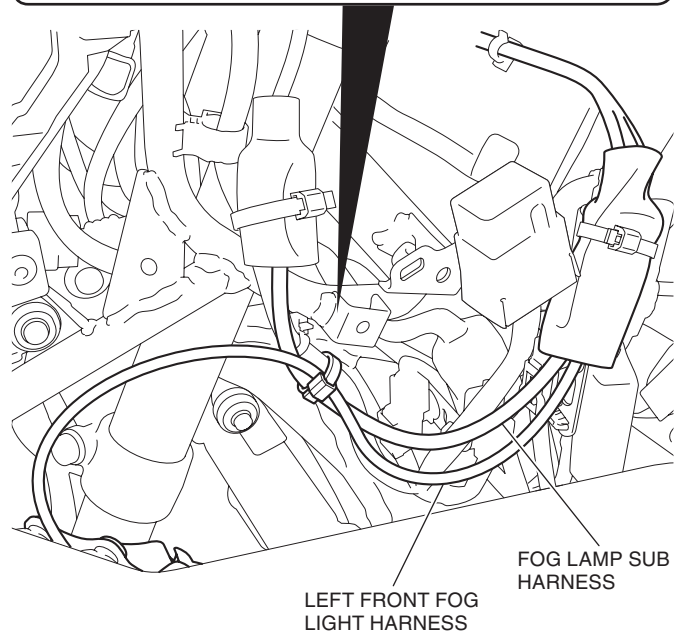
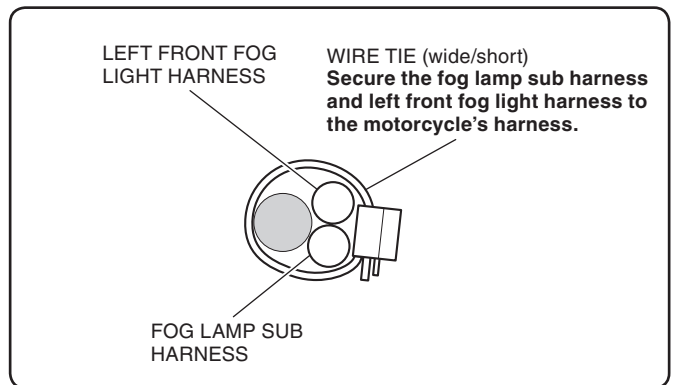

42. Secure the fog lamp sub harness and left front fog light harness with the wire tie as shown.

- **Do not cut the excess wire tie end.**

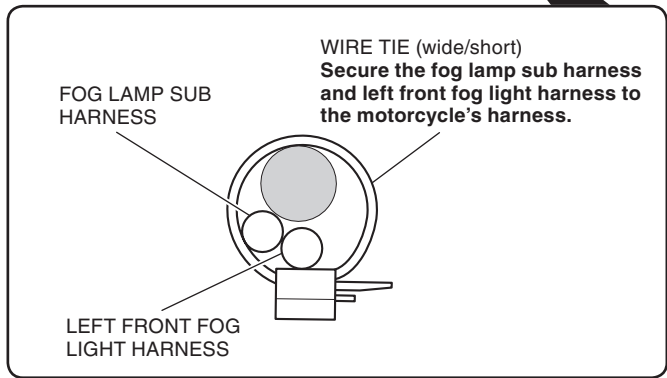
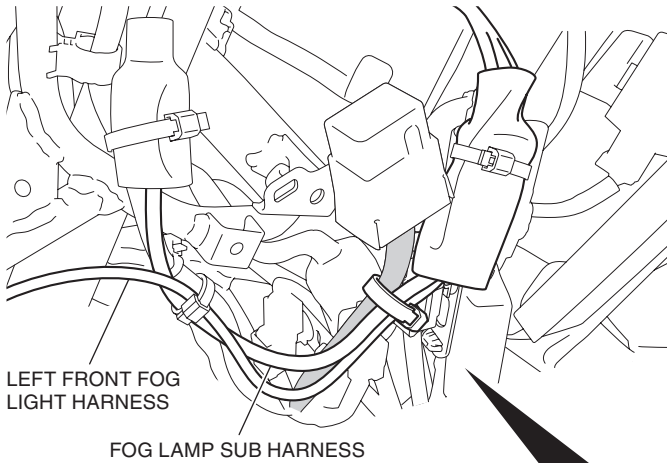

When installing the USB charger

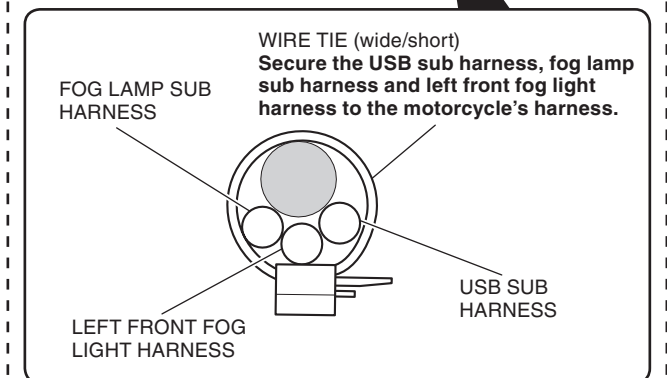
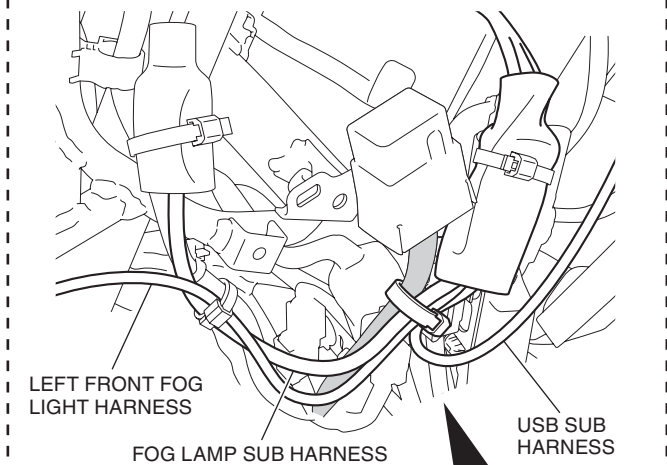

43. Secure the left front fog light harness with the wire tie as shown.

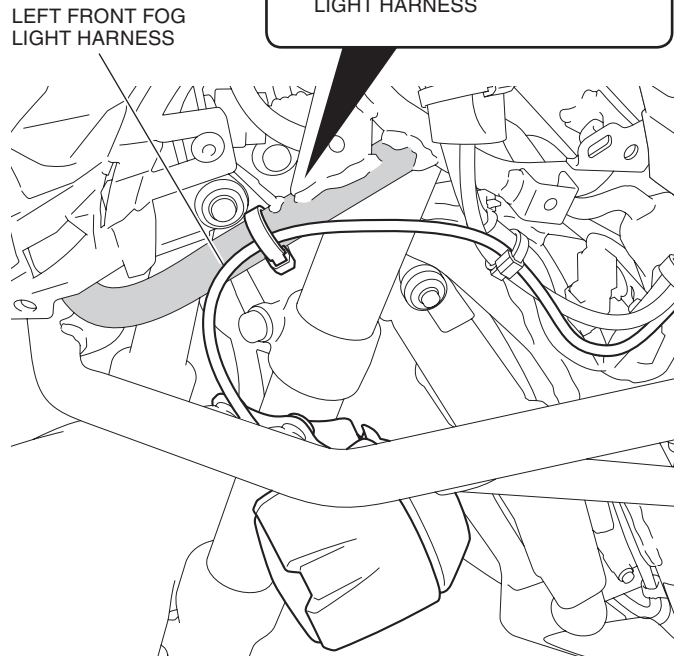
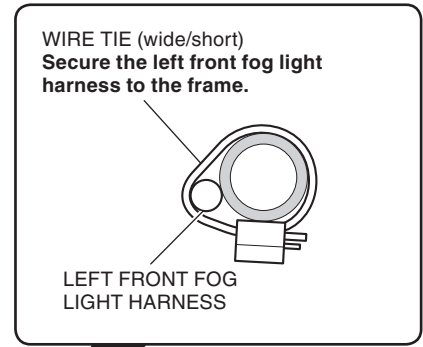

44. Route the right front fog light harness as shown.
<Right side>

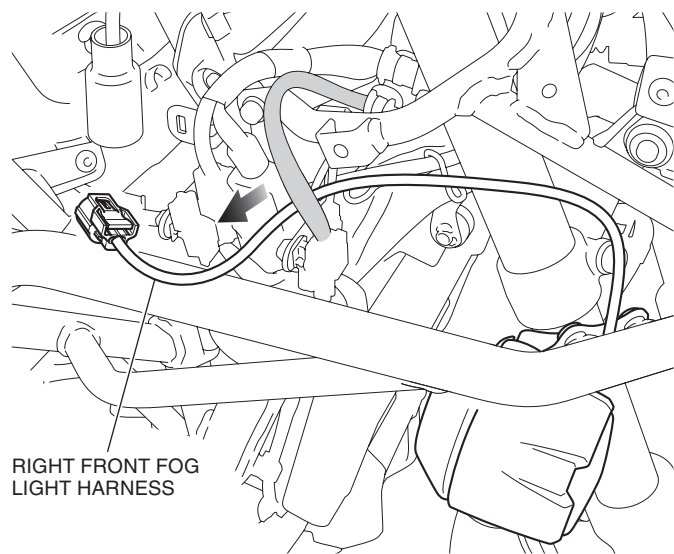

45. Connect the right front fog light harness as shown.

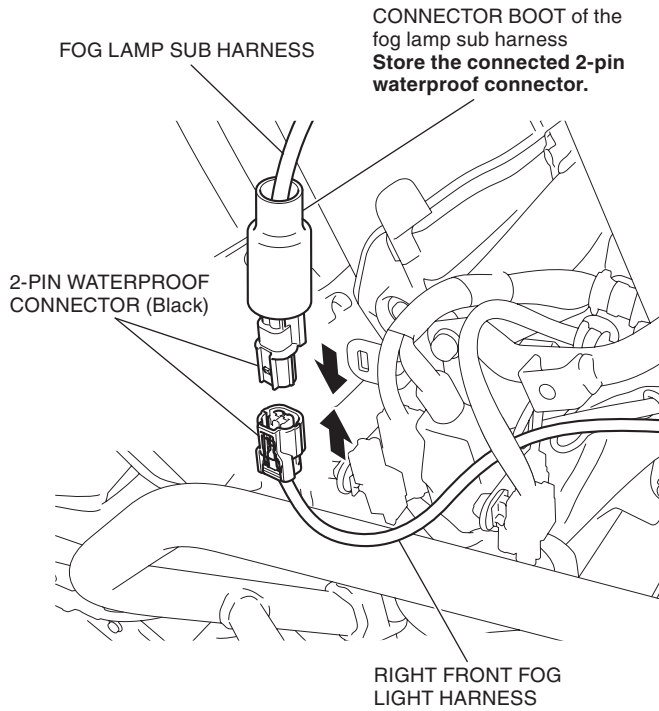

46. Install the corrugate tube as shown.

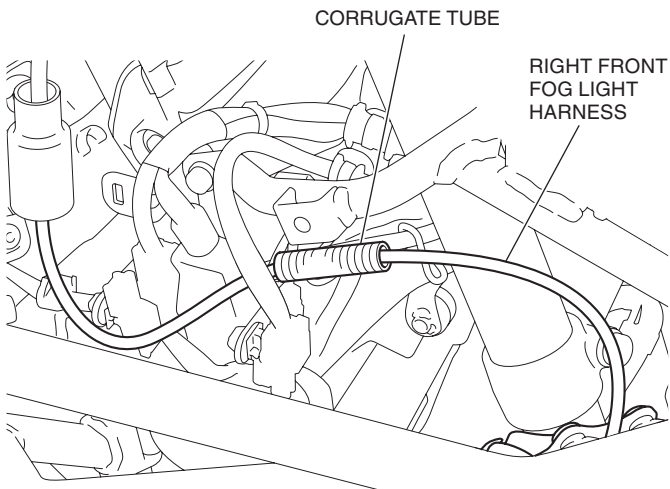

47. Secure the connector boot with the wire tie as shown.

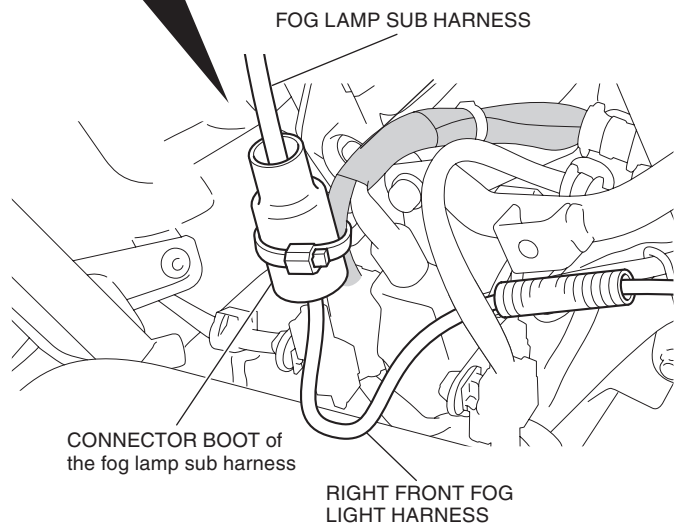
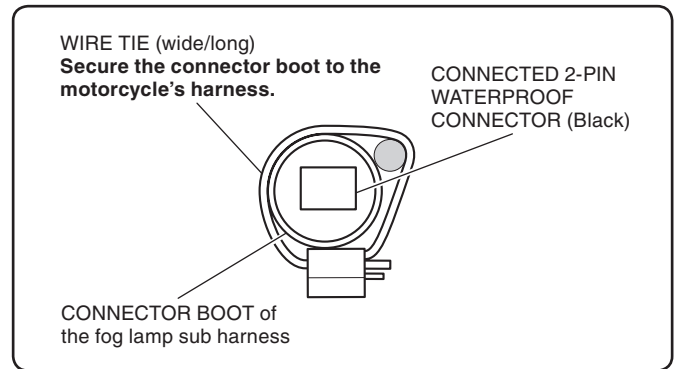

48. Secure the corrugate tube with the rubber band as shown.

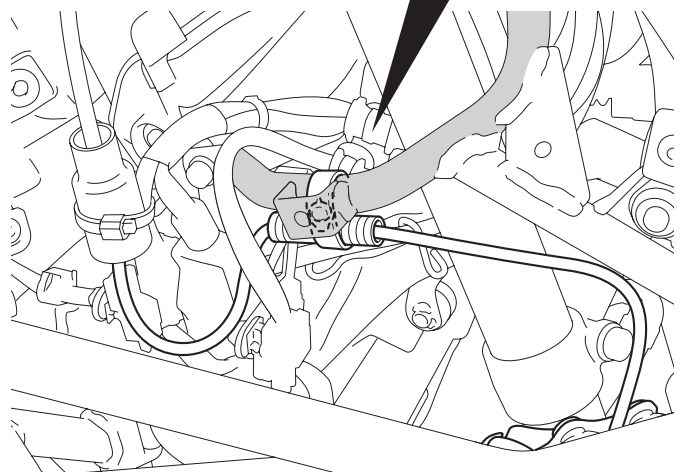
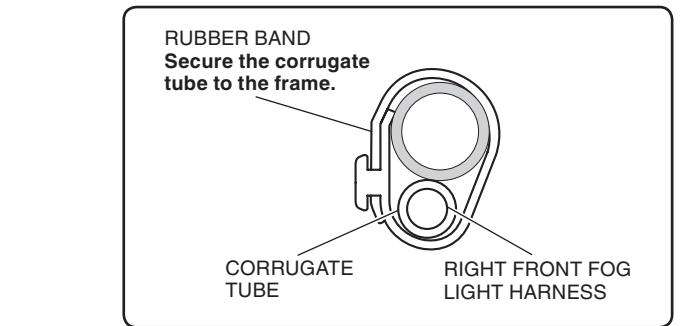

49. Secure the right front fog light harness with the wire tie as shown.

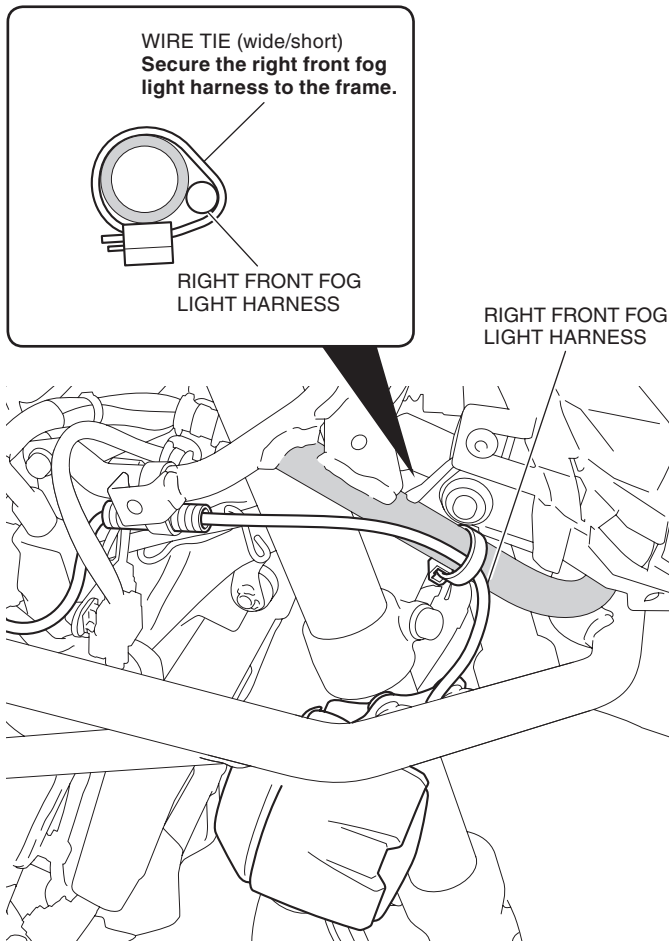

50. Install the motorcycle's parts in the reverse order of removal.
- **Confirm that any wire harness is not caught or too tight.**
51. Check the fog light, headlight and the other lights for proper operation.

ADJUSTING THE FOG LIGHT AIMING

1. Place the motorcycle on a level surface, 5 m away from the aiming screen.
2. Turn the ignition switch to ON.
3. Press the fog light switch to turn the fog lights on.

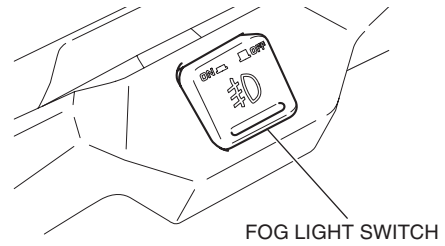

4. Measure the mounting height of the fog light from the floor.
5. Aim the fog lights so that the cut-off line of the light pattern on the aiming screen is the same distance above the floor as the fog light mounting height.

